

# STATE WELL REPORT

## Part 1

### Driller's Log

Mississippi Department of Environmental Quality  
Office of Land and Water Resources  
P.O. Box 2309  
Jackson, MS 39225-2309  
(601)961-5210  
(601)360-0535 (fax)

#### For Office Use Only:

Well #: B60  
Aquifer: MRVA  
E-Log #: \_\_\_\_\_

RECEIVED  
11-01-2019  
BY OLWR

County: QUITMAN  
Permit #: GW-50702  
Driller: CHAD MATTOX  
Date drilling completed: 09-25-19

State Law requires that this report be prepared by the license holder responsible for the work and filed with the Department at the above address within 30 days of completion of drilling of the well or borehole.

Well Owner Information (Landowner if borehole is not for a water well)	Well or Borehole Location
Owner Name: <u>MCARTHUR &amp; PATTERSON</u>	Latitude: <u>34 20 17N</u> Longitude: <u>90 20 02W</u>
Mailing Address: <u>405 DOAK THORNTON D</u>	Method of Lat/Long (check one): Conventional Survey <input type="radio"/> , USGS quad <input type="radio"/> , Hand-held GPS <input type="radio"/> , Survey-grade GPS <input type="radio"/>
<u>SLEDGE</u> MS <u>38670</u>	_____ 1/4 _____ 1/4, Sec. _____ T _____ R _____
City State Zip Code	_____ Miles _____ of _____ (Distance) (Direction) (Nearest Town)
Telephone No. (____) _____	

**Well / Borehole Data**

Date drilling started: 09-25-19 Date drilling completed: 09-25-19 Hole depth: 100 Hole diameter: 16"

Location of the source of any surface water used for drilling: \_\_\_\_\_

Method of dosing and volume of Chlorine used in drilling and development: \_\_\_\_\_

Logs run (check all applicable):  No log run  Electric  Gamma Ray  Density  Sonic  Neutron  Other: \_\_\_\_\_

Name of organization running log(s): \_\_\_\_\_

Purpose of borehole (circle one):  Water Well  Geotechnical/Geological Investigation  Ground Source Heat Pump  
 Seismic Survey  Other (describe) \_\_\_\_\_

*If drilling is not related to water well construction, skip the remainder of this block*

Purpose of Well (check all applicable):  Home  Industrial  Public Supply  Irrigation  Fish Culture

Other (describe): \_\_\_\_\_

If a flowing well, method of flow regulation: Valve \_\_\_\_\_ Other (describe) \_\_\_\_\_

Static Water Level: 25 feet  above /  below land surface Date measured: 09/24/19  
(select one)

Method of measurement (select one):  Steel tape  Electric tape  Air line  Other (describe): \_\_\_\_\_

Well depth: 100 Well grouted to a depth of: 10 feet Type of grout (select one):  Neat Cement  Bentonite  Mix

Casing length: 58 feet Casing diameter: 16" inches Type of casing: PVC

Screen length: 42 feet Screen diameter: 16" inches Type of screen: PVC

Screen slot size: .032 inches Setting depth: From \_\_\_\_\_ feet to \_\_\_\_\_ feet

Type of completion (check all applicable):  Gravel packed  Underreamed  Open hole  Natural Development

Other (describe): \_\_\_\_\_

Top of lap pipe or reduction in casing: \_\_\_\_\_ feet

*If telescoped or more than one screen, describe on next page*

County: QUITMAN  
 Permit #: GW-50702



**For Office Use Only:**  
 Well #: B60

The sketch below only required for water wells

If well telescopes, show depths on sketch.

Ground Level	
10	CASING
20	CASING
30	CASING
40	CASING
58	CASING
69	SCREEN
70	SCREEN
80	SCREEN
90	SCREEN
100	SCREEN

Description of formations encountered must be provided for all wells and boreholes, unless specifically exempted by regulations

Description of Formations Encountered	From (depth)	To (depth)
	Ground level	10
CLAY	10	20
MED SAND (25) & PEA GRAVEL	20	30
MED SAND & PEA GRAVEL	30	40
MED SAND & PEA GRAVEL	40	50
MED SAND & PEA GRAVEL	50	60
MED SAND & PEA GRAVEL	60	70
MED SAND & PEA GRAVEL	70	80
MED SAND & PEA GRAVEL	80	90
MED SAND & PEA GRAVEL	90	100
	100	110
	110	120

If more than one screen, show location of each on sketch

Sketch the property layout and include the following:

- 1) the well location
- 2) any permanent structures on the property that may aid in locating the well
- 3) any roads, power lines, or other items that may aid in locating the property and the well
- 4) north arrow

Landowner Name: \_\_\_\_\_

I HEREBY CERTIFY that the well/borehole was drilled, constructed, and completed in accordance with all applicable requirements of the Mississippi Department of Environmental Quality and the Mississippi Department of Health regulations, if applicable, and state laws.

CHAD MATTOX                      UNR 8243                      10/25/19                      Chad Mattox  
 Print Name of Responsible Licensee and License No.                      Date                      Signature of Licensee

# STATE WELL REPORT

## Part 2

**Pump Installer's Completion Report**  
 Mississippi Department of Environmental Quality  
 Office of Land and Water Resources  
 P.O. Box 2309  
 Jackson, MS 39225-2309  
 (601)961-5210  
 (601) 360-0535 (fax)

### For Office Use Only:

Well #: **B60**  
 Aquifer: \_\_\_\_\_

County: QUITMAN  
 Permit #: GW-50702  
 Driller: CHAD MATTOX  
 Date completed: 09/25/19  
*Copy information from block on Part 1*

*This part of the report must be completed by a licensed water well contractor or a licensed pump installer. A copy of Part 1 of the report must be attached and both parts filed with the Department at the above address within 30 days of well completion.*

Well Owner Information			Well Location		
Owner Name: <u>MCARTHUR &amp; PATTERSON FA</u>			Latitude: <u>34 20 17N</u> Longitude: <u>90 20 02W</u>		
Mailing Address: <u>405 DOAK THORNTON DRIV</u>			Method of Lat/Long (select one): Conventional Survey <input type="radio"/> ,		
			USGS quad <input type="radio"/> , Hand-held GPS <input checked="" type="radio"/> , Survey-grade GPS <input type="radio"/>		
<u>SLEDGE</u>	<u>MS</u>	<u>38670</u>	_____ ¼ _____ ¼, Sec _____ T _____ R _____		
City	State	Zip Code	_____ Miles _____ of _____		
Telephone No. (____) _____			(Distance) (Direction) (Nearest Town)		

**Pump Type (select one)**

Submersible  Turbine  Air Lift  Centrifugal  Flowing Well  Jet  Piston  Rotary  Other (describe): \_\_\_\_\_

Date Pump Installed: \_\_\_\_\_ Rated Pump Capacity: \_\_\_\_\_ Gallons Per Minute

Is This Pump (select one):  New  Repaired  Replacement

**Power Type (select one)**

Electric  Diesel  Gasoline  Natural Gas  Tractor PTO  Windmill  Other (describe): \_\_\_\_\_

Horse Power Rating of Motor: 90 Setting Depth: 60 feet Number of Stages: 1

**Pump Test Data for Non Flowing Well**

Date Well Tested: \_\_\_\_\_ Duration of Pump Test (minimum 4 hours): \_\_\_\_\_ hours

Static Water Level (A): 25 Feet Below Land Surface Pumping Water Level (B): \_\_\_\_\_ Feet Below Land Surface

Drawdown [(B) - (A)]: \_\_\_\_\_ Feet Below Land Surface Test Pumping Rate: \_\_\_\_\_ Gallons Per Minute

Method of measurement (select one):  Steel tape  Electric tape  Air line  Other (describe): \_\_\_\_\_

**Pump Test Data for Flowing Well**

Measured shut in head: \_\_\_\_\_ feet.

Well yielded \_\_\_\_\_ GPM with a drawdown of \_\_\_\_\_ feet after \_\_\_\_\_ hours of pumping

**Meter Installation**

Meter Manufacturer: \_\_\_\_\_ Meter Serial Number: \_\_\_\_\_

Meter Model Number/Name: \_\_\_\_\_ Type of Meter: \_\_\_\_\_

Totalizer Register Unit and Multiplier Factor (AF x .001, gal x 1000, etc): \_\_\_\_\_

Installation Date: \_\_\_\_\_ Meter installed by: \_\_\_\_\_

Is This Meter (circle one):  New  Repaired  Replacement

*Important: By submitting the above information you are certifying that this meter was installed to manufacturer standards. For agricultural wells, a list of approved meters is on the MDEQ website.*

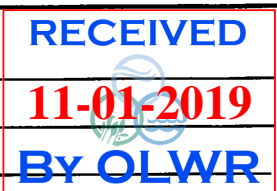

I HEREBY CERTIFY that the above statements are true to the best of my knowledge.

David P. Holt                      0-752P                      10/25/19                      [Signature]

Print Name of Pump Installer and License No. (if applicable)                      Date                      Signature of Pump Installer



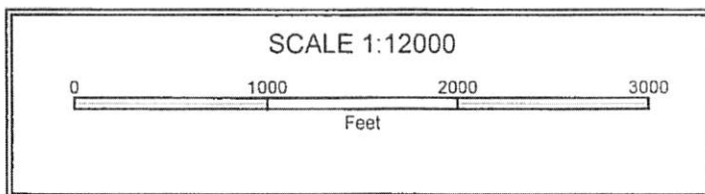
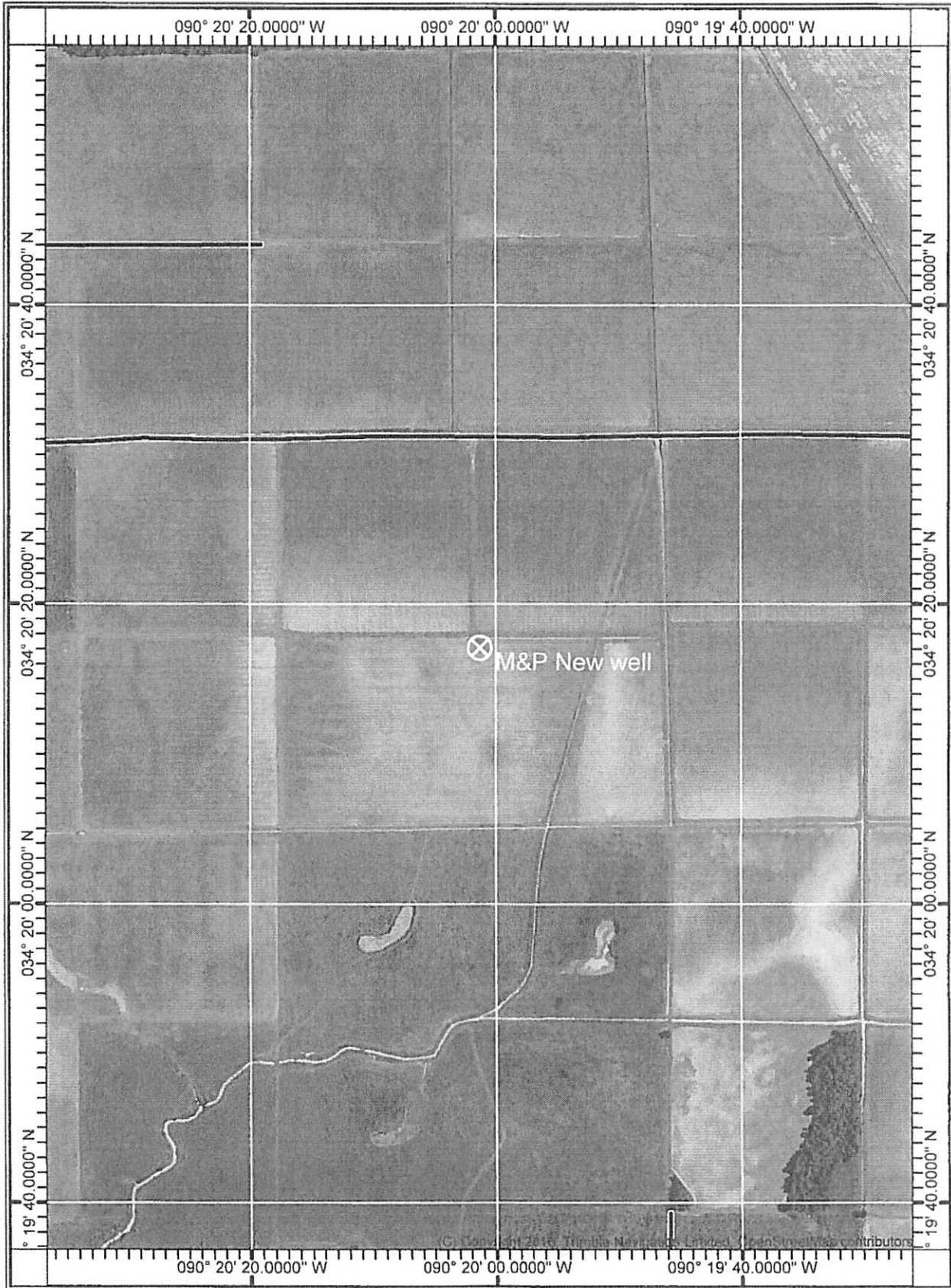

RECEIVED  
11-01-2019  
BY OLWR



STATE OF MISSISSIPPI
Department of Environmental Quality
Office of Land and Water Resources
P.O.Box 2309
Jackson, Mississippi 39225

34 20 17
90 20 02

PERMIT
TO DIVERT OR WITHDRAW FOR BENEFICIAL USE THE PUBLIC WATERS

This permit is issued to the landowner named below in accordance with the provisions of the Mississippi Water Laws, Mississippi Code Sections 51-3-1, et seq.(1972, as amended), and the regulations and standards as promulgated thereunder. Whether or not specifically named in this permit or in the applications for this permit, anyone using water from the diversion/withdrawal point described below shall do so in compliance with the provisions of this permit. Neither this permit, nor any authority conferred hereby, may be sold, conveyed, encumbered, assigned or otherwise aliened, for any period of time or under any conditions whatsoever. This permit may not be modified, transferred, or revoked without prior action by the Permit Board. Any attempts to modify, transfer or revoke this permit, or to take any other action on this permit, shall be invalid and unenforceable and may result in immediate revocation or suspension of this permit. The holder of this permit shall at all times be responsible for adherence to the terms and conditions of this permit. No agreement between the permit holder and any other party shall affect the obligations and liabilities of the permit holder. Water use under this permit is allowed only when the streamflow or lake level elevation (whichever, if any, is applicable) is above the established minimum, pursuant to Mississippi Code Section 51-3-7. Authorization is hereby granted to divert/withdraw water for the beneficial use designated herein, and for no other purpose, subject to the following terms, conditions, and limitations:

Permit Number: MS-GW 50702 Total Permitted Acreage: 120

Landowner Name: MCARTHUR AND PATTERSON FARMS
Landowner Address: 405 DOAK THORNTON DRIVE
SLEDGE, MS 38670

Source of Water: MISSISSIPPI RIVER VALLEY ALLUVIAL AQUIFER

Beneficial Use(s): IRRIGATION

Diversion/Withdrawal Location: SE 1/4 of the SE 1/4 Section: 31 Township: 29N Range: 01W

County: QUITMAN Quad: MARKS

Permitted Acreage: Irrigation: 120 Fish Culture: 0 Wildlife Management: 0

Maximum Volume: See Special Terms And Conditions (attachment I)

Applicant Name: MCARTHUR AND PATTERSON FARMS
Applicant Address: 405 DOAK THORNTON DRIVE
SLEDGE, MS 38670

Date Permit Issued: 04/01/2019

Date Permit Expires: 04/01/2024

Date Permit Modified:

Date Permit Reissued:

This permit shall be deemed null and void if construction has not begun within one (1) year of the permit issue date.

SPECIAL TERMS AND CONDITIONS I
See Attachment I which is hereby declared part of this permit.

Gary C. Rikard/Executive Director
Mississippi Department of Environmental Quality