

State Well Report

Part I - Driller's Log

County Quitman
Permit # GW-48201
Driller Joel Jumper
Date drilling completed 8-1-14

Mississippi Department of Environmental Quality
Office of Land and Water Resources
P.O. Box 2309
Jackson, MS 39226
(601)961-5210
(601)961-5228 (fax)

For Office Use Only:

Aquifer: _____
Well # A99
L.S. Elevation _____
E-log #: _____

State Law requires that this report be prepared by the license holder responsible for the work and filed with the Department at the above address within 30 days of completion of drilling of the well or borehole.

Information on Well Owner (Landowner if borehole is not for a water well)	Well or Borehole Location
Owner Name: <u>Jim Johnson</u>	Latitude: <u>34° 26' 45"</u> Longitude: <u>90° 13' 24"</u>
Mailing Address: <u>4424 Holly</u> <u>Grave Road</u> <u>Sardis Ms 38666</u>	Method of Lat/Long (circle one): Conventional Survey
City: _____ State: _____ Zip Code: _____	USGS quad: <u>Hand-held GPS</u> , Survey-grade GPS
Telephone No.: _____	SE 1/4 <u>NW</u> Sec <u>26</u> Twn <u>07S</u> Rng <u>10W</u>
	Distance _____ Miles Direction <u>NW</u> of Nearest Town <u>Sledge</u>

Well / Borehole Data

Date drilling started: 8-1-14 Date drilling completed: 8-1-14 Hole depth: 115 Hole diameter: 22 in

Location of the source of any surface water used for drilling: Nearest Well

Method of dosing and volume of Chlorine used in drilling and development: _____

Logs run (circle all applicable): No log run Electric Gamma Ray Density Sonic Neutron Other: _____

Name of organization running log(s): _____

Purpose of borehole (check one): Water Well Geotechnical/Geological Investigation Ground Source Heat Pump

Seismic Survey Other (describe) _____

If drilling is not related to water well construction, skip the remainder of this block

Purpose of Well (check one): Home Industrial Public Supply Irrigation Fish Culture Other: _____

If a flowing well, method of flow regulation: Valve _____ Other (describe) _____

Static Water Level: 16 feet above or below (circle one) land surface Date measured: 8-2-14

Method of Measurement (circle one) steel tape electric tape air line other: _____

Well depth: 115 Well grouted to a depth of 10 feet Type of grout (circle one): Neat Cement Bentonite Mix

Casing length: 75 feet Casing diameter: 12 inches Type of casing: pvc

Screen length: 40 feet Screen diameter: 12 inches Type of screen: pvc

Screen slot size: 0.50 inches Setting depth: From 0 feet to 70 feet

Type of completion (circle all applicable): Gravel packed Underreamed Telescoped Open hole Natural Development

Other (describe): _____

Top of lap pipe or reduction in casing: _____ feet. *If telescoped or more than one screen, describe on next page*

Form: OLWR-SWR-1A (04/08)

RECEIVED
AUG 27 2014
OLWR

The sketch below only required for water wells

If well telescopes, show depths on sketch.

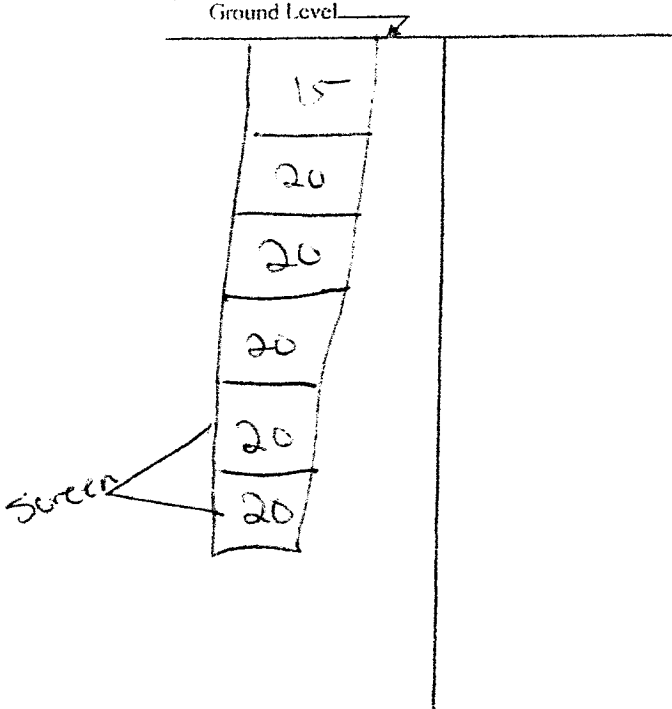

Description of formations encountered must be provided for all wells and boreholes, unless specifically exempted by regulations

Description of Formations Encountered	From (depth)	To (depth)
Clumbo	Ground Level	20
Sand	20	40
sand	40	60
Cowpe sand	60	80
gravel	80	100
gravel	100	115

If more than one screen, show location of each on sketch

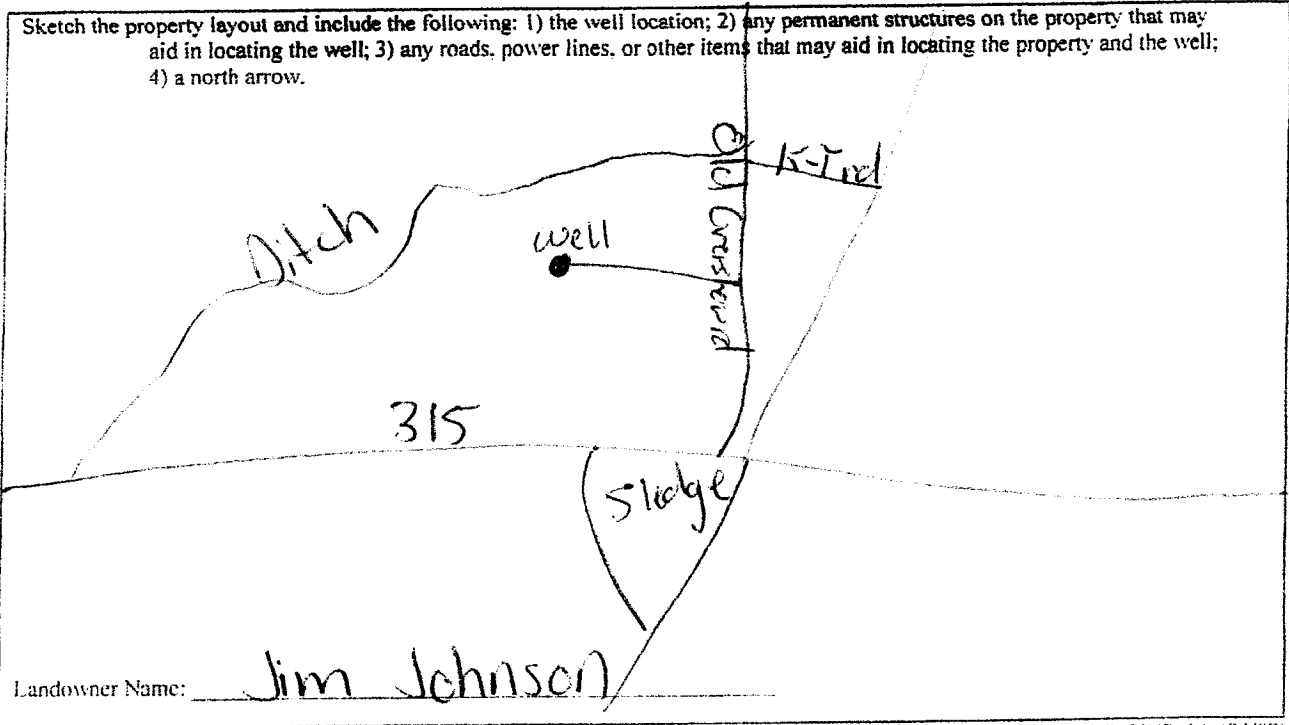

Form: OLWR-SWR-1A (04/08)

I certify that the well/borehole was drilled, constructed, and completed in accordance with all applicable requirements of the Mississippi Department of Environmental Quality and the Mississippi Department of Health regulations, if applicable, and state laws.

Joel Jumper 5317 8-2-14
Print Name of Responsible Licensee and License No. Date

[Signature]
Signature of Licensee

RECEIVED

AUG 27 2014

OLWA

STATE WELL REPORT

Part 2

Pump Installer's Completion Report
 Mississippi Department of Environmental Quality
 Office of Land and Water Resources
 P.O. Box 2309
 Jackson, MS 39225
 (601)961-5210
 (601)961-5228 (fax)

County: Quitman
 Permit #: GLW-48201
 Driller: Joel Jumper
 Date completed: 8-3-14
Copy information from block on Part 1

For Office Use Only:

Aquifer: _____
 Well #: A99
 Elevation: _____

This part of the report must be completed by a licensed water well contractor or a licensed pump installer. A copy of Part 1 of the report must be attached and both parts filed with the Department at the above address within 30 days of well completion.

Well Owner Information	Well Location
Owner Name: <u>Jim Johnson</u>	Latitude: <u>34-26-45</u> Longitude: <u>90-13-24</u>
Mailing Address: <u>4424 Holly Grove Road</u>	Method of Lat/Long (check one): Conventional Survey _____ USGS quad _____, Hand-held GPS <input checked="" type="checkbox"/> Survey-grade GPS _____
<u>Sardis Ms 38666</u>	<u>SE 1/4 NW 1/4 Sec 26 T 07S R 10W</u>
City State Zip Code	Distance Direction Nearest Town
Telephone No. () _____	<u>1</u> Miles <u>NW</u> of <u>Sledge</u>

Pump Type Circle one	Power Type Circle one
Air Lift Jet <input type="checkbox"/> Submersible <input checked="" type="checkbox"/>	Diesel Engine Gasoline Engine Natural Gas
Bucket Piston Turbine	Electric Motor <input checked="" type="checkbox"/> Hand Tractor PTO
Centrifugal Rotary Flowing Well	Windmill Other (specify): _____
Other (specify): _____	Horse Power Rating of Motor: <u>40 H.P.</u>
Date Pump Installed: <u>8-3-14</u>	Setting Depth: <u>0 to 70</u> feet
Rated Pump Capacity: <u>2,000</u> Gallons Per Minute	Number of Stages: <u>1</u>

Pump Test Data	Method of Measuring Water Level Circle one
Date Well Tested: <u>8-3-14</u>	Air Line Electric Measuring Line Steel Tape
Static Water Level (A): <u>110</u> Feet Below Land Surface	Other (specify): _____
Pumping Water Level (B): <u>31</u> Feet Below Land Surface	For flowing well, measured shut in head: _____ feet
Drawdown [(B) - (A)]: <u>15</u> Feet Below Land Surface	Well yielded _____ GPM with a drawdown of _____ feet after _____ hours of pumping
Test Pumping Rate: <u>2,000</u> Gallons Per Minute	
Duration of Pump Test (minimum 4 hours): <u>8</u> hours	

I HEREBY CERTIFY that the above statements are true to the best of my knowledge.

Joel Jumper 5317 Joel Jumper
 Print Name of Pump Installer and License No. (if applicable) Signature of Pump Installer

Form: OLWR-SWR-1B (04/08)

AUG 27 2014