

# STATE WELL REPORT

## Part 1

### Driller's Log

Mississippi Department of Environmental Quality  
Office of Land and Water Resources  
P.O. Box 2309  
Jackson, MS 39225-2309  
(601)961-5210  
(601)360-0535 (fax)

#### For Office Use Only:

Well #: A66  
Aquifer: \_\_\_\_\_  
E-Log #: \_\_\_\_\_

County: Pontotoc  
Permit #: \_\_\_\_\_  
Driller: Wally Wilson  
Date drilling completed: 7-2-12

*State Law requires that this report be prepared by the license holder responsible for the work and filed with the Department at the above address within 30 days of completion of drilling of the well or borehole.*

| Well Owner Information<br><small>(Landowner if borehole is not for a water well)</small> | Well or Borehole Location   |
|--|---|
| Owner Name: <u>Barbra Partdee</u>  | Latitude: <u>34° 19.639'</u> Longitude: <u>89° 08.701'</u><br><small style="margin-left: 100px;">38" <span style="margin-left: 150px;">42"</span></small> |
| Mailing Address: <u>3780 Cane Creek Road</u>   | Method of Lat/Long (check one): Conventional Survey _____, USGS quad _____, Hand-held GPS <input checked="" type="checkbox"/> , Survey-grade GPS _____    |
| <u>Thaxton</u> <u>MS</u> <u>38871</u><br>City State Zip Code                             | <u>NE 1/4 SE 1/4, Sec 1 T 9 S R 1 E</u>   |
| Telephone No. ( ) <u>No Phone</u>  | <u>5</u> Miles <u>W</u> of <u>Pontotoc</u><br>(Distance) (Direction) (Nearest Town)   |

| Well / Borehole Data  |
|---|
| Date drilling started: <u>6-29-12</u> Date drilling completed: <u>7-2-12</u> Hole depth: <u>280'</u> Hole diameter: <u>7 7/8"</u>   |
| Location of the source of any surface water used for drilling: <u>Fire hydrant 1/4 mile from well</u>   |
| Method of dosing and volume of Chlorine used in drilling and development: _____   |
| Logs run (circle all applicable): <input checked="" type="checkbox"/> No log run <input type="checkbox"/> Electric <input type="checkbox"/> Gamma Ray <input type="checkbox"/> Density <input type="checkbox"/> Sonic <input type="checkbox"/> Neutron Other: _____ |
| Name of organization running log(s): _____  |
| Purpose of borehole (circle one): <input checked="" type="checkbox"/> Water Well <input type="checkbox"/> Geotechnical/Geological Investigation <input type="checkbox"/> Ground Source Heat Pump<br><input type="checkbox"/> Seismic Survey Other (describe) _____  |
| <i>If drilling is not related to water well construction, skip the remainder of this block</i>  |

|  |
|--|
| Purpose of Well (circle all applicable): <input checked="" type="checkbox"/> Home <input type="checkbox"/> Industrial <input type="checkbox"/> Public Supply <input type="checkbox"/> Irrigation <input type="checkbox"/> Fish Culture |
| Other (describe): _____  |
| If a flowing well, method of flow regulation: Valve _____ Other (describe) _____   |
| Static Water Level: <u>105</u> feet [above or <input checked="" type="checkbox"/> below] land surface Date measured: <u>7-3-12</u><br><small style="margin-left: 100px;">(circle one)</small>  |
| Method of measurement (circle one): <input checked="" type="checkbox"/> Steel tape <input type="checkbox"/> Electric tape <input type="checkbox"/> Air line Other (describe): _____  |
| Well depth: <u>280'</u> Well grouted to a depth of: <u>20</u> feet Type of grout (circle one): Neat Cement Bentonite <input checked="" type="checkbox"/> Mix   |
| Casing length: <u>240</u> feet Casing diameter: <u>4</u> inches Type of casing: <u>Sch 40 PUG</u>  |
| Screen length: <u>40</u> feet Screen diameter: <u>4</u> inches Type of screen: <u>Sch 40 PUG</u>   |
| Screen slot size: <u>.10</u> inches Setting depth: From <u>240</u> feet to <u>280</u> feet   |
| Type of completion (circle all applicable): <input checked="" type="checkbox"/> Gravel packed <input type="checkbox"/> Underreamed <input type="checkbox"/> Open hole <input type="checkbox"/> Natural Development                     |
| Other (describe): _____  |
| Top of lap pipe or reduction in casing: _____ feet   |

*If telescoped or more than one screen, describe on next page*

County: Pontotoc  
 Permit #: \_\_\_\_\_

**For Office Use Only:**  
 Well #: Abb

The sketch below only required for water wells

If well telescopes, show depths on sketch.

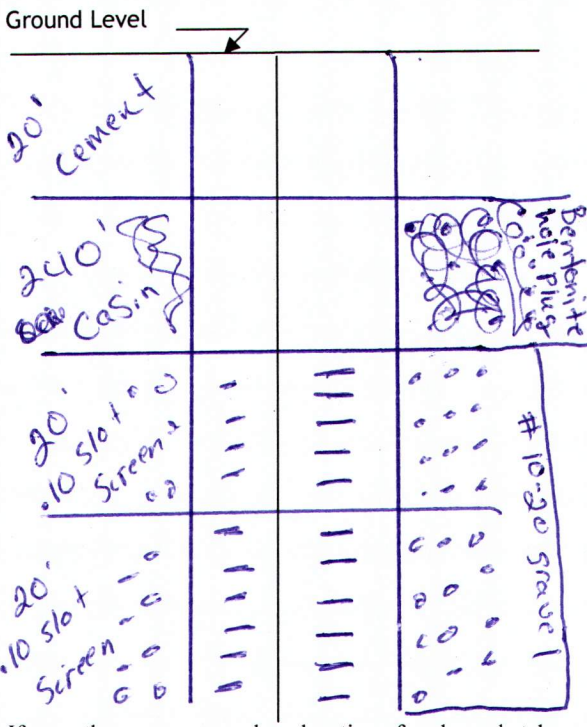

If more than one screen, show location of each on sketch

Description of formations encountered must be provided for all wells and boreholes, unless specifically exempted by regulations

| Description of Formations Encountered | From (depth) | To (depth) |
|---------------------------------------|--------------|------------|
| TOP Soil                              | Ground level | 8          |
| Blue clay                             | 12'          | 230'       |
| Fine Sand                             | 230          | 240        |
| Rock                                  | 240          | 242        |
| Sand                                  | 242          | 280        |
|                                       |              |            |
|                                       |              |            |
|                                       |              |            |
|                                       |              |            |
|                                       |              |            |
|                                       |              |            |
|                                       |              |            |
|                                       |              |            |
|                                       |              |            |
|                                       |              |            |
|                                       |              |            |

Sketch the property layout and include the following:

- 1) the well location
- 2) any permanent structures on the property that may aid in locating the well
- 3) any roads, power lines, or other items that may aid in locating the property and the well
- 4) north arrow

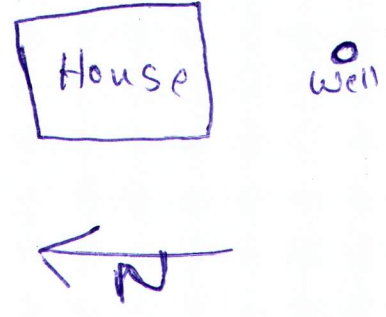

RECEIVED  
 OCT 21 2013  
 BY: OLWR

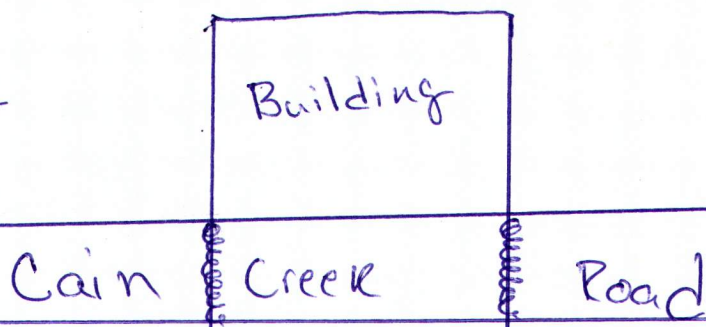

Landowner Name: ~~Barbara Partdee~~ Barbra Partdee

I HEREBY CERTIFY that the well/borehole was drilled, constructed, and completed in accordance with all applicable requirements of the Mississippi Department of Environmental Quality and the Mississippi Department of Health regulations, if applicable, and state laws.

Wally Wilson UWR-00004589      7-10-12      Wally Wilson  
 Print Name of Responsible Licensee and License No.      Date      Signature of Licensee

# STATE WELL REPORT

## Part 2

**Pump Installer's Completion Report**  
Mississippi Department of Environmental Quality  
Office of Land and Water Resources  
P.O. Box 2309  
Jackson, MS 39225-2309  
(601)961-5210  
(601) 360-0535 (fax)

### For Office Use Only:

Well #: A66  
Aquifer: \_\_\_\_\_

County: Pontotoc  
Permit #: \_\_\_\_\_  
Driller: Wally Wilson  
Date completed: 7-4-12

Copy information from block on Part 1

*This part of the report must be completed by a licensed water well contractor or a licensed pump installer. A copy of Part 1 of the report must be attached and both parts filed with the Department at the above address within 30 days of well completion.*

| Well Owner Information                                       | Well Location  |
|--|--|
| Owner Name: <u>Barbra Partdee</u>                            | Latitude: <u>34° 19.639'</u> Longitude: <u>89° 08.701'</u>   |
| Mailing Address: <u>3780 Cane Creek Road</u>                 | Method of Lat/Long (check one): Conventional Survey _____, USGS quad _____, Hand-held GPS <input checked="" type="checkbox"/> , Survey-grade GPS _____ |
| City: <u>Thaxton</u> State: <u>MS</u> Zip Code: <u>38871</u> | _____ 1/4 _____ 1/4, Sec <u>1</u> T <u>9</u> R <u>1</u>  |
| Telephone No. ( ) <u>No Phone</u>                            | <u>5</u> Miles <u>W</u> of <u>Pontotoc</u><br>(Distance) (Direction) (Nearest Town)  |

**Pump Type (circle one)**  
 Submersible  Turbine  Air Lift  Centrifugal  Flowing Well  Jet  Piston  Rotary  Other (describe): \_\_\_\_\_  
Date Pump Installed: 7-3-12 Rated Pump Capacity: 12 Gallons Per Minute  
Is This Pump (circle one):  New  Repaired  Replacement

**Power Type (circle one)**  
 Electric  Diesel  Gasoline  Natural Gas  Tractor PTO  Windmill  Other (describe): \_\_\_\_\_  
Horse Power Rating of Motor: 3/4 Setting Depth: 140 feet Number of Stages: 8

**Pump Test Data for Non Flowing Well**  
Date Well Tested: 7-3-12 Duration of Pump Test (minimum 4 hours): 8 hours  
Static Water Level (A): 105 Feet Below Land Surface Pumping Water Level (B): 125 Feet Below Land Surface  
Drawdown [(B) - (A)]: 025 Feet Below Land Surface Test Pumping Rate: 10 Gallons Per Minute  
Method of measurement (circle one)  Steel tape  Electric tape  Air line  Other (describe): \_\_\_\_\_

**Pump Test Data for Flowing Well**  
Measured shut in head: \_\_\_\_\_ feet.  
Well yielded 10 GPM with a drawdown of 25 feet after 8 hours of pumping

**Meter Installation**  
Meter Manufacturer: \_\_\_\_\_ Meter Serial Number: RECEIVED  
Meter Model Number/Name: \_\_\_\_\_ Type of Meter: 0012222  
Totalizer Register Unit and Multiplier Factor (AF x .001, gal x 1000, etc): \_\_\_\_\_  
Installation Date: \_\_\_\_\_ Meter installed by: BY: OLWR  
Is This Meter (circle one):  New  Repaired  Replacement  
*Important: By submitting the above information you are certifying that this meter was installed to manufacturer standards. For agricultural wells, a list of approved meters is on the MDEQ website.*

I HEREBY CERTIFY that the above statements are true to the best of my knowledge.  
Wally Wilson UNR-00004589 7-10-12 Wally Wilson  
Print Name of Pump Installer and License No. (if applicable) Date Signature of Pump Installer