

# State Well Report

## Part 1 - Driller's Log

Mississippi Department of Environmental Quality  
Office of Land and Water Resources  
P.O. Box 2307  
Jackson, MS 39225  
(601)961- 5210  
(601)961- 5228 (fax)

County: Pike  
Permit #: \_\_\_\_\_  
Driller: J.C. Sumrall  
Date drilling completed: 1/27/09

For Office Use Only:  
Aquifer: \_\_\_\_\_  
Well #: M-129  
L. S. Elevation: \_\_\_\_\_  
E-log #: \_\_\_\_\_

State Law requires that this report be prepared by the license holder responsible for the work and filed with the Department at the above address within 30 days of completion of drilling of the well or borehole.

Information on Well Owner (Landowner if borehole is not for a water well)	Well or Borehole Location
Owner Name: <u>Curt Wagner</u>	Latitude: _____ Longitude: _____
Mailing Address: <u>1160 Joe Tucker Rd</u> <u>McComb, MS</u>	Method of Lat/Long (circle one): Conventional Survey, USGS quad, Hand-held GPS, Survey-grade GPS
City _____ State _____ Zip Code _____	_____ 1/4 _____ 1/4 Sec <u>21</u> Twn <u>1N</u> Rng <u>9E</u>
Telephone No. (____) _____	Distance _____ Miles Direction <u>SE</u> of Nearest Town <u>Magnolia, MS</u>

**Well / Borehole Data**

Date drilling started: 1/27/09 Date drilling completed: 1/27/09 Hole depth: 70 Hole diameter: 2 1/2

Location of the source of any surface water used for drilling: POTABLE WATER

Method of dosing and volume of Chlorine used in drilling and development: \_\_\_\_\_

Logs run (circle all applicable): No log run Electric Gamma Ray Density Sonic Neutron Other: \_\_\_\_\_

Name of organization running log(s): \_\_\_\_\_

Purpose of borehole (check one): Water Well  Geotechnical/Geological Investigation \_\_\_\_\_ Ground Source Heat Pump \_\_\_\_\_

Seismic Survey \_\_\_\_\_ Other (describe) \_\_\_\_\_

**If drilling is not related to water well construction, skip the remainder of this block**

Purpose of Well (check one): Home \_\_\_\_\_ Industrial \_\_\_\_\_ Public Supply \_\_\_\_\_ Irrigation \_\_\_\_\_ Fish Culture \_\_\_\_\_ Other: Live Stock

If a flowing well, method of flow regulation: Valve \_\_\_\_\_ Other (describe) \_\_\_\_\_

Static Water Level: 35 feet above of below (circle one) land surface Date measured: 1/27/09

Method of Measurement (circle one) steel tape electric tape air line other: \_\_\_\_\_

Well depth: 70 Well grouted to a depth of 10 feet Type of grout (circle one): Neat Cement Bentonite Mix

Casing length: 60 feet Casing diameter: 4 inches Type of casing: PVC

Screen length: 10 feet Screen diameter: 4 inches Type of screen: PVC

Screen slot size: .010 inches Setting depth: From 60 feet to 70 feet

Type of completion (circle all applicable): Gravel packed Underreamed Telescoped Open hole Natural Development

Other (describe): \_\_\_\_\_

Top of lap pipe or reduction in casing: \_\_\_\_\_ feet. **If telescoped or more than one screen, describe on next page**

M-129

The sketch below only required for water wells

Description of formations encountered must be provided for all wells and boreholes, unless specifically exempted by regulations

If well telescopes, show depths on sketch.

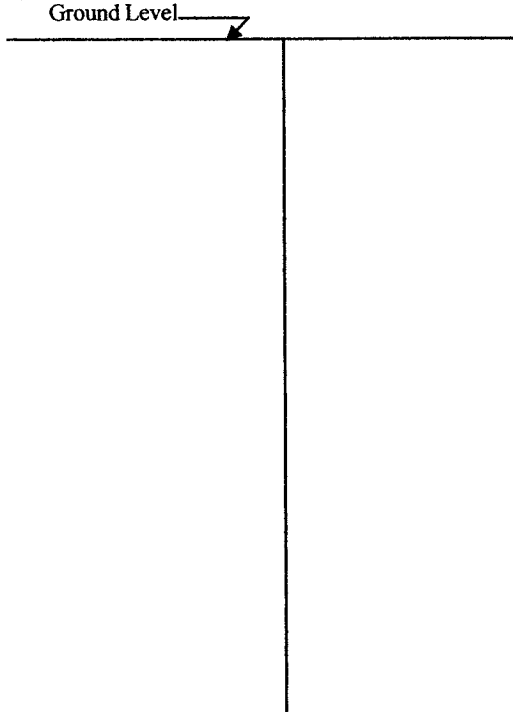

Description of Formations Encountered	From (depth) Ground Level	To (depth)
top soil	0	1
Sandy clay	1	35
Sand	35	70

If more than one screen, show location of each on sketch

Sketch the property layout and include the following: 1) the well location; 2) any permanent structures on the property that may aid in locating the well; 3) any roads, power lines, or other items that may aid in locating the property and the well; 4) a north arrow.

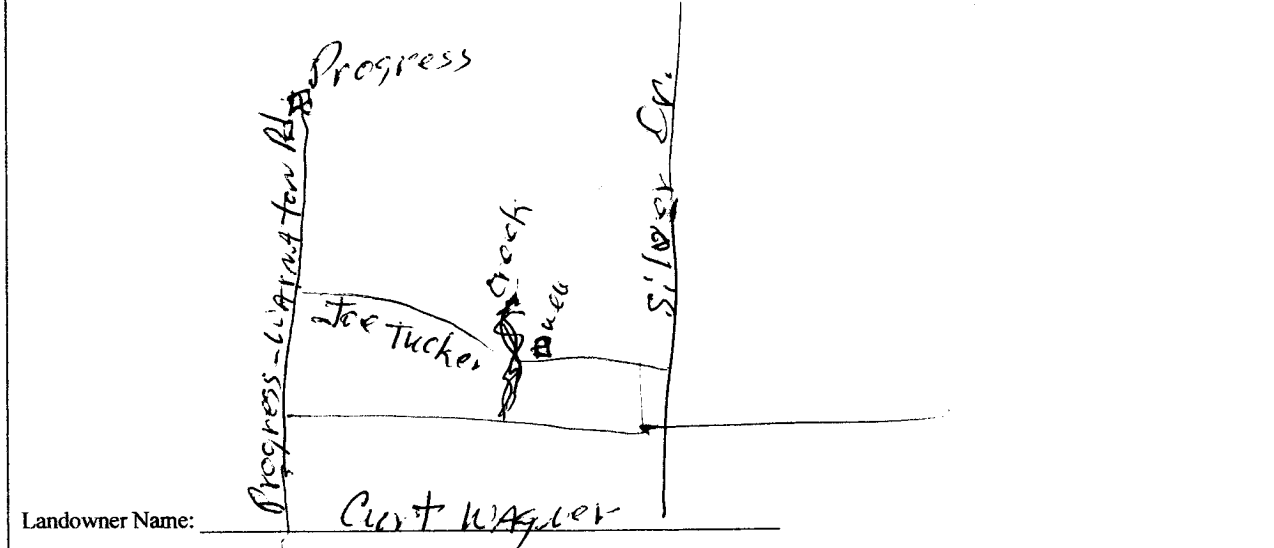

Landowner Name: Curt Wagner

Form: OLWR-SWR-1A (04/08)

I certify that the well/borehole was drilled, constructed, and completed in accordance with all applicable requirements of the Mississippi Department of Environmental Quality and the Mississippi Department of Health regulations, if applicable, and state laws.

Jordan Well Ser. C-508 1/27/09

Print Name of Responsible Licensee and License No.

Date

Signature of Licensee

# STATE WELL REPORT

## Part 2

**Pump Installer's Completion Report**  
 Mississippi Department of Environmental Quality  
 Office of Land and Water Resources  
 P.O. Box 2309  
 Jackson, MS 39225  
 (601)961-5210  
 (601)961-5228 (fax)

County: Pike  
 Permit #: \_\_\_\_\_  
 Driller: J.C. Sumrall  
 Date completed: 1/27/09  
*Copy information from block on Part 1*

**For Office Use Only:**

Aquifer: \_\_\_\_\_  
 Well #: M-129  
 Elevation: \_\_\_\_\_

*This part of the report must be completed by a licensed water well contractor or a licensed pump installer. A copy of Part 1 of the report must be attached and both parts filed with the Department at the above address within 30 days of well completion.*

Well Owner Information	Well Location
Owner Name: <u>Curt Wagner</u>	Latitude: _____ Longitude: _____
Mailing Address: <u>1160 Joe Tucker Rd</u> <u>McComb, MS</u>	Method of Lat/Long (check one): Conventional Survey _____ USGS quad _____, Hand-held GPS _____, Survey-grade GPS _____ _____ 1/4 _____ 1/4 Sec <u>21</u> T <u>1</u> R <u>9e</u>
City _____ State _____ Zip Code _____	Distance _____ Direction _____ Nearest Town _____
Telephone No. (____) _____	<u>8</u> Miles <u>SE</u> of <u>Magnolia, MS</u>

Pump Type Circle one	Power Type Circle one
Air Lift _____ Jet _____ <u>Submersible</u>	Diesel Engine _____ Gasoline Engine _____ Natural Gas _____
Bucket _____ Piston _____ Turbine _____	<u>Electric Motor</u> _____ Hand _____ Tractor PTO _____
Centrifugal _____ Rotary _____ Flowing Well _____	Windmill _____ Other (specify): _____
Other (specify): _____	Horse Power Rating of Motor: <u>1/2</u>
Date Pump Installed: <u>1/27/09</u>	Setting Depth: <u>60</u> feet
Rated Pump Capacity: <u>10</u> Gallons Per Minute	Number of Stages: <u>8</u>

Pump Test Data	Method of Measuring Water Level Circle one
Date Well Tested: <u>1/27/09</u>	Air Line _____ Electric Measuring Line _____ <u>Steel Tape</u>
Static Water Level (A): <u>35</u> Feet Below Land Surface	Other (specify): _____
Pumping Water Level (B): _____ Feet Below Land Surface	For flowing well, measured shut in head: _____ feet
Drawdown [(B) - (A)]: _____ Feet Below Land Surface	Well yielded <u>10</u> GPM with a drawdown of _____ feet after <u>4</u> hours of pumping
Test Pumping Rate: <u>10</u> Gallons Per Minute	
Duration of Pump Test (minimum 4 hours): <u>4</u> hours	

I HEREBY CERTIFY that the above statements are true to the best of my knowledge.

Jordan Well Serv. 0-508 \_\_\_\_\_  
 Print Name of Pump Installer and License No. (if applicable) Signature of Pump Installer