

County: Pike
 Permit #: _____
 Driller: Fitzgerald Well Serv
 Date drilling completed: 8-31-10

State Well Report
Part 1 - Driller's Log
 Mississippi Department of Environmental Quality
 Office of Land and Water Resources
 P.O. Box 10631
 Jackson, MS 39289-0631
 (601)961-5210
 (601)354-6938 (fax)

For Office Use Only:

Aquifer: J 153
 Well #: _____
 L. S. Elevation: _____
 E-log #: _____

State Law requires that this report be prepared by the license holder responsible for the work and filed with the Department at the above address within 30 days of completion of drilling of the well or borehole.

Information on Well Owner <i>(Landowner if borehole is not for a water well)</i>	Well or Borehole Location
Owner Name: <u>Gillis DuFreen</u>	Latitude: <u>31° 9' 55.9"</u> Longitude: <u>90° 19' 28.1"</u>
Mailing Address: <u>Conedy Dr.</u>	Method of Lat/Long (circle one): Conventional Survey,
<u>M/omb MS.</u>	USGS quad, Hand-held GPS, Survey-grade GPS
City State Zip Code	<u>NW 1/4 SW 1/4 Sec 5 Twn 2N Rng 9E</u>
Telephone No. ()	Distance Direction Nearest Town
	Miles of

Well / Borehole Data

Date drilling started: 8-31-10 Date drilling completed: 8-31-10 Hole depth: 155' Hole diameter: 8"

Location of the source of any surface water used for drilling: _____
 Method of dosing and volume of Chlorine used in drilling and development: _____

Logs run (circle all applicable): No log run Electric Gamma Ray Density Sonic Neutron Other: _____
 Name of organization running log(s): _____

Purpose of borehole (check one): Water Well Geotechnical/Geological Investigation _____ Ground Source Heat Pump _____
 Seismic Survey _____ Other (describe) _____

If drilling is not related to water well construction, skip the remainder of this block.

Purpose of Well (check one): Home Industrial _____ Public Supply _____ Irrigation _____ Fish Culture _____ Other: _____

If a flowing well, method of flow regulation: Valve _____ Other (describe) _____

Static Water Level: 86' feet above or below (circle one) land surface Date measured: 8-31-10

Method of Measurement (circle one) steel tape electric tape air line other: _____

Well depth: 155' Well grouted to a depth of 10' feet Type of grout (circle one): Neat Cement Bentonite Mix

Casing length: 145' feet Casing diameter: 4" inches Type of casing: PVC

Screen length: 10' feet Screen diameter: 4" inches Type of screen: PVC

Screen slot size: .012 inches Setting depth: From 145' feet to 155' feet

Type of completion (circle all applicable): Gravel packed Underreamed Telescoped Open hole Natural Development
 Other (describe): _____

Top of lap pipe or reduction in casing: _____ feet. *If telescoped or more than one screen, describe on next page*

RECEIVED RECEIVED
 OCT 04 2010 OCT 04 2010
 BY: OLWR BY: OLWR

If well telescopes, show depths on sketch.

Ground Level →

Description of Formations Encountered	From (depth) To (depth)	
	Ground Level	
Clay	0	20
gravel	20	60
sand	60	80
gravel	80	100
Clay	100	120
sand	120	140
coarse sand	140	155

J153

If more than one screen, show location of each on sketch

Sketch the property layout and include the following: 1) the well location; 2) any permanent structures on the property that may aid in locating the well; 3) any roads, power lines, or other items that may aid in locating the property and the well; 4) a north arrow.

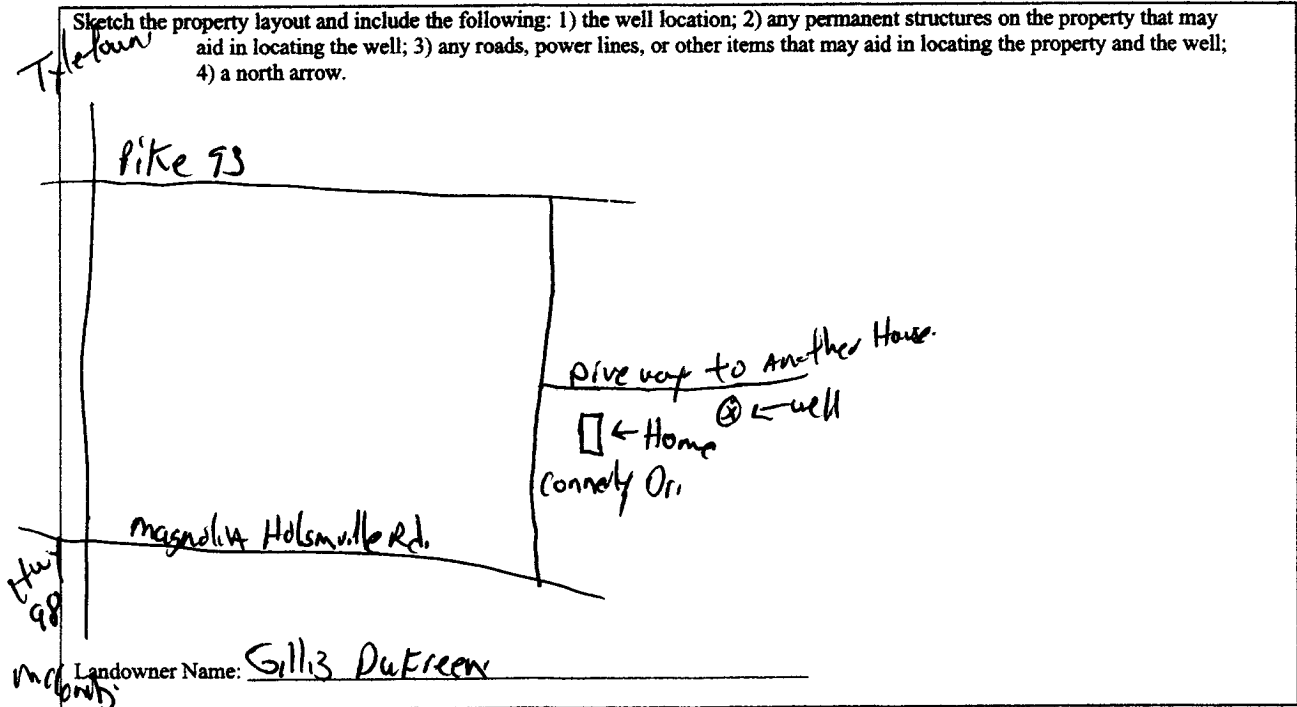

Form: OLWR-SWR-1A

I certify that the well/borehole was drilled, constructed, and completed in accordance with all applicable requirements of the Mississippi Department of Environmental Quality and the Mississippi Department of Health regulations, if applicable, and state laws.

Brad Fitzgerald 029 831-10 *Brad Fitzgerald*

Print Name of Responsible Licensee and License No. Date Signature of Licensee

RECEIVED
OCT 04 2010
BY: OLWR

STATE WELL REPORT

Part 2

Pump Installer's Completion Report
 Mississippi Department of Environmental Quality
 Office of Land and Water Resources
 P.O. Box 10631
 Jackson, MS 39289-0631
 (601)961-5210
 (601)354-6938 (fax)

County: Pike
 Permit #: _____
 Driller: Fitzgerald Well Serv
 Date completed: 8-31-10
Copy information from block on Part 1

For Office Use Only:

Aquifer: _____
 Well #: _____
 Elevation: _____

This part of the report must be completed by a licensed water well contractor or a licensed pump installer. A copy of Part 1 of the report must be attached and both parts filed with the Department at the above address within 30 days of well completion.

Well Owner Information	Well Location
Owner Name: <u>Gillis Dufreay</u>	Latitude: <u>31° 9' 55.8"</u> Longitude: <u>90° 19' 24.1"</u>
Mailing Address: <u>Coverly Dr</u>	Method of Lat/Long (check one): Conventional Survey _____
<u>M'Comb MS</u>	USGS quad _____, Hand-held GPS _____, Survey-grade GPS _____
City State Zip Code	_____ 1/4 _____ 1/4 Sec _____ T _____ R _____
Telephone No. (_____) _____	Distance Direction Nearest Town
	_____ Miles _____ of _____

Pump Type Circle one	Power Type Circle one
Air Lift Jet <input checked="" type="radio"/> Submersible	Diesel Engine Gasoline Engine Natural Gas
Bucket Piston Turbine	<input checked="" type="radio"/> Electric Motor Hand Tractor PTO
Centrifugal Rotary Flowing Well	Windmill Other (specify): _____
Other (specify): _____	Horse Power Rating of Motor: <u>1</u>
Date Pump Installed: <u>8-31-10</u>	Setting Depth: <u>120'</u> feet
Rated Pump Capacity: <u>20'</u> Gallons Per Minute	Number of Stages: <u>8</u>

Pump Test Data	Method of Measuring Water Level Circle one
Date Well Tested: _____	Air Line Electric Measuring Line <input checked="" type="radio"/> Steel Tape
Static Water Level (A): _____ Feet Below Land Surface	Other (specify): _____
Pumping Water Level (B): _____ Feet Below Land Surface	For flowing well, measured shut in head: _____ feet
Drawdown [(B) - (A)]: _____ Feet Below Land Surface	Well yielded _____ GPM with a drawdown of _____ feet after _____ hours of pumping
Test Pumping Rate: _____ Gallons Per Minute	
Duration of Pump Test (minimum 4 hours): _____ hours	

I HEREBY CERTIFY that the above statements are true to the best of my knowledge

Brad Fitzgerald 029 _____
 Print Name of Pump Installer and License No. (if applicable) Signature of Pump Installer

RECEIVED
 Form: OLWR-SW-10
 OCT 04 2010
 BY: OLWR