

County: Pike  
 Permit #: \_\_\_\_\_  
 Driller: Fitzgerald Well Service  
 Date drilling completed: 4-10-07

### State Well Report

#### Part 1 - Driller's Log

Mississippi Department of Environmental Quality  
 Office of Land and Water Resources  
 P.O. Box 10631  
 Jackson, MS 39289-0631  
 (601)961-5210  
 (601)354-6938 (fax)

For Office Use Only:  
 Aquifer: \_\_\_\_\_  
 Well #: H-198 178  
 L. S. Elevation: \_\_\_\_\_  
 E-log #: \_\_\_\_\_

*State Law requires that this report be prepared by the license holder responsible for the work and filed with the Department at the above address within 30 days of completion of drilling of the well or borehole.*

Information on Well Owner <i>(Landowner if borehole is not for a water well)</i>	Well or Borehole Location
Owner Name: <u>Dale Laurich</u>	Latitude: <u>31° 8' 54.2"</u> Longitude: <u>90° 23' 28.4"</u>
Mailing Address: <u>Union Church Rd</u>	Method of Lat/Long (circle one): <u>54</u> Conventional Survey, <u>28</u>
<u>magnolia</u> <u>ms.</u>	USGS quad, Hand-held GPS, Survey-grade GPS
City State Zip Code	<u>SE 1/4 S 20</u> <u>10</u> <u>Twn 20</u> <u>Rng 8E</u>
Telephone No. ( ) _____	Distance Direction Nearest Town _____ Miles _____ of _____

**Well / Borehole Data**

Date drilling started: 4-10-07 Date drilling completed: 4-10-07 Hole depth: 240' Hole diameter: 7"

Location of the source of any surface water used for drilling: \_\_\_\_\_  
 Method of dosing and volume of Chlorine used in drilling and development: \_\_\_\_\_

Logs run (circle all applicable): (No log run) Electric Gamma Ray Density Sonic Neutron Other: \_\_\_\_\_  
 Name of organization running log(s): \_\_\_\_\_

Purpose of borehole (check one): Water Well  Geotechnical/Geological Investigation \_\_\_\_\_ Ground Source Heat Pump \_\_\_\_\_  
 Seismic Survey \_\_\_\_\_ Other (describe) \_\_\_\_\_

*If drilling is not related to water well construction, skip the remainder of this block.*

Purpose of Well (check one): Home  Industrial \_\_\_\_\_ Public Supply \_\_\_\_\_ Irrigation \_\_\_\_\_ Fish Culture \_\_\_\_\_ Other: \_\_\_\_\_

If a flowing well, method of flow regulation: Valve \_\_\_\_\_ Other (describe) \_\_\_\_\_

Static Water Level: 76' feet above or below (circle one) land surface Date measured: 4-10-07

Method of Measurement (circle one) steel tape electric tape air line other: \_\_\_\_\_

Well depth: 240 Well grouted to a depth of 10' feet Type of grout (circle one) (Neat Cement) Bentonite Mix

Casing length: 230' feet Casing diameter: 4" inches Type of casing: Pvc

Screen length: 10' feet Screen diameter: 4" inches Type of screen: Pvc

Screen slot size: .012 inches Setting depth: From 230 feet to 240' feet

Type of completion (circle all applicable): Gravel packed Underreamed Telescoped Open hole Natural Development  
 Other (describe): \_\_\_\_\_

Top of lap pipe or reduction in casing: \_\_\_\_\_ feet. *If telescoped or more than one screen, describe on next page.*

Form: OLWR-SWR-1A

RECEIVED  
 APR 23 2007  
 BY: OLWR

The sketch below only required for water wells.

If well intersects, show depths on sketch.

Ground Level 

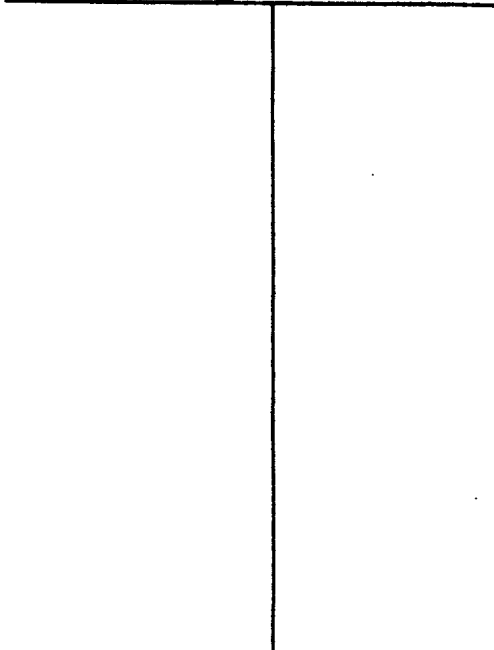

Description of formations encountered must be provided for all wells and boreholes, unless specifically exempted by regulations.

Description of Formations Encountered	From (depth)	To (depth)
	Ground Level	
clay	0	20
sand	20	40
clay	40	80
sand	80	100
clay	100	160
fine sand	160	220
(coarse sand)	220	240

If more than one screen, show location of each on sketch

Sketch the property layout and include the following: 1) the well location; 2) any permanent structures on the property that may aid in locating the well; 3) any roads, power lines, or other items that may aid in locating the property and the well; 4) a north arrow.

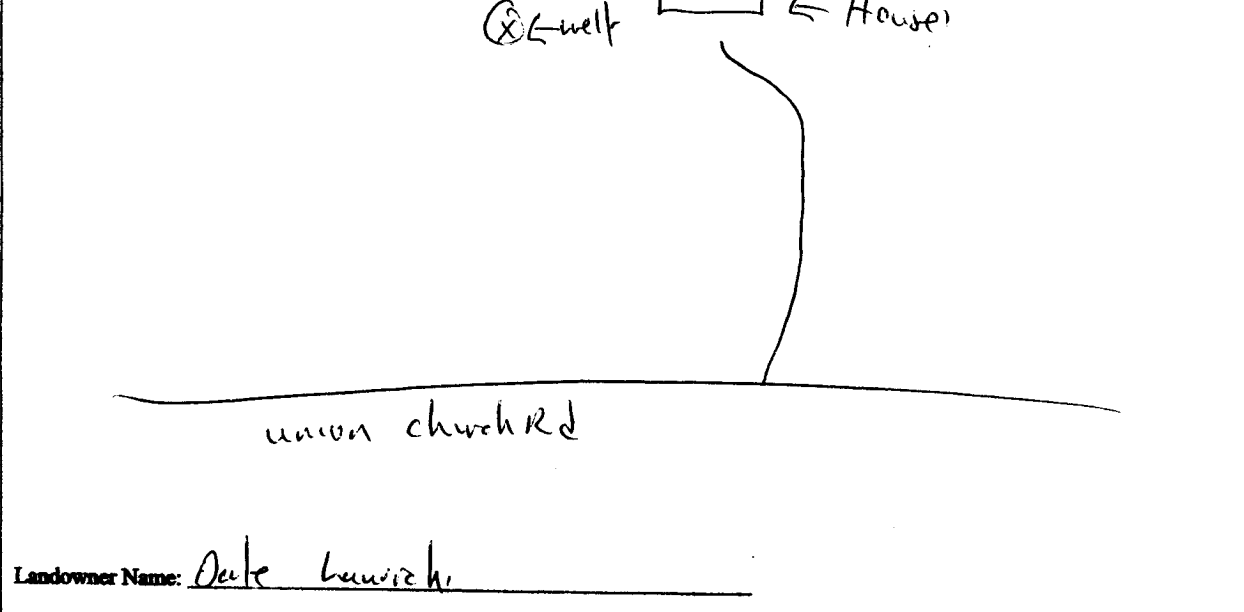

Landowner Name: Dale Lewis

Form: OLWR-SWR-1A

I certify that the well/borehole was drilled, constructed, and completed in accordance with all applicable requirements of the Mississippi Department of Environmental Quality and the Mississippi Department of Health regulations, if applicable, and state laws.

Brad Fitzgerald      029      4-10-07      Brad Fitzgerald  
Print Name of Responsible Licensee and License No.      Date      Signature of Licensee

RECEIVED  
APR 23 2007  
BY: OLWR

# STATE WELL REPORT

## Part 2

**Pump Installer's Completion Report**  
 Mississippi Department of Environmental Quality  
 Office of Land and Water Resources  
 P.O. Box 10631  
 Jackson, MS 39289-0631  
 (601)961-5210  
 (601)354-6938 (fax)

County: Pike  
 Permit #: \_\_\_\_\_  
 Driller: Fitzgerald well serv  
 Date completed: 4-10-07  
*Copy information from block on Part 1*

**For Office Use Only:**

Aquifer: \_\_\_\_\_  
 Well #: H-198  
 Elevation: \_\_\_\_\_

*This part of the report must be completed by a licensed water well contractor or a licensed pump installer. A copy of Part 1 of the report must be attached and both parts filed with the Department at the above address within 30 days of well completion.*

Well Owner Information	Well Location
Owner Name: <u>Dale Laurich</u>	Latitude: <u>30° 08' 54.2"</u> Longitude: <u>90° 23' 28.4"</u>
Mailing Address: <u>Union Church Rd.</u>	Method of Lat/Long (check one): Conventional Survey _____
<u>Merrolia ms</u>	USGS quad _____, Hand-held GPS _____, Survey-grade GPS _____
City State Zip Code	_____ 1/4 _____ 1/4 Sec <u>10</u> T <u>2N</u> R <u>8E</u>
Telephone No. (____) _____	Distance _____ Direction _____ Nearest Town _____
	_____ Miles _____ of _____

Pump Type Circle one	Power Type Circle one
Air Lift                      Jet <u>Submersible</u>	Diesel Engine                      Gasoline Engine                      Natural Gas
Bucket                      Piston                      Turbine	<u>Electric Motor</u> Hand                      Tractor PTO
Centrifugal                      Rotary                      Flowing Well	Windmill                      Other (specify): _____
Other (specify): _____	Horse Power Rating of Motor: <u>3/4</u>
Date Pump Installed: <u>4-10-07</u>	Setting Depth: <u>130'</u> feet
Rated Pump Capacity: <u>12</u> Gallons Per Minute	Number of Stages: <u>12</u>

Pump Test Data	Method of Measuring Water Level Circle one
Date Well Tested: _____	Air Line                      Electric Measuring Line <u>Steel Tape</u>
Static Water Level (A): _____ Feet Below Land Surface	Other (specify): _____
Pumping Water Level (B): _____ Feet Below Land Surface	For flowing well, measured shut in head: _____ feet
Drawdown [(B) - (A)]: _____ Feet Below Land Surface	Well yielded _____ GPM with a drawdown of _____ feet after _____ hours of pumping
Test Pumping Rate: _____ Gallons Per Minute	
Duration of Pump Test (minimum 4 hours): _____ hours	

I HEREBY CERTIFY that the above statements are true to the best of my knowledge.

Bruce Fitzgerald                      Bruce Fitzgerald  
 Print Name of Pump Installer and License No. (if applicable)                      Signature of Pump Installer

Form: OLWR-SWR-1B

RECEIVED

APR 23 2007

BY: OLWR