

County: Pike
 Permit #: _____
 Driller: Fitzgerald Well Service
 Date drilling completed: 1-6-10

State Well Report Part 1 - Driller's Log

Mississippi Department of Environmental Quality
 Office of Land and Water Resources
 P.O. Box 10631
 Jackson, MS 39289-0631
 (601)961-5210
 (601)354-6938 (fax)

For Office Use Only:
 Aquifer: G 176
 Well #: _____
 L. S. Elevation: _____
 E-log #: _____

State Law requires that this report be prepared by the license holder responsible for the work and filed with the Department at the above address within 30 days of completion of drilling of the well or borehole.

Information on Well Owner (Landowner if borehole is not for a water well)	Well or Borehole Location
Owner Name: <u>Austin Bulser</u>	Latitude: <u>31° 9' 27.1"</u> Longitude: <u>90° 28' 15.4"</u>
Mailing Address: <u>R. Bohner</u>	Method of Lat/Long (circle one): Conventional Survey,
<u>Magnolia MS.</u> City State Zip Code	USGS quad, Hand-held GPS, Survey-grade GPS
Telephone No. () _____	<u>NW 1/4 NE 1/4 Sec 11 Twn 2N Rng 7E</u>
	Distance _____ Miles Direction _____ Nearest Town _____

Well / Borehole Data

Date drilling started: 1-6-10 Date drilling completed: 1-6-10 Hole depth: 71' Hole diameter: 8"

Location of the source of any surface water used for drilling: _____
 Method of dosing and volume of Chlorine used in drilling and development: _____

Logs run (circle all applicable): No log run Electric Gamma Ray Density Sonic Neutron Other: _____
 Name of organization running logs: _____

Purpose of borehole (check one): Water Well Geotechnical/Geological Investigation _____ Ground Source Heat Pump _____
 Seismic Survey _____ Other (describe) _____

If drilling is not related to water well construction, skip the remainder of this block.

Purpose of Well (check one): Home Industrial _____ Public Supply _____ Irrigation _____ Fish Culture _____ Other: _____

If a flowing well, method of flow regulation: Valve _____ Other (describe) _____

Static Water Level: 14 feet above or below (circle one) land surface Date measured: 1-6-10

Method of Measurement (circle one) steel tape electric tape air line other: _____

Well depth: 71' Well grouted to a depth of 10' feet Type of grout (circle one) Neat Cement Bentonite Mix

Casing length: 51' feet Casing diameter: 4" inches Type of casing: PVC

Screen length: 20' feet Screen diameter: 4" inches Type of screen: PVC

Screen slot size: .010 inches Setting depth: From 51' feet to 71' feet

Type of completion (circle all applicable): Gravel packed Underreamed Telescoped Open hole Natural Development
 Other (describe): _____

Top of lap pipe or reduction in casing: _____ feet *If telescoped or more than one screen, describe on next page*

Form: OLWR-SWR-1A

RECEIVED
 JAN 20 2010
 BY: OLWR

6176

The sketch below only required for water wells

If well telescopes, show depths on sketch

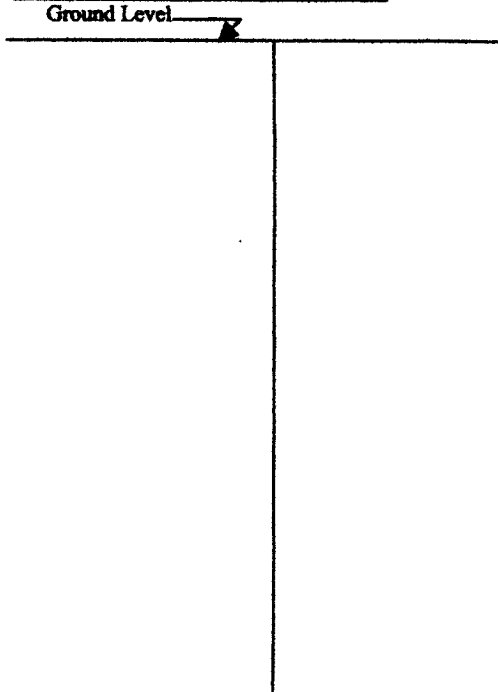

Description of formations encountered must be provided for all wells and boreholes, unless specifically exempted by regulations

Description of Formations Encountered	From (depth)	To (depth)
	Ground Level	
Clay	0	20
Sand	20	40
Gravel	40	60
Coarse Sand	60	71

If more than one screen, show location of each on sketch

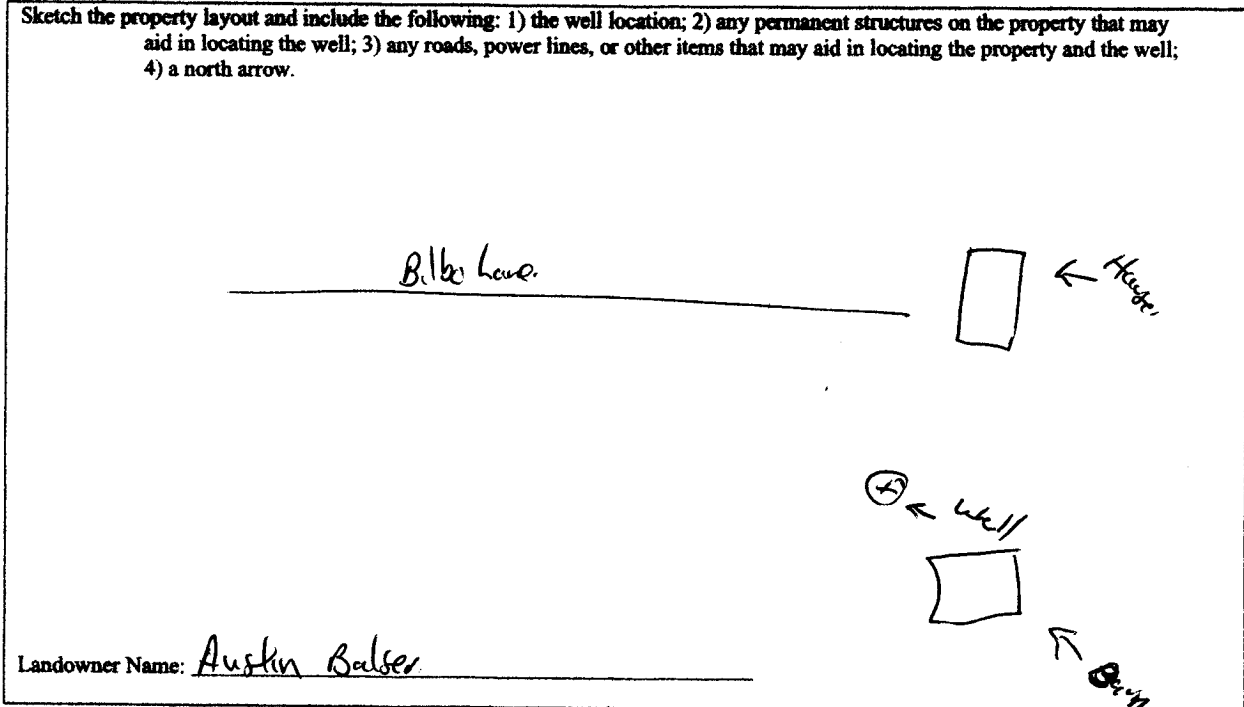

Landowner Name: Austin Balser

Form: OLWR-SWR-1A

I certify that the well/borehole was drilled, constructed, and completed in accordance with all applicable requirements of the Mississippi Department of Environmental Quality and the Mississippi Department of Health regulations, if applicable, and state laws.

Reel Stuyd 029 1-6-10 Reel Stuyd
 Print Name of Responsible Licensee and License No. Date Signature of Licensee

RECEIVED
 JAN 28 2010
 BY: OLWR

STATE WELL REPORT

Part 2

Pump Installer's Completion Report
 Mississippi Department of Environmental Quality
 Office of Land and Water Resources
 P.O. Box 10631
 Jackson, MS 39289-0631
 (601)961-5210
 (601)354-6938 (fax)

County: Pike
 Permit #: _____
 Driller: Fitzgerald Well Serv
 Date completed: 1-6-10
Copy information from block on Part 1

For Office Use Only:

Aquifer: 6176
 Well #: _____
 Elevation: _____

This part of the report must be completed by a licensed water well contractor or a licensed pump installer. A copy of Part 1 of the report must be attached and both parts filed with the Department at the above address within 30 days of well completion.

Well Owner Information	Well Location
Owner Name: <u>Austin Balsar</u>	Latitude: <u>31° 9' 22.1"</u> Longitude: <u>90° 28' 15.4"</u>
Mailing Address: <u>Billw Lane</u>	Method of Lat/Long (check one): Conventional Survey _____
<u>Madison MS</u>	USGS quad _____, Hand-held GPS _____, Survey-grade GPS _____
City State Zip Code	_____ 1/4 _____ 1/4 Sec _____ T _____ R _____
Telephone No. () _____	Distance Direction Nearest Town
	_____ Miles _____ of _____

Pump Type Circle one	Power Type Circle one
Air Lift Jet <u>Submersible</u>	Diesel Engine Gasoline Engine Natural Gas
Bucket Piston Turbine	<u>Electric Motor</u> Hand Tractor PTO
Centrifugal Rotary Flowing Well	Windmill Other (specify): _____
Other (specify): _____	Horse Power Rating of Motor: <u>1</u>
Date Pump Installed: <u>1-6-10</u>	Setting Depth: <u>60'</u> feet
Rated Pump Capacity: <u>20'</u> Gallons Per Minute	Number of Stages: <u>8</u>

Pump Test Data	Method of Measuring Water Level Circle one
Date Well Tested: _____	Air Line Electric Measuring Line <u>Steel Tape</u>
Static Water Level (A): _____ Feet Below Land Surface	Other (specify): _____
Pumping Water Level (B): _____ Feet Below Land Surface	For flowing well, measured shut in head: _____ feet
Drawdown [(B) - (A)]: _____ Feet Below Land Surface	Well yielded _____ GPM with a drawdown of _____ feet after _____ hours of pumping
Test Pumping Rate: _____ Gallons Per Minute	
Duration of Pump Test (minimum 4 hours): _____ hours	

I HEREBY CERTIFY that the above statements are true to the best of my knowledge.

Brad Fitzgerald 029 Paul Staley
 Print Name of Pump Installer and License No. (if applicable) Signature of Pump Installer

Form: OLWR-SWR-1B

RECEIVED

JAN 28 2010

BY: OLWR