

8A 21-15

State Well Report Part 1

Mississippi Department of Environmental Quality
Office of Land and Water Resources
P.O. Box 10631
Jackson, MS 39289-0631
(601)961-5210
(601)354-6938 (fax)

For Office Use Only:

Aquifer: D 273
Well #: _____
L. S. Elevation: _____
E-log #: _____

County: Pike
Permit #: _____
Driller: John W Thompson
Date drilling completed: 5-12-10

State Law requires that this report be prepared by the driller in detail and filed with the Department within 30 days of completion of drilling of the well.

Well Owner Information	Well Location
Owner Name: <u>Denbury Onshore</u>	Latitude: <u>31.12.44</u> " Longitude: <u>90.29.35</u> "
Mailing Address: <u>P.O. Box 6506</u> <u>Laurel MS</u>	Method of Lat/Long (circle one): <input type="checkbox"/> Conventional Survey, <input type="checkbox"/> USGS quad, <input type="checkbox"/> Hand-held GPS, <input type="checkbox"/> Survey-grade GPS
City: _____ State: _____ Zip Code: _____	<u>SE 1/4 NW 1/4 Sec 22</u> Twn <u>3N</u> Rng <u>7E</u>
Telephone No. () _____	Distance _____ Miles Direction <u>SW</u> of Nearest Town <u>McComb</u>

Well Data

Purpose of Well (circle one) Home Industrial Public Supply Irrigation Fish Culture Other: rig supply

Date well drilling started: 5-11-10 Date well drilling completed: 5-12-10

If flowing, method of flow regulation: Valve _____ Other (describe) _____

Static Water Level: 71 feet above or below (circle one) land surface Date measured: 5-12-10

Method of Measurement (circle one) steel tape electric tape air line other: _____

Hole depth: 163 Well depth: 150 Well grouted to a depth of 15 feet

Type of grout (circle one): Cement Bentonite Mix

Casing length: 130 feet Casing diameter: 4 inches Type of casing: PVC

Screen length: 20 feet Screen diameter: 4 inches Type of screen: PVC Slotted

Screen slot size: 0020 inches Setting depth: From 130 feet to 150 feet

Type of completion (circle all applicable): Gravel packed Underreamed Telescoped Open hole Natural Development

Other (describe): _____

Top of lap pipe or reduction in casing: _____ feet. If telescoped or more than one screen, describe on back of page

Logs run (circle all applicable): No log run Electric Gamma Ray Density Sonic Neutron Other: _____

Name of organization running log(s): _____

I certify that the well was drilled, constructed, and completed in accordance with all applicable requirements of the Mississippi Department of Environmental Quality and/or the Mississippi Department of Health regulations and state laws.

John W Thompson 0679
Print Name of Water Well Contractor License No. _____

John W Thompson
Signature of Water Well Contractor

RECEIVED
JUN 03 2010
BY: OLWR

RECEIVED
JUN 03 2010
BY: OLWR

RECEIVED
JUN 03 2010
BY: OLWR

If well telescopes please sketch below and show depths.

Ground Level _____

Description of Formations Encountered	From	To
sandy clay	0	40
sandy clay + gravel	40	80
sand + pea gravel	80	150
clay	150	163

If more than one screen, show location of each on sketch

Sketch the property layout and include the following: 1) the well location; 2) any permanent structures on the property that may aid in locating the well; 3) any roads, power lines, or other items that may aid in locating the property and the well; 4) indicate direction.

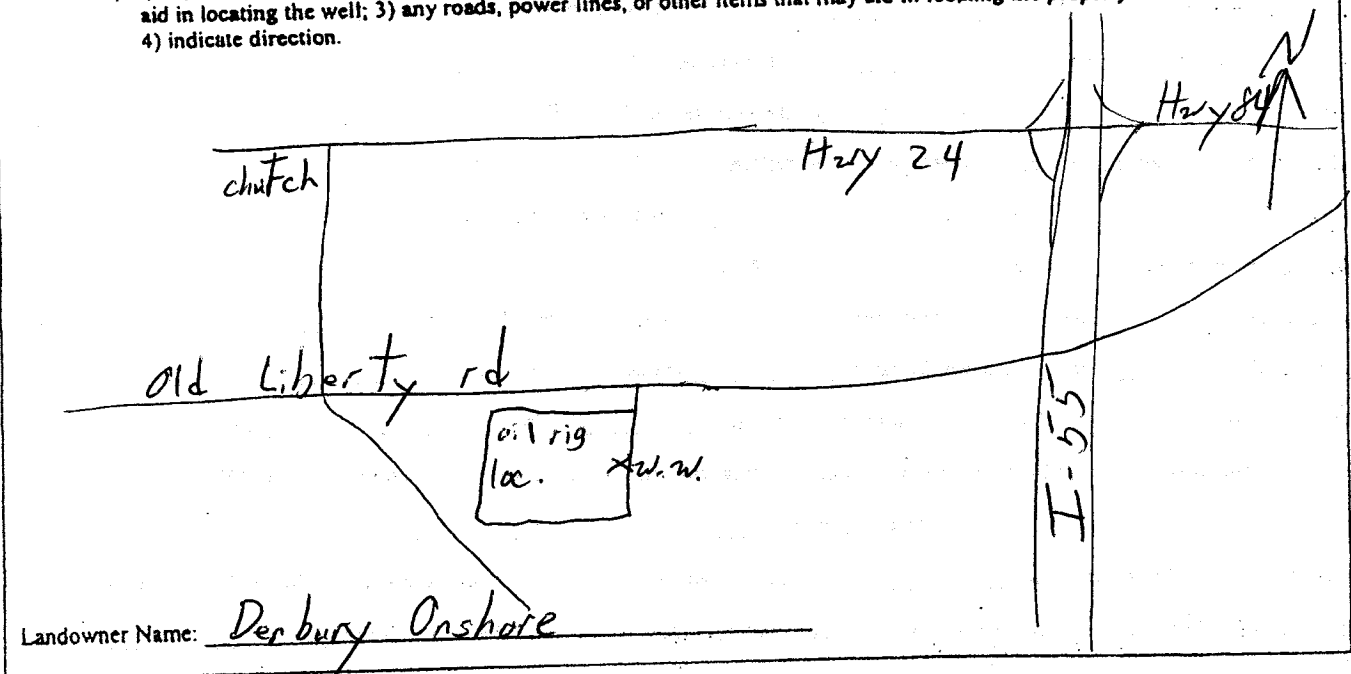

Landowner Name: Derbury Onshore

John W. Thompson
Signature of Water Well Contractor

STATE WELL REPORT

Part 2

Pump Installer's Completion Report
Mississippi Department of Environmental Quality
Office of Land and Water Resources
P.O. Box 10631
Jackson, MS 39289-0631
(601)961-5210
(601)354-6938 (fax)

For Office Use Only:

Aquifer: D273
Well #: _____
Elevation: _____

County: Pike
Permit #: _____
Driller: John W Thompson
Date completed: 5-12-10
Copy information from block on Part 1

This part of the report must be completed by a licensed water well contractor or a licensed pump installer. A copy of Part 1 of the report must be attached and both parts filed with the Department at the above address within 30 days of well completion.

Well Owner Information	Well Location
Owner Name: <u>Denbury Onshore</u>	Latitude: _____ Longitude: _____
Mailing Address: <u>P.O. Box 6506</u> <u>Laurel MS</u>	Method of Lat/Long (check one): Conventional Survey _____ USGS quad _____, Hand-held GPS _____, Survey-grade GPS _____
City _____ State _____ Zip Code _____	_____ 1/4 _____ 1/4 Sec <u>22</u> T <u>3N</u> R <u>7E</u>
Telephone No. () _____	Distance _____ Direction _____ Nearest Town _____ <u>2</u> Miles <u>SW</u> of <u>McComb</u>

Pump Type Circle one	Power Type Circle one
Air Lift Jet <u>Submersible</u>	Diesel Engine Gasoline Engine Natural Gas
Bucket Piston Turbine	<u>Electric Motor</u> Hand Tractor PTO
Centrifugal Rotary Flowing Well	Windmill Other (specify): _____
Other (specify): _____	Horse Power Rating of Motor: <u>5</u>
Date Pump Installed: <u>5-12-10</u>	Setting Depth: <u>120</u> feet
Rated Pump Capacity: <u>85</u> Gallons Per Minute	Number of Stages: _____

Pump Test Data	Method of Measuring Water Level Circle one
Date Well Tested: <u>5-12-10</u>	Air Line <u>Electric Measuring Line</u> Steel Tape
Static Water Level (A): <u>71</u> Feet Below Land Surface	Other (specify): _____
Pumping Water Level (B): <u>78</u> Feet Below Land Surface	For flowing well, measured shut in head: _____ feet
Drawdown [(B) - (A)]: <u>7</u> Feet Below Land Surface	Well yielded <u>50</u> GPM with a drawdown of
Test Pumping Rate: <u>50</u> Gallons Per Minute	<u>7</u> feet after <u>4</u> hours of pumping
Duration of Pump Test (minimum 4 hours): <u>4</u> hours	

I HEREBY CERTIFY that the above statements are true to the best of my knowledge.

John W Thompson 0-679
Print Name of Pump Installer and License No. (if applicable)

John W Thompson
Signature of Pump Installer

Form: OLWR-SWR-1B

RECEIVED

JUN 03 2010

BY: OLWR