

M.F.U. 23-6

State Well Report Part 1

Mississippi Department of Environmental Quality
Office of Land and Water Resources
P.O. Box 10631
Jackson, MS 39289-0631
(601)961-5210
(601)354-6938 (fax)

County: Pike
 Permit #: _____
 Driller: John W Thompson
 Date drilling completed: 8-8-07

For Office Use Only:
 Aquifer: _____
 Well #: D-254
 L. S. Elevation: _____
 E-log #: _____

State Law requires that this report be prepared by the driller in detail and filed with the Department within 30 days of completion of drilling of the well.

Well Owner Information	Well Location
Owner Name: <u>Denbury Onshore</u>	Latitude: _____ Longitude: _____
Mailing Address: <u>P.O. Box 6506</u> <u>Laurel MS</u>	Method of Lat/Long (circle one): Conventional Survey, USGS quad, Hand-held GPS, Survey-grade GPS
City: _____ State: _____ Zip Code: _____	_____ 1/4 _____ 1/4 Sec <u>23</u> Twn <u>3N</u> Rng <u>7E</u>
Telephone No. (____) _____	Distance _____ Direction _____ Nearest Town _____ _____ Miles <u>5</u> of <u>McCarr</u>

Well Data

Purpose of Well (circle one) Home Industrial Public Supply Irrigation Fish Culture Other: rig supply

Date well drilling started: 8-8-07 Date well drilling completed: 8-8-07

If flowing, method of flow regulation: Valve _____ Other (describe) _____

Static Water Level: 41 feet above or below (circle one) land surface Date measured: 8-8-07

Method of Measurement (circle one) steel tape electric tape air line other: _____

Hole depth: 90 Well depth: 80 Well grouted to a depth of 20 feet

Type of grout (circle one): Cement Bentonite Mix

Casing length: 60 feet Casing diameter: 4 inches Type of casing: PVC

Screen length: 20 feet Screen diameter: 4 inches Type of screen: PVC Slotted

Screen slot size: .020 inches Setting depth: From 60 feet to 80 feet

Type of completion (circle all applicable): Gravel packed Underreamed Telescoped Open hole Natural Development

Other (describe): _____

Top of lap pipe or reduction in casing: _____ feet. If telescoped or more than one screen, describe on back of page

Logs run (circle all applicable): No log run Electric Gamma Ray Density Sonic Neutron Other: _____

Name of organization running log(s): _____

I certify that the well was drilled, constructed, and completed in accordance with all applicable requirements of the Mississippi Department of Environmental Quality and/or the Mississippi Department of Health regulations and state laws.

John W Thompson 0-679 John W Thompson
 Print Name of Water Well Contractor and License No. Signature of Water Well Contractor

RECEIVED
 AUG 20 2007
 BY: OLWR

D-254

If well telescopes please sketch below and show depths.

Ground Level

--	--

Description of Formations Encountered	From	To
clay	0	20
sand & gravel	20	80
clay	80	90

If more than one screen, show location of each on sketch

Sketch the property layout and include the following: 1) the well location; 2) any permanent structures on the property that may aid in locating the well; 3) any roads, power lines, or other items that may aid in locating the property and the well; 4) indicate direction.

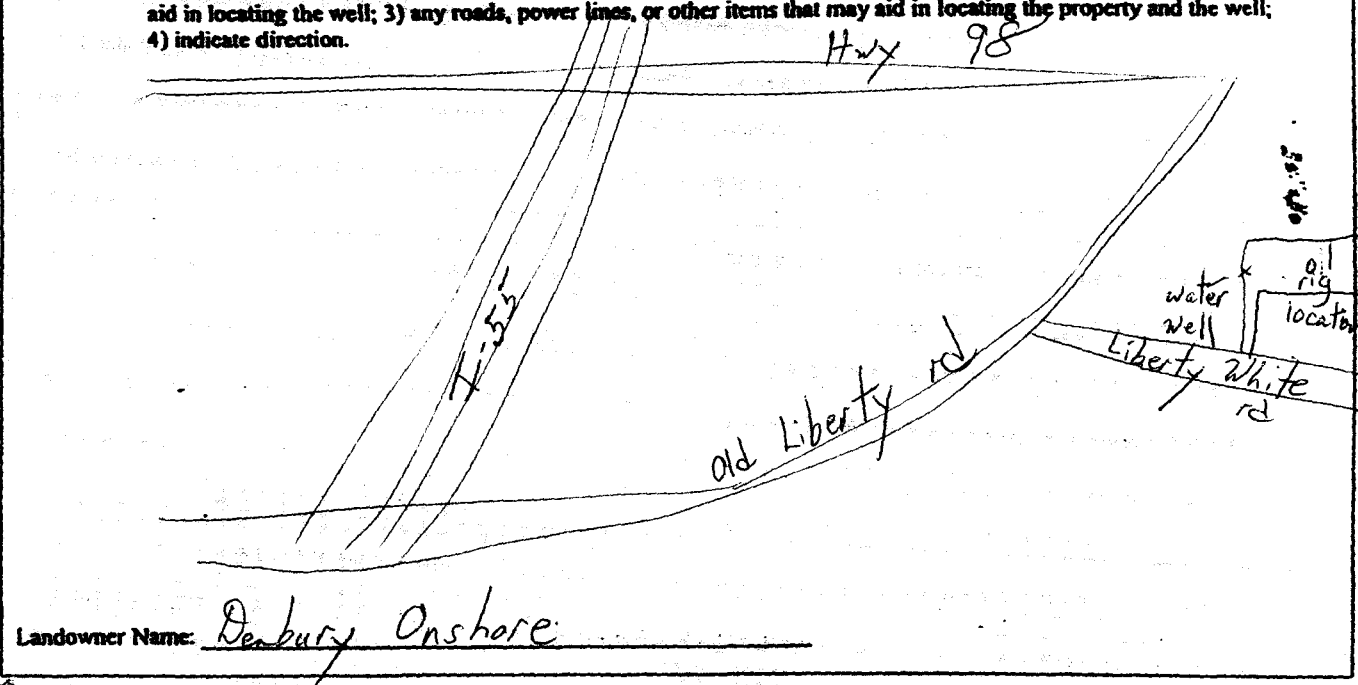

Landowner Name: Deebury Onshore

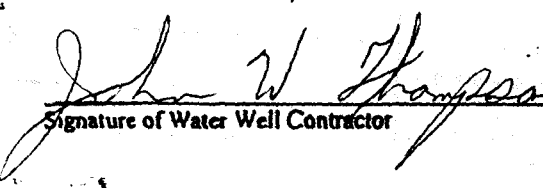

Signature of Water Well Contractor

STATE WELL REPORT

Part 2

Pump Installer's Completion Report
 Mississippi Department of Environmental Quality
 Office of Land and Water Resources
 P.O. Box 10631
 Jackson, MS 39289-0631
 (601)961-5210
 (601)354-6938 (fax)

For Office Use Only:

Aquifer: _____

Well #: D-254

Elevation: _____

County: Pike
 Permit #: _____
 Driller: John W Thompson
 Date completed: 8-8-07

This report should be prepared by the pump installer in detail and filed with the Department within 30 days of the installation of pump.

Well Owner Information	Well Location
Owner Name: <u>Denbury Onshore</u>	Latitude: _____ Longitude: _____
Mailing Address: <u>P.O. Box 6506</u>	Method of Lat/Long (circle one): <input type="radio"/> Conventional Survey,
<u>Laurel MS</u>	<input type="radio"/> USGS quad, <input type="radio"/> Hand-held GPS, <input type="radio"/> Survey-grade GPS
City State Zip Code	_____ 1/4 _____ 1/4 Sec <u>23</u> Twn <u>3N</u> Rng <u>7E</u>
Telephone No. () _____	Distance Direction Nearest Town
	<u>1</u> Miles <u>S</u> of <u>McComb</u>

Pump Type Circle one	Power Type Circle one
<input type="checkbox"/> Air Lift <input type="checkbox"/> Jet <input checked="" type="checkbox"/> <u>Submersible</u> <input type="checkbox"/> Bucket <input type="checkbox"/> Piston <input type="checkbox"/> Turbine <input type="checkbox"/> Centrifugal <input type="checkbox"/> Rotary <input type="checkbox"/> Flowing Well Other (specify): _____ Date Pump Installed: <u>8-8-07</u> Rated Pump Capacity: <u>35</u> Gallons Per Minute	<input type="checkbox"/> Diesel Engine <input type="checkbox"/> Gasoline Engine <input type="checkbox"/> Natural Gas <input type="checkbox"/> Electric Motor <input type="checkbox"/> Hand <input type="checkbox"/> Tractor PTO <input type="checkbox"/> Windmill Other (specify): _____ Horse Power Rating of Motor: <u>3</u> Setting Depth: <u>60</u> feet Number of Stages: _____

Pump Test Data	Method of Measuring Water Level Circle one
Date Well Tested: <u>8-8-07</u>	<input type="checkbox"/> Air Line <input checked="" type="checkbox"/> <u>Electric Measuring Line</u> <input type="checkbox"/> Steel Tape Other (specify): _____
Static Water Level (A): <u>41</u> Feet Below Land Surface	For flowing well, measured shut in head: _____ feet
Pumping Water Level (B): <u>48</u> Feet Below Land Surface	Well yielded <u>35</u> GPM with a drawdown of
Drawdown ((B) - (A)): <u>7</u> Feet Below Land Surface	<u>7</u> feet after <u>4</u> hours of pumping
Test Pumping Rate: <u>35</u> Gallons Per Minute	
Duration of Pump Test (minimum 4 hours): <u>4</u> hours	

I HEREBY CERTIFY that the above statements are true to the best of my knowledge.

John W Thompson 0-679 John W Thompson
 Print Name of Pump Installer and License No. (if applicable) Signature of Pump Installer

RECEIVED

AUG 20 2007

BY: OLWR