

STATE WELL REPORT

Part 1

Driller's Log

Mississippi Department of Environmental Quality
Office of Land and Water Resources
P.O. Box 2309
Jackson, MS 39225-2309
(601)961-5210
(601)360-0535 (fax)

For Office Use Only:

Well #: U14C
Aquifer: _____
E-Log #: _____

County: Pike
Permit #: _____
Driller: Fitzgerald Well Service
Date drilling completed: 12-24-13

State Law requires that this report be prepared by the license holder responsible for the work and filed with the Department at the above address within 30 days of completion of drilling of the well or borehole.

Well Owner Information (Landowner if borehole is not for a water well)	Well or Borehole Location
Owner Name: <u>Gene Shartkey</u>	Latitude: <u>31°16'14.5"</u> Longitude: <u>90°16'37.4"</u>
Mailing Address: <u>Eric Price Rd</u>	Method of Lat/Long (check one): Conventional Survey _____, USGS quad _____, Hand-held GPS _____, Survey-grade GPS _____
<u>Tylahomy</u> <u>ms.</u> City State Zip Code	<u>SW 1/4 NW 1/4, Sec 35 T4N R9E</u>
Telephone No. (____) _____	____ Miles ____ of ____ (Distance) (Direction) (Nearest Town)

Well / Borehole Data	
Date drilling started: <u>12-24-13</u> Date drilling completed: <u>12-24-13</u> Hole depth: <u>130'</u> Hole diameter: <u>8"</u>	
Location of the source of any surface water used for drilling: _____	
Method of dosing and volume of Chlorine used in drilling and development: _____	
Logs run (circle all applicable): <u>No log run</u> Electric Gamma Ray Density Sonic Neutron Other: _____	
Name of organization running log(s): _____	
Purpose of borehole (circle one): <u>Water Well</u> Geotechnical/Geological Investigation Ground Source Heat Pump Seismic Survey Other (describe) _____	
<i>If drilling is not related to water well construction, skip the remainder of this block</i>	
Purpose of Well (circle all applicable): <u>Home</u> Industrial Public Supply Irrigation Fish Culture	
Other (describe): _____	
If a flowing well, method of flow regulation: Valve _____ Other (describe) _____	
Static Water Level: <u>100'</u> feet [above or below] land surface Date measured: <u>12-23-13</u> (circle one)	
Method of measurement (circle one): Steel tape <u>Electric tape</u> Air line Other (describe): _____	
Well depth: <u>130'</u> Well grouted to a depth of: <u>10'</u> feet Type of grout (circle one): <u>Neat Cement</u> Bentonite Mix	
Casing length: <u>120'</u> feet Casing diameter: <u>4"</u> inches Type of casing: <u>Pvc</u>	
Screen length: <u>10'</u> feet Screen diameter: <u>4"</u> inches Type of screen: <u>Pvc</u>	
Screen slot size: <u>.010</u> inches Setting depth: From <u>120'</u> feet to <u>130'</u> feet	
Type of completion (circle all applicable): <u>Gravel packed</u> Underreamed Open hole Natural Development	
Other (describe): _____	
Top of lap pipe or reduction in casing: _____ feet	

If telescoped or more than one screen, describe on next page

RECEIVED
BY: OIWR

County: Pike
 Permit #: _____

For Office Use Only:
 Well #: 0140

The sketch below only required for water wells
If well telescopes, show depths on sketch.

Description of formations encountered must be provided for all wells
and boreholes, unless specifically exempted by regulations

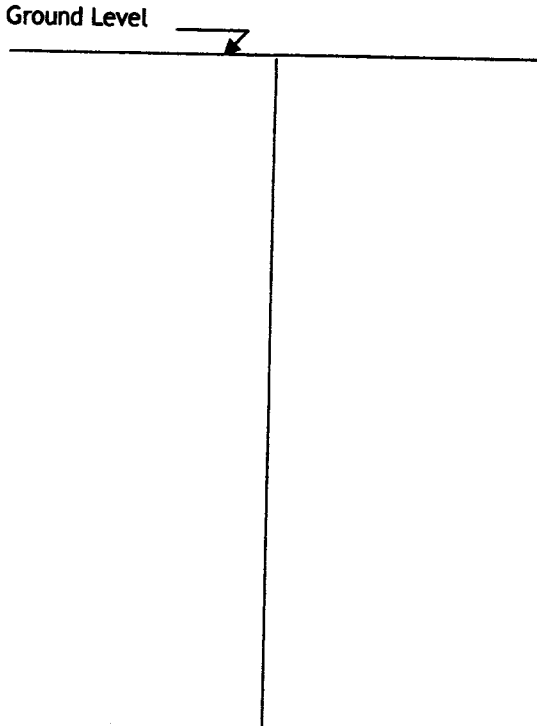

Description of Formations Encountered	From (depth) Ground level	To (depth)
clay	0	20
clavel	20	60
clay	60	80
Sand	80	100
clavel	100	120
Curve Sand	120	130

If more than one screen, show location of each on sketch

Sketch the property layout and include the following:

- 1) the well location
- 2) any permanent structures on the property that may aid in locating the well
- 3) any roads, power lines, or other items that may aid in locating the property and the well
- 4) north arrow

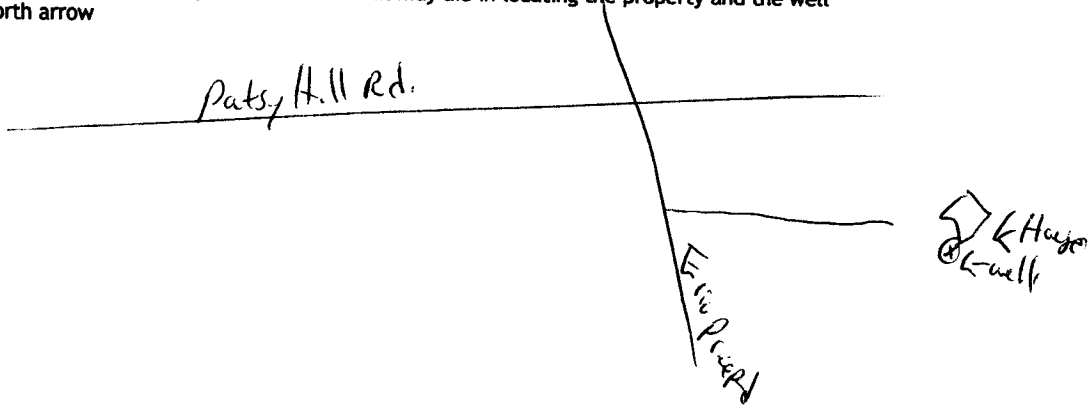

Landowner Name: Gene Shurtley

I HEREBY CERTIFY that the well/borehole was drilled, constructed, and completed in accordance with all applicable requirements of the Mississippi Department of Environmental Quality and the Mississippi Department of Health regulations, if applicable, and state laws.

Brad Fitzgerald 029. 12-23-13. Red Staff
 Print Name of Responsible Licensee and License No. Date Signature of Licensee

STATE WELL REPORT

Part 2

Pump Installer's Completion Report
 Mississippi Department of Environmental Quality
 Office of Land and Water Resources
 P.O. Box 2309
 Jackson, MS 39225-2309
 (601)961-5210
 (601) 360-0535 (fax)

For Office Use Only:

Well #: 0140
 Aquifer: _____

County: Pike
 Permit #: _____
 Driller: Fitzgerald Well Service
 Date completed: 12-24-13
Copy information from block on Part 1

This part of the report must be completed by a licensed water well contractor or a licensed pump installer. A copy of Part 1 of the report must be attached and both parts filed with the Department at the above address within 30 days of well completion.

Well Owner Information	Well Location
Owner Name: <u>Gene Shurkey</u>	Latitude: <u>31°16'14.5"</u> Longitude: <u>90°16'37.4"</u>
Mailing Address: <u>Eric Pire Rd</u>	Method of Lat/Long (check one): Conventional Survey _____, USGS quad _____, Hand-held GPS _____, Survey-grade GPS _____
<u>Tylertown</u> <u>MS</u> City State Zip Code	_____ 1/4 _____ 1/4, Sec _____ T _____ R _____
Telephone No. () _____	_____ Miles _____ of _____ (Distance) (Direction) (Nearest Town)

Pump Type (circle one)

Submersible Turbine Air Lift Centrifugal Flowing Well Jet Piston Rotary Other (describe): _____

Date Pump Installed: 12-24-13 Rated Pump Capacity: 12 Gallons Per Minute

Is This Pump (circle one): New Repaired Replacement

Power Type (circle one)

Electric Diesel Gasoline Natural Gas Tractor PTO Windmill Other (describe): _____

Horse Power Rating of Motor: 3/4 Setting Depth: 125 feet Number of Stages: 12

Pump Test Data for Non Flowing Well

Date Well Tested: _____ Duration of Pump Test (minimum 4 hours): _____ hours

Static Water Level (A): _____ Feet Below Land Surface Pumping Water Level (B): _____ Feet Below Land Surface

Drawdown [(B) - (A)]: _____ Feet Below Land Surface Test Pumping Rate: _____ Gallons Per Minute

Method of measurement (circle one): Steel tape Electric tape Air line Other (describe): _____

Pump Test Data for Flowing Well

Measured shut in head: _____ feet.

Well yielded _____ GPM with a drawdown of _____ feet after _____ hours of pumping

Meter Installation

Meter Manufacturer: _____ Meter Serial Number: _____

Meter Model Number/Name: _____ Type of Meter: _____

Totalizer Register Unit and Multiplier Factor (AF x .001, gal x 1000, etc): _____

Installation Date: _____ Meter installed by: _____

Is This Meter (circle one): New Repaired Replacement

RECEIVED

BY: OLWR

Important: By submitting the above information you are certifying that this meter was installed to manufacturer standards. For agricultural wells, a list of approved meters is on the MDEQ website.

I HEREBY CERTIFY that the above statements are true to the best of my knowledge.

Brian Fitzgerald 029 12-24-13 Ral [Signature]
 Print Name of Pump Installer and License No. (if applicable) Date Signature of Pump Installer