

Permit never received 4/13

County: Pike  
 Permit #: \_\_\_\_\_  
 Driller: 0-808  
 Date drilling completed: 4-1-09

**State Well Report**  
**Part 1 - Driller's Log**

Mississippi Department of Environmental Quality  
 Office of Land and Water Resources  
 P.O. Box 2307  
 Jackson, MS 39225  
 (601)961- 5210  
 (601)961- 5228 (fax)

**For Office Use Only:**  
 Aquifer: \_\_\_\_\_  
 Well #: B-218  
 L. S. Elevation: \_\_\_\_\_  
 E-log #: \_\_\_\_\_

*State Law requires that this report be prepared by the license holder responsible for the work and filed with the Department at the above address within 30 days of completion of drilling of the well or borehole.*

<p><b>Information on Well Owner</b>  <i>(Landowner if borehole is not for a water well)</i></p> <p>Owner Name <u>Southwest miss. Community College</u>          Mailing Address: <u>1156 College Dr.</u>  <u>Summit ms 39666</u>          City State Zip Code          Telephone No. <u>(601) 276-2000</u></p>	<p><b>Well or Borehole Location</b></p> <p>Latitude: <u>31°17'19"</u> Longitude: <u>90°26'36"</u>          Method of Lat/Long (circle one): Conventional Survey,          USGS quad, <u>Hand-held GPS</u> Survey-grade GPS  <u>NW 1/4 NW 1/4</u> Sec <u>30</u> Twn <u>4N</u> Rng <u>8E</u>          Distance Direction Nearest Town  <u>2</u> Miles <u>NE</u> of <u>Summit, ms.</u></p>
--	---

**Well / Borehole Data**

Date drilling started: 3-31-09 Date drilling completed: 4-1-09 Hole depth: 195' Hole diameter: 7 7/8"

Location of the source of any surface water used for drilling: none  
 Method of dosing and volume of Chlorine used in drilling and development: \_\_\_\_\_

Logs run (circle all applicable): No log run Electric Gamma Ray Density Sonic Neutron Other: \_\_\_\_\_  
 Name of organization running log(s): \_\_\_\_\_

Purpose of borehole (check one): Water Well  Geotechnical/Geological Investigation \_\_\_\_\_ Ground Source Heat Pump \_\_\_\_\_  
 Seismic Survey \_\_\_\_\_ Other (describe) \_\_\_\_\_

*If drilling is not related to water well construction, skip the remainder of this block*

Purpose of Well (check one): Home \_\_\_\_\_ Industrial  Public Supply \_\_\_\_\_ Irrigation \_\_\_\_\_ Fish Culture \_\_\_\_\_ Other: \_\_\_\_\_

If a flowing well, method of flow regulation: Valve \_\_\_\_\_ Other (describe) \_\_\_\_\_

Static Water Level: 40' feet above or below (circle one) land surface Date measured: 4-1-09

Method of Measurement (circle one) steel tape electric tape air line other: \_\_\_\_\_

Well depth: 195' Well grouted to a depth of 170' feet Type of grout (circle one): Neat Cement Bentonite Mix

Casing length: 180' feet Casing diameter: 4" inches Type of casing: PVC sch 40

Screen length: 15' feet Screen diameter: 4" inches Type of screen: PVC slot sch 40

Screen slot size: .010 inches Setting depth: From 180' feet to 195' feet

Type of completion (circle all applicable): Gravel packed Underreamed Telescoped Open hole Natural Development  
 Other (describe): \_\_\_\_\_

Top of lap pipe or reduction in casing: \_\_\_\_\_ feet. *If telescoped or more than one screen, describe on next page*

Form: OLWR-SWR-1A (04/08)

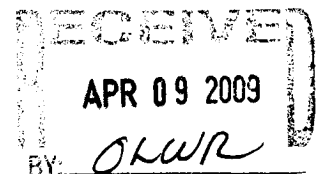

B-218

The sketch below only required for water wells

If well telescopes, show depths on sketch.

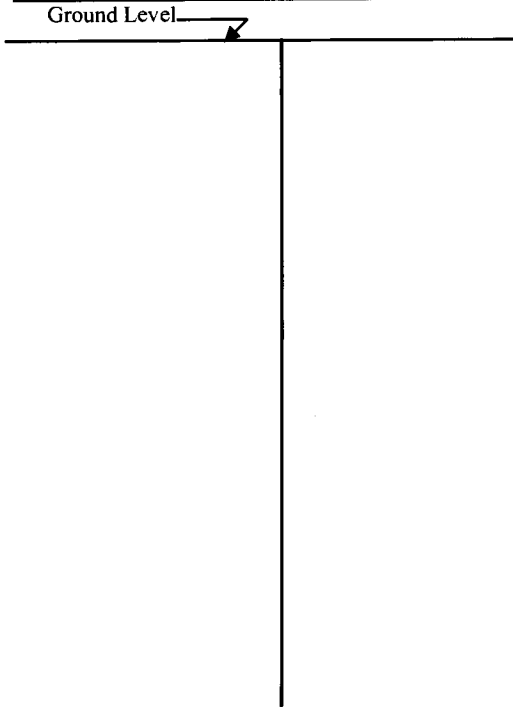

Description of formations encountered must be provided for all wells and boreholes, unless specifically exempted by regulations

Description of Formations Encountered	From (depth)	To (depth)
red clay	Ground Level	18'
sand w/ pea gravel	18'	45'
sand	45'	108'
white clay	108'	125'
coarse sand	125'	195'

If more than one screen, show location of each on sketch

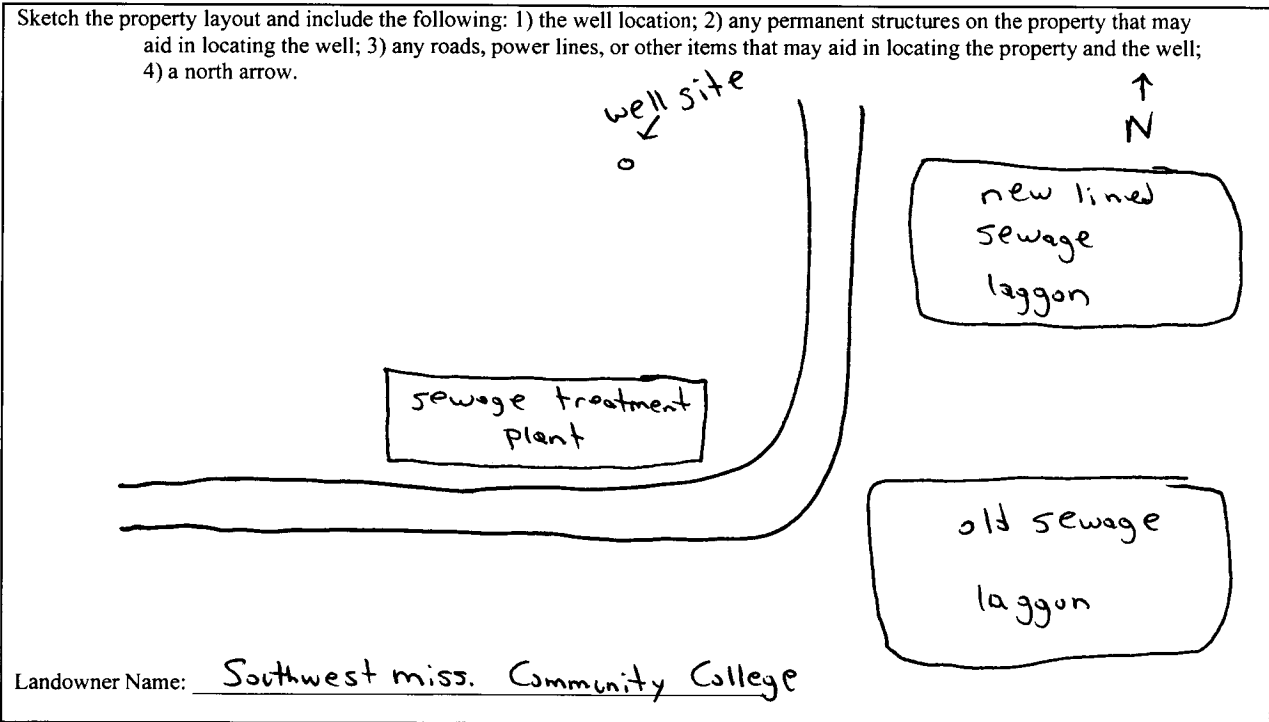

Form: OLWR-SWR-1A (04/08)

I certify that the well/borehole was drilled, constructed, and completed in accordance with all applicable requirements of the Mississippi Department of Environmental Quality and the Mississippi Department of Health regulations, if applicable, and state laws.

Print Name of Responsible Licensee and License No. Clinton Dunn 0-808

Date 4-1-09

Signature of Licensee Clinton Dunn

RECEIVED  
APR 09 2009  
BY: OWWR