

State Well Report

Part 1

Mississippi Department of Environmental Quality
Office of Land and Water Resources
P.O. Box 10631
Jackson, MS 39289-0631
(601)961-5210
(601)354-6938 (fax)

For Office Use Only:

Aquifer: _____
Well #: R-26 111
L. S. Elevation: _____
E-log #: _____

County: Perry

Permit #: _____

Driller: Coast Water Wells Inc

Date drilling completed: 8-26-04

State Law requires that this report be prepared by the driller in detail and filed with the Department within 30 days of completion of drilling of the well.

Well Owner Information	Well Location
Owner Name: <u>Kay Webb</u>	Latitude: <u>30.54.837</u> " Longitude: <u>088.56.291</u> "
Mailing Address: <u>980 Bendale Road</u>	Method of Lat/Long (circle one): Conventional Survey,
<u>Wiggins MS 39577</u>	USGS quad, (<u>Hand-held GPS</u>), Survey-grade GPS
City State Zip Code	<u>SE</u> <u>SW</u> <u>1/4</u> <u>SE</u> <u>1/4</u> Sec <u>36</u> Twn <u>T15</u> Rng <u>R10W</u>
Telephone No. <u>(601) 598-2752</u>	Distance Direction Nearest Town
	<u>11</u> Miles <u>NW</u> of <u>BENDALE</u>

Well Data

Purpose of Well (circle one) Home Industrial Public Supply Irrigation Fish Culture Other: _____

Date well drilling started: 8-25-04 Date well drilling completed: 8-26-04

If flowing, method of flow regulation: Valve N/A Other (describe) _____

Static Water Level: 55 feet above or below (circle one) land surface Date measured: 8-26-04

Method of Measurement (circle one) steel tape electric tape air line other: _____

Hole depth: 397' Well depth: 397' Well grouted to a depth of 10 feet

Type of grout (circle one): Cement Bentonite Mix

Casing length: 387 feet Casing diameter: 2 inches Type of casing: PVC

Screen length: 10 feet Screen diameter: 2 inches Type of screen: PVC

Screen slot size: .008 inches Setting depth: From 387 feet to 397 feet

Type of completion (circle all applicable): Gravel packed Underreamed Telescoped Open hole Natural Development

Other (describe): _____

Top of lap pipe or reduction in casing: _____ feet. If telescoped or more than one screen, describe on back of page

Logs run (circle all applicable): No log run Electric Gamma Ray Density Sonic Neutron Other: _____

Name of organization running log(s): _____

RECEIVED
SEP 16 2004
BY: OLWR

I certify that the well was drilled, constructed, and completed in accordance with all applicable requirements of the Mississippi Department of Environmental Quality and/or the Mississippi Department of Health regulations and state laws.

JACK RIDGDELL 0-472
Print Name of Water Well Contractor and License No.

[Signature]
Signature of Water Well Contractor

R-26

If well telescopes please sketch below and show depths.

Ground Level

--

Description of Formations Encountered	From	To
Top Soil	0	2
Orange Clay	2	17
White Coarse Sand	17	40
Blue Clay	40	315
Gray Low Medium Sand	315	333
Blue Clay	333	377
Gray Coarse Sand	377	397

If more than one screen, show location of each on sketch

Sketch the property layout and include the following: 1) the well location; 2) any permanent structures on the property that may aid in locating the well; 3) any roads, power lines, or other items that may aid in locating the property and the well; 4) indicate direction.

RECEIVED
 SEP 16 2004
 BY: OLWR

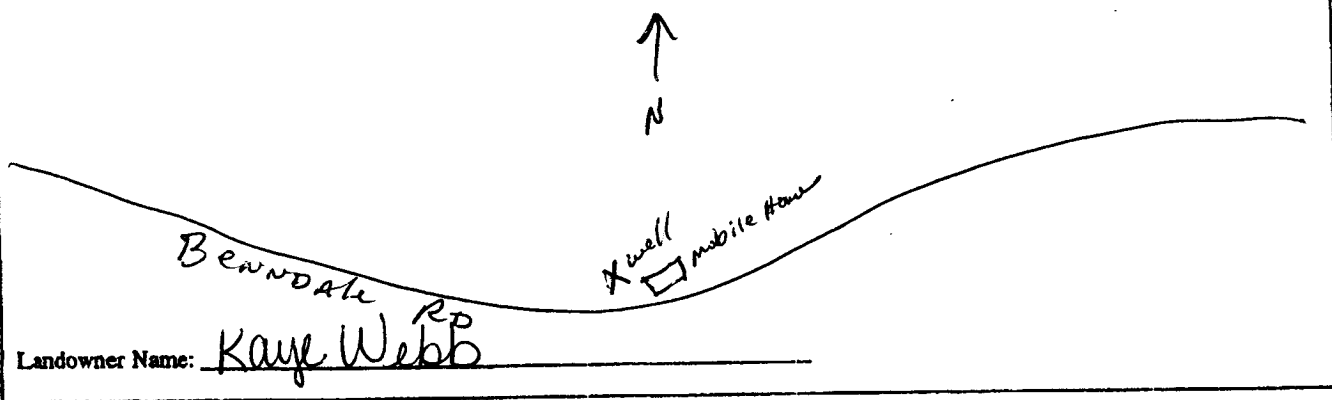

Jack Ridgell
 Signature of Water Well Contractor

STATE WELL REPORT

Part 2

Pump Installer's Completion Report
Mississippi Department of Environmental Quality
Office of Land and Water Resources
P.O. Box 10631
Jackson, MS 39289-0631
(601)961-5210
(601)354-6938 (fax)

For Office Use Only:

Aquifer: _____

Well #: R-26

Elevation: _____

County Perry

Permit #: _____

Driller: Coast Water Well Serv

Date completed: 8-26-04

This report should be prepared by the pump installer in detail and filed with the Department within 30 days of the installation of pump.

Well Owner Information	Well Location
Owner Name: <u>Kaye Webb</u>	Latitude: <u>30° 54.837"</u> Longitude: <u>088° 56.299"</u>
Mailing Address: <u>980 Bendale Road</u>	Method of Lat/Long (circle one): Conventional Survey,
<u>Wiggins MS 39577</u>	USGS quad, Hand-held GPS, Survey-grade GPS
City State Zip Code	<u>8W 1/4 SE 1/4 Sec 36 Twn 11 S Rng R10 W</u>
Telephone No. <u>(601) 598-2752</u>	Distance Direction Nearest Town <u>11 Miles NW of BENDALE</u>

Pump Type Circle one	Power Type Circle one
Air Lift <input checked="" type="radio"/> Jet Submersible	Diesel Engine Gasoline Engine Natural Gas
Bucket <input type="radio"/> Piston <input type="radio"/> Turbine	<input checked="" type="radio"/> Electric Motor Hand Tractor PTO
Centrifugal <input type="radio"/> Rotary <input type="radio"/> Flowing Well	Windmill Other (specify): _____
Other (specify): <u>1 HP</u>	Horse Power Rating of Motor: <u>1 HP</u>
Date Pump Installed: <u>8-27-04</u>	Setting Depth: <u>80' Deep pipe</u> feet
Rated Pump Capacity: <u>7.5</u> Gallons Per Minute	Number of Stages: <u>2</u>

RECEIVED
SEP 16 2004
BY: OLWR

Pump Test Data	Method of Measuring Water Level Circle one
Date Well Tested: <u>8-27-04</u>	<input checked="" type="radio"/> Air Line <input type="radio"/> Electric Measuring Line <input type="radio"/> Steel Tape
Static Water Level (A): <u>55'</u> Feet Below Land Surface	Other (specify): _____
Pumping Water Level (B): <u>N/A</u> Feet Below Land Surface	For flowing well, measured shut in head: <u>N/A</u> feet
Drawdown [(B) - (A)]: <u>N/A</u> Feet Below Land Surface	Well yielded <u>7.5</u> GPM with a drawdown of
Test Pumping Rate: <u>7.5</u> Gallons Per Minute	<u>N/A</u> feet after <u>N/A</u> hours of pumping
Duration of Pump Test (minimum 4 hours): <u>4</u> hours	

I HEREBY CERTIFY that the above statements are true to the best of my knowledge.

David Mays
Print Name of Pump Installer and License No. (if applicable)

David Mays
Signature of Pump Installer