

State Well Report

Part 1 - Driller's Log

Mississippi Department of Environmental Quality
 Office of Land and Water Resources
 P.O. Box 2307
 Jackson, MS 39225
 (601)961- 5210
 (601)961- 5228 (fax)

County: PANOLA
 Permit #: MS 00-10551
 Driller: Parks & Parks
 Date drilling completed: 9/20/09

For Office Use Only:
 Aquifer: _____
 Well #: NCC55
 L. S. Elevation: _____
 E-log #: _____

State Law requires that this report be prepared by the license holder responsible for the work and filed with the Department at the above address within 30 days of completion of drilling of the well or borehole.

Information on Well Owner <i>(Landowner if borehole is not for a water well)</i>	Well or Borehole Location
Owner Name: <u>HOTOPIA WATER ASSO.</u>	Latitude: <u>34° 22' 31"</u> Longitude: <u>89° 50' 39"</u>
Mailing Address: <u>1667 Hudson Rd</u> <u>Batesville, MS 38606</u>	Method of Lat/Long (circle one): Conventional Survey, USGS quad, Hand-held GPS, Survey-grade GPS
City: _____ State: _____ Zip Code: _____	<u>SW 1/4 NW 1/4</u> Sec <u>21</u> Twn <u>85</u> Rng <u>6W</u>
Telephone No. <u>(662) 563-7867</u>	Distance <u>14</u> Miles Direction <u>NW</u> of Nearest Town <u>Batesville</u>

Well / Borehole Data

Date drilling started: 3/1/09 Date drilling completed: 9/20/09 Hole depth: 940 Hole diameter: 12x8

Location of the source of any surface water used for drilling: _____
 Method of dosing and volume of Chlorine used in drilling and development: 5PPM

Logs run (circle all applicable): No log run Electric Gamma Ray Density Sonic Neutron Other: _____
 Name of organization running log(s): _____

Purpose of borehole (check one): Water Well Geotechnical/Geological Investigation Ground Source Heat Pump
 Seismic Survey Other (describe) _____

If drilling is not related to water well construction, skip the remainder of this block

Purpose of Well (check one): Home Industrial Public Supply Irrigation Fish Culture Other: _____

If a flowing well, method of flow regulation: Valve _____ Other (describe) _____

Static Water Level: 169 feet above or below (circle one) land surface Date measured: 9/28/09

Method of Measurement (circle one) steel tape electric tape air line other: _____

Well depth: 940 Well grouted to a depth of 825 feet Type of grout (circle one): Neat Cement Bentonite Mix

Casing length: 875 feet Casing diameter: 12 inches Type of casing: Steel

Screen length: 60 feet Screen diameter: 8 inches Type of screen: STAINLESS STEEL

Screen slot size: .016 inches Setting depth: From 880 feet to 940 feet

Type of completion (circle all applicable): Gravel packed Underreamed Telescoped Open hole Natural Development
 Other (describe): _____

Top of lap pipe or reduction in casing: 820 feet. *If telescoped or more than one screen, describe on next page*

The sketch below only required for water wells

If well telescopes, show depths on sketch.

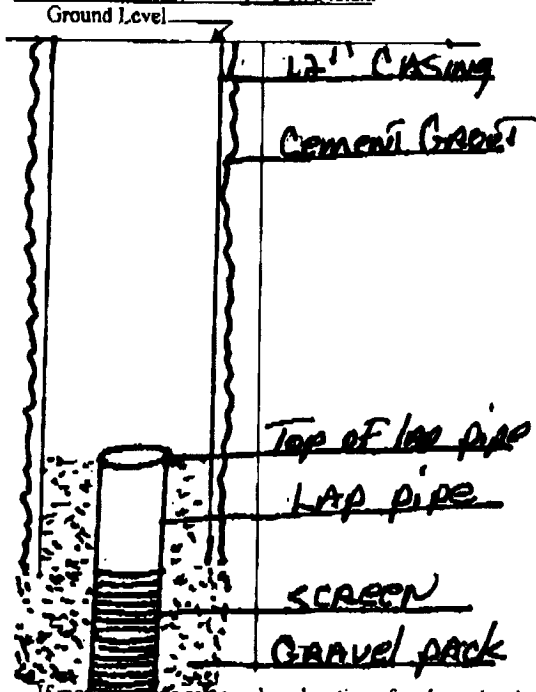

(If more than one screen, show location of each on sketch)

Description of formations encountered must be provided for all wells and boreholes, unless specifically exempted by regulations

Description of Formations Encountered	From (depth)	To (depth)
	Ground Level	
SAND + GRAVEL	0	121
SAND + SHALL	121	480
CLAY + Shell w/ SAND	480	926
SAND	926	960

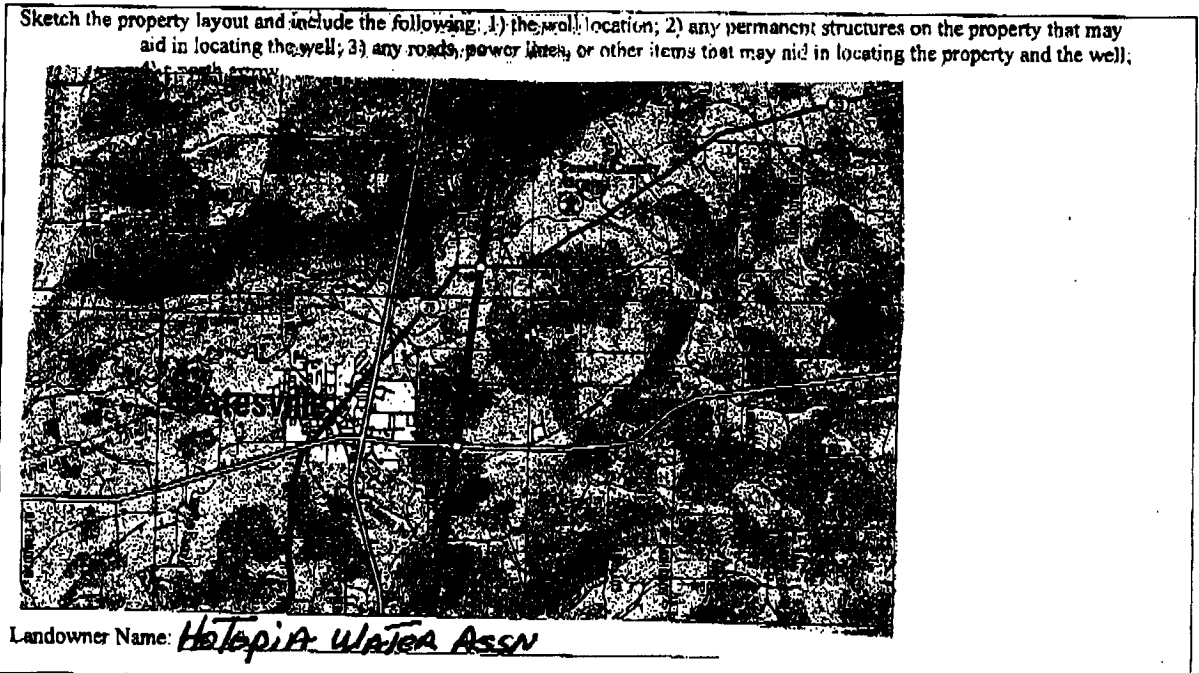

Form: OI.WR-SWR-1A (04/08)

I certify that the well/borehole was drilled, constructed, and completed in accordance with all applicable requirements of the Mississippi Department of Environmental Quality and the Mississippi Department of Health regulations, if applicable, and state laws.

Rayburn Parks 0-414 10/20/09
 Print Name of Responsible Licensee and License No. Date

Rayburn Parks
 Signature of Licensee

STATE WELL REPORT

Part 2

Pump Installer's Completion Report
 Mississippi Department of Environmental Quality
 Office of Land and Water Resources
 P.O. Box 2309
 Jackson, MS 39225
 (601)961-5210
 (601)961-5228 (fax)

County: PANOLA
 Permit #: _____
 Driller: Parks + Parks
 Date completed: 9/20/09
Copy information from block on Part 1

For Office Use Only:
 Aquifer: _____
 Well #: N0055
 Elevation: _____

This part of the report must be completed by a licensed water well contractor or a licensed pump installer. A copy of Part 1 of the report must be attached and both parts filed with the Department at the above address within 30 days of well completion.

Well Owner Information			Well Location		
Owner Name:	<u>HOPIA WATER ASSO</u>		Latitude:	<u>34-22-31</u>	
Mailing Address:	<u>1667 Hudson Rd</u>		Longitude:	<u>89-50-39</u>	
	<u>Batesville, MS 38606</u>		Method of Lat/Long (check one):	Conventional Survey _____	
City	State	Zip Code	USGS quad _____	Hand-held GPS _____	Survey-grade GPS _____
Telephone No.:	<u>(66) 563-7867</u>		<u>SW</u> $\frac{1}{4}$ <u>10^N</u> $\frac{1}{4}$ Sec <u>21</u> T <u>8S</u> R <u>6W</u>	Distance	Direction
			<u>14</u> Miles	<u>NW</u> of	<u>Batesville</u>

Pump Type Circle one			Power Type Circle one		
Air Lift	Jct	Submersible	Diesel Engine	Gasoline Engine	Natural Gas
Bucket	Piston	<u>Turbine</u>	<u>Electric Motor</u>	Hand	Tractor PTO
Centrifugal	Rotary	Flowing Well	Windmill	Other (specify): _____	
Other (specify): _____			Horse Power Rating of Motor: <u>100</u>		
Date Pump Installed: <u>10/18/09</u>			Setting Depth: <u>540</u> feet		
Rated Pump Capacity: <u>400</u> Gallons Per Minute			Number of Stages: <u>12</u>		

Pump Test Data		Method of Measuring Water Level Circle one	
Date Well Tested:	<u>9/28/09</u>	Air Line	<u>Electric Measuring Line</u>
Static Water Level (A):	<u>169</u> Feet Below Land Surface	Other (specify):	Steel Tape
Pumping Water Level (B):	<u>484</u> Feet Below Land Surface	For flowing well, measured shut in head: _____ feet	
Drawdown [(B) - (A)]:	<u>315</u> Feet Below Land Surface	Well yielded	<u>401</u> GPM with a drawdown of
Test Pumping Rate:	<u>401</u> Gallons Per Minute	<u>315</u> feet after	<u>4</u> hours of pumping
Duration of Pump Test (minimum 4 hours):	<u>4</u> hours		

I HEREBY CERTIFY that the above statements are true to the best of my knowledge.

Rayburn Parks 0-414
 Print Name of Pump Installer and License No. (if applicable)

Rayburn Parks
 Signature of Pump Installer