

# STATE WELL REPORT

175

County: PANOLA  
 Permit #: GW-51569  
 Driller: CHAD MATTOX  
 Date drilling completed: 6/2/21

**Part 1**  
**Driller's Log**  
 Mississippi Department of Environmental Quality  
 Office of Land and Water Resources  
 P.O. Box 2309  
 Jackson, MS 39225-2309  
 (601)961-5210  
 (601)360-0535 (fax)

**For Office Use Only:**

Well #: K 89  
 Aquifer: \_\_\_\_\_  
 E-Log #: \_\_\_\_\_

*State Law requires that this report be prepared by the license holder responsible for the work and filed with the Department at the above address within 30 days of completion of drilling of the well or borehole.*

Well Owner Information <small>(Landowner if borehole is not for a water well)</small>	Well or Borehole Location
Owner Name: <u>RIVERSIDE FARMS</u>	Latitude: <u>34.393333</u> Longitude: <u>-90.122731</u>
Mailing Address: <u>98 PLEASANT RD</u>	Method of Lat/Long (check one): Conventional Survey <input type="radio"/> <u>34 23 36</u> <u>90 07 21.8</u>
<u>SARDIS</u> <u>MS</u> <u>38666</u>	USGS quad <input type="radio"/> Hand-held GPS <input type="radio"/> Survey-grade GPS <input type="radio"/>
City State Zip Code	<u>NE</u> <u>1/4</u> <u>NW</u> <u>1/4</u> , Sec <u>14</u> T <u>08S</u> R <u>09W</u>
Telephone No. (____) _____	<u>7</u> Miles <u>E</u> of <u>FALCON</u>
	(Distance) (Direction) (Nearest Town)

**Well / Borehole Data**

Date drilling started: 6/2/21 Date drilling completed: 6/2/21 Hole depth: 115 Hole diameter: 24

Location of the source of any surface water used for drilling: NEARBY WELL

Method of dosing and volume of Chlorine used in drilling and development: \_\_\_\_\_

Logs run (check all applicable):  No log run  Electric  Gamma Ray  Density  Sonic  Neutron  Other: \_\_\_\_\_

Name of organization running log(s): \_\_\_\_\_

Purpose of borehole (circle one):  Water Well  Geotechnical/Geological Investigation  Ground Source Heat Pump  
 Seismic Survey  Other (describe) \_\_\_\_\_

*If drilling is not related to water well construction, skip the remainder of this block*

Purpose of Well (check all applicable):  Home  Industrial  Public Supply  Irrigation  Fish Culture

Other (describe): \_\_\_\_\_

If a flowing well, method of flow regulation: Valve \_\_\_\_\_ Other (describe) \_\_\_\_\_

Static Water Level: 21 feet  above /  below land surface Date measured: 6/2/21  
(select one)

Method of measurement (select one):  Steel tape  Electric tape  Air line  Other (describe): \_\_\_\_\_

Well depth: 115 Well grouted to a depth of: 10 feet Type of grout (select one):  Neat Cement  Bentonite  Mix

Casing length: 75 feet Casing diameter: 16 inches Type of casing: PVC

Screen length: 40 feet Screen diameter: 16 inches Type of screen: PVC

Screen slot size: .050 inches Setting depth: From 70 feet to 115 feet

Type of completion (check all applicable):  Gravel packed  Underreamed  Open hole  Natural Development

Other (describe): \_\_\_\_\_

Top of lap pipe or reduction in casing: \_\_\_\_\_ feet

*If telescoped or more than one screen, describe on next page*

RECEIVED  
 AUG 27 2021  
 BY OLWR







6/4/2021

34°23'36.0"N 90°07'21.8"W - Google Maps

Google Maps

34°23'36.0"N 90°07'21.8"W

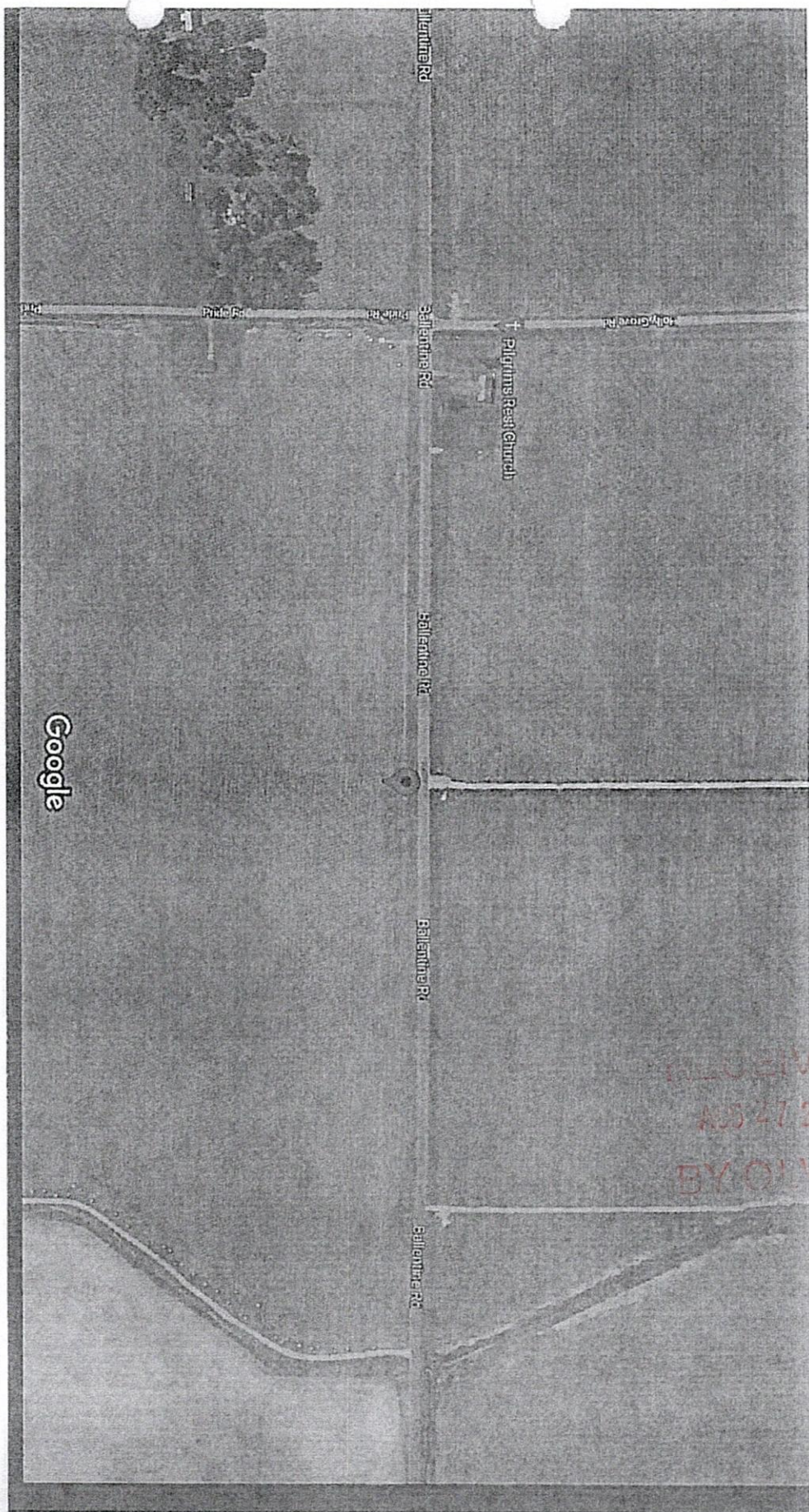

Imagery ©2021 Maxar Technologies, State of Arkansas, USDA Farm Service Agency, Map data ©2021

200 ft

[https://www.google.com/maps/@34°23'36.0"N+90°07'21.8"W/@34.3934174,-90.1228003,727m/data=!3m1!1e3!1d513m1!1s0x0:0x018m213d3d3933333d4d-90:1227306](https://www.google.com/maps/@34°23'36.0)



**STATE OF MISSISSIPPI**  
Department of Environmental Quality  
Office of Land and Water Resources  
P.O.Box 2309  
Jackson, Mississippi 39225

Riverside  
21-0256

**PERMIT**  
**TO DIVERT OR WITHDRAW FOR BENEFICIAL USE THE PUBLIC WATERS**

This permit is issued to the landowner named below in accordance with the provisions of the Mississippi Water Laws, Mississippi Code Sections 51-3-1, et seq. (1972, as amended), and the regulations and standards as promulgated thereunder. Whether or not specifically named in this permit or in the applications for this permit, anyone using water from the diversion/withdrawal point described below shall do so in compliance with the provisions of this permit. Neither this permit, nor any authority conferred hereby, may be sold, conveyed, encumbered, assigned or otherwise aliened, for any period of time or under any conditions whatsoever. This permit may not be modified, transferred, or revoked without prior action by the Permit Board. Any attempts to modify, transfer or revoke this permit, or to take any other action on this permit, shall be invalid and unenforceable and may result in immediate revocation or suspension of this permit. The holder of this permit shall at all times be responsible for adherence to the terms and conditions of this permit. No agreement between the permit holder and any other party shall affect the obligations and liabilities of the permit holder. Water use under this permit is allowed only when the streamflow or lake level elevation (whichever, if any, is applicable) is above the established minimum, pursuant to Mississippi Code Section 51-3-7. Authorization is hereby granted to divert/withdraw water for the beneficial use designated herein, and for no other purpose, subject to the following terms, conditions, and limitations:

**Permit Number:** MS-GW-51569 **Total Permitted Acreage:** 160

**Landowner Name:** RIVERSIDE FARMS  
**Landowner Address:** 98 PLEASANT GROVE ROAD  
SARDIS, MS 38666

**Source of Water:** MISSISSIPPI RIVER VALLEY ALLUVIAL AQUIFER

**Beneficial Use(s):** IRRIGATION

**Diversion/Withdrawal Location:** NE 1/4 of the NW 1/4 **Section:** 14 **Township:** 08S **Range:** 09W  
**County:** PANOLA **Quad:** PLEASANT GROVE

**Permitted Acreage:** **Irrigation:** 160 **Fish Culture:** 0 **Wildlife Management:** 0

**Maximum Volume:** See Special Terms And Conditions (attachment I)

**Applicant Name:** RIVERSIDE FARMS  
**Applicant Address:** 98 PLEASANT GROVE ROAD  
SARDIS, MS 38666

**Date Permit Issued:** 06/01/2021  
**Date Permit Expires:** 06/01/2026  
**Date Permit Modified:**  
**Date Permit Reissued:**

This permit shall be deemed null and void if construction has not begun within one (1) year of the permit issue date.

**SPECIAL TERMS AND CONDITIONS 1:**

See Attachment I which is hereby declared part of this permit.

RECEIVED  
AUG 27 2021  
BY OLWR

Key W...