

State Well Report

Part I

Mississippi Department of Environmental Quality
Office of Land and Water Resources
P.O. Box 10631
Jackson, MS 39289-0631
(601)961-5210
(601)354-6938 (fax)

For Office Use Only:

Aquifer: _____
Well #: K-26
L. S. Elevation: _____
E-log #: _____

County: Panola
Permit #: 6W 41873
Driller: Netto Dickey
Date drilling completed: 5-20-07

State Law requires that this report be prepared by the driller in detail and filed with the Department within 30 days of completion of drilling of the well.

Well Owner Information	Well Location
Owner Name: <u>Hale Farms</u>	Latitude: <u>34° 21' 015"</u> Longitude: <u>90° 11' 593"</u>
Mailing Address: <u>1855 Hale Rd</u>	Method of Lat/Long (circle one): <u>Conventional Survey</u>
<u>Hedge</u> MS <u>38670</u>	<u>S/E</u> USGS quad, <u>Hand-held GPS</u> , Survey-grade GPS
City State Zip Code	<u>SW</u> 1/4 <u>SW</u> 1/4 Sec <u>30</u> Twn <u>8</u> Rng <u>9W</u>
Telephone No. <u>(662) 619-0122</u>	Distance Direction Nearest Town <u>5</u> Miles <u>E</u> of <u>Falcom MS.</u>

Well Data

Purpose of Well (circle one) Home Industrial Public Supply Irrigation Fish Culture Other: _____

Date well drilling started: 5-20-07 Date well drilling completed: 5-20-07

If flowing, method of flow regulation: Valve _____ Other (describe) _____

Static Water Level: 22 feet above or below (circle one) land surface Date measured: 5-21-07

Method of Measurement (circle one) steel tape electric tape air line other: _____

Hole depth: 100 Well depth: 100 Well grouted to a depth of 10 feet

Type of grout (circle one): Cement Bentonite Mix

Casing length: 60 feet Casing diameter: 12 inches Type of casing: PVC

Screen length: 40 feet Screen diameter: 12 inches Type of screen: PVC

Screen slot size: 0032 inches Setting depth: From 60 feet to 100 feet

Type of completion (circle all applicable): Gravel packed Underreamed Telescoped Open hole Natural Development

Other (describe): _____

Top of lap pipe or reduction in casing: _____ feet. If telescoped or more than one screen, describe on back of page

Logs run (circle all applicable): No log run Electric Gamma Ray Density Sonic Neutron Other: VISUAL

Name of organization running log(s): _____

I certify that the well was drilled, constructed, and completed in accordance with all applicable requirements of the Mississippi Department of Environmental Quality and/or the Mississippi Department of Health regulations and state laws.

ALAN DYLE 0674

Print Name of Water Well Contractor and License No.

Signature of Water Well Contractor

GW41873

K-26

If well telescopes please sketch below and show depths.

Ground Level _____

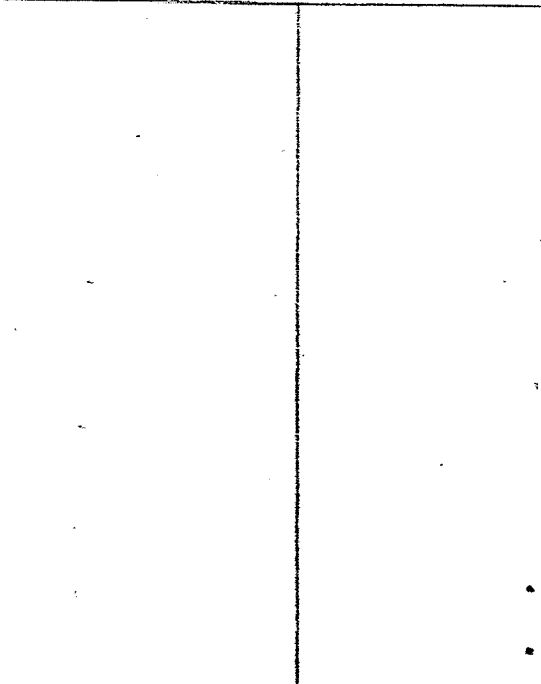

Description of Formations Encountered	From	To
Clay	0	40
Fine Sand	40	50
Sand Coarse Sand	50	71
Coarse Sand + Gravel	71	100

If more than one screen, show location of each on sketch

Sketch the property layout and include the following: 1) the well location; 2) any permanent structures on the property that may aid in locating the well; 3) any roads, power lines, or other items that may aid in locating the property and the well; 4) indicate direction.

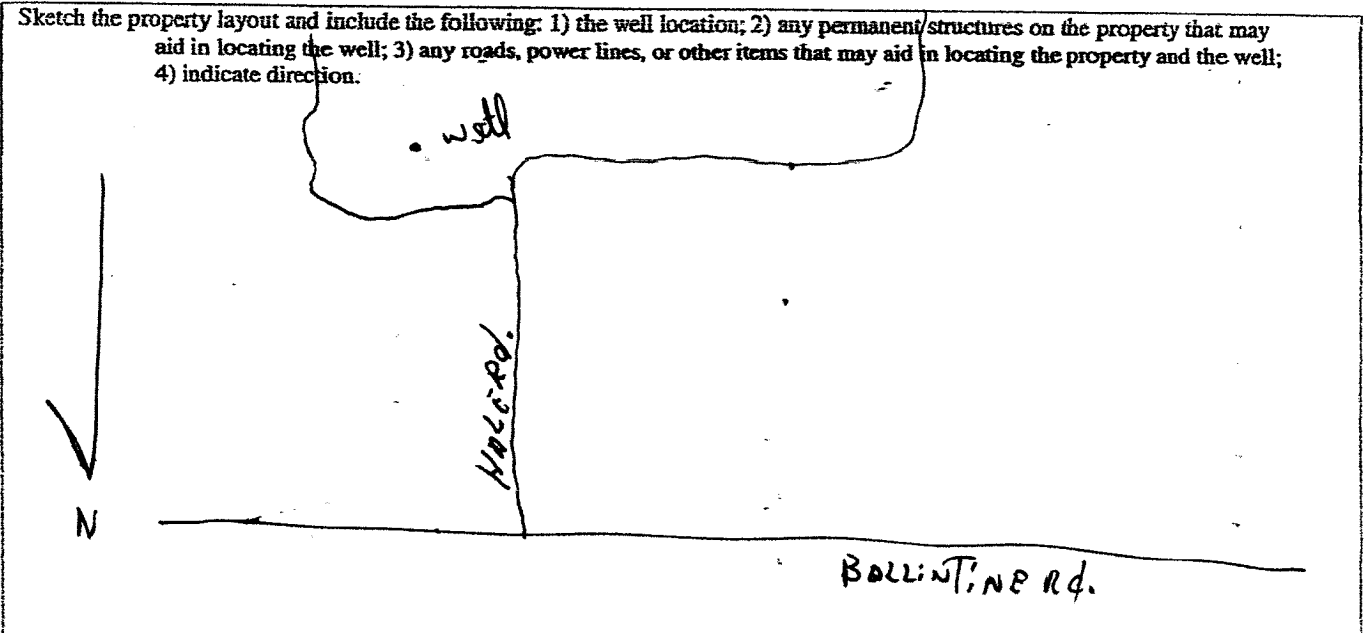

Landowner Name: HALE BROS

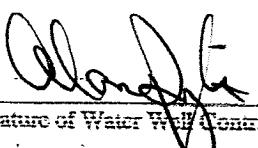
Signature of Water Well Contractor

STATE WELL REPORT

Part 2

Pump Installer's Completion Report
 Mississippi Department of Environmental Quality
 Office of Land and Water Resources
 P.O. Box 10631
 Jackson, MS 39289-0631
 (601)961-5210
 (601)354-6938 (fax)

County: Panola
 Permis #: 6W41873
 Driller: Walter Dally
 Date completed: 5-21-07

- For Office Use Only:

Aquifer: _____
 Well #: R-26
 Elevation: _____

This report should be prepared by the pump installer in detail and filed with the Department within 30 days of the installation of pump.

Well Owner Information	Well Location
Owner Name: <u>Hale farm</u> Mailing Address: <u>1855 - Hale Rd</u> <u>Sledge MS 38670</u> <small>City State Zip Code</small> Telephone No. <u>(662) 619-0122</u>	Latitude: <u>34-21-015</u> Longitude: <u>89-11-523</u> Method of Lat/Long (circle one): <u>Conventional Survey</u> , <u>USGS quad</u> , <u>Hand-held GPS</u> , <u>Survey-grade GPS</u> _____ $\frac{1}{4}$ _____ $\frac{1}{2}$ Sec _____ Twn _____ Rng _____ Distance _____ Direction _____ Nearest Town _____ _____ Miles _____ of _____

Pump Type Circle one	Power Type Circle one
Air Lift Jet Submersible Bucket Piston <u>Turbine</u> Centrifugal Rotary Flowing Well Other (specify): _____ Date Pump Installed: <u>5-21-07</u> Rated Pump Capacity: <u>8500</u> Gallons Per Minute	<u>Diesel Engine</u> Gasoline Engine Natural Gas Electric Motor Hand Tractor PTO Windmill Other (specify): _____ Horse Power Rating of Motor: <u>90</u> Setting Depth: <u>60</u> feet Number of Stages: <u>2</u>

Pump Test Data	Method of Measuring Water Level Circle one
Date Well Tested: _____ Static Water Level (A): _____ Feet Below Land Surface Pumping Water Level (B): _____ Feet Below Land Surface Drawdown [(B) - (A)]: _____ Feet Below Land Surface Test Pumping Rate: _____ Gallons Per Minute Duration of Pump Test (minimum 4 hours): _____ hours	<u>Air Line</u> Electric Measuring Line Steel Tape Other (specify): _____ For flowing well, measured shut in head: _____ feet Well yielded _____ GPM with a drawdown of _____ feet after _____ hours of pumping

I HEREBY CERTIFY that the above statements are true to the best of my knowledge.
ALAN DYLF _____
 Print Name of Pump Installer and License No. (if applicable) Signature of Pump Installer