

County: Panola
 Permit #: GW-48792
 Driller: Joel Jumper
 Date drilling completed: 9-10-15

State Well Report
Part I - Driller's Log
 Mississippi Department of Environmental Quality
 Office of Land and Water Resources
 P.O. Box 2309
 Jackson, MS 39225
 (601)961-5210
 (601)961-5228 (fax)

For Office Use Only
 Aquifer: _____
 Well #: E 44
 L.S. Elevation: _____
 E-log #: _____

State Law requires that this report be prepared by the license holder responsible for the work and filed with the Department at the above address within 30 days of completion of drilling of the well or borehole.

Information on Well Owner <i>(Landowner if borehole is not for a water well)</i>	Well or Borehole Location
Owner Name: <u>Chickasaw Farms</u>	Latitude: <u>34° 27' 26"</u> Longitude: <u>90° 10' 16"</u>
Mailing Address: <u>5764 Ballentine Rd</u>	Method of Lat/Long (circle one): Conventional Survey, <u>Hand-held GPS</u> , Survey-grade GPS
<u>Sandis Ms 38666</u>	USGS quad, <u>SE 1/4 SW 1/4 Sec 20 Twp 07S Rng 09W</u>
Telephone No. () _____	Distance <u>2</u> Miles Direction <u>E</u> of Nearest Town <u>Sledge</u>

Well / Borehole Data

Date drilling started: 9-10-15 Date drilling completed: 9-10-15 Hole depth: 112 Hole diameter: 24in

Location of the source of any surface water used for drilling: Nearest Well

Method of dosing and volume of Chlorine used in drilling and development: _____

Logs run (circle all applicable): No log run Electric Gamma Ray Density Sonic Neutron Other: _____

Name of organization running log(s): _____

Purpose of borehole (check one): Water Well Geotechnical/Geological Investigation Ground Source Heat Pump

Seismic Survey Other (describe) _____

if drilling is not related to water well construction, skip the remainder of this block

Purpose of Well (check one): Home Industrial Public Supply Irrigation Fish Culture Other: _____

If a flowing well, method of flow regulation: Valve _____ Other (describe) _____

Static Water Level: 25 feet above or below (circle one) land surface Date measured: 9-10-15

Method of Measurement (circle one) steel tape electric tape air line other: _____

Well depth: 112 Well grouted to a depth of 10 feet Type of grout (circle one): Neat Cement Bentonite Mix

Casing length: 72 feet Casing diameter: 16 inches Type of casing: PVC

Screen length: 40 feet Screen diameter: 16 inches Type of screen: PVC

Screen slot size: 0.50 inches Setting depth: From 72 feet to 70 feet

Type of completion (circle all applicable): Gravel packed Underreamed Telescoped Open hole Natural Development

Other (describe): _____

Top of lap pipe or reduction in casing: _____ feet. *if telescoped or more than one screen, describe on next page*

Form: OLWR-SWR-1A (04/08)

OCT 23 2015

The sketch below only required for water wells

If well telescopes, show depths on sketch

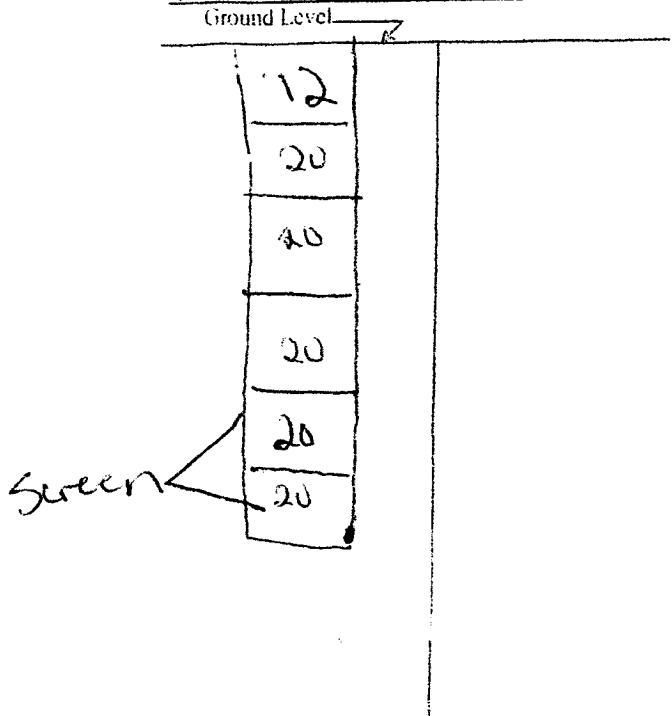

Description of formations encountered must be provided for all wells and boreholes, unless specifically exempted by regulations

Description of Formations Encountered	From (depth)	To (depth)
Top Soil	Ground Level	20
sand	20	40
sand	40	60
Course sand	60	80
gravel + sand	80	100
gravel + sand	100	112

If more than one screen, show location of each on sketch

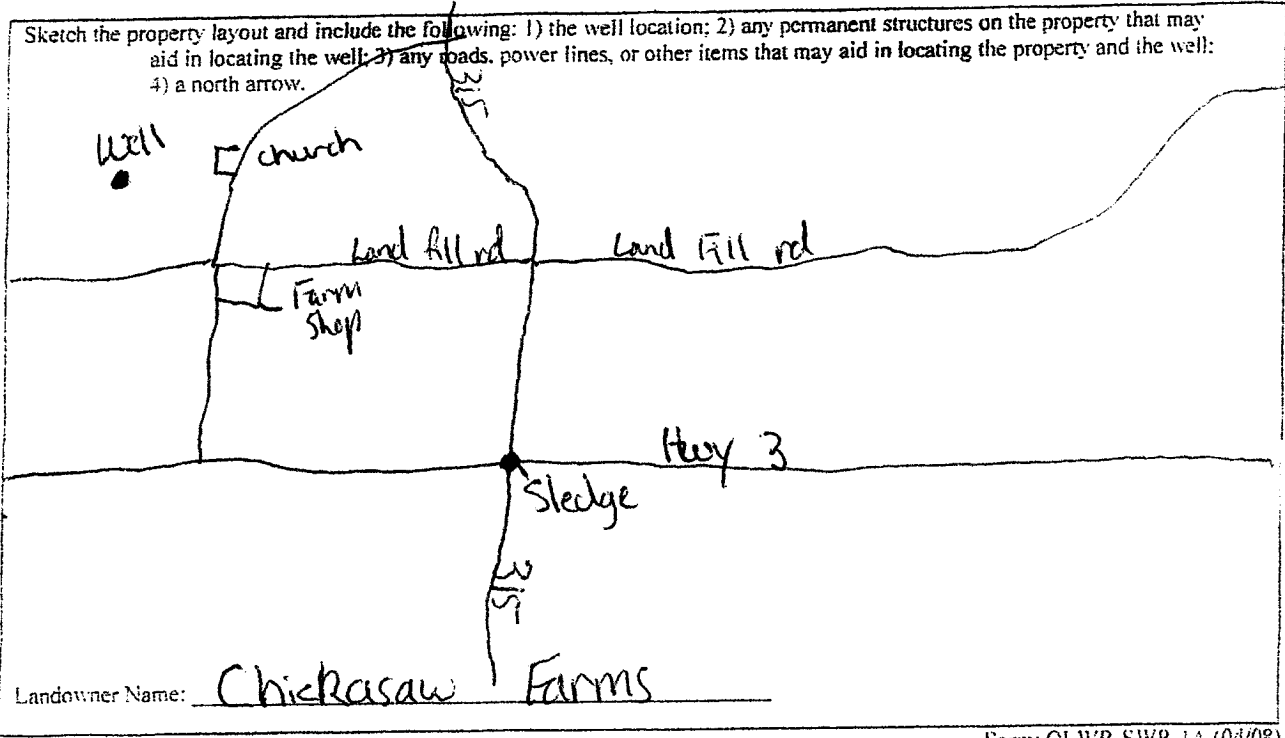

Form: OI.WR-SWR-1A (04/08)

I certify that the well/borehole was drilled, constructed, and completed in accordance with all applicable requirements of the Mississippi Department of Environmental Quality and the Mississippi Department of Health regulations, if applicable, and state laws.

Joel Jumper 5317 9-12-15
Print Name of Responsible Licensee and License No. Date

[Signature] OCT 28 2015
Signature of Licensee

STATE WELL REPORT

Part 2

Pump Installer's Completion Report
 Mississippi Department of Environmental Quality
 Office of Land and Water Resources
 P.O. Box 2309
 Jackson, MS 39225-2309
 (601)961-5210
 (601) 360-0535 (fax)

For Office Use Only:

Well #: E 66

Aquifer: _____

County: PANOLA
 Permit #: CW-48792
 Driller: JOEL JUMBER
 Date completed: 9-10-15
 Copy information from block on Part 1

This part of the report must be completed by a licensed water well contractor or a licensed pump installer. A copy of Part 1 of the report must be attached and both parts filed with the Department at the above address within 30 days of well completion.

Well Owner Information	Well Location
Owner Name: <u>CHICKASAW FARMS</u>	Latitude: <u>34°27'20"</u> Longitude: <u>90°10'18"</u>
Mailing Address: <u>5764 BALLENTINE RD</u>	Method of Lat/Long (check one): Conventional Survey _____, USGS quad _____, Hand-held GPS _____, Survey-grade GPS _____
<u>SARDES</u> <u>MS</u> <u>38666</u> City State Zip Code	<u>SE</u> ¼ <u>SW</u> ¼, Sec <u>20</u> T <u>07S</u> R <u>09W</u>
Telephone No. <u>(602) 487-3961</u>	<u>2.8</u> Miles <u>NE</u> of <u>SLEAZE</u> (Distance) (Direction) (Nearest Town)

Pump Type (circle one)

Submersible Turbine Air Lift Centrifugal Flowing Well Jet Piston Rotary Other (describe): _____

Date Pump Installed: 9-11-15 Rated Pump Capacity: 2200 Gallons Per Minute

Is This Pump (circle one): New Repaired Replacement

Power Type (circle one)

Electric Diesel Gasoline Natural Gas Tractor PTO Windmill Other (describe): _____

Horse Power Rating of Motor: 60 Setting Depth: 70 feet Number of Stages: 2

Pump Test Data for Non Flowing Well

Date Well Tested: _____ Duration of Pump Test (minimum 4 hours): _____ hours

Static Water Level (A): _____ Feet Below Land Surface Pumping Water Level (B): _____ Feet Below Land Surface

Drawdown [(B) - (A)]: _____ Feet Below Land Surface Test Pumping Rate: _____ Gallons Per Minute

Method of measurement (circle one): Steel tape Electric tape Air line Other (describe): _____

Pump Test Data for Flowing Well

Measured shut in head: _____ feet.

Well yielded _____ GPM with a drawdown of _____ feet after _____ hours of pumping

Meter Installation

Meter Manufacturer: _____ Meter Serial Number: _____

Meter Model Number/Name: _____ Type of Meter: _____

Totalizer Register Unit and Multiplier Factor (AF x .001, gal x 1000, etc): _____

Installation Date: _____ Meter installed by: _____

Is This Meter (circle one): New Repaired Replacement

RECEIVED
SEP 25 2015

Important: By submitting the above information you are certifying that this meter was installed to manufacturer standards. For agricultural wells, a list of approved meters is on the MDEQ website.

I HEREBY CERTIFY that the above statements are true to the best of my knowledge.

DAVID P. HOLT 0-752P 9-23-15 
 Print Name of Pump Installer and License No. (if applicable) Date Signature of Pump Installer

BY: OLWR

15-0076