

County: Montgomery  
 Permit #: \_\_\_\_\_  
 Driller: Ratliff  
 Date drilling completed: 11-5-10

**State Well Report**  
**Part 1 - Driller's Log**  
 Mississippi Department of Environmental Quality  
 Office of Land and Water Resources  
 P.O. Box 10631  
 Jackson, MS 39289-0631  
 (601)961-5210  
 (601)354-6938 (fax)

**For Office Use Only:**  
 Aquifer: \_\_\_\_\_  
 Well #: 535  
 L. S. Elevation: \_\_\_\_\_  
 E-log #: \_\_\_\_\_

**State Law requires that this report be prepared by the license holder responsible for the work and filed with the Department at the above address within 30 days of completion of drilling of the well or borehole.**

Information on Well Owner <i>(Landowner if borehole is not for a water well)</i>	Well or Borehole Location
Owner Name: <u>South Winona Water</u>	Latitude: <u>33° 26' 42" N</u> Longitude: <u>89° 43' 21" W</u>
Mailing Address: <u>753 Enterprise Dr</u>	Method of Lat/Long (circle one): Conventional Survey, USGS quad, Hand-held GPS, Survey-grade GPS
<u>Winona</u> MS	NW 1/4 SE 1/4 Sec <u>12</u> Twn <u>18N</u> Rng <u>5E</u>
City State Zip Code	Distance Direction Nearest Town
Telephone No. ( )	<u>3</u> Miles <u>S</u> of <u>Winona</u>

**Well / Borehole Data**

Date drilling started: 10-29-10 Date drilling completed: 11-5-10 Hole depth: 1180' Hole diameter: 6.5"

Location of the source of any surface water used for drilling: South Winona water

Method of dosing and volume of Chlorine used in drilling and development: \_\_\_\_\_

Logs run (circle all applicable): No log run  Electric  Gamma Ray  Density  Sonic  Neutron Other: \_\_\_\_\_

Name of organization running log(s): MS Geo Survey

Purpose of borehole (check one): Water Well \_\_\_\_\_ Geotechnical/Geological Investigation \_\_\_\_\_ Ground Source Heat Pump \_\_\_\_\_ Seismic Survey \_\_\_\_\_ Other (describe) Test hole #3

*If drilling is not related to water well construction, skip the remainder of this block*

Purpose of Well (check one): Home \_\_\_\_\_ Industrial \_\_\_\_\_ Public Supply \_\_\_\_\_ Irrigation \_\_\_\_\_ Fish Culture \_\_\_\_\_ Other: \_\_\_\_\_

If a flowing well, method of flow regulation: Valve \_\_\_\_\_ Other (describe) \_\_\_\_\_

Static Water Level: \_\_\_\_\_ feet above or below (circle one) land surface Date measured: \_\_\_\_\_

Method of Measurement (circle one) steel tape \_\_\_\_\_ electric tape \_\_\_\_\_ air line \_\_\_\_\_ other: \_\_\_\_\_

Well depth: \_\_\_\_\_ Well grouted to a depth of \_\_\_\_\_ feet Type of grout (circle one): Neat Cement \_\_\_\_\_ Bentonite \_\_\_\_\_ Mix \_\_\_\_\_

Casing length: \_\_\_\_\_ feet Casing diameter: \_\_\_\_\_ inches Type of casing: \_\_\_\_\_

Screen length: \_\_\_\_\_ feet Screen diameter: \_\_\_\_\_ inches Type of screen: \_\_\_\_\_

Screen slot size: \_\_\_\_\_ inches Setting depth: From \_\_\_\_\_ feet to \_\_\_\_\_ feet

Type of completion (circle all applicable): Gravel packed \_\_\_\_\_ Underreamed \_\_\_\_\_ Telescoped \_\_\_\_\_ Open hole \_\_\_\_\_ Natural Development \_\_\_\_\_ Other (describe): \_\_\_\_\_

Top of lap pipe or reduction in casing: \_\_\_\_\_ feet. *If telescoped or more than one screen, describe on next page*

J35

**The sketch below only required for water wells**

**If well telescopes, show depths on sketch**

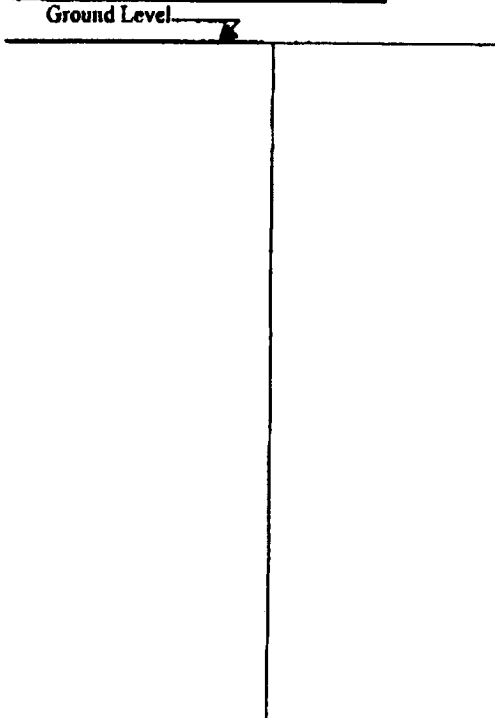

**Description of formations encountered must be provided for all wells and boreholes, unless specifically exempted by regulations**

Description of Formations Encountered	From (depth)	To (depth)
SAND	Ground Level	20
Shale	70	180
Rock	175	175
clay/shale	180	300
sand	300	440
shale/lignite	440	480
shale	480	610
Rock	610	610
clay/shale	610	700
Rock	690	690
sand + shale	700	770
clay + sand streak	770	975
Rock - hard	975	975
shale	975	1000
sand	1000	1010
clay + shale	1010	1180

If more than one screen, show location of each on sketch

Sketch the property layout and include the following: 1) the well location; 2) any permanent structures on the property that may aid in locating the well; 3) any roads, power lines, or other items that may aid in locating the property and the well; 4) a north arrow.

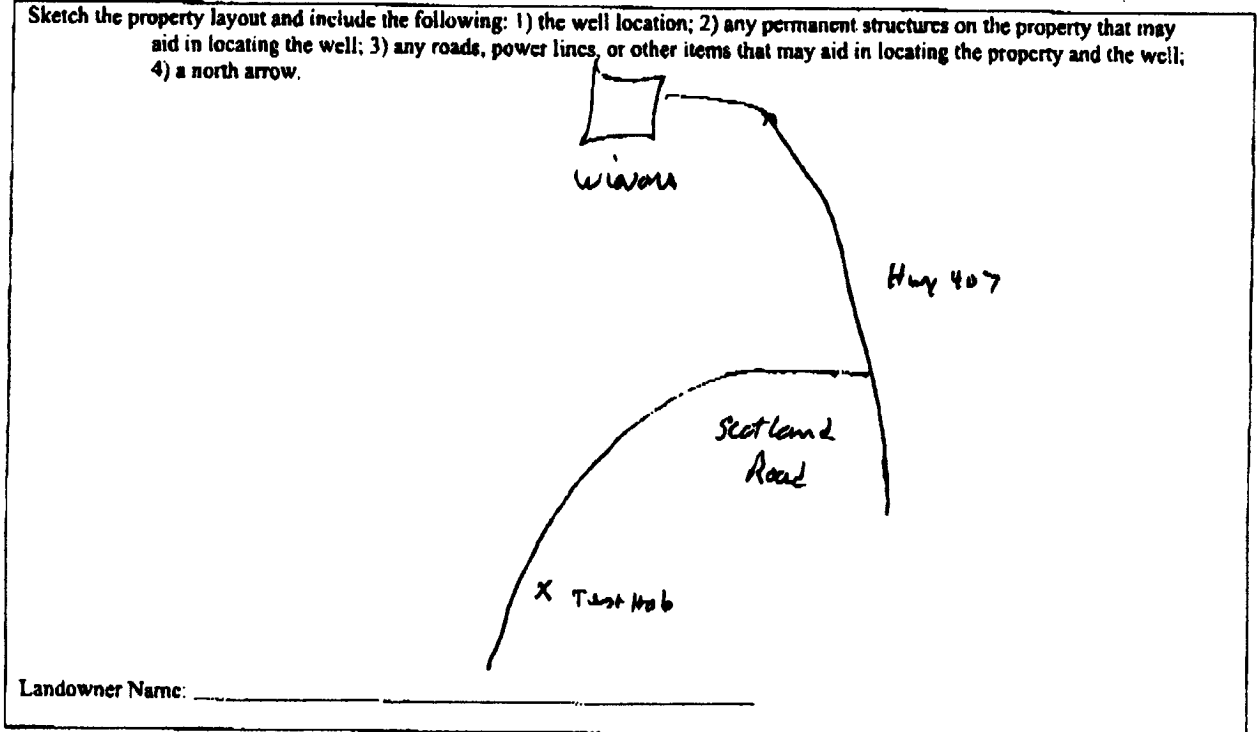

Landowner Name: \_\_\_\_\_

Form: OLWR-SWR-1/

I certify that the well/borehole was drilled, constructed, and completed in accordance with all applicable requirements of the Mississippi Department of Environmental Quality and the Mississippi Department of Health regulations, if applicable, and state laws.

Robert Ratliff      U-002      Robert Ratliff