

STATE WELL REPORT

Part 1

Driller's Log

Mississippi Department of Environmental Quality
 Office of Land and Water Resources
 P.O. Box 2309
 Jackson, MS 39225-2309
 (601)961-5210
 (601)360-0535 (fax)

County: Montgomery
 Permit #: _____
 Driller: Katiff Water Well
 Date drilling completed: 8-4-15

For Office Use Only:
 Well #: F.36
 Aquifer: _____
 E-Log #: _____

State Law requires that this report be prepared by the license holder responsible for the work and filed with the Department at the above address within 30 days of completion of drilling of the well or borehole.

Well Owner Information <i>(Landowner if borehole is not for a water well)</i>	Well or Borehole Location
Owner Name: <u>WINONA HARDWOOD</u>	Latitude: <u>33° 31' 46" N</u> Longitude: <u>89° 43' 16" W</u>
Mailing Address: <u>164 SAWYER LOOP</u>	Method of Lat/Long (check one): Conventional Survey _____, USGS quad _____, Hand-held GPS <input checked="" type="checkbox"/> , Survey-grade GPS _____
<u>WINONA</u> <u>MS.</u> <u>38967</u>	<u>NE 1/4 NE 1/4, Sec 12 T 19N R 5E</u>
City State Zip Code	<u>3</u> Miles <u>North</u> of <u>Winona</u>
Telephone No. () _____	(Distance) (Direction) (Nearest Town)

Well / Borehole Data

Date drilling started: 7-28-15 Date drilling completed: 8-30-15 Hole depth: 600 Hole diameter: 7.5

Location of the source of any surface water used for drilling: Community

Method of dosing and volume of Chlorine used in drilling and development: 50ppm Cl²

Logs run (circle all applicable): No log run Electric Gamma Ray Density Sonic Neutron Other: _____

Name of organization running log(s): Ms. Geology

Purpose of borehole (circle one): Water Well Geotechnical/Geological Investigation Ground Source Heat Pump
 Seismic Survey Other (describe) _____

If drilling is not related to water well construction, skip the remainder of this block

Purpose of Well (circle all applicable): Home Industrial Public Supply Irrigation Fish Culture

Other (describe): _____

If a flowing well, method of flow regulation: Valve _____ Other (describe) _____

Static Water Level: 158 feet [above or below] land surface Date measured: 8-12-15
(circle one)

Method of measurement (circle one): Steel tape Electric tape Air line Other (describe): _____

Well depth: 460 Well grouted to a depth of: 10 feet Type of grout (circle one): Neat Cement Bentonite Mix

Casing length: 420 feet Casing diameter: 4 inches Type of casing: Steel

Screen length: 40 feet Screen diameter: 2.5 inches Type of screen: Steel

Screen slot size: .013 inches Setting depth: From 420 feet to 460 feet

Type of completion (circle all applicable): Gravel packed Underreamed Open hole Natural Development

Other (describe): _____

Top of lap pipe or reduction in casing: _____ feet

If telescoped or more than one screen, describe on next page



Google Unnamed Rd

North

WELL

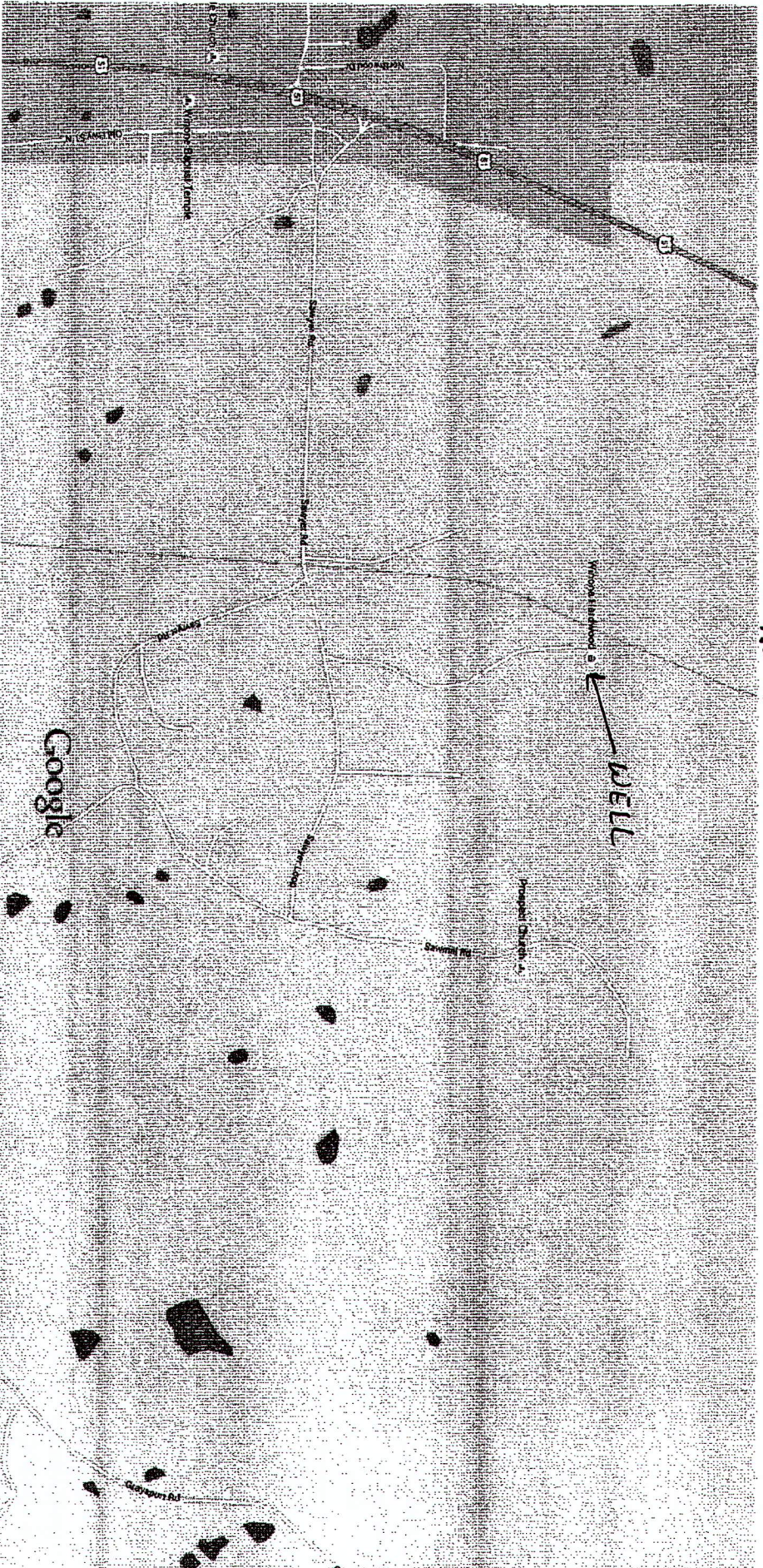

Map data ©2015 Google 500 ft

Unnamed Rd
Winona, MS 38967

STATE WELL REPORT

Part 2

Pump Installer's Completion Report
 Mississippi Department of Environmental Quality
 Office of Land and Water Resources
 P.O. Box 2309
 Jackson, MS 39225-2309
 (601)961-5210
 (601) 360-0535 (fax)

County: Montgomery
 Permit #: _____
 Driller: Ratliff Water Well
 Date completed: Aug 7-15
 Copy information from block on Part 1

For Office Use Only:
 Well #: F36
 Aquifer: _____

This part of the report must be completed by a licensed water well contractor or a licensed pump installer. A copy of Part 1 of the report must be attached and both parts filed with the Department at the above address within 30 days of well completion.

Well Owner Information			Well Location		
Owner Name: <u>WINONA HARDWOOD</u>			Latitude: <u>33° 31' 46" N</u> Longitude: <u>89° 43' 16" W</u>		
Mailing Address: <u>164 SAWYER LOOP</u>			Method of Lat/Long (check one): Conventional Survey _____		
<u>WINONA</u> <u>Ms.</u> <u>38967</u>			USGS quad _____, Hand-held GPS <input checked="" type="checkbox"/> , Survey-grade GPS _____		
City State Zip Code			<u>1/4</u> <u>1/4</u> , Sec <u>12</u> T. <u>19N</u> R. <u>5E</u>		
Telephone No. (____) _____			<u>3</u> Miles <u>North</u> of <u>WINONA, Ms.</u>		
			(Distance) (Direction) (Nearest Town)		

Pump Type (circle one)
 Submersible Turbine Air Lift Centrifugal Flowing Well Jet Piston Rotary Other (describe): _____
 Date Pump Installed: 8-12-15 Rated Pump Capacity: 45 Gallons Per Minute
 Is This Pump (circle one): New Repaired Replacement

Power Type (circle one)
 Electric Diesel Gasoline Natural Gas Tractor PTO Windmill Other (describe): _____
 Horse Power Rating of Motor: 5 Setting Depth: 252 feet Number of Stages: 18

Pump Test Data for Non Flowing Well
 Date Well Tested: 8-12-15 Duration of Pump Test (minimum 4 hours): 4 hours
 Static Water Level (A): 158 Feet Below Land Surface Pumping Water Level (B): 230 Feet Below Land Surface
 Drawdown [(B) - (A)]: 72 Feet Below Land Surface Test Pumping Rate: 48 Gallons Per Minute
 Method of measurement (circle one): Steel tape Electric tape Air line Other (describe): _____

Pump Test Data for Flowing Well
 Measured shut in head: _____ feet.
 Well yielded 48 GPM with a drawdown of 72 feet after 4 hours of pumping

Meter Installation
 Meter Manufacturer: _____ Meter Serial Number: _____
 Meter Model Number/Name: _____ Type of Meter: _____
 Totalizer Register Unit and Multiplier Factor (AF x .001, gal x 1000, etc): _____
 Installation Date: _____ Meter installed by: _____
 Is This Meter (circle one): New Repaired Replacement
Important: By submitting the above information you are certifying that this meter was installed to manufacturer standards. For agricultural wells, a list of approved meters is on the MDEQ website.

I HEREBY CERTIFY that the above statements are true to the best of my knowledge.
Robert E. Ratliff 0-002 8-18-15 Robert E. Ratliff
 Print Name of Pump Installer and License No. (if applicable) Date Signature of Pump Installer