

County: Wesfall
 Permit #: 0-162
 Driller: Larry Carpenter
 Date drilling completed: 7-7-07

State Well Report
Part 1 - Driller's Log
 Mississippi Department of Environmental Quality
 Office of Land and Water Resources
 P.O. Box 10631
 Jackson, MS 39289-0631
 (601)961-5210
 (601)354-6938 (fax)

For Office Use Only:
 Aquifer: _____
 Well #: V-32
 L. S. Elevation: _____
 E-log #: _____

State Law requires that this report be prepared by the license holder responsible for the work and filed with the Department at the above address within 30 days of completion of drilling of the well or borehole.

<p>Information on Well Owner <i>(Landowner if borehole is not for a water well)</i></p> <p>Owner Name: <u>Billy Phillips</u> Mailing Address: <u>3348 Hwy 310</u> <u>Waterford</u> <u>Ms</u> <u>38685</u> City State Zip Code Telephone No. <u>(662) 274-4301</u></p>	<p>Well or Borehole Location</p> <p>Latitude: <u>34° 34' 15"</u> Longitude: <u>89° 34' 52"</u> Method of Lat/Long (circle one): <u>Conventional Survey</u> USGS quad, Hand-held GPS, Survey-grade GPS <u>SE 1/4 SE 1/4</u> Sec. <u>11</u> Twn. <u>65</u> Rng. <u>4W</u> Distance Direction Nearest Town <u>1/2</u> Miles <u>West</u> of <u>Louis Hall</u></p>
---	---

Well / Borehole Data

Date drilling started: 7-7-07 Date drilling completed: 7-7-07 Hole depth: 205' Hole diameter: 8"

Location of the source of any surface water used for drilling: Well Water
 Method of casing and volume of Chlorine used in drilling and development: 1/2 lb chlorine to 1000 gal water

Logs run (circle all applicable): No log run Electric Gamma Ray Density Sonic Neutron Other: _____
 Name of organization running log(s): _____

Purpose of borehole (check one): Water Well Geotechnical/Geological Investigation _____ Ground Source Heat Pump _____
 Seismic Survey _____ Other (describe) _____
If drilled it is not related to water well construction, skip the remainder of this block

Purpose of Well (check one): Home Industrial _____ Public Supply _____ Irrigation _____ Fish Culture _____ Other _____

If a flowing well, method of flow regulation: Valve _____ Other (describe) _____

Static Water Level: 150 feet above or below (circle one) land surface Date measured: 7-9-07

Method of Measurement (circle one): steel tape electric tape air line other: _____

Well depth: 210' Well grouted to a depth of 10 feet Type of grout (circle one): Neat Cement Bentonite Mix

Casing length: 200 feet Casing diameter: 4 inches Type of casing: PVC

Screen length: 10 feet Screen diameter: 4 inches Type of screen: PVC

Screen slot size: .013 inches Setting depth: From 200 feet to 210 feet

Type of completion (circle all applicable): Gravel packed Underreamed Telescoped Open hole Natural Development
 Other (describe): _____

Top of lap pipe or reduction in casing: _____ feet. *If telescoped or more than one screen, describe on next page*

RECEIVED
 AUG 03 2007
 BY: OLWR

The sketch below only intended for water wells.

If well construction shown sketch on sketch:
Ground Level

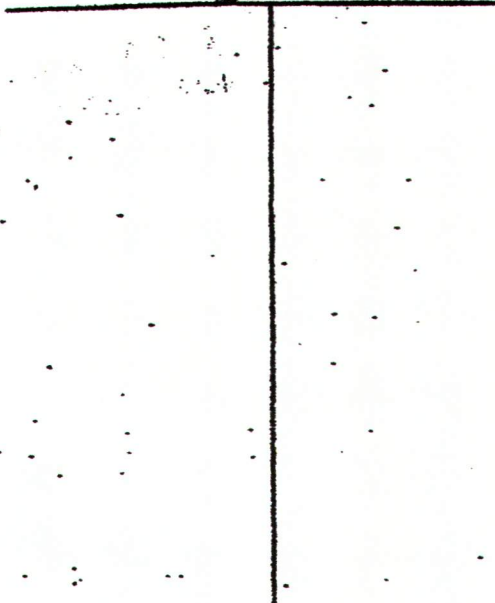

Description of formation encountered must be provided for all wells and formation names specifically extended by geologists.

Description of Formations Encountered	From (depth)	To (depth)
Surface Soil	0	21
Red Red Soil	21	45
Red White Soil	45	90
White clay	90	108
Fine White Soil	108	140
White clay	140	162
White Coarse Soil	162	210

If more than one screen, show location of each on sketch

Sketch the property layout and include the following: 1) the well location; 2) any permanent structures on the property that may aid in locating the well; 3) any roads, power lines, or other items that may aid in locating the property and the well; 4) a north arrow.

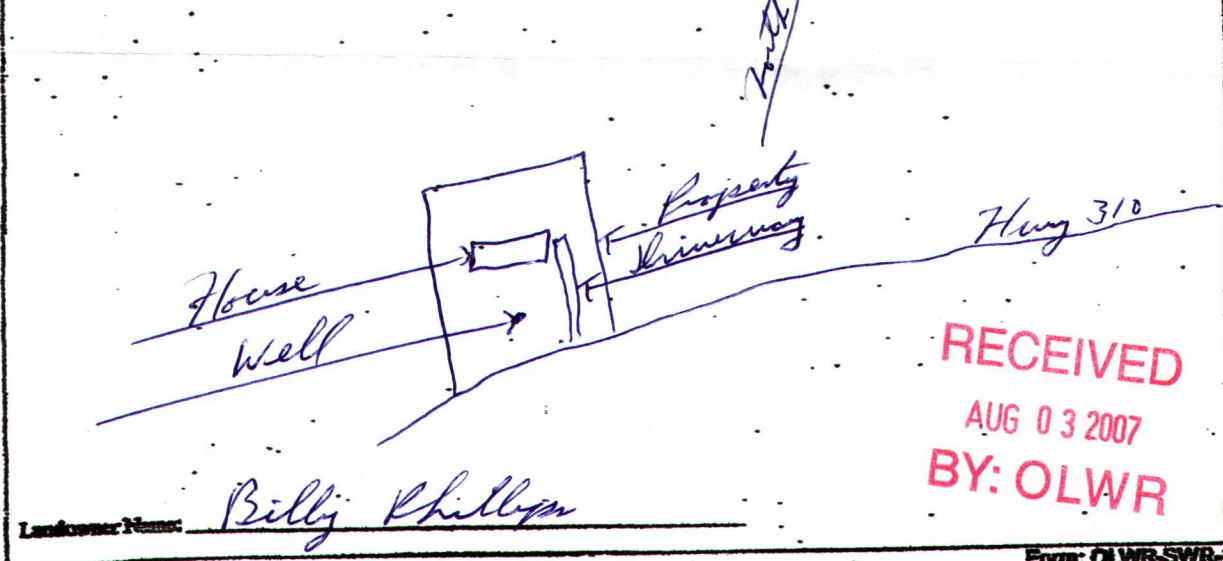

RECEIVED
AUG 03 2007
BY: OLWR

I certify that the well/wholes was drilled, constructed, and completed in accordance with all applicable requirements of the Mississippi Department of Environmental Quality and the Mississippi Department of Health regulations, if applicable, and state laws.

LARRY CARPENTER 0-166 7-26-07
Print Name of Responsible Licensee and License No. Date Larry Carpenter
Signature of Licensee

STATE WELL REPORT

Part 2

Pump Installer's Completion Report
Mississippi Department of Environmental Quality
Office of Land and Water Resources
P.O. Box 10631
Jackson, MS 39289-0631
(601)961-5210
(601)354-6938 (fax)

County: Washell
Permit #: 0-162
Driller: Larry Carpenter
Date completed: 7-9-07
Copy information from block on Part 1

For Office Use Only:

Aquifer: _____
Well #: V-32
Elevation: _____

This part of the report must be completed by a licensed water well contractor or a licensed pump installer. A copy of Part 1 of the report must be attached and both parts filed with the Department at the above address within 30 days of well completion.

Well Owner Information	Well Location
Owner Name: <u>Billy Phillips</u>	Latitude: _____ Longitude: _____
Mailing Address: <u>3348 Hwy 310</u>	Method of Lat/Long (check one): Conventional Survey _____ USGS quad _____ Hand-held GPS _____ Survey-grade GPS _____
<u>Waterford</u> <u>Ms.</u> <u>38685</u>	_____ 1/4 _____ 1/4 Sec. <u>11</u> T <u>65</u> R <u>46</u>
City State Zip Code	Distance Direction Nearest Town
Telephone No. <u>(662) 274-4301</u>	<u>1/2</u> Miles <u>West</u> of <u>Louis Hill</u>

Pump Type Circle one	Power Type Circle one
Air Lift Jet <input checked="" type="radio"/> <u>Submersible</u>	Diesel Engine Gasoline Engine Natural Gas
Bucket Piston Turbine	<input checked="" type="radio"/> <u>Electric Motor</u> Hand Tractor PTO
Centrifugal Rotary Flowing Well	Windmill Other (specify): _____
Other (specify): _____	Horse Power Rating of Motor: <u>3/4</u>
Date Pump Installed: <u>7-9-07</u>	Setting Depth: <u>170</u> feet
Rated Pump Capacity: <u>10</u> Gallons Per Minute	Number of Stages: <u>11</u>

RECEIVED
AUG 03 2007
BY: OLWR

Pump Test Data	Method of Measuring Water Level Circle one
Date Well Tested: <u>7-9-07</u>	Air Line Electric Measuring Line <input checked="" type="radio"/> <u>Steel Tape</u>
Static Water Level (A): <u>150</u> Feet Below Land Surface	Other (specify): _____
Pumping Water Level (B): <u>155</u> Feet Below Land Surface	For flowing well, measured shut in head: _____ feet
Drawdown ((B)-(A)): <u>5</u> Feet Below Land Surface	Well yielded <u>15</u> GPM with a drawdown of
Test Pumping Rate: <u>15</u> Gallons Per Minute	<u>5</u> feet after <u>4</u> hours of pumping
Duration of Pump Test (minimum 4 hours): <u>4</u> hours	

I HEREBY CERTIFY that the above statements are true to the best of my knowledge.

LARRY CARPENTER 0-162
Print Name of Pump Installer and License No. (if applicable)

Larry Carpenter
Signature of Pump Installer