

State Well Report

Part 1 - Driller's Log

Mississippi Department of Environmental Quality
Office of Land and Water Resources
P.O. Box 2309
Jackson, MS 39225
(601)961- 5210
(601)961- 5228 (fax)

For Office Use Only:

Aquifer: _____
Well #: TA1
L. S. Elevation: _____
E-log #: _____

County: Marshall
Permit #: _____
Driller: Jones W. Mason
Date drilling completed: 11-25-11

State Law requires that this report be prepared by the license holder responsible for the work and filed with the Department at the above address within 30 days of completion of drilling of the well or borehole.

Information on Well Owner (Landowner if borehole is not for a water well)	Well or Borehole Location
Owner Name: <u>Jimmy Evans</u>	Latitude: <u>34° 36' 278"</u> Longitude: <u>89° 21' 997"</u>
Mailing Address: <u>749 Lebanon rd</u>	Method of Lat/Long (circle one): <u>Ab</u> Conventional Survey, <u>59</u>
<u>Potts Camp MS 38659</u>	USGS quad: <u>Hand-held GPS</u> Survey-grade GPS
City State Zip Code	<u>SW 1/4 SW 1/4 Sec 25 Twn 55 Rng 2W</u>
Telephone No. <u>(662) 551-0823</u>	Distance Direction Nearest Town <u>2.12</u> Miles <u>NW</u> of <u>Bethlehem</u>

Well / Borehole Data

Date drilling started: 11-18-11 Date drilling completed: 11-25-11 Hole depth: 930' Hole diameter: 6 3/4"

Location of the source of any surface water used for drilling: NA

Method of dosing and volume of Chlorine used in drilling and development: NA

Logs run (circle all applicable): No log run Electric Gamma Ray Density Sonic Neutron Other: _____

Name of organization running log(s): NA

Purpose of borehole (check one): Water Well Geotechnical/Geological Investigation ___ Ground Source Heat Pump ___

Seismic Survey ___ Other (describe) NA

If drilling is not related to water well construction, skip the remainder of this block

Purpose of Well (check one): Home Industrial ___ Public Supply ___ Irrigation ___ Fish Culture ___ Other: _____

If a flowing well, method of flow regulation: Valve NA Other (describe) _____

Static Water Level: 70 feet above or below (circle one) land surface Date measured: 11-26-11

Method of Measurement (circle one) steel tape electric tape air line other: string/weight

Well depth: 930 Well grouted to a depth of 10 feet Type of grout (circle one): Neat Cement Bentonite Mix

Casing length: 870 feet Casing diameter: 4 inches Type of casing: pvc

Screen length: 60 feet Screen diameter: 4 inches Type of screen: pvc

Screen slot size: .010 inches Setting depth: From 870 feet to 930 feet

Type of completion (circle all applicable): Gravel packed Underreamed Telescoped Open hole Natural Development

Other (describe): NA

Top of lap pipe or reduction in casing: NA feet. **If telescoped or more than one screen, describe on next page**

Form: OLWR/SAE/11-108
RECEIVED
DEC 29 2011
BY: OLWR

The sketch below only required for water wells

Description of formations encountered must be provided for all wells and boreholes, unless specifically exempted by regulations

If well telescopes, show depths on sketch.

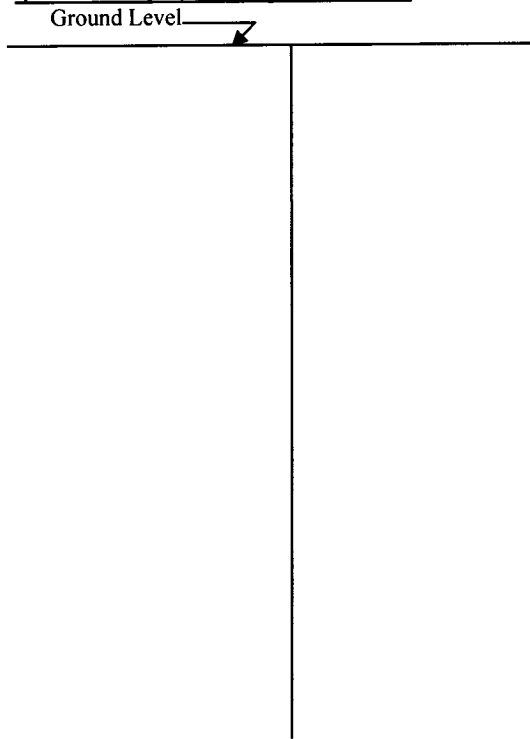

Description of Formations Encountered	From (depth)	To (depth)
clay dirt	Ground Level	15
red sand	15	40
white clay	40	50
Black clay	50	75
Rock	75	76
Black clay.	76	200
gray sand	200	215
Black clay	215	430
Rock	430	435
Black clay	435	730
Rock	730	740
Black clay	740	790
Rock	790	793
Black clay	793	815
Rock	815	820
Black clay	820	840
white sand	840	860
Rock	860	862
white sand	862	900
Rock	900	902
white sand	902	930

If more than one screen, show location of each on sketch

Sketch the property layout and include the following: 1) the well location; 2) any permanent structures on the property that may aid in locating the well; 3) any roads, power lines, or other items that may aid in locating the property and the well; 4) a north arrow.

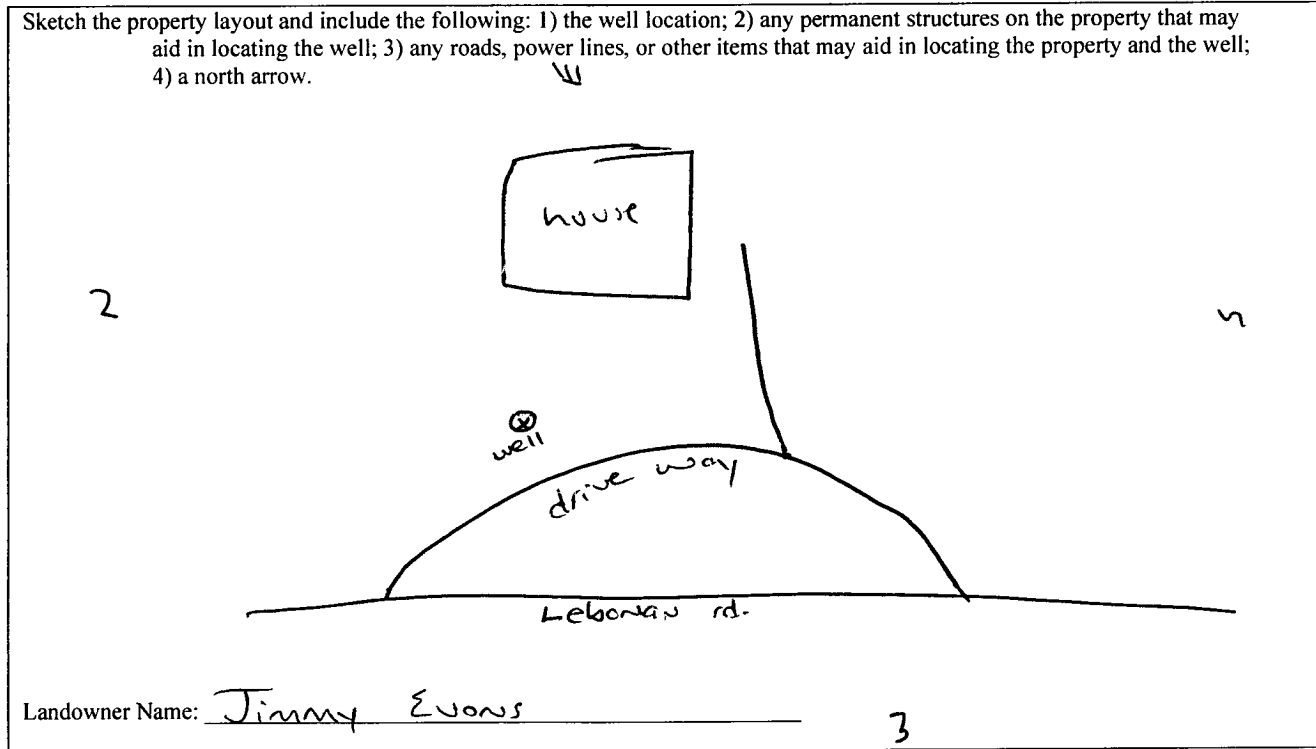

Landowner Name: Jimmy Evans

Form: OLWR-SWR-1A (04/08)

I certify that the well/borehole was drilled, constructed, and completed in accordance with all applicable requirements of the Mississippi Department of Environmental Quality and the Mississippi Department of Health regulations, if applicable, and state laws.

Jones W. Mason 0-620 12-16-11
 Print Name of Responsible Licensee and License No. Date

Jones W. Mason
 Signature of Licensee

RECEIVED
 DEC 20 2011
 BY: OLWR

STATE WELL REPORT

Part 2

Pump Installer's Completion Report
 Mississippi Department of Environmental Quality
 Office of Land and Water Resources
 P.O. Box 2309
 Jackson, MS 39225
 (601)961-5210
 (601)961-5228 (fax)

For Office Use Only:

Aquifer: _____
 Well #: T41
 Elevation: _____

County: Marshall
 Permit #: _____
 Driller: Jones w. Mason
 Date completed: 11-26-11
Copy information from block on Part 1

This part of the report must be completed by a licensed water well contractor or a licensed pump installer. A copy of Part 1 of the report must be attached and both parts filed with the Department at the above address within 30 days of well completion.

Well Owner Information	Well Location
Owner Name: <u>Jimmy Evans</u>	Latitude: <u>34.36.778</u> Longitude: <u>89.21.992</u>
Mailing Address: <u>749 Lebanon rd</u>	Method of Lat/Long (check one): Conventional Survey _____
<u>Potts Camp MS 38659</u>	USGS quad _____, Hand-held GPS <input checked="" type="checkbox"/> , Survey-grade GPS _____
City State Zip Code	<u>SW 1/4 SW 1/4 Sec 25 T 5s R 2w</u>
Telephone No. <u>(662) 551-0823</u>	Distance Direction Nearest Town
	<u>2 1/2</u> Miles <u>nw</u> of <u>Bethlehem</u>

Pump Type Circle one	Power Type Circle one
Air Lift Jet <input type="checkbox"/> <u>Submersible</u> <input checked="" type="checkbox"/>	Diesel Engine Gasoline Engine Natural Gas
Bucket Piston <input type="checkbox"/> Turbine <input type="checkbox"/>	<u>Electric Motor</u> <input checked="" type="checkbox"/> Hand <input type="checkbox"/> Tractor PTO <input type="checkbox"/>
Centrifugal Rotary <input type="checkbox"/> Flowing Well <input type="checkbox"/>	Windmill Other (specify): _____
Other (specify): _____	Horse Power Rating of Motor: <u>1 hp.</u>
Date Pump Installed: <u>11-26-11</u>	Setting Depth: <u>110</u> feet
Rated Pump Capacity: <u>12</u> Gallons Per Minute	Number of Stages: <u>11</u>

Pump Test Data	Method of Measuring Water Level Circle one
Date Well Tested: <u>11-26-11</u>	Air Line Electric Measuring Line Steel Tape
Static Water Level (A): <u>70</u> Feet Below Land Surface	Other (specify): <u>string weight</u>
Pumping Water Level (B): <u>na</u> Feet Below Land Surface	For flowing well, measured shut in head: <u>na</u> feet
Drawdown [(B) - (A)]: <u>na</u> Feet Below Land Surface	Well yielded <u>12</u> GPM with a drawdown of
Test Pumping Rate: <u>12</u> Gallons Per Minute	<u>na</u> feet after <u>24</u> hours of pumping
Duration of Pump Test (minimum 4 hours): <u>24</u> hours	

I HEREBY CERTIFY that the above statements are true to the best of my knowledge.

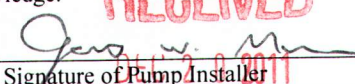
<u>Jones w. Mason 0-620</u> Print Name of Pump Installer and License No. (if applicable)	 Signature of Pump Installer
---	---

RECEIVED RECEIVED
BY: OLWR BY: OLWR
 Form: OLWR-SWR-1B (04/08)