

STATE WELL REPORT

Part 1

Driller's Log

Mississippi Department of Environmental Quality
Office of Land and Water Resources
P.O. Box 2309
Jackson, MS 39225-2309
(601)961-5210
(601)360-0535 (fax)

For Office Use Only:

Well #: R69
Aquifer: _____
E-Log #: _____

County: Marshall
Permit #: _____
Driller: Joel W. Mason
Date drilling completed: 3-20-17

State Law requires that this report be prepared by the license holder responsible for the work and filed with the Department at the above address within 30 days of completion of drilling of the well or borehole.

Well Owner Information <small>(Landowner if borehole is not for a water well)</small>	Well or Borehole Location
Owner Name: <u>Patricia Alexander</u>	Latitude: <u>34°39'34.55"</u> Longitude: <u>89°36'23.13"W</u>
Mailing Address: <u>85 Muse rd.</u>	Method of Lat/Long (check one): Conventional Survey _____
<u>Holly Springs MS 38635</u>	USGS quad _____, Hand-held GPS <input checked="" type="checkbox"/> , Survey-grade GPS _____
City State Zip Code	<u>SW 1/4 SE 1/4, Sec 10 T 4W R 5W</u>
Telephone No. <u>(662) 564-3532</u>	<u>1/4</u> Miles <u>NE</u> of <u>Chulahoma</u>
	(Distance) (Direction) (Nearest Town)

Well / Borehole Data
Date drilling started: <u>3-20-17</u> Date drilling completed: <u>3-20-17</u> Hole depth: <u>225'</u> Hole diameter: <u>2"</u>
Location of the source of any surface water used for drilling: <u>N/A</u>
Method of dosing and volume of Chlorine used in drilling and development: <u>50 ppm and greater</u>
Logs run (circle all applicable): <input checked="" type="checkbox"/> No log run <input type="checkbox"/> Electric <input type="checkbox"/> Gamma Ray <input type="checkbox"/> Density <input type="checkbox"/> Sonic <input type="checkbox"/> Neutron <input type="checkbox"/> Other: <u>N/A</u>
Name of organization running log(s): <u>N/A</u>
Purpose of borehole (circle one): Water Well <input type="checkbox"/> Geotechnical/Geological Investigation <input type="checkbox"/> Ground Source Heat Pump <input type="checkbox"/> Seismic Survey <input type="checkbox"/> Other (describe) <u>N/A</u>
<i>If drilling is not related to water well construction, skip the remainder of this block</i>
Purpose of Well (circle all applicable): <input checked="" type="checkbox"/> Home <input type="checkbox"/> Industrial <input type="checkbox"/> Public Supply <input type="checkbox"/> Irrigation <input type="checkbox"/> Fish Culture
Other (describe): <u>NA</u>
If a flowing well, method of flow regulation: Valve <input checked="" type="checkbox"/> Other (describe) <u>N/A</u>
Static Water Level: <u>200'</u> feet [above or <input checked="" type="checkbox"/> below] land surface Date measured: <u>3-20-17</u> <small>(circle one)</small>
Method of measurement (circle one): Steel tape <input type="checkbox"/> Electric tape <input type="checkbox"/> Air line <input type="checkbox"/> Other (describe): <u>String weight</u>
Well depth: <u>225'</u> Well grouted to a depth of: <u>50'</u> feet Type of grout (circle one): Neat Cement <input type="checkbox"/> <input checked="" type="checkbox"/> Bentonite <input type="checkbox"/> Mix
Casing length: <u>205'</u> feet Casing diameter: <u>4"</u> inches Type of casing: <u>pvc</u>
Screen length: <u>20'</u> feet Screen diameter: <u>4"</u> inches Type of screen: <u>pvc</u>
Screen slot size: <u>010</u> inches Setting depth: From <u>205'</u> feet to <u>225'</u> feet
Type of completion (circle all applicable): <input checked="" type="checkbox"/> Gravel packed <input type="checkbox"/> Underreamed <input type="checkbox"/> Open hole <input type="checkbox"/> Natural Development
Other (describe): <u>N/A</u>
Top of lap pipe or reduction in casing: <u>N/A</u> feet

If telescoped or more than one screen, describe on next page

RECEIVED
APR 21 2017

County: Marshall
 Permit #: _____

For Office Use Only:
 Well #: R69

The sketch below only required for water wells

If well telescopes, show depths on sketch.

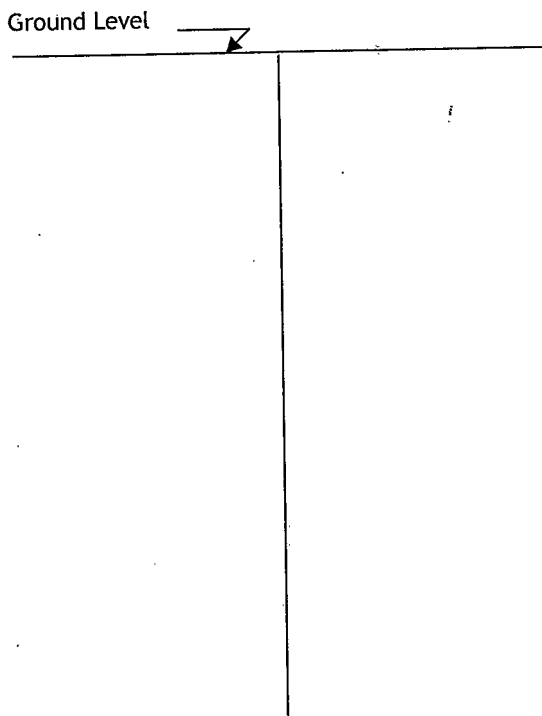

Description of formations encountered must be provided for all wells and boreholes, unless specifically exempted by regulations

Description of Formations Encountered	From (depth)	To (depth)
clay dirt	Ground level	10
white clay	10	40
hard rock	40	42
white clay	42	60
white sand	60	90
white clay	90	125
white sand.	125	150
white clay.	150	185
white sand	185	225

If more than one screen, show location of each on sketch

Sketch the property layout and include the following:

- 1) the well location
- 2) any permanent structures on the property that may aid in locating the well
- 3) any roads, power lines, or other items that may aid in locating the property and the well
- 4) north arrow

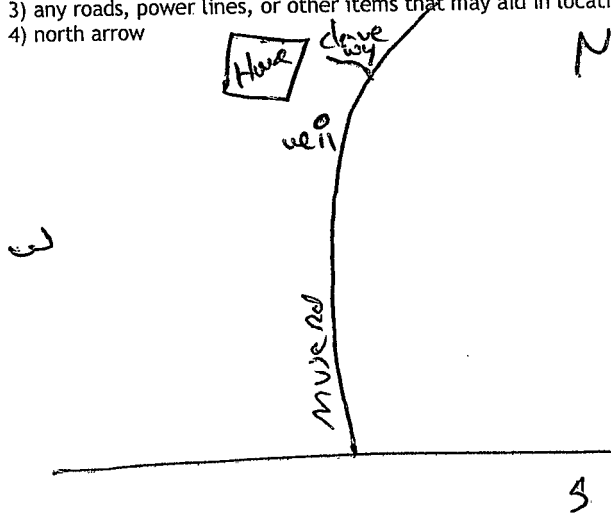

RECEIVED
 APR 21 2017 E
 BY OLWR

4/19/17

Landowner Name: Patricia Alexander

I HEREBY CERTIFY that the well/borehole was drilled, constructed, and completed in accordance with all applicable requirements of the Mississippi Department of Environmental Quality and the Mississippi Department of Health regulations, if applicable, and state laws.

James W. Masor 0-620 4-19-17
 Print Name of Responsible Licensee and License No. Date

James W. Masor
 Signature of Licensee

STATE WELL REPORT

Part 2

Pump Installer's Completion Report

Mississippi Department of Environmental Quality
Office of Land and Water Resources
P.O. Box 2309
Jackson, MS 39225-2309
(601)961-5210
(601) 360-0535 (fax)

For Office Use Only:

Well #: R69

Aquifer: _____

County: Marshall

Permit #: _____

Driller: Jones w. Mason

Date completed: 3-20-17

Copy information from block on Part 1

This part of the report must be completed by a licensed water well contractor or a licensed pump installer. A copy of Part 1 of the report must be attached and both parts filed with the Department at the above address within 30 days of well completion.

Well Owner Information	Well Location
Owner Name: <u>Patricia Alexander</u>	Latitude: <u>34°39'34.55"N</u> Longitude: <u>89°36'23.13"W</u>
Mailing Address: <u>85 mure rd.</u>	Method of Lat/Long (check one): Conventional Survey _____, USGS quad _____, Hand-held GPS <input checked="" type="checkbox"/> , Survey-grade GPS _____
<u>Holly Springs MS 38635</u>	<u>SW 1/4 SE 1/4, Sec 10 T 46 S R 50</u> 4W
City State Zip Code	<u>1.14</u> Miles <u>NE</u> of <u>Chulahoma</u>
Telephone No. <u>(662) 564-3532</u>	(Distance) (Direction) (Nearest Town)

Pump Type (circle one)
 Submersible Turbine Air Lift Centrifugal Flowing Well Jet Piston Rotary Other (describe): _____
Date Pump Installed: 3-20-17 Rated Pump Capacity: 10 Gallons Per Minute
Is This Pump (circle one): New Repaired Replacement

Power Type (circle one)
 Electric Diesel Gasoline Natural Gas Tractor PTO Windmill Other (describe): _____
Horse Power Rating of Motor: 1 hp. Setting Depth: 210 feet Number of Stages: 8

Pump Test Data for Non Flowing Well
Date Well Tested: 3-20-17 Duration of Pump Test (minimum 4 hours): 24 hours
Static Water Level (A): 200 Feet Below Land Surface Pumping Water Level (B): N/A Feet Below Land Surface
Drawdown [(B) - (A)]: N/A Feet Below Land Surface Test Pumping Rate: 10 Gallons Per Minute
Method of measurement (circle one): Steel tape Electric tape Air line Other (describe): string weight

Pump Test Data for Flowing Well
Measured shut in head: N/A feet.
Well yielded 10 GPM with a drawdown of N/A feet after 24 hours of pumping

Meter Installation
Meter Manufacturer: N/A Meter Serial Number: U 12
Meter Model Number/Name: N/A Type of Meter: N/A
Totalizer Register Unit and Multiplier Factor (AF x .001, gal x 1000, etc): N/A
Installation Date: N/A Meter installed by: N/A
Is This Meter (circle one): New Repaired Replacement

RECEIVED
APR 21 2017
BY OLWR

Important: By submitting the above information you are certifying that this meter was installed to manufacturer standards. For agricultural wells, a list of approved meters is on the MDEQ website.

I HEREBY CERTIFY that the above statements are true to the best of my knowledge.

Jones w. Mason O-610 4-19-17 Jones w. Mason
Print Name of Pump Installer and License No. (if applicable) Date Signature of Pump Installer