

State Well Report

Part 1 - Driller's Log

Mississippi Department of Environmental Quality
Office of Land and Water Resources
P.O. Box 2309
Jackson, MS 39225
(601)961- 5210
(601)961- 5228 (fax)

County: Marshall
Permit #: _____
Driller: James W. Mason
Date drilling completed: 7-16-10

For Office Use Only:

Aquifer: N 25
Well #: _____
L. S. Elevation: _____
E-log #: _____

State Law requires that this report be prepared by the license holder responsible for the work and filed with the Department at the above address within 30 days of completion of drilling of the well or borehole.

Information on Well Owner (Landowner if borehole is not for a water well)	Well or Borehole Location
Owner Name: <u>C.C. Jones</u>	Latitude: <u>34° 42' 51.0"</u> Longitude: <u>89° 36' 03.00"</u>
Mailing Address: <u>324 chulahoma rd.</u>	Method of Lat/Long (circle one): Conventional Survey, <u>31</u>
<u>Holly Springs ms. 38635</u>	USGS quad, <u>Hand-held GPS</u> , Survey-grade GPS
City State Zip Code	<u>NE</u> 1/4 <u>SE</u> 1/4 Sec <u>27</u> TwN <u>4S</u> Rng <u>4W</u>
Telephone No. <u>(901) 268-9370</u>	Distance <u>3 1/4</u> Miles Direction <u>S</u> of Nearest Town <u>Marianna</u>

Well / Borehole Data

Date drilling started: 7-16-10 Date drilling completed: 7-16-10 Hole depth: 230' Hole diameter: 6 3/4

Location of the source of any surface water used for drilling: NA
Method of dosing and volume of Chlorine used in drilling and development: NA

Logs run (circle all applicable): No log run Electric Gamma Ray Density Sonic Neutron Other: _____
Name of organization running log(s): NA

Purpose of borehole (check one): Water Well Geotechnical/Geological Investigation _____ Ground Source Heat Pump _____
Seismic Survey _____ Other (describe) _____

If drilling is not related to water well construction, skip the remainder of this block

Purpose of Well (check one): Home Industrial _____ Public Supply _____ Irrigation _____ Fish Culture _____ Other: _____

If a flowing well, method of flow regulation: Valve NA Other (describe) _____

Static Water Level: 168 feet above or below (circle one) land surface Date measured: 7-17-10

Method of Measurement (circle one) steel tape electric tape air line other: string/weight

Well depth: 230 Well grouted to a depth of 10 feet Type of grout (circle one): Neat Cement Bentonite Mix

Casing length: 210 feet Casing diameter: 4 inches Type of casing: pvc

Screen length: 20 feet Screen diameter: 4 inches Type of screen: pvc

Screen slot size: .010 inches Setting depth: From 210 feet to 230 feet

Type of completion (circle all applicable): Gravel packed Underreamed Telescoped Open hole Natural Development
Other (describe): NA

Top of lap pipe or reduction in casing: NA feet. **If telescoped or more than one screen, describe on next page**

Form: OLWR-SWR-1A (04/08)

RECEIVED
AUG 11 2010
BY: OLWR

N105

The sketch below only required for water wells

Description of formations encountered must be provided for all wells and boreholes, unless specifically exempted by regulations

If well telescopes, show depths on sketch.

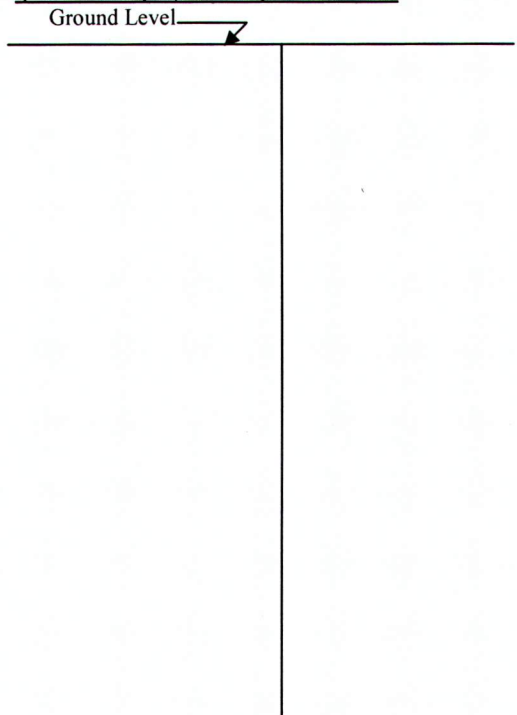

Description of Formations Encountered	From (depth)	To (depth)
Clay dirt	Ground Level	15
white sand	15	160
Black clay	160	185
white sand	185	230

If more than one screen, show location of each on sketch

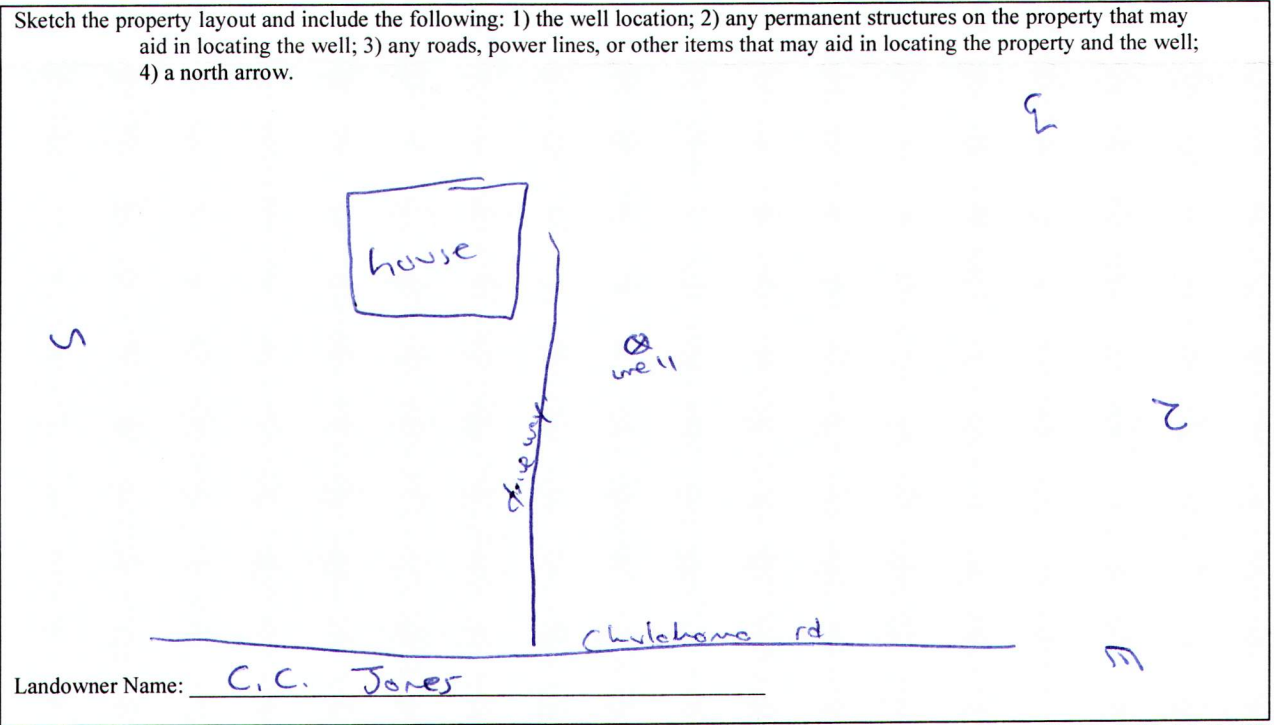

Form: OLWR-SWR-1A (04/08)

I certify that the well/borehole was drilled, constructed, and completed in accordance with all applicable requirements of the Mississippi Department of Environmental Quality and the Mississippi Department of Health regulations, if applicable, and state laws.

Jones W. Mason 0-620 8-10-10

Print Name of Responsible Licensee and License No. Date

Jones W. Mason

Signature of Licensee

RECEIVED
AUG 11 2010
BY: OLWR

STATE WELL REPORT

Part 2

Pump Installer's Completion Report
 Mississippi Department of Environmental Quality
 Office of Land and Water Resources
 P.O. Box 2309
 Jackson, MS 39225
 (601)961-5210
 (601)961-5228 (fax)

County: Marshall
 Permit #: _____
 Driller: Jones vs. Mason
 Date completed: 7-17-10
Copy information from block on Part 1

For Office Use Only:

Aquifer: N105
 Well #: _____
 Elevation: _____

This part of the report must be completed by a licensed water well contractor or a licensed pump installer. A copy of Part 1 of the report must be attached and both parts filed with the Department at the above address within 30 days of well completion.

Well Owner Information	Well Location
Owner Name: <u>C.C. Jones</u>	Latitude: <u>34-42.510</u> Longitude: <u>89-36.013</u>
Mailing Address: <u>324 chulahoma rd</u>	Method of Lat/Long (check one): Conventional Survey _____, USGS quad _____, Hand-held GPS <input checked="" type="checkbox"/> , Survey-grade GPS _____
<u>Holly Springs MS 38635</u>	<u>NE 1/4 SE 1/4 Sec 27 T 45 R 4W</u>
City State Zip Code	Distance Direction Nearest Town
Telephone No. (<u>901</u>) <u>268-9370</u>	<u>314</u> Miles <u>5</u> of <u>Marionna</u>

Pump Type Circle one	Power Type Circle one
Air Lift Jet <input type="checkbox"/> <u>Submersible</u>	Diesel Engine Gasoline Engine Natural Gas
Bucket Piston Turbine	<u>Electric Motor</u> Hand Tractor PTO
Centrifugal Rotary Flowing Well	Windmill Other (specify): _____
Other (specify): _____	Horse Power Rating of Motor: <u>1 hp</u>
Date Pump Installed: <u>7-17-10</u>	Setting Depth: <u>175</u> feet
Rated Pump Capacity: <u>10</u> Gallons Per Minute	Number of Stages: <u>11</u>

Pump Test Data	Method of Measuring Water Level Circle one
Date Well Tested: <u>7-17-10</u>	Air Line Electric Measuring Line Steel Tape
Static Water Level (A): <u>168'</u> Feet Below Land Surface	Other (specify): <u>string / weight</u>
Pumping Water Level (B): <u>NA</u> Feet Below Land Surface	For flowing well, measured shut in head: <u>NA</u> feet
Drawdown [(B) - (A)]: <u>NA</u> Feet Below Land Surface	Well yielded <u>10</u> GPM with a drawdown of
Test Pumping Rate: <u>10</u> Gallons Per Minute	<u>NA</u> feet after <u>24</u> hours of pumping
Duration of Pump Test (minimum 4 hours): <u>24</u> hours	

I HEREBY CERTIFY that the above statements are true to the best of my knowledge.

Jones vs. Mason 0-620 _____
 Print Name of Pump Installer and License No. (if applicable) Signature of Pump Installer

Form: OLWR-SWR-1B (04/08)

RECEIVED
 AUG 11 2010
 BY: OLWR