

# STATE WELL REPORT

446

County: Marshall  
 Permit #: \_\_\_\_\_  
 Driller: Jones W. Mason  
 Date drilling completed: 10-26-19

**Part 1**  
**Driller's Log**  
 Mississippi Department of Environmental Quality  
 Office of Land and Water Resources  
 P.O. Box 2309  
 Jackson, MS 39225-2309  
 (601)961-5210  
 (601)360-0535 (fax)

**For Office Use Only:**  
 Well #: M 100  
 Aquifer: \_\_\_\_\_  
 E-Log #: \_\_\_\_\_

*State Law requires that this report be prepared by the license holder responsible for the work and filed with the Department at the above address within 30 days of completion of drilling of the well or borehole.*

Well Owner Information (Landowner if borehole is not for a water well)	Well or Borehole Location
Owner Name: <u>Wheel Estates</u>	Latitude: <u>34°42'38.48" N</u> Longitude: <u>89°40'49.52" W</u>
Mailing Address: <u>105 Sanders cove</u>	Method of Lat/Long (check one): Conventional Survey _____, USGS quad _____, Hand-held GPS <input checked="" type="checkbox"/> , Survey-grade GPS _____
<u>Byhalia</u> <u>MS</u> <u>38611</u>	<u>SE</u> <u>SW</u> 1/4 <u>NW</u> 1/4, Sec <u>25</u> T. <u>45</u> R. <u>5w</u>
City State Zip Code	<u>1 1/2</u> Miles <u>SW</u> of <u>ORION</u>
Telephone No. <u>(662) (687)-3737</u>	(Distance) (Direction) (Nearest Town)

**Well / Borehole Data**

Date drilling started: 10-26-19 Date drilling completed: 10-26-19 Hole depth: 170 Hole diameter: 7"

Location of the source of any surface water used for drilling: N/A

Method of dosing and volume of Chlorine used in drilling and development: 50 ppm and granules

Logs run (circle all applicable):  No log run  Electric  Gamma Ray  Density  Sonic  Neutron Other: \_\_\_\_\_

Name of organization running log(s): N/A

Purpose of borehole (circle one):  Water Well  Geotechnical/Geological Investigation  Ground Source Heat Pump  Seismic Survey Other (describe) \_\_\_\_\_

*If drilling is not related to water well construction, skip the remainder of this block*

Purpose of Well (circle all applicable):  Home  Industrial  Public Supply  Irrigation  Fish Culture

Other (describe): N/A

If a flowing well, method of flow regulation: Valve N/A Other (describe) \_\_\_\_\_

Static Water Level: 85 feet [above or  below] land surface Date measured: 10-26-19

Method of measurement (circle one): Steel tape  Electric tape  Air line  Other (describe): String weight

Well depth: 170 Well grouted to a depth of: 50 feet Type of grout (circle one): Neat Cement   Bentonite  Mix

Casing length: 150 feet Casing diameter: 4 inches Type of casing: pvc

Screen length: 20 feet Screen diameter: 4 inches Type of screen: pvc

Screen slot size: 10/10 inches Setting depth: From 150 feet to 170 feet

Type of completion (circle all applicable):  Gravel packed  Underreamed  Open hole  Natural Development

Other (describe): N/A

Top of lap pipe or reduction in casing: N/A feet

*If telescoped or more than one screen, describe on next page*

RECEIVED  
 DEC 03 2019  
 BY OLWR

County: \_\_\_\_\_  
 Permit #: \_\_\_\_\_

**For Office Use Only:**  
 Well #: \_\_\_\_\_

The sketch below only required for water wells  
If well telescopes, show depths on sketch.

Description of formations encountered must be provided for all wells and boreholes, unless specifically exempted by regulations

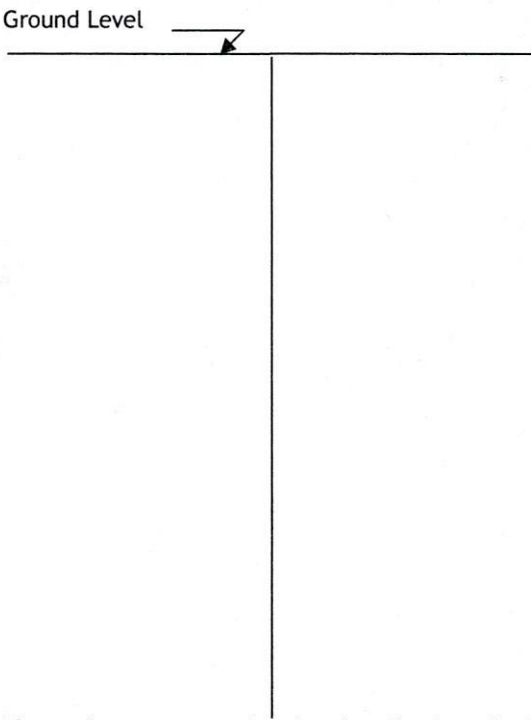

Description of Formations Encountered	From (depth)	To (depth)
red sand	Ground level	10
white clay	10	45
white sand	45	65
white clay	65	68
white sand	68	170

If more than one screen, show location of each on sketch

- Sketch the property layout and include the following:
- 1) the well location
  - 2) any permanent structures on the property that may aid in locating the well
  - 3) any roads, power lines, or other items that may aid in locating the property and the well
  - 4) north arrow

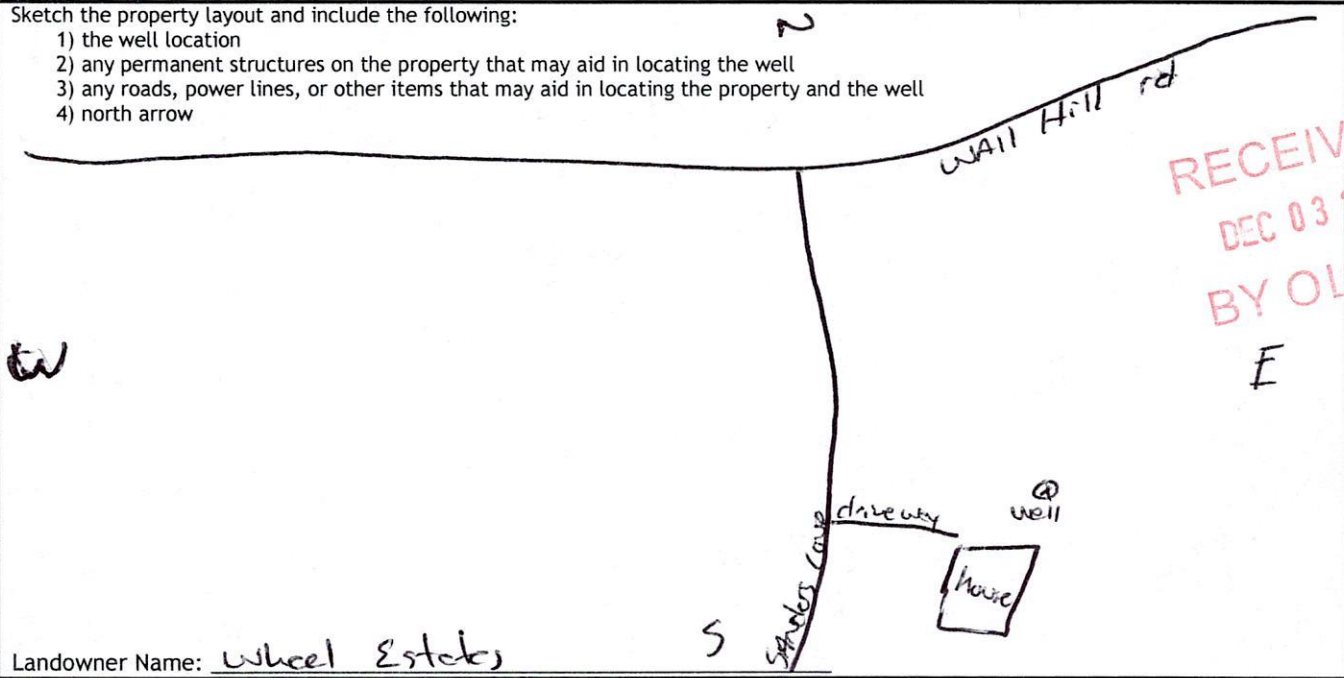

RECEIVED  
 DEC 03 2019  
 BY OLWR  
 E

Landowner Name: Wheel Estates

I HEREBY CERTIFY that the well/borehole was drilled, constructed, and completed in accordance with all applicable requirements of the Mississippi Department of Environmental Quality and the Mississippi Department of Health regulations, if applicable, and state laws.

Janes W. Mason 0-620 11-23-19 Janes W. Mason  
 Print Name of Responsible Licensee and License No. Date Signature of Licensee

# STATE WELL REPORT

## Part 2

**Pump Installer's Completion Report**  
 Mississippi Department of Environmental Quality  
 Office of Land and Water Resources  
 P.O. Box 2309  
 Jackson, MS 39225-2309  
 (601)961-5210  
 (601) 360-0535 (fax)

**For Office Use Only:**

Well #: M 100  
 Aquifer: \_\_\_\_\_

County: Marshall  
 Permit #: \_\_\_\_\_  
 Driller: Jones W. Mason  
 Date completed: 10-26-19  
Copy information from block on Part 1

*This part of the report must be completed by a licensed water well contractor or a licensed pump installer. A copy of Part 1 of the report must be attached and both parts filed with the Department at the above address within 30 days of well completion.*

Well Owner Information	Well Location
Owner Name: <u>Wheel Estates</u>	Latitude: <u>34°42'38.48"</u> Longitude: <u>89°40'49.52"W</u>
Mailing Address: <u>105 Sanders Cove</u>	Method of Lat/Long (check one): Conventional Survey _____, USGS quad _____, Hand-held GPS <input checked="" type="checkbox"/> , Survey-grade GPS _____
<u>Byhalia</u> MS <u>38611</u>	<u>SW<sup>SE</sup></u> 1/4 NW 1/4, Sec <u>25</u> T <u>4S</u> R <u>5W</u>
City State Zip Code	<u>1 1/2</u> Miles <u>SW</u> of <u>Orion</u>
Telephone No. <u>(662) 687-3737</u>	(Distance) (Direction) (Nearest Town)

**Pump Type (circle one)**

Submersible  Turbine  Air Lift  Centrifugal  Flowing Well  Jet  Piston  Rotary  Other (describe): \_\_\_\_\_

Date Pump Installed: 10-26-19 Rated Pump Capacity: 10 Gallons Per Minute

Is This Pump (circle one):  New  Repaired  Replacement

**Power Type (circle one)**

Electric  Diesel  Gasoline  Natural Gas  Tractor PTO  Windmill  Other (describe): \_\_\_\_\_

Horse Power Rating of Motor: 3/4 Setting Depth: 120 feet Number of Stages: 8

**Pump Test Data for Non Flowing Well**

Date Well Tested: 10-26-19 Duration of Pump Test (minimum 4 hours): 24 hours

Static Water Level (A): 85 Feet Below Land Surface Pumping Water Level (B): N/A Feet Below Land Surface

Drawdown [(B) - (A)]: N/A Feet Below Land Surface Test Pumping Rate: 10 Gallons Per Minute

Method of measurement (circle one): Steel tape  Electric tape  Air line  Other (describe): String/weight

**Pump Test Data for Flowing Well**

Measured shut in head: N/A feet.

Well yielded 10 GPM with a drawdown of N/A feet after 24 hours of pumping

**Meter Installation**

Meter Manufacturer: N/A Meter Serial Number: N/A

Meter Model Number/Name: N/A Type of Meter: N/A

Totalizer Register Unit and Multiplier Factor (AF x .001, gal x 1000, etc): N/A

Installation Date: N/A Meter installed by: N/A

Is This Meter (circle one):  New  Repaired  Replacement

**Important: By submitting the above information you are certifying that this meter was installed to manufacturer standards. For agricultural wells, a list of approved meters is on the MDEQ website.**

I HEREBY CERTIFY that the above statements are true to the best of my knowledge.

Jones W. Mason 0-620 11-23-19 [Signature]  
 Print Name of Pump Installer and License No. (if applicable) Date Signature of Pump Installer