

# State Well Report

## Part 1 - Driller's Log

Mississippi Department of Environmental Quality  
 Office of Land and Water Resources  
 P.O. Box 10631  
 Jackson, MS 39289-0631  
 (601)961-5210  
 (601)354-6938 (fax)

County: Marshall  
 Permit #: \_\_\_\_\_  
 Driller: Jones & Mason  
 Date drilling completed: 10-30-07

**For Office Use Only:**  
 Aquifer: \_\_\_\_\_  
 Well #: J-264  
 L. S. Elevation: \_\_\_\_\_  
 E-log #: \_\_\_\_\_

*State Law requires that this report be prepared by the license holder responsible for the work and filed with the Department at the above address within 30 days of completion of drilling of the well or borehole.*

Information on Well Owner (Landowner if borehole is not for a water well)	Well or Borehole Location
Owner Name: <u>Sandra Ferguson</u>	Latitude: <u>34° 49' 694"</u> Longitude: <u>89° 39' 836"</u>
Mailing Address: <u>99 dockery</u>	Method of Lat/Long (circle one): <u>Hand-held GPS</u> Conventional Survey, <u>SO</u>
City: <u>Byhalia</u> State: <u>MS</u> Zip Code: <u>38611</u>	USGS quad, <u>Hand-held GPS</u> , Survey-grade GPS
Telephone No. ( <u>662</u> ) <u>838-4394</u>	<u>SE</u> 1/4 <u>NW</u> 1/4 Sec <u>18</u> Twn <u>35</u> Rng <u>4W</u>
	Distance: <u>1.16</u> Miles Direction: <u>SE</u> Nearest Town: <u>Warsaw</u>

**Well / Borehole Data**

Date drilling started: 10-30-07 Date drilling completed: 10-30-07 Hole depth: 170' Hole diameter: 6 3/4"

Location of the source of any surface water used for drilling: NA

Method of dosing and volume of Chlorine used in drilling and development: NA

Logs run (circle all applicable): (No log run) Electric Gamma Ray Density Sonic Neutron Other: \_\_\_\_\_

Name of organization running log(s): NA

Purpose of borehole (check one): Water Well  Geotechnical/Geological Investigation \_\_\_\_\_ Ground Source Heat Pump \_\_\_\_\_

Seismic Survey \_\_\_\_\_ Other (describe) \_\_\_\_\_

*If drilling is not related to water well construction, skip the remainder of this block*

Purpose of Well (check one): Home  Industrial \_\_\_\_\_ Public Supply \_\_\_\_\_ Irrigation \_\_\_\_\_ Fish Culture \_\_\_\_\_ Other: \_\_\_\_\_

If a flowing well, method of flow regulation: Valve NA Other (describe) \_\_\_\_\_

Static Water Level: 78 feet above or below (circle one) land surface Date measured: 11-2-07

Method of Measurement (circle one) steel tape electric tape air line other: String Weight

Well depth: 170 Well grouted to a depth of 10 feet Type of grout (circle one): Neat Cement Bentonite Mix

Casing length: 160 feet Casing diameter: 4 inches Type of casing: PVC

Screen length: 10 feet Screen diameter: 4 inches Type of screen: PVC

Screen slot size: .010 inches Setting depth: From 160 feet to 170 feet

Type of completion (circle all applicable): Gravel packed Underreamed Telescoped Open hole Natural Development

Other (describe): NA

Top of lap pipe or reduction in casing: NA feet. *If telescoped or more than one screen, describe on next page*

Form: OLWR-SWR-1A

RECEIVED  
 NOV 29 2007  
 BY: OLWR

J-264

The sketch below only required for water wells

If well telescopes, show depths on sketch.

Ground Level →

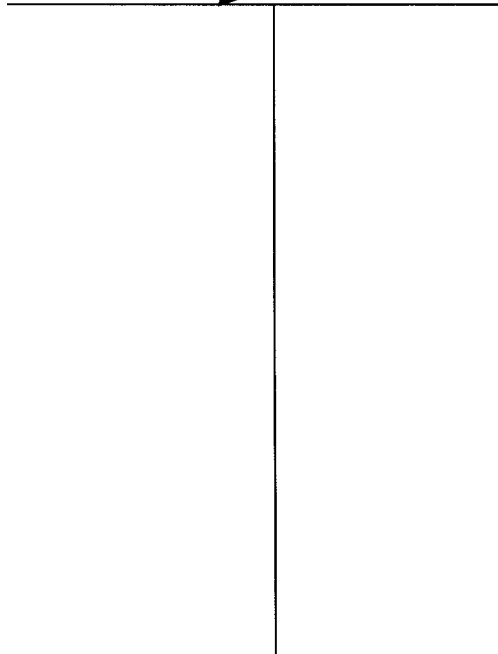

Description of formations encountered must be provided for all wells and boreholes, unless specifically exempted by regulations

Description of Formations Encountered	From (depth)	To (depth)
clay dirt	Ground Level	30
white sand	30	80
Rock	80	82
Blue clay	82	150
white sand	150	170

If more than one screen, show location of each on sketch

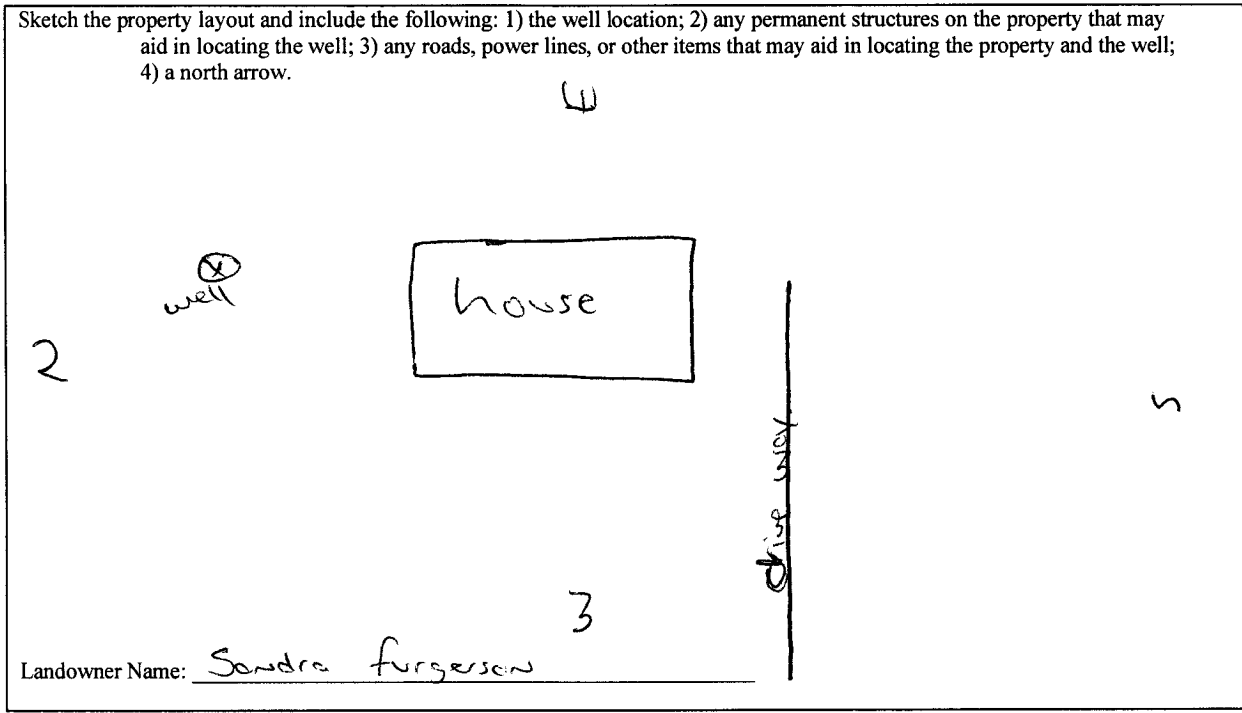

Form: OLWR-SWR-1A

I certify that the well/borehole was drilled, constructed, and completed in accordance with all applicable requirements of the Mississippi Department of Environmental Quality and the Mississippi Department of Health regulations, if applicable, and state laws.

James W. Mason 0-620  
Print Name of Responsible Licensee and License No.

11-26-07  
Date

James W. Mason  
Signature of Licensee

**RECEIVED**

NOV 29 2007

**BY: OLWR**

# STATE WELL REPORT

## Part 2

**Pump Installer's Completion Report**  
 Mississippi Department of Environmental Quality  
 Office of Land and Water Resources  
 P.O. Box 10631  
 Jackson, MS 39289-0631  
 (601)961-5210  
 (601)354-6938 (fax)

County: Marshall  
 Permit #: \_\_\_\_\_  
 Driller: James W. Mason  
 Date completed: 10-30-07  
*Copy information from block on Part 1*

**For Office Use Only:**

Aquifer: \_\_\_\_\_  
 Well #: J-264  
 Elevation: \_\_\_\_\_

*This part of the report must be completed by a licensed water well contractor or a licensed pump installer. A copy of Part 1 of the report must be attached and both parts filed with the Department at the above address within 30 days of well completion.*

Well Owner Information	Well Location
Owner Name: <u>Sandra Ferguson</u>	Latitude: <u>34.49.674</u> Longitude: <u>89.39.836</u>
Mailing Address: <u>99 docker</u>	Method of Lat/Long (check one): Conventional Survey _____
<u>Byhalia MS 38611</u> City State Zip Code	USGS quad _____ Hand-held GPS <input checked="" type="checkbox"/> Survey-grade GPS _____
Telephone No. ( <u>662</u> ) <u>838-4394</u>	<u>SE 1/4 NW 1/4 Sec 18 T3S R 4w</u>
	Distance Direction Nearest Town <u>1.16</u> Miles <u>SE</u> of <u>Warsaw</u>

Pump Type Circle one	Power Type Circle one
Air Lift Jet <input type="checkbox"/> <u>Submersible</u> <input checked="" type="checkbox"/>	Diesel Engine Gasoline Engine Natural Gas
Bucket Piston <input type="checkbox"/> Turbine <input type="checkbox"/>	<u>Electric Motor</u> <input checked="" type="checkbox"/> Hand <input type="checkbox"/> Tractor PTO <input type="checkbox"/>
Centrifugal Rotary <input type="checkbox"/> Flowing Well <input type="checkbox"/>	Windmill Other (specify): _____
Other (specify): _____	Horse Power Rating of Motor: <u>3/4</u>
Date Pump Installed: <u>11-2-07</u>	Setting Depth: <u>100</u> feet
Rated Pump Capacity: <u>10</u> Gallons Per Minute	Number of Stages: <u>8</u>

Pump Test Data	Method of Measuring Water Level Circle one
Date Well Tested: <u>11-2-07</u>	Air Line Electric Measuring Line Steel Tape
Static Water Level (A): <u>78</u> Feet Below Land Surface	Other (specify): <u>String weight</u>
Pumping Water Level (B): <u>NA</u> Feet Below Land Surface	For flowing well, measured shut in head: <u>NA</u> feet
Drawdown [(B) - (A)]: <u>NA</u> Feet Below Land Surface	Well yielded <u>10</u> GPM with a drawdown of
Test Pumping Rate: <u>10</u> Gallons Per Minute	<u>NA</u> feet after <u>24</u> hours of pumping
Duration of Pump Test (minimum 4 hours): <u>24</u> hours	

I HEREBY CERTIFY that the above statements are true to the best of my knowledge.

James W. Mason 0620 \_\_\_\_\_  
 Print Name of Pump Installer and License No. (if applicable) Signature of Pump Installer

Form: OLWR-SWR-1B

RECEIVED

NOV 23 2007

BY: OLWR