

**State Well Report
Part 1 - Driller's Log**

Mississippi Department of Environmental Quality
Office of Land and Water Resources
P.O. Box 10631
Jackson, MS 39289-0631
(601)961-5210
(601)354-6938 (fax)

County: Marshall
Permit #: _____
Driller: Jones W. Mason
Date drilling completed: 4-12-06

For Office Use Only:

Aquifer: _____
Well #: H-267
L. S. Elevation: _____
E-log #: _____

State Law requires that this report be prepared by the license holder responsible for the work and filed with the Department at the above address within 30 days of completion of drilling of the well or borehole.

Information on Well Owner <small>(Landowner if borehole is not for a water well)</small>	Well or Borehole Location
Owner Name: <u>Randy Coffman</u>	Latitude: <u>34° 48' 46.8"</u> Longitude: <u>89° 42' 639.8"</u>
Mailing Address: <u>690 Shammrock Loop</u>	Method of Lat/Long (circle one): Conventional Survey, <u>28</u>
<u>LOT 50</u>	USGS quad: <u>Hand-held GPS</u> Survey-grade GPS
<u>Byhalie MS 38611</u>	<u>SW</u> 1/4 <u>NE</u> 1/4 Sec <u>22</u> Twn <u>3s</u> Rng <u>5w</u>
City State Zip Code	NW SE Direction Nearest Town
Telephone No. <u>(662) 838-3773</u>	<u>112</u> Miles <u>NW</u> of <u>Watson</u>
Well / Borehole Data	
Date drilling started: <u>4-12-06</u> Date drilling completed: <u>4-12-06</u> Hole depth: <u>125'</u> Hole diameter: <u>6 3/4</u>	
Location of the source of any surface water used for drilling: <u>NA</u>	
Method of dosing and volume of Chlorine used in drilling and development: <u>NA</u>	
Logs run (circle all applicable): <u>No log run</u> Electric Gamma Ray Density Sonic Neutron Other: _____	
Name of organization running log(s): <u>NA</u>	
Purpose of borehole (check one): Water Well <input checked="" type="checkbox"/> Geotechnical/Geological Investigation _____ Ground Source Heat Pump _____	
Seismic Survey _____ Other (describe) _____	
<i>If drilling is not related to water well construction, skip the remainder of this block</i>	
Purpose of Well (check one): Home <input checked="" type="checkbox"/> Industrial _____ Public Supply _____ Irrigation _____ Fish Culture _____ Other: _____	
If a flowing well, method of flow regulation: Valve <u>NA</u> Other (describe) _____	
Static Water Level: <u>65</u> feet above <u>or below</u> (circle one) land surface Date measured: <u>4-13-06</u>	
Method of Measurement (circle one) steel tape electric tape air line other: <u>String Weight</u>	
Well depth: <u>125</u> Well grouted to a depth of <u>10</u> feet Type of grout (circle one): Neat Cement <u>Bentonite</u> Mix	
Casing length: <u>115</u> feet Casing diameter: <u>4</u> inches Type of casing: <u>pvc</u>	
Screen length: <u>10</u> feet Screen diameter: <u>4</u> inches Type of screen: <u>pvc</u>	
Screen slot size: <u>010</u> inches Setting depth: From <u>115</u> feet to <u>125</u> feet	
Type of completion (circle all applicable): <u>Gravel packed</u> Underreamed Telescoped Open hole Natural Development	
Other (describe): <u>NA</u>	
Top of lap pipe or reduction in casing: <u>NA</u> feet. <i>If telescoped or more than one screen, describe on next page</i>	

Form: OLWR-SWR-1A

RECEIVED
MAY 11 2006
BY: OLWR

H-267

The sketch below only required for water wells

If well telescopes, show depths on sketch.

Ground Level 

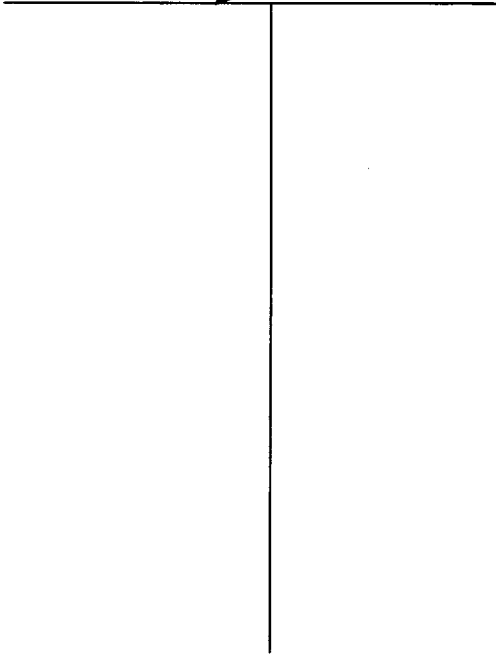

Description of formations encountered must be provided for all wells and boreholes, unless specifically exempted by regulations

Description of Formations Encountered	From (depth)	To (depth)
clay dirt.	Ground Level	25
white sand.	25	125.

If more than one screen, show location of each on sketch

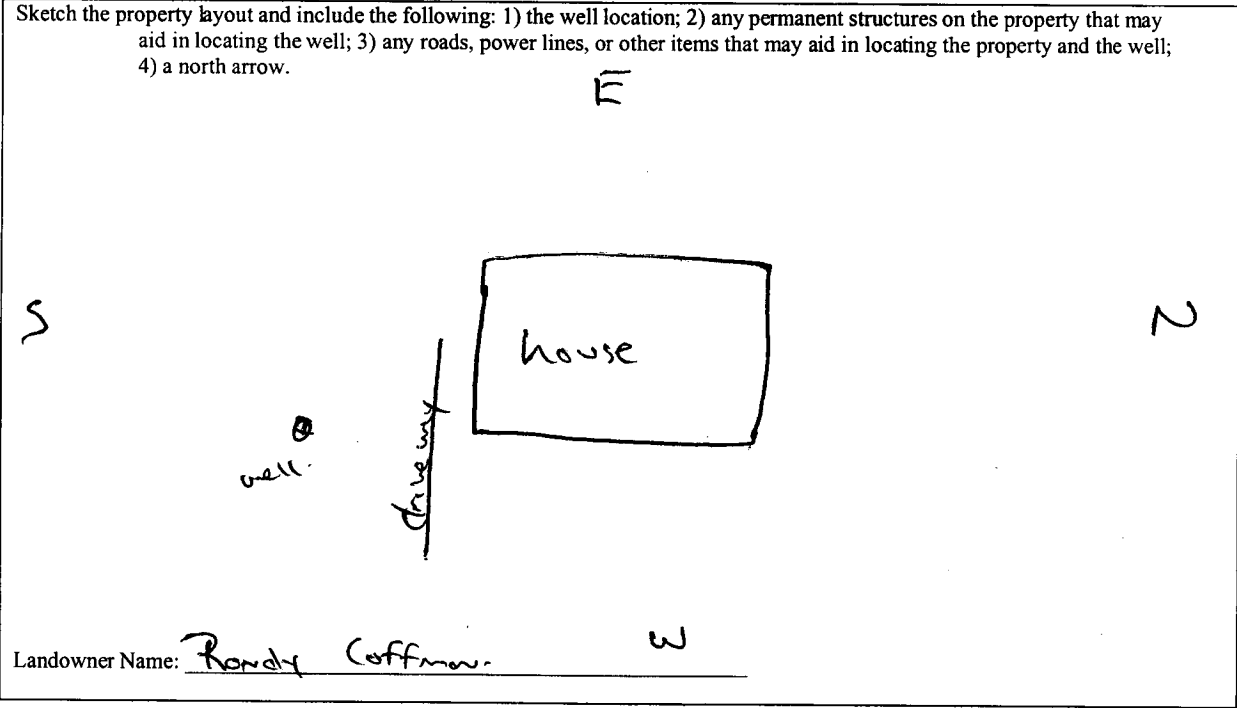

Landowner Name: Randy Coffman W

Form: OLWR-SWR-1A

I certify that the well/borehole was drilled, constructed, and completed in accordance with all applicable requirements of the Mississippi Department of Environmental Quality and the Mississippi Department of Health regulations, if applicable, and state laws.

Jones W. Mason 0-630 5-8-06
Print Name of Responsible Licensee and License No. Date

Jones W. Mason
Signature of Licensee

RECEIVED
MAY 11 2006
BY: OLWR

STATE WELL REPORT

Part 2

Pump Installer's Completion Report
 Mississippi Department of Environmental Quality
 Office of Land and Water Resources
 P.O. Box 10631
 Jackson, MS 39289-0631
 (601)961-5210
 (601)354-6938 (fax)

County: Marshall
 Permit #: _____
 Driller: Jones W. Masor
 Date completed: 4-12-06
Copy information from block on Part 1

For Office Use Only:

Aquifer: _____
 Well #: H-267
 Elevation: _____

This part of the report must be completed by a licensed water well contractor or a licensed pump installer. A copy of Part 1 of the report must be attached and both parts filed with the Department at the above address within 30 days of well completion.

Well Owner Information	Well Location
Owner Name: <u>Randy Coffman</u>	Latitude: <u>34.48.468</u> Longitude: <u>89.42.639</u>
Mailing Address: <u>690 Shamrock Loop</u>	Method of Lat/Long (check one): Conventional Survey _____, <u>28</u>
<u>LOT 50</u>	USGS quad _____, Hand-held GPS <input checked="" type="checkbox"/> , Survey-grade GPS _____
<u>Bahalia</u> <u>ms</u> <u>38611</u>	<u>SW 1/4 NE 1/4 Sec 22 T 3s R 5w</u>
City State Zip Code	Distance Direction Nearest Town
Telephone No. <u>(662) 838-3773</u>	<u>1.12</u> Miles <u>SW</u> of <u>Watson</u>

Pump Type Circle one	Power Type Circle one
Air Lift Jet <input type="checkbox"/> <u>Submersible</u> <input type="checkbox"/>	Diesel Engine Gasoline Engine Natural Gas
Bucket Piston Turbine <input type="checkbox"/>	<u>Electric Motor</u> <input type="checkbox"/> Hand Tractor PTO
Centrifugal Rotary Flowing Well	Windmill Other (specify): _____
Other (specify): _____	Horse Power Rating of Motor: <u>3/4</u>
Date Pump Installed: <u>4-13-06</u>	Setting Depth: <u>80</u> feet
Rated Pump Capacity: <u>12</u> Gallons Per Minute	Number of Stages: <u>11</u>

Pump Test Data	Method of Measuring Water Level Circle one
Date Well Tested: <u>4-13-06</u>	Air Line Electric Measuring Line Steel Tape
Static Water Level (A): <u>65</u> Feet Below Land Surface	Other (specify): <u>string weight</u>
Pumping Water Level (B): <u>NA</u> Feet Below Land Surface	For flowing well, measured shut in head: <u>NA</u> feet
Drawdown [(B) - (A)]: <u>NA</u> Feet Below Land Surface	Well yielded <u>12</u> GPM with a drawdown of
Test Pumping Rate: <u>12</u> Gallons Per Minute	<u>NA</u> feet after <u>24</u> hours of pumping
Duration of Pump Test (minimum 4 hours): <u>24</u> hours	

I HEREBY CERTIFY that the above statements are true to the best of my knowledge.

Jones W. Masor _____
 Print Name of Pump Installer and License No. (if applicable) Signature of Pump Installer

Form: OLWR-SWR-48
RECEIVED
 MAY 11 2006
 BY: OLWR