

County: Marshall  
 Permit #: 0-162  
 Driller: Larry Casper  
 Date drilling completed: 4-30-09

# State Well Report

## Part 1 - Driller's Log

Mississippi Department of Environmental Quality  
 Office of Land and Water Resources  
 P.O. Box 10631  
 Jackson, MS 39289-0631  
 (601)961-5210  
 (601)354-6938 (fax)

For Office Use Only:  
 Aquifer: \_\_\_\_\_  
 Well #: E-236  
 L. S. Elevation: \_\_\_\_\_  
 E-log #: \_\_\_\_\_

State Law requires that this report be prepared by the license holder responsible for the work and filed with the Department at the above address within 30 days of completion of drilling of the well or borehole.

Information on Well Owner (Landowner if borehole is not for a water well)	Well or Borehole Location
Owner Name: <u>Robert Taylor</u>	Latitude: <u>34° 53' 44"</u> Longitude: <u>89° 40' 13"</u>
Mailing Address: <u>914 Bubba Taylor Rd</u>	Method of Lat/Long (circle one): Conventional Survey, USGS quad, Hand-held GPS, Survey-grade GPS
<u>Byzola</u> City <u>Ms.</u> State <u>38611</u> Zip Code	<u>NW 1/4 SW 1/4 Sec 19</u> Twn <u>25</u> Rng <u>44</u>
Telephone No. <u>(901) 359-8344</u>	Distance <u>2</u> Miles <u>North</u> Direction of <u>Byzola</u> Nearest Town

**Well / Borehole Data**

Date drilling started: 4-30-09 Date drilling completed: 4-30-09 Hole depth: 124' Hole diameter: 8"

Location of the source of any surface water used for drilling: Well Water

Method of dosing and volume of Chlorine used in drilling and development: 1/2 Pt. Chlorine to 1000 Gal. Water

Logs run (circle all applicable):  No log run     Electric     Gamma Ray     Density     Sonic     Neutron    Other: \_\_\_\_\_

Name of organization running log(s): \_\_\_\_\_

Purpose of borehole (check one): Water Well  Geotechnical/Geological Investigation \_\_\_\_\_ Ground Source Heat Pump \_\_\_\_\_

Seismic Survey \_\_\_\_\_ Other (describe) \_\_\_\_\_

**If drilling is not related to water well construction, skip the remainder of this block**

Purpose of Well (check one): Home  Industrial \_\_\_\_\_ Public Supply \_\_\_\_\_ Irrigation \_\_\_\_\_ Fish Culture \_\_\_\_\_ Other: \_\_\_\_\_

If a flowing well, method of flow regulation: Valve \_\_\_\_\_ Other (describe) \_\_\_\_\_

Static Water Level: 70 feet above or below (circle one) land surface    Date measured: 4-30-09

Method of Measurement (circle one)  steel tape     electric tape     air line    other: \_\_\_\_\_

Well depth: 124' Well grouted to a depth of 10 feet    Type of grout (circle one)  Neat Cement     Bentonite     Mix

Casing length: 114 feet    Casing diameter: 4 inches    Type of casing: PVC

Screen length: 10 feet    Screen diameter: 4 inches    Type of screen: PVC

Screen slot size: .013 inches    Setting depth: From 114 feet to 124 feet

Type of completion (circle all applicable):  Gravel packed     Underreamed     Telescoped     Open hole     Natural Development

Other (describe): \_\_\_\_\_

Top of lap pipe or reduction in casing: \_\_\_\_\_ feet. If telescoped or more than one screen, describe on next page

Form: OLWR-SWR-1A

RECEIVED  
 MAY 21 2009  
 BY: OLWR

If well telescopes, show depths on sketch.

Ground Level  $\rightarrow$

Description of Formations Encountered	From (depth)	To (depth)
Surface Soil	0	18
Med. Red Sand	18	41
Fine White Sand	41	65
White Clay	65	82
Med White Sand	82	100
Coarse White Sand	100	124

If more than one screen, show location of each on sketch

Sketch the property layout and include the following: 1) the well location; 2) any permanent structures on the property that may aid in locating the well; 3) any roads, power lines, or other items that may aid in locating the property and the well; 4) a north arrow.

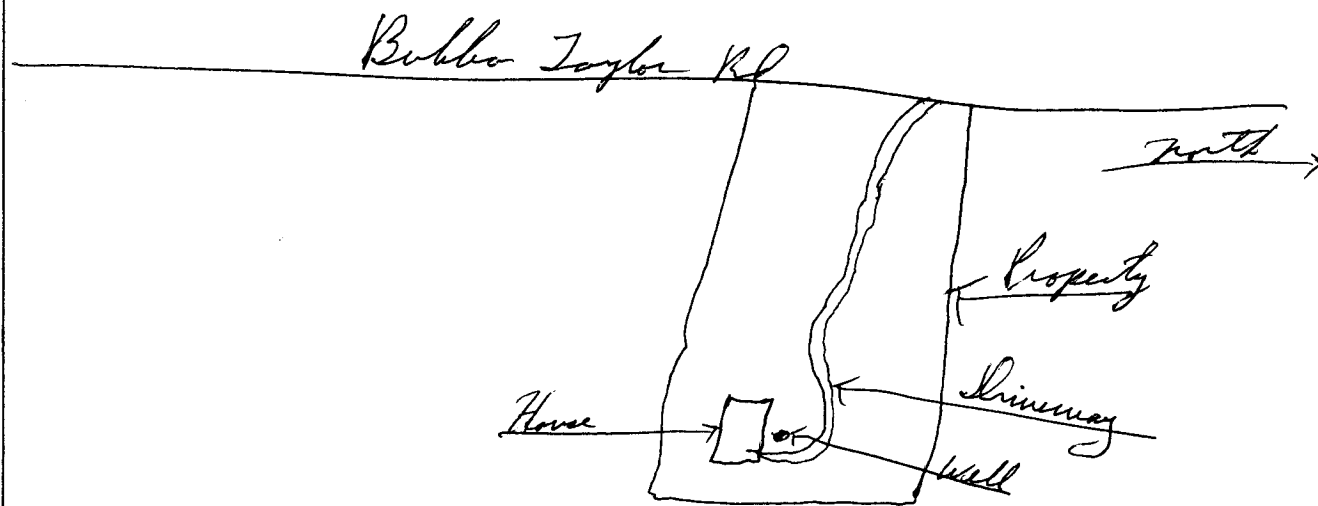

Landowner Name: Robert Taylor

Form: OLWR-SWR-1A

I certify that the well/borehole was drilled, constructed, and completed in accordance with all applicable requirements of the Mississippi Department of Environmental Quality and the Mississippi Department of Health regulations, if applicable, and state laws.

LARRY CARPENTER 0-160  
Print Name of Responsible Licensee and License No.

5-10-09  
Date

Larry Carpenter  
Signature of Licensee

RECEIVED  
MAY 21 2009  
BY: OLWR

# STATE WELL REPORT

## Part 2

**Pump Installer's Completion Report**  
 Mississippi Department of Environmental Quality  
 Office of Land and Water Resources  
 P.O. Box 10631  
 Jackson, MS 39289-0631  
 (601)961-5210  
 (601)354-6938 (fax)

County: Marshall  
 Permit #: 0-162  
 Driller: Larry Carpenter  
 Date completed: 4-30-09  
*Copy information from block on Part 1*

For Office Use Only:

Aquifer: \_\_\_\_\_  
 Well #: E-236  
 Elevation: \_\_\_\_\_

*This part of the report must be completed by a licensed water well contractor or a licensed pump installer. A copy of Part 1 of the report must be attached and both parts filed with the Department at the above address within 30 days of well completion.*

Well Owner Information	Well Location
Owner Name: <u>Robert Taylor</u>	Latitude: _____ Longitude: _____
Mailing Address: <u>914 Bubba Taylor Rd.</u>	Method of Lat/Long (check one): Conventional Survey _____
<u>Bygdalia</u> <u>Ms.</u> <u>38611</u>	USGS quad _____, Hand-held GPS _____, Survey-grade GPS _____
City State Zip Code	_____ 1/4 _____ 1/4 Sec <u>19</u> T <u>25</u> R <u>4W</u>
Telephone No. ( <u>901</u> ) <u>359-8344</u>	Distance Direction Nearest Town
	<u>2</u> Miles <u>North</u> of <u>Bygdalia</u>

Pump Type Circle one	Power Type Circle one
Air Lift Jet <input checked="" type="radio"/> <u>Submersible</u>	Diesel Engine Gasoline Engine Natural Gas
Bucket Piston Turbine	<input checked="" type="radio"/> <u>Electric Motor</u> Hand Tractor PTO
Centrifugal Rotary Flowing Well	Windmill Other (specify): _____
Other (specify): _____	Horse Power Rating of Motor: <u>3/4</u>
Date Pump Installed: <u>4-30-09</u>	Setting Depth: <u>100</u> feet
Rated Pump Capacity: <u>10</u> Gallons Per Minute	Number of Stages: <u>11</u>

Pump Test Data	Method of Measuring Water Level Circle one
Date Well Tested: <u>4-30-09</u>	Air Line Electric Measuring Line <input checked="" type="radio"/> <u>Steel Tape</u>
Static Water Level (A): <u>70</u> Feet Below Land Surface	Other (specify): _____
Pumping Water Level (B): <u>75</u> Feet Below Land Surface	For flowing well, measured shut in head: _____ feet
Drawdown [(B) - (A)]: <u>5</u> Feet Below Land Surface	Well yielded <u>17</u> GPM with a drawdown of
Test Pumping Rate: <u>17</u> Gallons Per Minute	<u>5</u> feet after <u>4</u> hours of pumping
Duration of Pump Test (minimum 4 hours): <u>4</u> hours	

RECEIVED

I HEREBY CERTIFY that the above statements are true to the best of my knowledge.

LARRY CARPENTER 0-162 Larry Carpenter  
 Print Name of Pump Installer and License No. (if applicable) Signature of Pump Installer

MAY 21 2009  
 BY: OLWR  
 Form: OLWR-SWR-1B