

State Well Report

Part 1 - Driller's Log

Mississippi Department of Environmental Quality
Office of Land and Water Resources
P.O. Box 10631
Jackson, MS 39289-0631
(601)961-5210
(601)354-6938 (fax)

For Office Use Only:

Aquifer: _____
Well #: E-216
L. S. Elevation: _____
E-log #: _____

County: Marshall
Permit #: 0-162
Driller: Larry Carpenter
Date drilling completed: 6-30-08

State Law requires that this report be prepared by the license holder responsible for the work and filed with the Department at the above address within 30 days of completion of drilling of the well or borehole.

Information on Well Owner <i>(Landowner if borehole is not for a water well)</i>	Well or Borehole Location
Owner Name: <u>Jack Syfon</u>	Latitude: <u>34° 53' 21"</u> Longitude: <u>89° 36' 51"</u>
Mailing Address: <u>124 Mac Corn Farm Rd.</u>	Method of Lat/Long (circle one): Conventional Survey, USGS quad, Hand-held GPS, Survey-grade GPS
<u>Byhalia</u> <u>Ms</u> <u>38611</u>	NW 1/4 NW 1/4 Sec <u>27</u> Twn <u>25</u> Rng <u>4W</u>
City State Zip Code	Distance Direction Nearest Town
Telephone No. <u>(761) 581-2345</u>	<u>3</u> Miles <u>North</u> of <u>Victoria</u>

Well / Borehole Data

Date drilling started: 6-30-08 Date drilling completed: 6-30-08 Hole depth: 130' Hole diameter: 8"

Location of the source of any surface water used for drilling: Well Water

Method of dosing and volume of Chlorine used in drilling and development: 1/2 lb Chlorine to 1000 Gal Water

Logs run (circle all applicable) No log run Electric Gamma Ray Density Sonic Neutron Other: _____

Name of organization running log(s): _____

Purpose of borehole (check one): Water Well Geotechnical/Geological Investigation Ground Source Heat Pump

Seismic Survey Other (describe) _____

If drilling is not related to water well construction, skip the remainder of this block

Purpose of Well (check one): Home Industrial Public Supply Irrigation Fish Culture Other: _____

If a flowing well, method of flow regulation: Valve _____ Other (describe) _____

Static Water Level: 80 feet above or below (circle one) land surface Date measured: 6-30-08

Method of Measurement (circle one) steel tape electric tape air line other: _____

Well depth: 130' Well grouted to a depth of 10 feet Type of grout (circle one) Neat Cement Bentonite Mix

Casing length: 120 feet Casing diameter: 4 inches Type of casing: PVC

Screen length: 10 feet Screen diameter: 4 inches Type of screen: PVC

Screen slot size: .013 inches Setting depth: From 120 feet to 130 feet

Type of completion (circle all applicable) Gravel packed Underreamed Telescoped Open hole Natural Development

Other (describe): _____

Top of lap pipe or reduction in casing: _____ feet. *If telescoped or more than one screen, describe on next page*

Form: OLWR-SWR-1A
RECEIVED
JUL 25 2008
BY: OLWR

E-216

The sketch below only required for water wells

If well telescopes, show depths on sketch.

Ground Level →

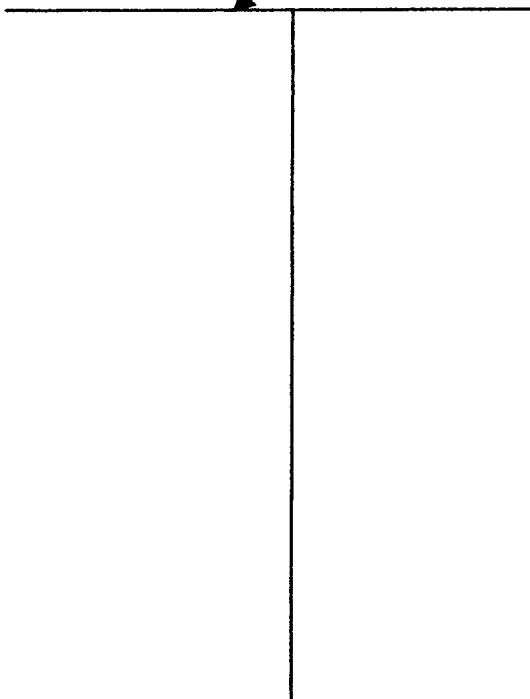

Description of formations encountered must be provided for all wells and boreholes, unless specifically exempted by regulations

Description of Formations Encountered	From (depth)	To (depth)
Surface Soil	0 Ground Level	18
Med Red Sand	18	35
Fine White Sand	35	70
White Clay	70	82
Med White Sand	82	100
Coarse White Sand	100	130

If more than one screen, show location of each on sketch

Sketch the property layout and include the following: 1) the well location; 2) any permanent structures on the property that aid in locating the well; 3) any roads, power lines, or other items that may aid in locating the property and the well; 4) a north arrow.

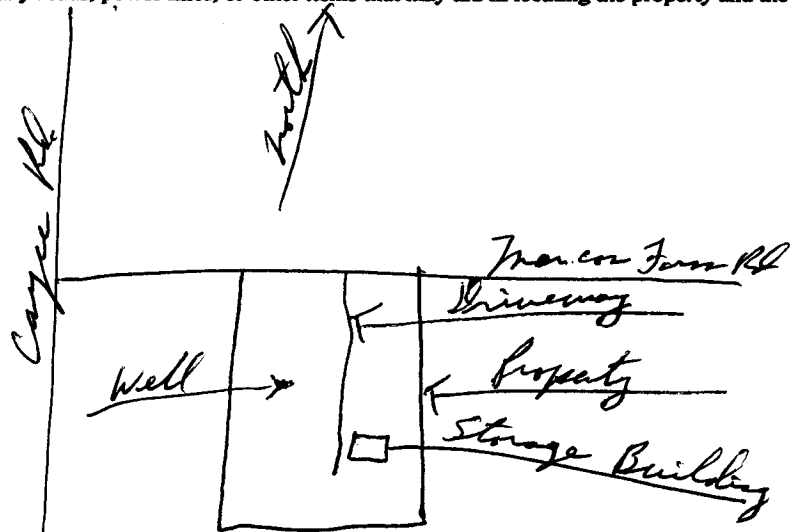

Landowner Name: Jack Syfer

Form: OLWR-SWR-1A

I certify that the well/borehole was drilled, constructed, and completed in accordance with all applicable requirements of the Mississippi Department of Environmental Quality and the Mississippi Department of Health regulations, if applicable, and state laws.

LARRY CARPENTER 6-162 6-30-08

Larry Carpenter RECEIVED

Print Name of Responsible Licensee and License No.

Date

Signature of Licensee

JUL 25 2008

BY: OLWR

STATE WELL REPORT

Part 2

Pump Installer's Completion Report
 Mississippi Department of Environmental Quality
 Office of Land and Water Resources
 P.O. Box 10631
 Jackson, MS 39289-0631
 (601)961-5210
 (601)354-6938 (fax)

County: Marshall
 Permit #: 0-162
 Driller: Larry Carpenter
 Date completed: 6-30-08
Copy information from block on Part 1

For Office Use Only:

Aquifer: _____
 Well #: E-216
 Elevation: _____

This part of the report must be completed by a licensed water well contractor or a licensed pump installer. A copy of Part 1 of the report must be attached and both parts filed with the Department at the above address within 30 days of well completion.

Well Owner Information	Well Location
Owner Name: <u>Jack Syfan</u>	Latitude: _____ Longitude: _____
Mailing Address: <u>124 Marcor Farm Rd.</u>	Method of Lat/Long (check one): Conventional Survey _____
<u>Byhalia</u> <u>Ms.</u> <u>38611</u>	USGS quad _____, Hand-held GPS _____, Survey-grade GPS _____
City State Zip Code	_____ 1/4 _____ 1/4 Sec <u>27</u> T <u>25</u> R <u>4W</u>
Telephone No. <u>(901) 581-2345</u>	Distance Direction Nearest Town
	<u>3</u> Miles <u>South</u> of <u>Victoria</u>

Pump Type Circle one	Power Type Circle one
Air Lift Jet <input type="radio"/> <input checked="" type="radio"/> Submersible	Diesel Engine Gasoline Engine Natural Gas
Bucket Piston <input type="radio"/> Turbine <input type="radio"/>	<input checked="" type="radio"/> Electric Motor Hand <input type="radio"/> Tractor PTO
Centrifugal Rotary <input type="radio"/> Flowing Well <input type="radio"/>	Windmill Other (specify): _____
Other (specify): _____	Horse Power Rating of Motor: <u>3/4</u>
Date Pump Installed: <u>6-30-08</u>	Setting Depth: <u>100 Ft.</u> feet
Rated Pump Capacity: <u>17</u> Gallons Per Minute	Number of Stages: <u>11</u>

Pump Test Data	Method of Measuring Water Level Circle one
Date Well Tested: <u>6-30-08</u>	Air Line Electric Measuring Line <input checked="" type="radio"/> Steel Tape
Static Water Level (A): <u>80</u> Feet Below Land Surface	Other (specify): _____
Pumping Water Level (B): <u>86</u> Feet Below Land Surface	For flowing well, measured shut in head: _____ feet
Drawdown [(B) - (A)]: <u>6</u> Feet Below Land Surface	Well yielded <u>17</u> GPM with a drawdown of
Test Pumping Rate: <u>17</u> Gallons Per Minute	<u>6</u> feet after <u>4</u> hours of pumping
Duration of Pump Test (minimum 4 hours): <u>4</u> hours	

I HEREBY CERTIFY that the above statements are true to the best of my knowledge.

LARRY CARPENTER 0-162 Larry Carpenter
 Print Name of Pump Installer and License No. (if applicable) Signature of Pump Installer

RECEIVED
 JUL 25 2008
 Form BY WFS/WR