

County: Marshall  
 Permit #: 6-162  
 Driller: Long Caputo  
 Date drilling completed: 10-17-06

**State Well Report**  
**Part I - Driller's Log**  
 Mississippi Department of Environmental Quality  
 Office of Land and Water Resources  
 P.O. Box 10631  
 Jackson, MS 39289-0631  
 (601)961-5210  
 (601)354-6938 (fax)

For Office Use Only:  
 Aquifer: \_\_\_\_\_  
 Well #: E-161  
 L.S. Elevation: \_\_\_\_\_  
 E-log #: \_\_\_\_\_

State Law requires that this report be prepared by the license holder responsible for the work and filed with the Department at the above address within 30 days of completion of drilling of the well or borehole.

Information on Well Owner <small>(Landowner if borehole is not for a water well)</small>	Well or Borehole Location
Owner Name: <u>Anderson Home LLC</u>	Latitude: <u>34° 55' 58"</u> Longitude: <u>89° 40' 11"</u>
Mailing Address: <u>P.O. Box 539</u>	Method of Lat/Long (circle one): Conventional Survey, USGS quad, Hand-held GPS, Survey-grade GPS
<u>Holly Springs</u> <u>Ms</u> <u>38635</u>	NW $\frac{1}{4}$ NW $\frac{1}{4}$ Sec <u>7</u> Twn <u>25</u> Rng <u>4W</u>
City State Zip Code	Distance Direction Nearest Town
Telephone No. <u>(662) 252-3500</u>	<u>4</u> Miles <u>North</u> of <u>Phyphala</u>

**Well / Borehole Data**

Date drilling started: 10-17-06 Date drilling completed: 10-17-06 Hole depth: 80' Hole diameter: 8"

Location of the source of any surface water used for drilling: Well Water

Method of dosing and volume of Chlorine used in drilling and development: Yield Chlorine to 1000 lbs Chlorine

Logs run (circle all applicable): No log run Electric Gamma Ray Density Sonic Neutron Other: \_\_\_\_\_

Name of organization running logs: \_\_\_\_\_

Purpose of borehole (check one): Water Well  Geotechnical/Geological Investigation \_\_\_\_\_ Ground Source Heat Pump \_\_\_\_\_

Seismic Survey \_\_\_\_\_ Other (describe) \_\_\_\_\_

*If driller is not related to water well construction, ship the remainder of this block*

Purpose of Well (check one): Home  Industrial \_\_\_\_\_ Public Supply \_\_\_\_\_ Irrigation \_\_\_\_\_ Fish Culture \_\_\_\_\_ Other \_\_\_\_\_

If a flowing well, method of flow regulation: Valve \_\_\_\_\_ Other (describe) \_\_\_\_\_

Static Water Level: 25 feet above or below (circle one) land surface Date measured: 10-17-06

Method of Measurement (circle one): steel tape electric tape air line other: \_\_\_\_\_

Well depth: 80' Well grouted to a depth of 10 feet Type of grout (circle one): Heat Cement Bentonite Mix

Casing length: 70 feet Casing diameter: 4 inches Type of casing: PVC

Screen length: 10 feet Screen diameter: 4 inches Type of screen: PVC

Screen slot size: .013 inches Setting depth: From 70 feet to 80 feet

Type of completion (circle all applicable): Gravel packed Underreamed Telescoped Open hole Natural Development

Other (describe): \_\_\_\_\_

Top of lap pipe or reduction in casing: \_\_\_\_\_ feet *If telescoped or more than one screen, describe on log*

**RECEIVED**  
 Form: OLWR-SWR-1A  
 NOV 09 2006  
 BY: OLWR

E-161

The sketch below only reserves for water wells

If well telescopes, show depths on sketch.

Ground Level ———— R

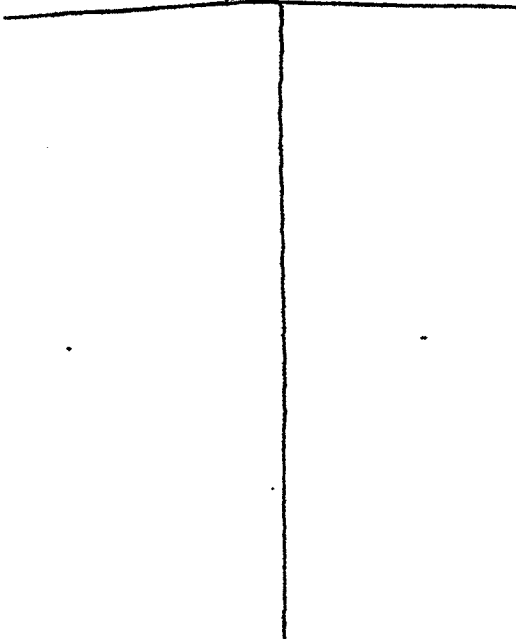

Description of formations encountered must be provided for all wells and boreholes, unless specifically exempted by regulations

Description of Formations Encountered	From (depth)	To (depth)
	Ground Level	
Surface Soil	0	19
Red Mud Soil	19	35
Fine White Soil	19	55
White clay	55	58
White coarse Soil	58	80

If more than one screen, show location of each on sketch

Sketch the property layout and include the following: 1) the well location; 2) any permanent structures on the property that may aid in locating the well; 3) any roads, power lines, or other items that may aid in locating the property and the well; 4) a north arrow.

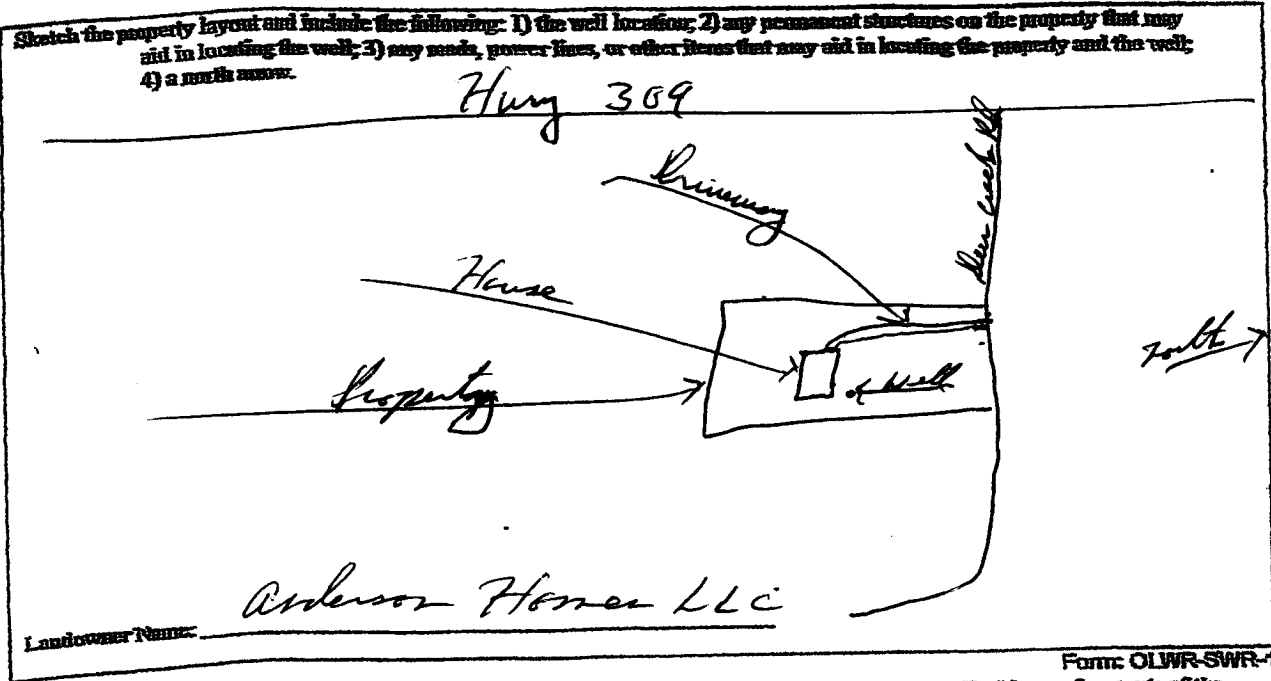

Form: OLWR-SWR-1A

I certify that the well/borehole was drilled, constructed, and completed in accordance with all applicable requirements of the Mississippi Department of Environmental Quality and the Mississippi Department of Health regulations, if applicable.

LARRY CARPENTER  
 Print Name of Responsible Licensee and License No.

10-21-06  
 Date

Larry Carpenter  
 Signature of Licensee

RECEIVED  
 NOV 09 2006  
 BY: OLWR

# STATE WELL REPORT

## Part 2

Pump Installer's Completion Report  
Mississippi Department of Environmental Quality  
Office of Land and Water Resources  
P.O. Box 10631  
Jackson, MS 39289-0631  
(601)961-5210  
(601)354-6938 (fax)

For Office Use Only:

Aquifer: \_\_\_\_\_  
Well #: E-161  
Elevation: \_\_\_\_\_

County: Marshall  
Permit #: 0-162  
Driller: Larry Carpenter  
Date completed: 10-17-06  
*Copy information from block on Part 1*

*This part of the report must be completed by a licensed water well contractor or a licensed pump installer. A copy of Part 1 of the report must be attached and both parts filed with the Department at the above address within 30 days of well completion.*

Well Owner Information	Well Location
Owner Name: <u>Professor Horner LLC</u>	Latitude: _____ Longitude: _____
Mailing Address: <u>P.O. Box 539</u>	Method of Lat/Long (check one): Conventional Survey _____ USGS quad _____, Hand-held GPS _____, Survey-grade GPS _____
<u>Holly Springs</u> <u>MS</u> <u>38635</u>	_____ $\frac{1}{4}$ _____ $\frac{1}{4}$ Sec. <u>7</u> T <u>25</u> R <u>4W</u>
City State Zip Code	Distance Direction Nearest Town
Telephone No. <u>(662) 252-3501</u>	<u>4</u> Miles <u>South</u> of <u>Bygdonia</u>

Pump Type Circle one	Power Type Circle one
Air Lift Jet <input type="radio"/> <u>Submersible</u> <input checked="" type="radio"/>	Diesel Engine Gasoline Engine Natural Gas
Bucket Piston Turbine	<u>Electric Motor</u> <input checked="" type="radio"/> Hand Tractor PTO
Centrifugal Rotary Flowing Well	Windmill Other (specify): _____
Other (specify): _____	Horse Power Rating of Motor: <u>3/4</u>
Date Pump Installed: <u>10-17-06</u>	Setting Depth: <u>60</u> feet
Rated Pump Capacity: <u>10</u> Gallons Per Minute	Number of Stages: <u>11</u>

Pump Test Data	Method of Measuring Water Level Circle one
Date Well Tested: <u>10-17-06</u>	Air Line Electric Measuring Line <u>Steel Tape</u> <input checked="" type="radio"/>
Static Water Level (A): <u>25</u> Feet Below Land Surface	Other (specify): _____
Pumping Water Level (B): <u>30</u> Feet Below Land Surface	For flowing well, measured shut in head: _____ feet
Drawdown [(B) - (A)]: <u>5</u> Feet Below Land Surface	Well yielded <u>17</u> GPM with a drawdown of
Test Pumping Rate: <u>17</u> Gallons Per Minute	<u>4</u> feet after <u>4</u> hours of pumping
Duration of Pump Test (minimum 4 hours): <u>4</u> hours	

I HEREBY CERTIFY that the above statements are true to the best of my knowledge.

LARRY CARPENTER 0-162  
Print Name of Pump Installer and License No. (if applicable)

Larry Carpenter  
Signature of Pump Installer

**RECEIVED**  
Form: OLWR-1B

NOV 09 2006  
BY: OLWR