

State Well Report

Part 1 - Driller's Log

Mississippi Department of Environmental Quality
Office of Land and Water Resources
P.O. Box 10631
Jackson, MS 39289-0631
(601)961-5210
(601)354-6938 (fax)

County: Marshall
Permit #: D-162
Driller: Larry Carpenter
Date drilling completed: 1-24-06

For Office Use Only:
Aquifer: _____
Well #: E-140
L. S. Elevation: _____
E-log #: _____

State Law requires that this report be prepared by the license holder responsible for the work and filed with the Department at the above address within 30 days of completion of drilling of the well or borehole.

Information on Well Owner <i>(Landowner if borehole is not for a water well)</i>	Well or Borehole Location
Owner Name: <u>Anderson Homes L.L.C.</u>	Latitude: <u>34.53.06</u> Longitude: <u>89.36.54</u>
Mailing Address: <u>P.O. Box 539</u>	Method of Lat/Long (circle one): <u>Conventional Survey</u>
<u>Holly Springs</u> <u>Ms.</u> <u>38635</u>	USGS quad, Hand-held GPS, Survey-grade GPS
City State Zip Code	<u>SW 1/4 NW 1/4 Sec 27 Twn 25 Rng 4W</u>
Telephone No. <u>(662) 252-3500</u>	Distance Direction Nearest Town <u>1 1/2 Miles North of Victoria</u>
Well / Borehole Data	
Date drilling started: <u>1-24-06</u> Date drilling completed: <u>1-24-06</u> Hole depth: <u>120'</u> Hole diameter: <u>8"</u>	
Location of the source of any surface water used for drilling: <u>Well Water</u>	
Method of dosing and volume of Chlorine used in drilling and development: <u>1/2 Pk. Chlorine to 1000 Gal Water</u>	
Logs run (circle all applicable): No log run <u>Electric</u> Gamma Ray Density Sonic Neutron Other: _____	
Name of organization running log(s): _____	
Purpose of borehole (check one): Water Well <input checked="" type="checkbox"/> Geotechnical/Geological Investigation _____ Ground Source Heat Pump _____	
Seismic Survey _____ Other (describe) _____	
<i>If drilling is not related to water well construction, skip the remainder of this block</i>	
Purpose of Well (check one): Home <input checked="" type="checkbox"/> Industrial _____ Public Supply _____ Irrigation _____ Fish Culture _____ Other: _____	
If a flowing well, method of flow regulation: Valve _____ Other (describe) _____	
Static Water Level: <u>70</u> feet above or below (circle one) land surface Date measured: _____	
Method of Measurement (circle one) <u>steel tape</u> electric tape air line other: _____	
Well depth: <u>120'</u> Well grouted to a depth of <u>10</u> feet Type of grout (circle one) <u>Neat Cement</u> Bentonite Mix	
Casing length: <u>110</u> feet Casing diameter: <u>4</u> inches Type of casing: <u>PVC</u>	
Screen length: <u>10</u> feet Screen diameter: <u>4</u> inches Type of screen: <u>PVC</u>	
Screen slot size: <u>.013</u> inches Setting depth: From <u>110</u> feet to <u>120</u> feet	
Type of completion (circle all applicable): <u>Gravel packed</u> Underreamed Telescoped Open hole Natural Development	
Other (describe): _____	
Top of lap pipe or reduction in casing: _____ feet. <i>If telescoped or more than one screen, describe on next page</i>	

Form: OLWR-SWR-1A

RECEIVED
FEB 21 2006
BY: OLWR

E-140

The sketch below only required for water wells

If well telescopes, show depths on sketch.

Ground Level \rightarrow

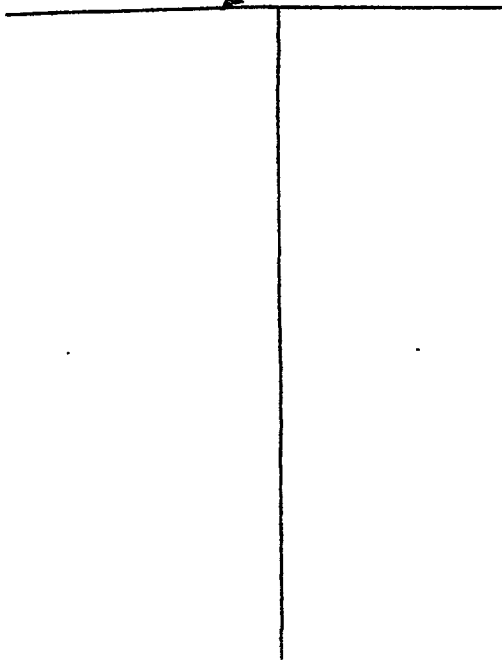

Description of formations encountered must be provided for all wells and boreholes, unless specifically exempted by regulations

Description of Formations Encountered	From (depth)	To (depth)
Surface Soil	Ground Level	16
Red Red Soil	16	28
Red White Sand	28	60
White Clay	60	78
White Coarse Sand	78	120

If more than one screen, show location of each on sketch

Sketch the property layout and include the following: 1) the well location; 2) any permanent structures on the property that may aid in locating the well; 3) any roads, power lines, or other items that may aid in locating the property and the well; 4) a north arrow.

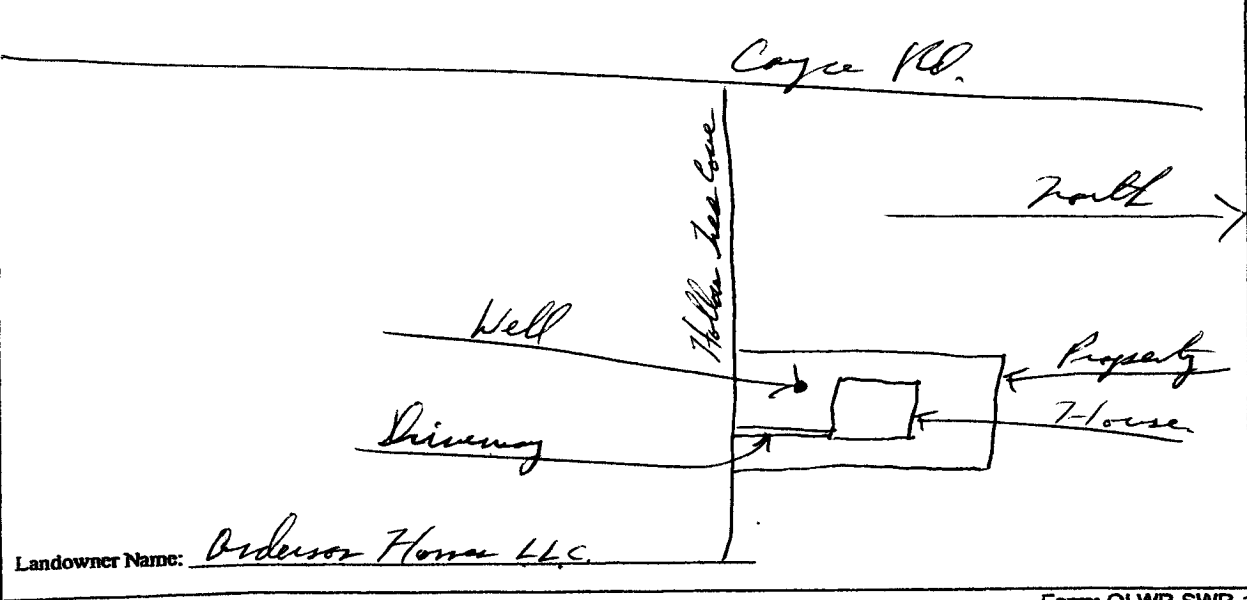

Landowner Name: Anderson Home LLC

Form: OLWR-SWR-1A

I certify that the well/borehole was drilled, constructed, and completed in accordance with all applicable requirements of the Mississippi Department of Environmental Quality and the Mississippi Department of Health regulations, if applicable, and state laws.

LARRY CARPENTER 0-162 1-26-06
Print Name of Responsible Licensee and License No. Date

Larry Carpenter
Signature of Licensee

RECEIVED
FEB 21 2006
BY: OLWR

STATE WELL REPORT

Part 2

Pump Installer's Completion Report
 Mississippi Department of Environmental Quality
 Office of Land and Water Resources
 P.O. Box 10631
 Jackson, MS 39289-0631
 (601)961-5210
 (601)354-6938 (fax)

For Office Use Only:

Aquifer: _____
 Well #: E-140
 Elevation: _____

County: Marshall
 Permit #: 0-162
 Driller: Larry Carpenter
 Date completed: 1-24-06
Copy information from block on Part 1

This part of the report must be completed by a licensed water well contractor or a licensed pump installer. A copy of Part 1 of the report must be attached and both parts filed with the Department at the above address within 30 days of well completion.

Well Owner Information	Well Location
Owner Name: <u>Anderson Homes L.L.C.</u> Mailing Address: <u>P.O. Box 539</u> <u>Holly Springs</u> <u>Ms.</u> <u>38635</u> City State Zip Code Telephone No. <u>(662) 252-3500</u>	Latitude: _____ Longitude: _____ Method of Lat/Long (check one): Conventional Survey _____ USGS quad _____ Hand-held GPS _____ Survey-grade GPS _____ _____ 1/4 _____ 1/4 Sec. <u>27 T 25 R 4 W</u> Distance Direction Nearest Town <u>1 1/2</u> Miles <u>South</u> of <u>Victoria</u>

Pump Type Circle one	Power Type Circle one
Air Lift Jet <input checked="" type="radio"/> Submersible Bucket Piston Turbine Centrifugal Rotary Flowing Well Other (specify): _____ Date Pump Installed: <u>1-24-06</u> Rated Pump Capacity: <u>12</u> Gallons Per Minute	Diesel Engine Gasoline Engine Natural Gas <input checked="" type="radio"/> Electric Motor Hand Tractor PTO Windmill Other (specify): _____ Horse Power Rating of Motor: <u>3/4</u> Setting Depth: <u>90</u> feet Number of Stages: <u>11</u>

Pump Test Data	Method of Measuring Water Level Circle one
Date Well Tested: _____ Static Water Level (A): <u>65</u> Feet Below Land Surface Pumping Water Level (B): <u>70</u> Feet Below Land Surface Drawdown [(B) - (A)]: <u>5</u> Feet Below Land Surface Test Pumping Rate: <u>16</u> Gallons Per Minute Duration of Pump Test (minimum 4 hours): <u>4</u> hours	Air Line Electric Measuring Line <input checked="" type="radio"/> Steel Tape Other (specify): _____ For flowing well, measured shut in head: _____ feet Well yielded <u>16</u> GPM with a drawdown of <u>5</u> feet after <u>4</u> hours of pumping

I HEREBY CERTIFY that the above statements are true to the best of my knowledge.

LARRY CARPENTER 0-162
 Print Name of Pump Installer and License No. (if applicable)

Larry Carpenter
 Signature of Pump Installer

RECEIVED
 Form: OLWR SWR 4B

FEB 21 2006

BY: OLWR