

# State Well Report

## Part 1

Mississippi Department of Environmental Quality  
Office of Land and Water Resources  
P.O. Box 10631  
Jackson, MS 39289-0631  
(601)961-5210  
(601)354-6938 (fax)

For Office Use Only:

Aquifer: \_\_\_\_\_  
Well #: C-40  
L. S. Elevation: \_\_\_\_\_  
E-log #: \_\_\_\_\_

County: ~~Benton~~ Marshall  
Permit #: \_\_\_\_\_  
Driller: Wilson Well Company  
Date drilling completed: 9-6-05

State Law requires that this report be prepared by the driller in detail and filed with the Department within 30 days of completion of drilling of the well.

Well Owner Information	Well Location
Owner Name: <u>Rice Robert</u>	Latitude: <u>34° 58' 19"</u> Longitude: <u>89° 21' 47"</u>
Mailing Address: <u>726 Rice Chapel Road</u>	Method of Lat/Long (circle one): Conventional Survey, USGS quad, Hand-held GPS, Survey-grade GPS
<u>Lamar</u> City <u>Ms.</u> State <u>38642</u> Zip Code	<u>SE 1/4 NW 1/4</u> Sec <u>25</u> ✓ Twn <u>T15</u> ✓ Rng <u>R2W</u>
Telephone No. ( <u>901</u> ) <u>224-4604</u>	Distance <u>2</u> Miles      Direction <u>North</u> Nearest Town <u>NW 72</u>

**Well Data**

Purpose of Well (circle one) Home Industrial Public Supply Irrigation Fish Culture Other: \_\_\_\_\_

Date well drilling started: 9-6-05 Date well drilling completed: 9-6-05

If flowing, method of flow regulation: Valve \_\_\_\_\_ Other (describe) \_\_\_\_\_

Static Water Level: 50 feet above or below (circle one) land surface Date measured: 9-6-05

Method of Measurement (circle one) steel tape electric tape air line other: PVC Pipe

Hole depth: 140 Well depth: 140 Well grouted to a depth of 10 feet

Type of grout (circle one): Cement Bentonite Mix

Casing length: 130 feet Casing diameter: 4 inches Type of casing: Plastic PVC

Screen length: 10 feet Screen diameter: 4 inches Type of screen: Plastic PVC

Screen slot size: .010 inches Setting depth: From 130 feet to 140 feet

Type of completion (circle all applicable): Gravel packed Underreamed Telescoped Open hole Natural Development  
Other (describe): \_\_\_\_\_

Top of lap pipe or reduction in casing: NA feet. If telescoped or more than one screen, describe on back of page

Logs run (circle all applicable): No log run Electric Gamma Ray Density Sonic Neutron Other: \_\_\_\_\_

Name of organization running log(s): \_\_\_\_\_

**RECEIVED**  
SEP 30 2005  
BY: OLWR

I certify that the well was drilled, constructed, and completed in accordance with all applicable requirements of the Mississippi Department of Environmental Quality and/or the Mississippi Department of Health regulations and state laws.

R. J. White 0-418      R. J. White  
Print Name of Water Well Contractor and License No.      Signature of Water Well Contractor

If well telescopes please sketch below and show depths.

C-40

Ground Level

Description of Formations Encountered	From	To

If more than one screen, show location of each on sketch

Sketch the property layout and include the following: 1) the well location; 2) any permanent structures on the property that may aid in locating the well; 3) any roads, power lines, or other items that may aid in locating the property and the well; 4) indicate direction.

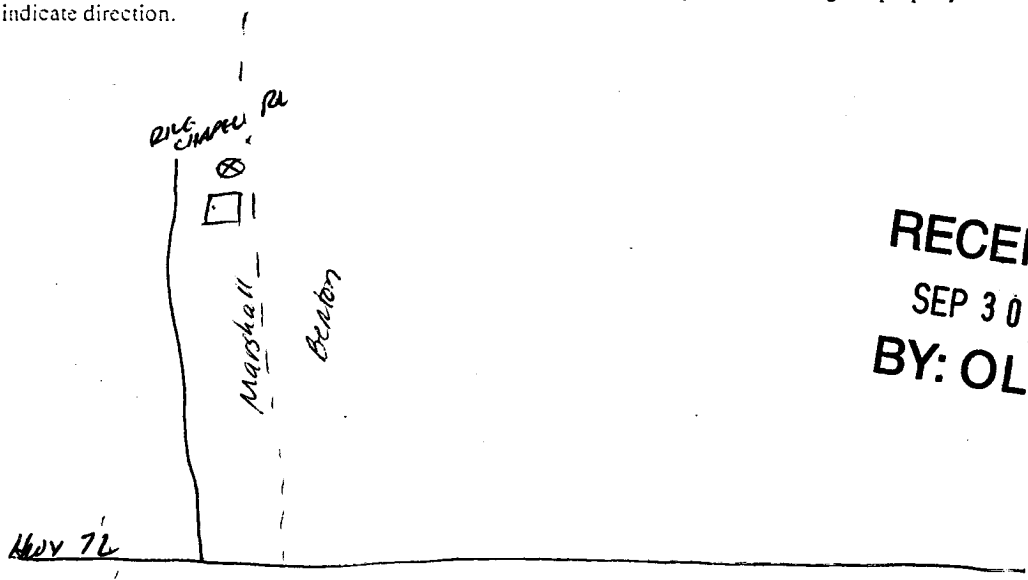

**RECEIVED**  
**SEP 30 2005**  
**BY: OLWR**

Landowner Name: \_\_\_\_\_

Ref. O. Wil  
Signature of Water Well Contractor

# STATE WELL REPORT

## Part 2

**Pump Installer's Completion Report**  
 Mississippi Department of Environmental Quality  
 Office of Land and Water Resources  
 P.O. Box 10631  
 Jackson, MS 39289-0631  
 (601)961-5210  
 (601)354-6938 (fax)

County: ~~Howell~~ Marshall  
 Permit #: \_\_\_\_\_  
 Driller: Wilson Well Co.  
 Date completed: 9-6-05  
*Copy information from block on Part 1*

**For Office Use Only:**

Aquifer: \_\_\_\_\_  
 Well #: C-40  
 Elevation: \_\_\_\_\_

*This part of the report must be completed by a licensed water well contractor or a licensed pump installer. A copy of Part 1 of the report must be attached and both parts filed with the Department at the above address within 30 days of well completion.*

Well Owner Information	Well Location
Owner Name: <u>Rick Rogers</u>	Latitude: _____ Longitude: _____
Mailing Address: <u>726 Rex Court Road</u>	Method of Lat/Long (check one): Conventional Survey _____
<u>Canum</u> <u>MS</u> <u>38642</u>	USGS quad _____, Hand-held GPS _____, Survey-grade GPS _____
City State Zip Code	_____ 1/4 _____ 1/4 Sec <u>25</u> T <u>15</u> R <u>2W</u>
Telephone No. ( <u>801</u> ) <u>224-4604</u>	Distance Direction Nearest Town
	<u>2</u> Miles <u>North</u> of <u>High 72</u>

Pump Type Circle one	Power Type Circle one
Air Lift Jet <input checked="" type="radio"/> <u>Submersible</u>	Diesel Engine Gasoline Engine Natural Gas
Bucket Piston Turbine	<input checked="" type="radio"/> <u>Electric Motor</u> Hand Tractor PTO
Centrifugal Rotary Flowing Well	Windmill Other (specify): _____
Other (specify): _____	Horse Power Rating of Motor: <u>3/4</u> SEP 30 2005
Date Pump Installed: <u>9-6-05</u>	Setting Depth: <u>120</u> feet <b>BY: OLWR</b>
Rated Pump Capacity: <u>10</u> Gallons Per Minute	Number of Stages: <u>12</u> <b>RECEIVED</b>

Pump Test Data	Method of Measuring Water Level Circle one
Date Well Tested: <u>9-6-05</u>	Air Line Electric Measuring Line Steel Tape
Static Water Level (A): <u>50</u> Feet Below Land Surface	Other (specify): <u>AC PIPE</u>
Pumping Water Level (B): <u>120</u> Feet Below Land Surface	For flowing well, measured shut in head: _____ feet
Drawdown [(B) - (A)]: _____ Feet Below Land Surface	Well yielded _____ GPM with a drawdown of _____
Test Pumping Rate: <u>10</u> Gallons Per Minute	_____ feet after _____ hours of pumping
Duration of Pump Test (minimum 4 hours): _____ hours	

I HEREBY CERTIFY that the above statements are true to the best of my knowledge.

Rodney O. Wilson 0-418 R.O. Wilson  
 Print Name of Pump Installer and License No. (if applicable) Signature of Pump Installer