

# State Well Report

## Part 1 - Driller's Log

Mississippi Department of Environmental Quality  
Office of Land and Water Resources  
P.O. Box 2309  
Jackson, MS 39225  
(601)961- 5210  
(601)961- 5228 (fax)

County: Madison  
Permit #: 0-586  
Driller: JAMES WELLS  
Date drilling completed: 9-9-10

For Office Use Only:  
Aquifer: N 146  
Well #: \_\_\_\_\_  
L. S. Elevation: \_\_\_\_\_  
E-log #: \_\_\_\_\_

State Law requires that this report be prepared by the license holder responsible for the work and filed with the Department at the above address within 30 days of completion of drilling of the well or borehole.

Information on Well Owner (Landowner if borehole is not for a water well)	Well or Borehole Location
Owner Name: <u>Chad McKenzie</u>	Latitude: <u>31° 06' 26"</u> Longitude: <u>89° 55' 06"</u>
Mailing Address: <u>679 New Hope Rd</u> <u>Foxworth Ms.</u>	Method of Lat/Long (circle one): Conventional Survey, <u>07 10 54 23</u>
City: _____ State: _____ Zip Code: <u>39483</u>	USGS quad, Hand-held GPS, Survey-grade GPS <input checked="" type="checkbox"/>
Telephone No. <u>(601) 731-725</u>	<u>SW</u> 1/4 <u>SW</u> 1/4 Sec <u>29</u> Twn <u>2N</u> Rng <u>13E</u>
	Distance <u>3</u> Miles <u>SW</u> Direction <u>20</u> of Nearest Town <u>Foxworth Ms</u>

Well / Borehole Data

Date drilling started: 9-9-10 Date drilling completed: 9-9-10 Hole depth: 165 Hole diameter: 7

Location of the source of any surface water used for drilling: Creek

Method of dosing and volume of Chlorine used in drilling and development: Shock 2 lb

Logs run (circle all applicable): No log run Electric Gamma Ray Density Sonic Neutron Other: \_\_\_\_\_

Name of organization running log(s): \_\_\_\_\_

Purpose of borehole (check one): Water Well  Geotechnical/Geological Investigation \_\_\_\_\_ Ground Source Heat Pump \_\_\_\_\_

Seismic Survey \_\_\_\_\_ Other (describe) \_\_\_\_\_

*If drilling is not related to water well construction, skip the remainder of this block*

Purpose of Well (check one): Home  Industrial \_\_\_\_\_ Public Supply \_\_\_\_\_ Irrigation \_\_\_\_\_ Fish Culture \_\_\_\_\_ Other: \_\_\_\_\_

If a flowing well, method of flow regulation: Valve \_\_\_\_\_ Other (describe) \_\_\_\_\_

Static Water Level: 90 feet above of below (circle one) land surface Date measured: 9-9-10

Method of Measurement (circle one) steel tape electric tape air line other: \_\_\_\_\_

Well depth: 165 Well grouted to a depth of \_\_\_\_\_ feet Type of grout (circle one): Neat Cement Bentonite Mix

Casing length: \_\_\_\_\_ feet Casing diameter: 4 inches Type of casing: PVC

Screen length: \_\_\_\_\_ feet Screen diameter: 4 inches Type of screen: PVC

Screen slot size: .008 inches Setting depth: From 145 feet to 165 feet

Type of completion (circle all applicable): Gravel packed Underreamed Telescoped Open hole Natural Development

Other (describe): \_\_\_\_\_

Top of lap pipe or reduction in casing: \_\_\_\_\_ feet. *If telescoped or more than one screen, describe on next page*

Form: OLWR-SWR-1A (04/08)

RECEIVED  
OCT 14 2010  
BY: OLWR

The sketch below only required for water wells

Description of formations encountered must be provided for all wells and boreholes, unless specifically exempted by regulations

If well telescopes, show depths on sketch.

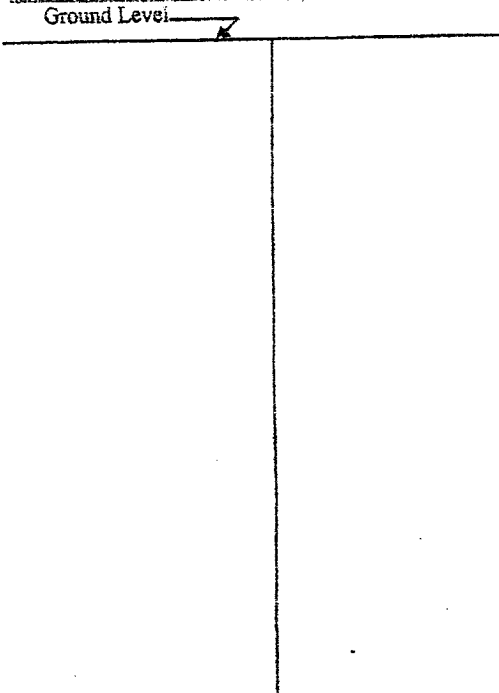

Description of Formations Encountered	From (depth) Ground Level	To (depth)
cl.	2	30
sh.	30	50
cl.	50	75
sh.	75	165

If more than one screen, show location of each on sketch

Sketch the property layout and include the following: 1) the well location; 2) any permanent structures on the property that may aid in locating the well; 3) any roads, power lines, or other items that may aid in locating the property and the well; 4) a north arrow.

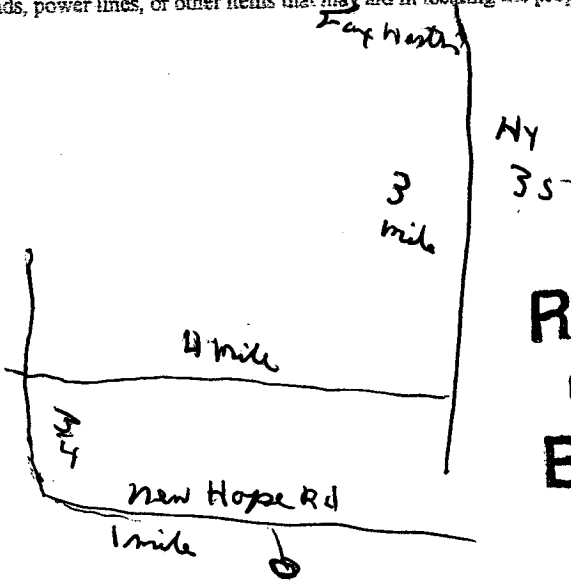

RECEIVED  
OCT 14 2010  
BY: OLWR

Landowner Name: Chad McKensie

Form: OLWR-SWR-1A (04/08)

I certify that the well/borehole was drilled, constructed, and completed in accordance with all applicable requirements of the Mississippi Department of Environmental Quality and the Mississippi Department of Health regulations, if applicable, and state laws.

Print Name of Responsible Licensee and License No. JAMES WELLS 0-586 Date

Signature of Licensee James Wells

# STATE WELL REPORT

## Part 2

**Pump Installer's Completion Report**  
 Mississippi Department of Environmental Quality  
 Office of Land and Water Resources  
 P.O. Box 2309  
 Jackson, MS 39225  
 (601)961-5210  
 (601)961-5228 (fax)

County: Monroe  
 Permit #: \_\_\_\_\_  
 Driller: JAMES WELLS  
 Date completed: 9-9-10  
*Copy information from block on Part 1*

For Office Use Only:

Aquifer: \_\_\_\_\_  
 Well #: \_\_\_\_\_  
 Elevation: \_\_\_\_\_

*This part of the report must be completed by a licensed water well contractor or a licensed pump installer. A copy of Part 1 of the report must be attached and both parts filed with the Department at the above address within 30 days of well completion.*

Well Owner Information	Well Location
Owner Name: <u>Chad McKenzie</u>	Latitude: _____ Longitude: _____
Mailing Address: <u>679 New Hope Rd</u>	Method of Lat/Long (check one): Conventional Survey _____
<u>Fourwatts Ms</u>	USGS quad _____, Hand-held GPS _____, Survey-grade GPS _____
City State Zip Code	_____ 1/4 _____ 1/4 Sec <u>8 29</u> T <u>2N</u> R <u>13E</u>
Telephone No. <u>(601) 731 3725</u>	Distance Direction Nearest Town
	<u>2</u> Miles <u>SW</u> of <u>Fourwatts Ms</u>

Pump Type Circle one	Power Type Circle one
Air Lift Jet <input type="radio"/> <u>Submersible</u> <input checked="" type="radio"/>	Diesel Engine Gasoline Engine Natural Gas
Bucket Piston Turbine	<u>Electric Motor</u> <input checked="" type="radio"/> Hand Tractor PTO
Centrifugal Rotary Flowing Well	Windmill Other (specify): _____
Other (specify): _____	Horse Power Rating of Motor: <u>1</u>
Date Pump Installed: <u>9-9-10</u>	Setting Depth: <u>120</u> feet
Rated Pump Capacity: <u>15</u> Gallons Per Minute	Number of Stages: <u>14</u>

Pump Test Data	Method of Measuring Water Level Circle one
Date Well Tested: <u>9-9-10</u>	Air Line Electric Measuring Line <u>Steel Tape</u> <input checked="" type="radio"/>
Static Water Level (A): <u>90</u> Feet Below Land Surface	Other (specify): _____
Pumping Water Level (B): <u>120</u> Feet Below Land Surface	For flowing well, measured shut in head: _____ feet
Drawdown [(B) - (A)]: <u>100</u> Feet Below Land Surface	Well yielded <u>15</u> GPM with a drawdown of
Test Pumping Rate: <u>15</u> Gallons Per Minute	<u>90</u> feet after <u>4</u> hours of pumping
Duration of Pump Test (minimum 4 hours): <u>4</u> hours	

I HEREBY CERTIFY that the above statements are true to the best of my knowledge.

JAMES WELLS 0-586 James Wells  
 Print Name of Pump Installer and License No. (if applicable) Signature of Pump Installer

**RECEIVED**  
 OCT 14 2010  
 BY: OLWR