

# STATE WELL REPORT

## Part 1

### Driller's Log

Mississippi Department of Environmental Quality  
Office of Land and Water Resources  
P.O. Box 2309  
Jackson, MS 39225-2309  
(601)961-5555  
(601)961-5228 (fax)

County: Lauderdale  
 Permit #: \_\_\_\_\_  
 Driller: Clardy Dault  
 Date drilling completed: 11/13/17

**For Office Use Only:**

Well #: J43  
 Aquifer: \_\_\_\_\_  
 E-Log #: \_\_\_\_\_

*State Law requires that this report be prepared by the license holder responsible for the work and filed with the Department at the above address within 30 days of completion of drilling of the well or borehole.*

Well Owner Information <small>(Landowner if borehole is not for a water well)</small>	Well or Borehole Location
Owner Name: <u>George Wicks</u>	Latitude: <u>N 33° 23.831'</u> Longitude: <u>W 88° 34.156'</u>
Mailing Address: <u>389 Onpawia Dr.</u>	Method of Lat/Long (check one): Conventional Survey _____
<u>Columbus, MS 39702</u>	USGS quad _____, Hand-held GPS <input checked="" type="checkbox"/> , Survey-grade GPS _____
City _____ State _____ Zip Code _____	<u>SE 1/4 NE 1/4, Sec. 25 T. 18N R. 16E</u>
Telephone No. <u>(662) 327-9511</u>	<u>3 1/2</u> Miles <u>East of Artesia</u>
	(Distance) (Direction) (Nearest Town)

**Well / Borehole Data**

Date drilling started: 11/6/17 Date drilling completed: 11/13/17 Hole depth: 393 Hole diameter: 4"

Location of the source of any surface water used for drilling: \_\_\_\_\_

Method of dosing and volume of Chlorine used in drilling and development: 2 1/2# granular

Logs run (check all applicable):  log run  Electric  Gamma Ray  Density  Sonic  Neutron Other: \_\_\_\_\_

Name of organization running log(s): \_\_\_\_\_

Purpose of borehole (check one): Water Well  Geotechnical/Geological Investigation  Ground Source Heat Pump   
 Seismic Survey Other (describe) \_\_\_\_\_

*If drilling is not related to water well construction, skip the remainder of this block*

Purpose of Well (check all applicable):  Home  Industrial  Public Supply  Irrigation  Fish Culture

Other (describe): \_\_\_\_\_

If a flowing well, method of flow regulation: Valve \_\_\_\_\_ Other (describe) \_\_\_\_\_

Static Water Level: 150 feet  above or  below land surface Date measured: 11/14/17  
(check one)

Method of measurement (check one)  Steel tape  Electric tape  Air line  Other (describe): \_\_\_\_\_

Well depth: 393 Well grouted to a depth of: 20 feet Type of grout (check one)  Neat Cement  Bentonite  Mix

Casing length: 210 feet Casing diameter: 4 inches Type of casing: PVC

Screen length: 40 feet Screen diameter: 20" inches Type of screen: PVC

Screen slot size: .013 inches Setting depth: From 338 feet to 378 feet

Type of completion (check all applicable)  gravel packed  Underreamed  Open hole  Natural Development

Other (describe): Telescoped

Top of lap pipe or reduction in casing: 5 feet

*If telescoped or more than one screen, describe on next page*

RECEIVED  
NOV 20 2017  
BY OLWR

County: Howard  
 Permit #: 121010

For Office Use Only:  
 Well #: J43

The sketch below only required for water wells.

Description of formations encountered must be provided for all wells and boreholes, unless specifically exempted by regulations.

If well telescopes, show depths on sketch.

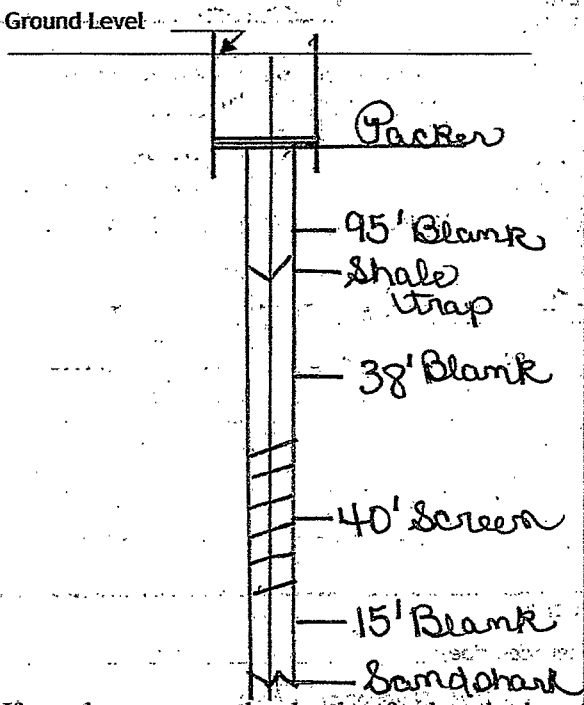

Description of Formations Encountered	From (depth)	To (depth)
Brown clay	Ground level	11
White clay	11	22
Blue clay	22	109 1/2
Rock	109 1/2	110
Blue clay	110	112 1/2
Rock	112 1/2	113
Blue clay	113	322
Sandy clay	322	332
Sand	332	339
Fine sand	339	342
Rocky sand	342	362
Fine sand	362	392
Clay	392	393

If more than one screen, show location of each on sketch.

Sketch the property layout and include the following:

- 1) the well location
- 2) any permanent structures on the property that may aid in locating the well
- 3) any roads, power lines, or other items that may aid in locating the property and the well
- 4) north arrow

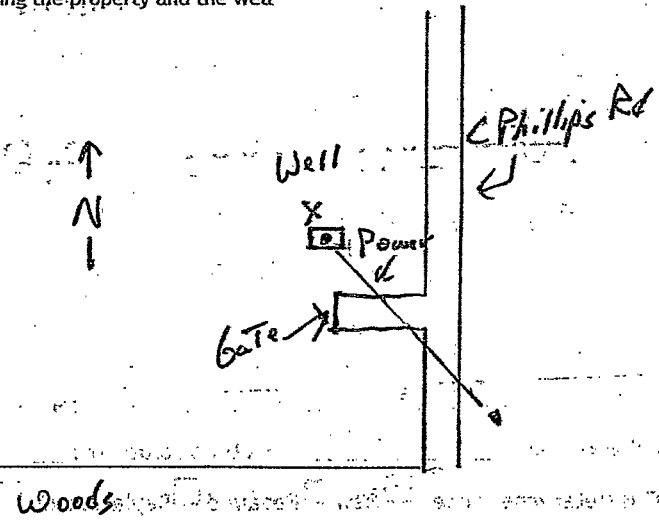

Landowner Name: George Wickers

I HEREBY CERTIFY that the well/borehole was drilled, constructed, and completed in accordance with all applicable requirements of the Mississippi Department of Environmental Quality and the Mississippi Department of Health regulations, if applicable, and state laws.

Donald B. Clardy UNR  
 Print Name of Responsible Licensee and License No.

11/14/17  
 Date

D. Clardy  
 Signature of Licensee

# STATE WELL REPORT

## Part 2

### Pump Installer's Completion Report

Mississippi Department of Environmental Quality  
Office of Land and Water Resources  
P.O. Box 2309  
Jackson, MS 39225-2309  
(601)961-5210  
(601) 360-0535 (fax)

County: Saunder  
 Permit #: \_\_\_\_\_  
 Driller: Clardy  
 Date completed: 11/13/17  
*Copy information from block on Part 1*

**For Office Use Only:**

Well #: J43  
 Aquifer: \_\_\_\_\_

*This part of the report must be completed by a licensed water well contractor or a licensed pump installer. A copy of Part 1 of the report must be attached and both parts filed with the Department at the above address within 30 days of well completion.*

Well Owner Information	Well Location
Owner Name: <u>George Wucko</u>	Latitude: <u>33° 23' 23"</u> Longitude: <u>088° 34' 15"</u>
Mailing Address: <u>389 Padua Dr.</u>	Method of Lat/Long (check one): Conventional Survey <u>09</u>
<u>Columbus, MS</u> <u>39702</u>	USGS quad _____, Hand-held GPS <input checked="" type="checkbox"/> , Survey-grade GPS _____
City State Zip Code	<u>SE 1/4 NE 1/4, Sec 25 T18N R16E</u>
Telephone No. <u>602 327-9511</u>	<u>3 1/2</u> Miles <u>East</u> of <u>Orbena</u>
	(Distance) (Direction) (Nearest Town)

**Pump Type (check one)**

Submersible  Turbine  Air Lift  Centrifugal  Flowing Well  Jet  Piston  Rotary  Other (describe): \_\_\_\_\_

Date Pump Installed: 11/13/17 Rated Pump Capacity: 15 Gallons Per Minute

Is This Pump (check one):  New  Repaired  Replacement

**Power Type (check one)**

Electric  Diesel  Gasoline  Natural Gas  Tractor PTO  Windmill  Other (describe): \_\_\_\_\_

Horse Power Rating of Motor: 1 Setting Depth: 200 feet Number of Stages: 12

**Pump Test Data for Non-Flowing Well**

Date Well Tested: 11/13/17 Duration of Pump Test (minimum 4 hours): \_\_\_\_\_ hours

Static Water Level (A): 150 Feet Below Land Surface Pumping Water Level (B): \_\_\_\_\_ Feet Below Land Surface

Drawdown [(B) - (A)]: \_\_\_\_\_ Feet Below Land Surface Test Pumping Rate: \_\_\_\_\_ Gallons Per Minute

Method of measurement (check one): Steel tape  Electric tape  Air line  Other (describe): \_\_\_\_\_

**Pump Test Data for Flowing Well**

Measured shut in head: \_\_\_\_\_ feet.

Well yielded \_\_\_\_\_ GPM with a drawdown of \_\_\_\_\_ feet after \_\_\_\_\_ hours of pumping

**Meter Installation**

Meter Manufacturer: \_\_\_\_\_ Meter Serial Number: \_\_\_\_\_

Meter Model Number/Name: \_\_\_\_\_ Type of Meter: \_\_\_\_\_

Totalizer Register Unit and Multiplier Factor (AF x .001, gal x 1000, etc): \_\_\_\_\_

Installation Date: \_\_\_\_\_ Meter installed by: \_\_\_\_\_

Is This Meter (check one):  New  Repaired  Replacement

**RECEIVED**  
**NOV 20 2017**  
**BY OLWR**

*Important: By submitting the above information you are certifying that this meter was installed to manufacturer standards. For agricultural wells, a list of approved meters is on the MDEQ website.*

I HEREBY CERTIFY that the above statements are true to the best of my knowledge.

Donald B Clardy UNR00000 11/14/17 Clardy  
 Print Name of Pump Installer and license No. (if applicable) Date Signature of Pump Installer

Small table with faint text, possibly a header or title.

Small table with faint text, possibly a header or title.

Small table with faint text, possibly a header or title.