

County: Lauderdale
 Permit #: _____
 Driller: Clardy Dade
 Date drilling completed: 6/19/09

State Well Report

Part 1 - Driller's Log

Mississippi Department of Environmental Quality
 Office of Land and Water Resources
 P.O. Box 2309
 Jackson, MS 39225
 (601)961- 5210
 (601)961- 5228 (fax)

For Office Use Only:
 Aquifer: _____
 Well #: 1454
 L. S. Elevation: _____
 E-log #: _____

State Law requires that this report be prepared by the license holder responsible for the work and filed with the Department at the above address within 30 days of completion of drilling of the well or borehole.

Information on Well Owner (Landowner if borehole is not for a water well)	Well or Borehole Location
Owner Name: <u>Derrick Franko</u>	Latitude: <u>N 33° 27' 36.9"</u> Longitude: <u>W 88° 18' 41.28"</u>
Mailing Address: <u>249 Ala. St.</u>	Method of Lat/Long (circle one): Conventional Survey, <u>41</u>
<u>Columbus, MS 39102</u>	USGS quad: <u>Hand-held GPS</u> , Survey-grade GPS
City State Zip Code	<u>SE 1/4 NE 1/4 Sec 33 Twn 18S Rng 17W</u>
Telephone No. () _____	Distance Direction Nearest Town <u>3</u> Miles <u>SE</u> of <u>Columbus</u>

Well / Borehole Data

Date drilling started: 6/18/09 Date drilling completed: 6/19/09 Hole depth: 238 Hole diameter: 4

Location of the source of any surface water used for drilling: _____
 Method of dosing and volume of Chlorine used in drilling and development: 2 1/2 # granular

Logs run (circle all applicable): No log run Electric Gamma Ray Density Sonic Neutron Other: _____
 Name of organization running log(s): _____

Purpose of borehole (check one): Water Well Geotechnical/Geological Investigation _____ Ground Source Heat Pump _____
 Seismic Survey _____ Other (describe) _____

If drilling is not related to water well construction, skip the remainder of this block

Purpose of Well (check one): Home Industrial _____ Public Supply _____ Irrigation _____ Fish Culture _____ Other: _____

If a flowing well, method of flow regulation: Valve _____ Other (describe) _____

Static Water Level: 97 feet above or below (circle one) land surface Date measured: 6/19/09

Method of Measurement (circle one) steel tape electric tape air line other: _____

Well depth: 238 Well grouted to a depth of 20 feet Type of grout (circle one): Neat Cement Bentonite Mix

Casing length: 157 feet Casing diameter: 4 inches Type of casing: PVC

Screen length: 40 feet Screen diameter: 2 inches Type of screen: PVC

Screen slot size: .013 inches Setting depth: From 168 feet to 208 feet

Type of completion (circle all applicable): Gravel packed Underreamed Telescoped Open hole Natural Development
 Other (describe): _____

Top of lap pipe or reduction in casing: 5 feet. *If telescoped or more than one screen, describe on next page*

Form: OLWR-SWR-1A (04/08)

RECEIVED
 JUL 16 2009
 BY: OLWR

The sketch below only required for water wells

Description of formations encountered must be provided for all wells and boreholes, unless specifically exempted by regulations

If well telescopes, show depths on sketch.

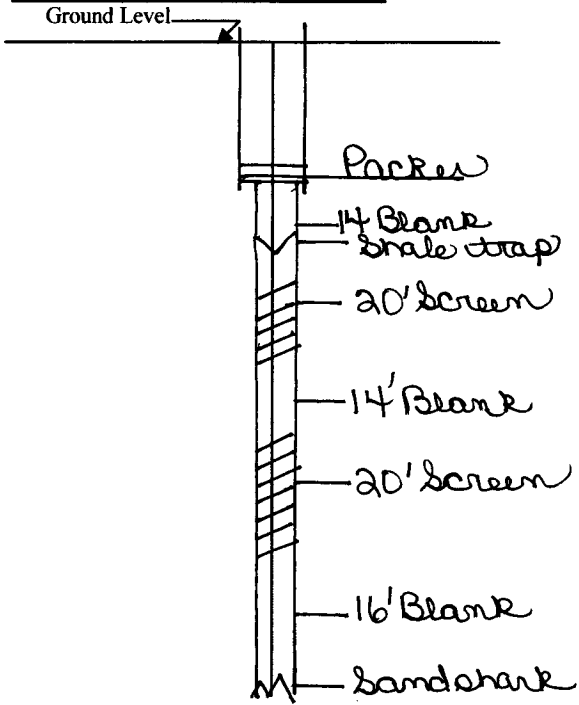

Description of Formations Encountered	From (depth)	To (depth)
Red Clay	Ground Level	22
Sand & gravel	22	30
Blue Clay	30	82
Rocky	82	85
Sandy Clay	85	110
Clay	110	149 1/2
Rock	149 1/2	157
Clay	157	168
Sandy Clay	168	175
Rocky sand streak	175	180
Clay	180	191
Sandy Clay	191	198
Sand streak	198	198 1/2
Sandy Clay	198 1/2	204
Rocky Sand	204	222
Sandy Clay	222	226
Sand streak	226	231
Sandy Clay	231	235
Clay	235	238

If more than one screen, show location of each on sketch

Sketch the property layout and include the following: 1) the well location; 2) any permanent structures on the property that may aid in locating the well; 3) any roads, power lines, or other items that may aid in locating the property and the well; 4) a north arrow.

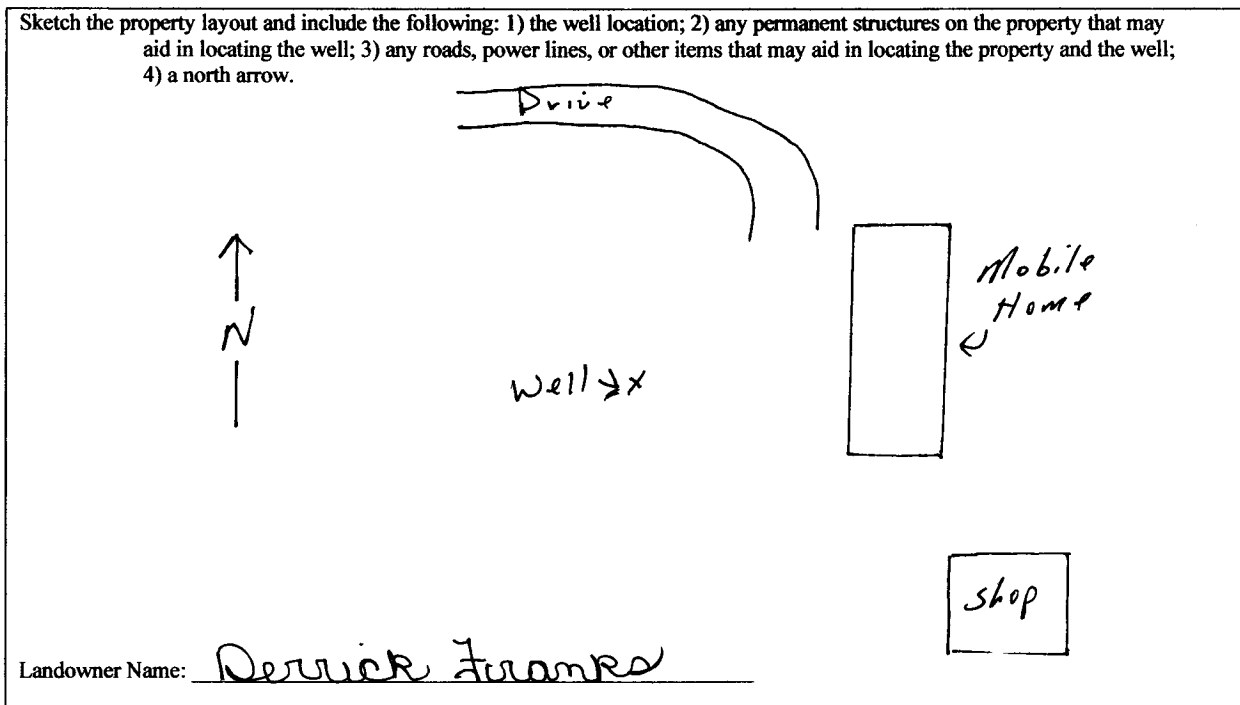

Landowner Name: Derrick Frames

Form: OLWR-SWR-1A (04/08)

I certify that the well/borehole was drilled, constructed, and completed in accordance with all applicable requirements of the Mississippi Department of Environmental Quality and the Mississippi Department of Health regulations, if applicable, and state laws.

Donald B. Clardy D-496 7/2/09
 Print Name of Responsible Licensee and License No. Date

Donald B. Clardy
 Signature of Licensee

RECEIVED
 JUL 16 2009
 BY: OLWR

STATE WELL REPORT

Part 2

Pump Installer's Completion Report
 Mississippi Department of Environmental Quality
 Office of Land and Water Resources
 P.O. Box 2309
 Jackson, MS 39225
 (601)961-5210
 (601)961-5228 (fax)

County: Louisa
 Permit #: _____
 Driller: Clardy
 Date completed: 6/22/09
Copy information from block on Part 1

For Office Use Only:

Aquifer: _____
 Well #: H54
 Elevation: _____

This part of the report must be completed by a licensed water well contractor or a licensed pump installer. A copy of Part 1 of the report must be attached and both parts filed with the Department at the above address within 30 days of well completion.

Well Owner Information	Well Location
Owner Name: <u>Derrick Furman</u>	Latitude: <u>N 33° 27' 36.9"</u> Longitude: <u>W 088° 18' 68.0"</u>
Mailing Address: <u>249 Ala. St.</u>	Method of Lat/Long (check one): Conventional Survey <input type="checkbox"/> ²² <input checked="" type="checkbox"/> Survey-grade GPS ⁴¹
<u>Columbus, MS 39702</u>	USGS quad _____, Hand-held GPS <input checked="" type="checkbox"/> , Survey-grade GPS _____
City State Zip Code	<u>SE 1/4 NE 1/4 Sec 33 T18S R17W</u>
Telephone No. () _____	Distance Direction Nearest Town <u>3 Miles SE of Columbus</u>

Pump Type Circle one	Power Type Circle one
Air Lift Jet <input type="checkbox"/> <u>Submersible</u> <input checked="" type="checkbox"/>	Diesel Engine Gasoline Engine Natural Gas
Bucket Piston Turbine	<u>Electric Motor</u> <input checked="" type="checkbox"/> Hand Tractor PTO
Centrifugal Rotary Flowing Well	Windmill Other (specify): _____
Other (specify): _____	Horse Power Rating of Motor: <u>3/4</u>
Date Pump Installed: <u>6/22/09</u>	Setting Depth: <u>140</u> feet
Rated Pump Capacity: <u>15</u> Gallons Per Minute	Number of Stages: <u>10</u>

Pump Test Data	Method of Measuring Water Level Circle one
Date Well Tested: <u>6/22/09</u>	Air Line Electric Measuring Line <u>Steel Tape</u> <input checked="" type="checkbox"/>
Static Water Level (A): <u>97</u> Feet Below Land Surface	Other (specify): _____
Pumping Water Level (B): _____ Feet Below Land Surface	For flowing well, measured shut in head: _____ feet
Drawdown [(B) - (A)]: _____ Feet Below Land Surface	Well yielded _____ GPM with a drawdown of _____ feet after _____ hours of pumping
Test Pumping Rate: <u>15</u> Gallons Per Minute	
Duration of Pump Test (minimum 4 hours): _____ hours	

I HEREBY CERTIFY that the above statements are true to the best of my knowledge.

Donald B. Clardy 0-496 Donald B. Clardy
 Print Name of Pump Installer and License No. (if applicable) Signature of Pump Installer

Form: OLWR-SWR-1B (04/08)

RECEIVED

JUL 16 2009

BY: OLWR