

# State Well Report

## Part 1

Mississippi Department of Environmental Quality

Office of Land and Water Resources

P.O. Box 10631

Jackson, MS 39289-0631

(601)961-5210

(601)354-6938 (fax)

For Office Use Only:

Aquifer: B 89

Well #: \_\_\_\_\_

L. S. Elevation: \_\_\_\_\_

E-log #: \_\_\_\_\_

County: Lincoln  
Permit #: \_\_\_\_\_  
Driller: GRENN WATER WELL & SUPPLY, INC  
Date drilling completed: 5/12/10

State Law requires that this report be prepared by the driller in detail and filed with the Department within 30 days of completion of drilling of the well.

Well Owner Information	Well Location
Owner Name: <u>Wayne Tanner</u>	Latitude: <u>31° 40' 48.3" N</u> Longitude: <u>90° 33' 48.9" W</u>
Mailing Address: <u>1943 Pleasant Ridge Rd</u>	Method of Lat/Long (circle one): <u>Conventional Survey</u>
<u>Wesson</u> MS <u>39191</u>	USGS quad, <u>Hand-held GPS</u> Survey-grade GPS
City State Zip Code	<u>NW 1/4 SE 1/4 Sec 12 Twn 8N Rng 6E</u>
Telephone No. <u>(601) 833-1742</u>	Distance Direction Nearest Town <u>4</u> Miles <u>N</u> of <u>Lloyd Star</u>

**Well Data**

Purpose of Well (circle one) Home Industrial Public Supply Irrigation Fish Culture Other: \_\_\_\_\_

Date well drilling started: 5/12/10 Date well drilling completed: 5/12/10

If flowing, method of flow regulation: Valve \_\_\_\_\_ Other (describe) \_\_\_\_\_

Static Water Level: 57 feet above or below (circle one) land surface Date measured: 5/12/10

Method of Measurement (circle one) steel tape electric tape air line other: \_\_\_\_\_

Hole depth: 85 Well depth: 80 Well grouted to a depth of 10 feet

Type of grout (circle one): Cement Bentonite Mix

Casing length: 60 feet Casing diameter: 4" inches Type of casing: PVC

Screen length: 20 feet Screen diameter: 4" inches Type of screen: PVC

Screen slot size: .010 inches Setting depth: From 60 feet to 80 feet

Type of completion (circle all applicable): Gravel packed Underreamed Telescoped Open hole Natural Development

Other (describe): \_\_\_\_\_

Top of lap pipe or reduction in casing: \_\_\_\_\_ feet. If telescoped or more than one screen, describe on back of page

Logs run (circle all applicable) No log run Electric Gamma Ray Density Sonic Neutron Other: \_\_\_\_\_

Name of organization running log(s): \_\_\_\_\_

I certify that the well was drilled, constructed, and completed in accordance with all applicable requirements of the Mississippi

Department of Environmental Quality and/or the Mississippi Department of Health regulations and state laws.

GRENN WATER WELL & SUPPLY, INC.  
WILLIAM L. HARDIN, LIC. NO. 0-802

Print Name of Water Well Contractor and License No.

*Chaz Hardin*

Signature of Water Well Contractor

RECEIVED

JUN 07 2010

BY: O.

If well telescopes please sketch below and show depths.

Ground Level

Description of Formations Encountered	From	To
red clay (citronelle)	0	12
sand & gravel	12	80
yellow clay	80	85

If more than one screen, show location of each on sketch

Sketch the property layout and include the following: 1) the well location; 2) any permanent structures on the property that may aid in locating the well; 3) any roads, power lines, or other items that may aid in locating the property and the well; 4) indicate direction.

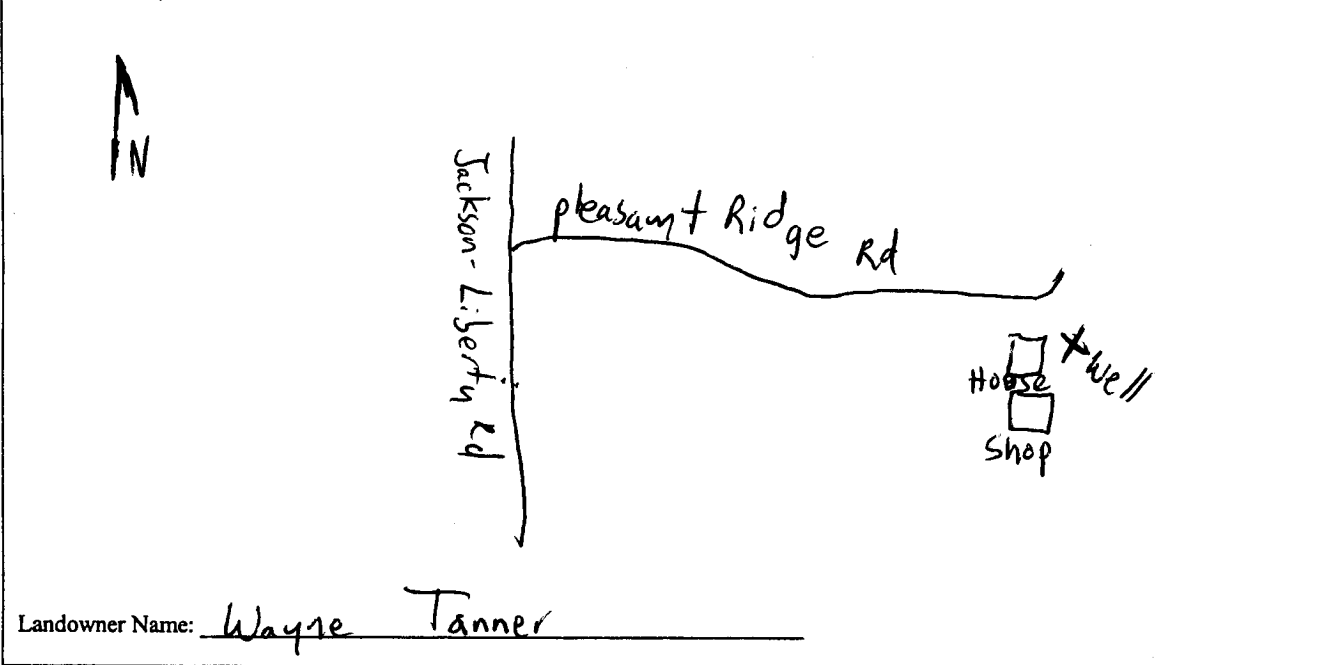

Landowner Name: Wayne Tanner

GRENN WATER WELL & SUPPLY, INC.  
WILLIAM L. HARDIN, LIC. NO. 0-802

Chris Hardin  
Signature of Water Well Contractor

# STATE WELL REPORT

## Part 2

**Pump Installer's Completion Report**  
 Mississippi Department of Environmental Quality  
 Office of Land and Water Resources  
 P.O. Box 10631  
 Jackson, MS 39289-0631  
 (601)961-5210  
 (601)354-6938 (fax)

County: Lincoln  
 Permit #: \_\_\_\_\_  
 Driller: GRENN WATER WELL & SUPPLY, INC  
 Date completed: 5/25/10

**For Office Use Only:**

Aquifer: B89  
 Well #: \_\_\_\_\_  
 Elevation: \_\_\_\_\_

**This report should be prepared by the pump installer in detail and filed with the Department within 30 days of the installation of pump.**

Well Owner Information	Well Location
Owner Name: <u>Wayne Tanner</u>	Latitude: <u>31° 40' 45.3" N</u> Longitude: <u>90° 33' 48.9" W</u>
Mailing Address: <u>1943 Pleasant Ridge Rd</u>	Method of Lat/Long (circle one): Conventional Survey,
<u>Wesson MS 39191</u>	USGS quad: <u>Hand-held GPS</u> , Survey-grade GPS
City State Zip Code	<u>NW 1/4 SE 1/4 Sec 12 Twn 8N Rng 6E</u>
Telephone No. <u>(601) 833-1742</u>	Distance Direction Nearest Town
	<u>4</u> Miles <u>N</u> of <u>Loyd Star</u>

Pump Type Circle one	Power Type Circle one
Air Lift Jet <input type="radio"/> <u>Submersible</u>	Diesel Engine Gasoline Engine Natural Gas
Bucket Piston Turbine	<u>Electric Motor</u> Hand Tractor PTO
Centrifugal Rotary Flowing Well	Windmill Other (specify): _____
Other (specify): _____	Horse Power Rating of Motor: <u>3/4</u>
Date Pump Installed: <u>5/25/10</u>	Setting Depth: <u>79</u> feet
Rated Pump Capacity: <u>10</u> Gallons Per Minute	Number of Stages: <u>12</u>

Pump Test Data	Method of Measuring Water Level Circle one
Date Well Tested: <u>5/25/10</u>	Air Line <input type="radio"/> <u>Electric Measuring Line</u> Steel Tape
Static Water Level (A): <u>57</u> Feet Below Land Surface	Other (specify): _____
Pumping Water Level (B): <u>68</u> Feet Below Land Surface	For flowing well, measured shut in head: _____ feet
Drawdown [(B) - (A)]: <u>11</u> Feet Below Land Surface	Well yielded <u>14</u> GPM with a drawdown of
Test Pumping Rate: <u>14</u> Gallons Per Minute	<u>11</u> feet after <u>4</u> hours of pumping
Duration of Pump Test (minimum 4 hours): <u>4</u> hours	

I HEREBY CERTIFY that the above statements are true to the best of my knowledge.  
 GRENN WATER WELL & SUPPLY, INC.  
WILLIAM L. HARDIN, LIC. NO. 0-802  
 Print Name of Pump Installer and License No. (if applicable)

William Hardin  
 Signature of Pump Installer

**RECEIVED**  
 JUN 07 2010  
 BY: OIWR