

# STATE WELL REPORT

## Part 1

### Driller's Log

Mississippi Department of Environmental Quality  
Office of Land and Water Resources  
P.O. Box 2309  
Jackson, MS 39225-2309  
(601)961-5210  
(601)360-0535 (fax)

#### For Office Use Only:

Well #: N150  
Aquifer: \_\_\_\_\_  
E-Log #: \_\_\_\_\_

County: LeFlore  
Permit #: MS-GW-49332  
Driller: \_\_\_\_\_  
Date drilling completed: 9-15-16

*State Law requires that this report be prepared by the license holder responsible for the work and filed with the Department at the above address within 30 days of completion of drilling of the well or borehole.*

| Well Owner Information<br><small>(Landowner if borehole is not for a water well)</small> | Well or Borehole Location  |
|--|--|
| Owner Name: <u>Marvin Alderman</u>   | Latitude: <u>33° 24' 2" N</u> Longitude: <u>90° 15' 1.96" W</u>  |
| Mailing Address: <u>510 West Jefferson</u>   | Method of Lat/Long (check one): Conventional Survey _____, USGS quad _____, Hand-held GPS <input checked="" type="checkbox"/> , Survey-grade GPS _____ |
| <u>Greenwood</u> <u>MS</u> <u>38930</u>  | <u>NW</u> ¼ <u>NE</u> ¼, Sec <u>25</u> T <u>18N</u> R <u>01W</u>   |
| City State Zip Code  | <u>6</u> Miles <u>SW</u> of <u>Sidon, MS</u>   |
| Telephone No. (____) _____   | (Distance) (Direction) (Nearest Town)  |

| Well / Borehole Data  |
|---|
| Date drilling started: <u>9/15/16</u> Date drilling completed: <u>9/15/16</u> Hole depth: <u>110</u> Hole diameter: <u>22"</u>  |
| Location of the source of any surface water used for drilling: <u>Sidon Cutoff</u>  |
| Method of dosing and volume of Chlorine used in drilling and development: _____   |
| Logs run (circle all applicable): No log run <input checked="" type="checkbox"/> Electric <input type="checkbox"/> Gamma Ray <input type="checkbox"/> Density <input type="checkbox"/> Sonic <input type="checkbox"/> Neutron <input type="checkbox"/> Other: _____                         |
| Name of organization running log(s): _____  |
| Purpose of borehole (circle one): <input checked="" type="checkbox"/> Water Well <input type="checkbox"/> Geotechnical/Geological Investigation <input type="checkbox"/> Ground Source Heat Pump<br><input type="checkbox"/> Seismic Survey <input type="checkbox"/> Other (describe) _____ |
| <i>If drilling is not related to water well construction, skip the remainder of this block</i>  |
| Purpose of Well (circle all applicable): Home <input type="checkbox"/> Industrial <input type="checkbox"/> Public Supply <input type="checkbox"/> <input checked="" type="checkbox"/> Irrigation <input type="checkbox"/> Fish Culture  |
| Other (describe): _____   |
| If a flowing well, method of flow regulation: Valve _____ Other (describe) _____  |
| Static Water Level: <u>18</u> feet [above or <input checked="" type="checkbox"/> below] land surface Date measured: _____<br><small>(circle one)</small>  |
| Method of measurement (circle one): Steel tape <input type="checkbox"/> Electric tape <input type="checkbox"/> Air line <input type="checkbox"/> Other (describe): _____  |
| Well depth: <u>110</u> Well grouted to a depth of: <u>10</u> feet Type of grout (circle one): <input checked="" type="checkbox"/> Neat Cement <input type="checkbox"/> Bentonite <input type="checkbox"/> Mix   |
| Casing length: <u>70</u> feet Casing diameter: <u>12</u> inches Type of casing: <u>PVC</u>  |
| Screen length: <u>40</u> feet Screen diameter: <u>12</u> inches Type of screen: <u>PVC</u>  |
| Screen slot size: <u>.032</u> inches Setting depth: From <u>70</u> feet to <u>110</u> feet  |
| Type of completion (circle all applicable): <input checked="" type="checkbox"/> Gravel packed <input type="checkbox"/> Underreamed <input type="checkbox"/> Open hole <input type="checkbox"/> Natural Development  |
| Other (describe): _____   |
| Top of tap pipe or reduction in casing: _____ feet  |
| <i>If telescoped or more than one screen, describe on next page</i>   |

RECEIVED  
OCT 17 2016  
BY OLWR

County: Leflore  
Permit #: MS-GW-49332

For Office Use Only:  
Well #: W156

The sketch below only required for water wells

Description of formations encountered must be provided for all wells and boreholes, unless specifically exempted by regulations

If well telescopes, show depths on sketch.

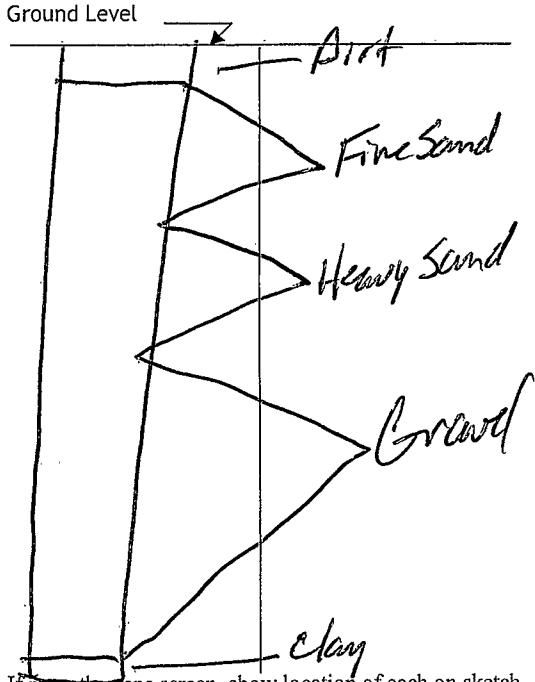

| Description of Formations Encountered | From (depth) | To (depth) |
|---------------------------------------|--------------|------------|
| Dirt                                  | Ground level | 10         |
| Fine Sand                             | 10           | 25         |
| Heavy Sand                            | 25           | 45         |
| Gravel                                | 45           | 108        |
| Clay                                  | 108          | 110        |
|                                       |              |            |
|                                       |              |            |
|                                       |              |            |
|                                       |              |            |
|                                       |              |            |
|                                       |              |            |
|                                       |              |            |
|                                       |              |            |
|                                       |              |            |
|                                       |              |            |
|                                       |              |            |
|                                       |              |            |
|                                       |              |            |

If more than one screen, show location of each on sketch

- Sketch the property layout and include the following:
- 1) the well location
  - 2) any permanent structures on the property that may aid in locating the well
  - 3) any roads, power lines, or other items that may aid in locating the property and the well
  - 4) north arrow

RECEIVED  
OCT 17 2016  
BY OLWR

Landowner Name: \_\_\_\_\_

I HEREBY CERTIFY that the well/borehole was drilled, constructed, and completed in accordance with all applicable requirements of the Mississippi Department of Environmental Quality and the Mississippi Department of Health regulations, if applicable, and state laws.

Tommy Pearson MW163408 9-15-16 [Signature]  
Print Name of Responsible Licensee and License No. Date Signature of Licensee

N150

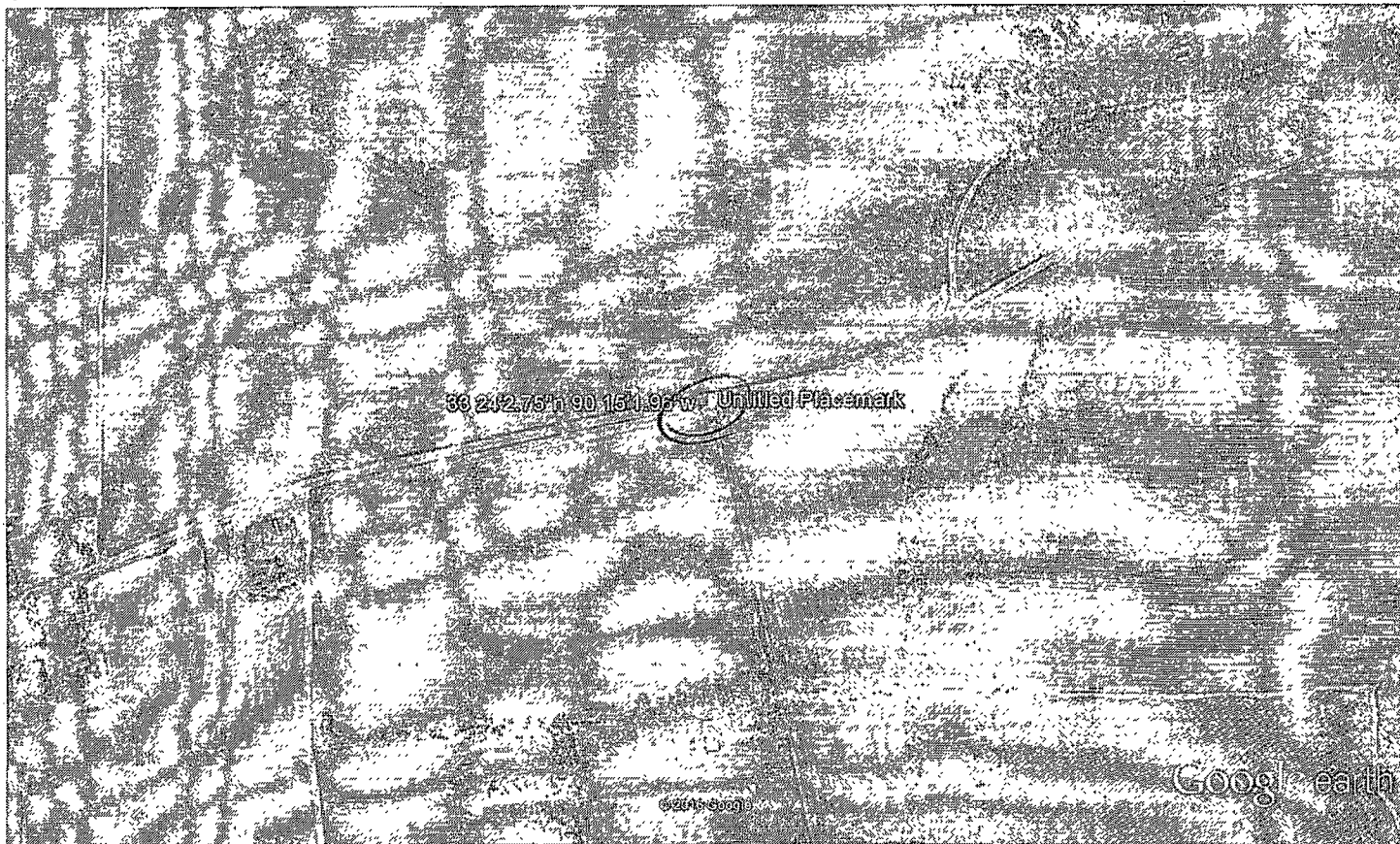

Google earth



RECEIVED  
OCT 17 2016  
BY OLWR

**STATE OF MISSISSIPPI**  
**Department of Environmental Quality**  
**Office of Land and Water Resources**  
**P. O. Box 2309**  
**Jackson, Mississippi 39225**

N156

**PERMIT**

**TO DIVERT OR WITHDRAW FOR BENEFICIAL USE THE PUBLIC WATERS**

This permit is issued to the landowner named below in accordance with the provisions of the Mississippi Water Laws, Mississippi Code Sections 51-3-1, et seq. (1972, as amended), and the regulations and standards as promulgated thereunder. Whether or not specifically named in this permit or in the applications for this permit, anyone using water from the diversion/withdrawal point described below shall do so in compliance with the provisions of this permit. Neither this permit, nor any authority conferred hereby, may be sold, conveyed, encumbered, assigned, or otherwise aliened, for any period of time or under any conditions whatsoever. This permit may not be modified, transferred or revoked without prior action by the Permit Board. Any attempts to modify, transfer or revoke this permit, or to take any other action on this permit, shall be invalid and unenforceable and may result in immediate revocation or suspension of this permit. The holder of this permit shall at all times be responsible for adherence to the terms and conditions of this permit. No agreement between the permit holder and any other party shall affect the obligations and liabilities of the permit holder. Water use under this permit is allowed only when the streamflow, lake level elevation, or static groundwater level (whichever, if any, is applicable) is above the established minimum, pursuant to Mississippi Code Section 51-3-7. Authorization is hereby granted to divert/withdraw water for the beneficial use designated herein, and for no other purpose, subject to the following terms, conditions, and limitations:

**Permit Number:** MS-GW-49332

**Landowner Name:** ALDERMAN, MARVIN

**Landowner Address:** 510 WEST JEFFERSON AVENUE  
GREENWOOD MS 38930

**Source Of Water:** MISSISSIPPI RIVER VALLEY ALLUVIAL AQUIFER

**Beneficial Use:** IRRIGATION

**Diversion/Withdrawal Location:** NW 1/4 of the NE 1/4      **Section:** 25      **Township:** 18N      **Range:** 01W

**County:** LEFLORE

**Quad:** ITTA BENA

**Maximum Volume:** 90 Acre-Foot/Year      *equivalent to* .0803 Million Gallons/Day

**Maximum Rate:** 1800 Gallons/Minute

**Applicant Name:** ALDERMAN, SPENCER

**Applicant Address:** 2012 COUNTY ROAD 122  
CARROLLTON MS 38917

**Date Permit Issued:** 03/28/2016

**Date Permit Expires:** 03/28/2021

**Date Permit Modified:**

**Date Permit Re-issued:**

This permit shall be deemed null and void if construction has not begun within one (1) year of permit issue date

**SPECIAL TERMS AND CONDITIONS:** SEE ATTACHMENT 1, WHICH IS HEREBY DECLARED TO BE PART OF THIS PERMIT.

**SPECIAL TERMS AND CONDITIONS 2:**

RECEIVED

OCT 17 2016

BY OLWR



Gary C. Rikard, Executive Director  
Mississippi Department of Environmental Quality