

STATE WELL REPORT

Part 1

Driller's Log

Mississippi Department of Environmental Quality
Office of Land and Water Resources
P.O. Box 2309
Jackson, MS 39225-2309
(601)961-5210
(601)360-0535 (fax)

County: LELFORE
Permit #: GW-51585
Driller: CHAD MATTOX
Date drilling completed: 5/7/21

For Office Use Only:
Well #: M160
Aquifer: _____
E-Log #: _____

State Law requires that this report be prepared by the license holder responsible for the work and filed with the Department at the above address within 30 days of completion of drilling of the well or borehole.

<p>Well Owner Information (Landowner if borehole is not for a water well)</p> <p>Owner Name: <u>ASA BENNETT</u> Mailing Address: <u>605 ROBERT E LEE DR</u> <u>GREENWOOD</u> MS 38930 City State Zip Code Telephone No. (____) _____</p>			<p>Well or Borehole Location</p> <p>Latitude: <u>33.413611</u> Longitude: <u>-90.439722</u> Method of Lat/Long (check one): Conventional Survey <input type="radio"/>, USGS quad <input type="radio"/>, Hand-held GPS <input checked="" type="radio"/>, Survey-grade GPS <input type="radio"/> <u>NE</u> ¼ <u>NE</u> ¼, Sec <u>19</u> T <u>18N</u> R <u>02W</u> <u>4</u> Miles <u>SE</u> of <u>MOORHEAD</u> (Distance) (Direction) (Nearest Town)</p>		
--	--	--	---	--	--

Well / Borehole Data

Date drilling started: 5/7/21 Date drilling completed: 5/7/21 Hole depth: 115 Hole diameter: 24
Location of the source of any surface water used for drilling: NEARBY DITCH
Method of dosing and volume of Chlorine used in drilling and development: _____
Logs run (check all applicable): No log run Electric Gamma Ray Density Sonic Neutron Other: _____
Name of organization running log(s): _____
Purpose of borehole (circle one): Water Well Geotechnical/Geological Investigation Ground Source Heat Pump
 Seismic Survey Other (describe) _____
If drilling is not related to water well construction, skip the remainder of this block
Purpose of Well (check all applicable): Home Industrial Public Supply Irrigation Fish Culture
Other (describe): _____
If a flowing well, method of flow regulation: Valve _____ Other (describe) _____
Static Water Level: 13 feet above / below land surface Date measured: 5/7/21
(select one)
Method of measurement (select one): Steel tape Electric tape Air line Other (describe): _____
Well depth: 115 Well grouted to a depth of: 10 feet Type of grout (select one): Neat Cement Bentonite Mix
Casing length: 75 feet Casing diameter: 16 inches Type of casing: PVC
Screen length: 40 feet Screen diameter: 16 inches Type of screen: PVC
Screen slot size: .032 inches Setting depth: From ~~70~~ 75 feet to 115 feet
Type of completion (check all applicable): Gravel packed Underreamed Open hole Natural Development
Other (describe): _____
Top of lap pipe or reduction in casing: _____ feet
If telescoped or more than one screen, describe on next page

Google Maps 33°24'49.0"N 90°26'23.0"W

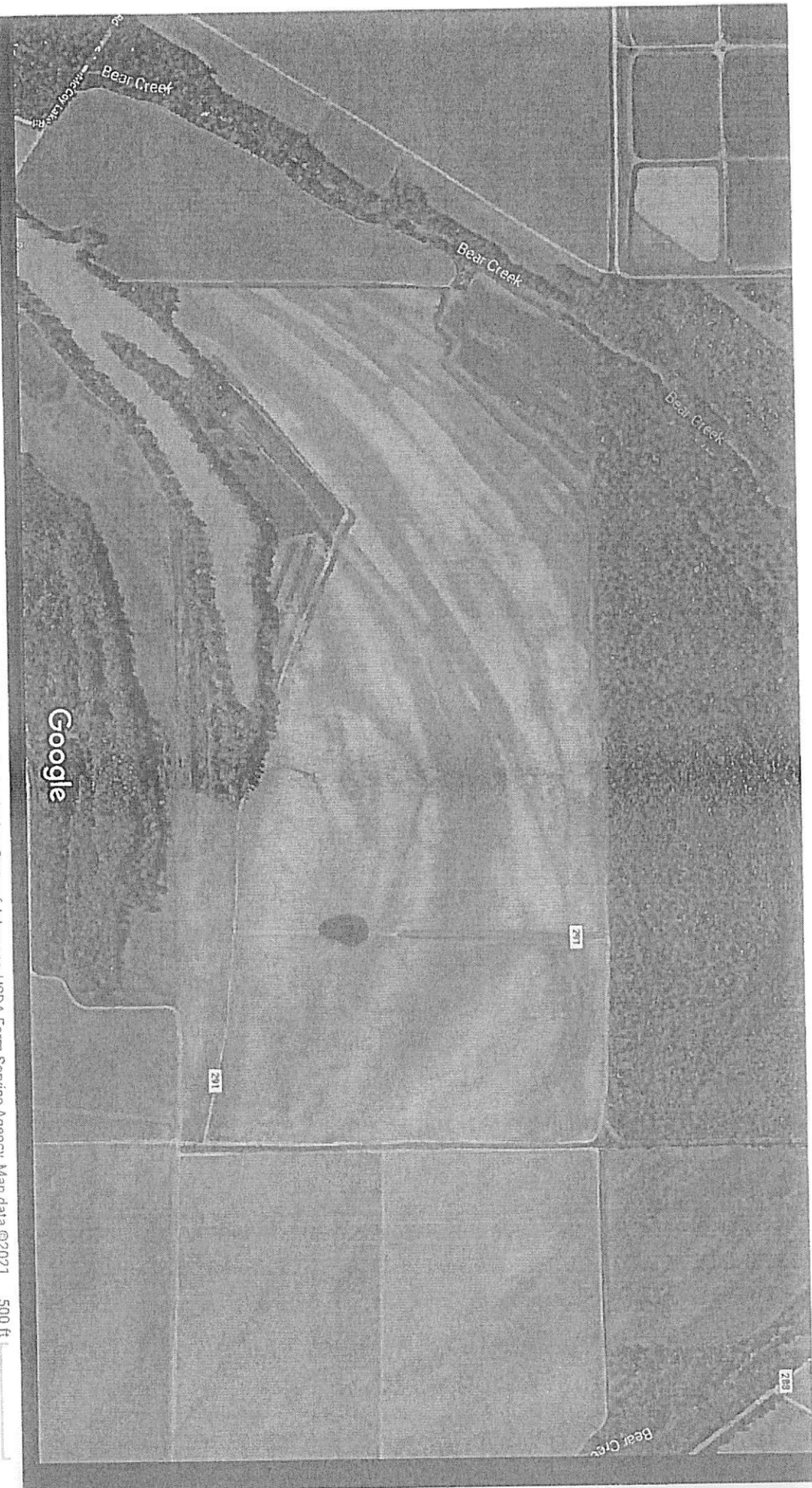

Imagery ©2021 Maxar Technologies, State of Arkansas, USDA Farm Service Agency, Map data ©2021

500 ft

RECEIVED
06-03-2021
BY OLWR

[https://www.google.com/maps/place/33°24'49.0"N+90°26'23.0"W/@33.4150622,-90.4430407,1476m/data=!3m1!1e3!4m5!3m4!1s0x0:0x0:8m2!3d33.4136111!4d-90.4397222](https://www.google.com/maps/place/33°24'49.0)



Don R. Christy, PhD
Executive Director
P. O. Box 129
Stoneville, MS 38776
Tel.: (662) 686-7712
Fax: (662) 686-9078
www.ymd.org

Yazoo Mississippi Delta Joint Water Management District

May 4, 2021

*Bare Bones
Job # 21-0260
Marhead - East side
Redrill pivot well*

RE: CONSTRUCTION NOTICE

Dr. Asa Bennett
605 Robert E. Lee Drive
Greenwood, MS 38930

RE: Receipt for Notification of Construction of Replacement Well MS-GW-51585
which will be replacing GW-47328 well located at
Location: NE1/4 of the NE Section 19 Township 18N Range 02W County Leflore
Latitude: 33.415N Longitude -90.439444

Dear Asa Bennett:

This letter acknowledges your notification to the state that you intend to replace a previously permitted well in the Mississippi River Valley Alluvial Aquifer and that this replacement construction will meet the requirements for a groundwater replacement well specified in 11 Miss. Admin. Code Part 7, Chapter 1, Rule 1.4.F.1 (see attached/back of page). **Construction may begin immediately on your replacement well.**

Remember that you are still required to submit a permit application (enclosed) for the replacement well within 5 days of construction beginning. You are also required to properly decommission (plug and abandon) the replaced well within 180 days of the replacement well's construction.

A copy of this letter, or a water use permit for the replacement well, **must** be attached to the State Well Report submitted by your driller to MDEQ and they must also submit a copy to YMD, as specified in the Water Well Contractor regulations found in 11 Miss. Admin. Code Part 7, Chapter 2, Rule 2.9.

If you have any questions, please call YMD at 662-686-7712.

Sincerely,

Dillard Melton, Jr
Permitting Director