

# State Well Report

## Part 1

Mississippi Department of Environmental Quality  
Office of Land and Water Resources  
P.O. Box 10631  
Jackson, MS 39289-0631  
(601)961-5210  
(601)354-6938 (fax)

County: Leflore  
Permit #: OW 41326  
Irrigation Equipment  
Driller: \_\_\_\_\_  
Date drilling completed: 9-5-06

For Office Use Only:  
Aquifer: \_\_\_\_\_  
Well #: F-125  
L. S. Elevation: \_\_\_\_\_  
E-log #: \_\_\_\_\_

State Law requires that this report be prepared by the driller in detail and filed with the Department within 30 days of completion of drilling of the well.

Well Owner Information	Well Location
Owner Name: <u>Live Oaks Planting Co.</u>	Latitude: <u>33 36 13.2"</u> Longitude: <u>90 023 46.0</u>
Mailing Address: <u>23939 County Road 523</u>	Method of Lat/Long (circle one): <u>13</u> Conventional Survey, <u>46</u>
<u>Schlater MS 38952</u>	USGS quad, Hand-held GPS, Survey-grade GPS
City State Zip Code	<u>NW 1/4 NW 1/4 Sec 15 Twn 20N Rng 2W</u>
Telephone No. ( <u>662-254-7322</u> )	Distance Direction Nearest Town
	<u>4 Miles SW of Schlater</u>

**Well Data**

Purpose of Well (circle one) Home Industrial Public Supply Irrigation Fish Culture Other: \_\_\_\_\_

Date well drilling started: 9-5-06 Date well drilling completed: 9-5-06

If flowing, method of flow regulation: Valve \_\_\_\_\_ Other (describe) \_\_\_\_\_

Static Water Level: 53' feet above or below (circle one) land surface Date measured: 9-22-06

Method of Measurement (circle one) steel tape electric tape air line other: \_\_\_\_\_

Hole depth: 145 Well depth: 145 Well grouted to a depth of 10 feet

Type of grout (circle one): Cement Bentonite Mix

Casing length: 85 feet Casing diameter: 16 inches Type of casing: PVC Sch. 40

Screen length: 60 feet Screen diameter: 16 inches Type of screen: PVC Sch. 40

Screen slot size: .050 inches Setting depth: From 83 feet to 142 feet

Type of completion (circle all applicable): Gravel packed Underreamed Telescoped Open hole Natural Development

Other (describe): \_\_\_\_\_

Top of lap pipe or reduction in casing: \_\_\_\_\_ feet. If telescoped or more than one screen, describe on back of page

Logs run (circle all applicable): No log run Electric Gamma Ray Density Sonic Neutron Other: \_\_\_\_\_

Name of organization running log(s): \_\_\_\_\_

I certify that the well was drilled, constructed, and completed in accordance with all applicable requirements of the Mississippi Department of Environmental Quality and/or the Mississippi Department of Health regulations and state laws.

Irrigation Equipment Inc.  
Patrick M. Chism 0695

Print Name of Water Well Contractor and License No.

*Patrick M. Chism*

Signature of Water Well Contractor

RECEIVED

SEP 28 2006

BY: OLWF

If well telescopes please sketch below and show depths.

Ground Level

Description of Formations Encountered	From	To
Clay	0	22
Fine Sand	23	35
Fine Sand/gravel	36	50
Med. Sand/gravel	51	142
Fine Sand	143	145

If more than one screen, show location of each on sketch

Sketch the property layout and include the following: 1) the well location; 2) any permanent structures on the property that may aid in locating the well; 3) any roads, power lines, or other items that may aid in locating the property and the well; 4) indicate direction.

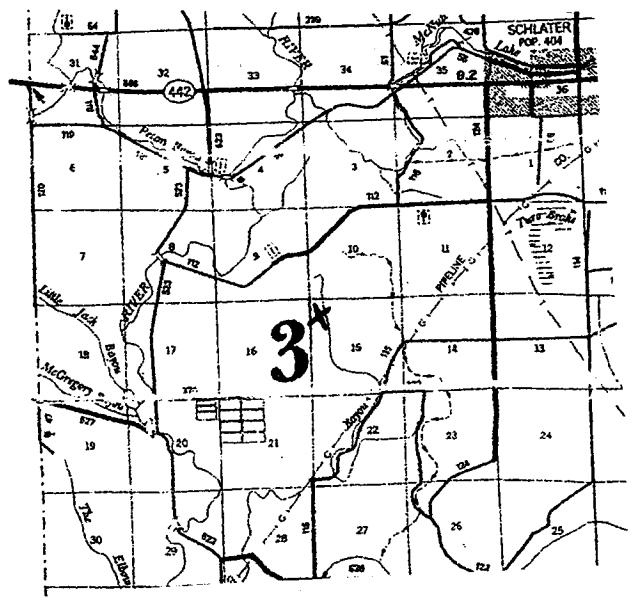

Landowner Name: \_\_\_\_\_

Patrick M. Chis  
Signature of Water Well Contractor

# STATE WELL REPORT

## Part 2

**Pump Installer's Completion Report**  
Mississippi Department of Environmental Quality  
Office of Land and Water Resources

P.O. Box 10631  
Jackson, MS 39289-0631  
(601)961-5210  
(601)354-6938 (fax)

For Office Use Only:

Aquifer: \_\_\_\_\_

Well #: F-175

Elevation: \_\_\_\_\_

County: Leflore

Permit #: 6W41326  
Irrigation Equipment  
Driller: \_\_\_\_\_

Date completed: 9-5-06

*Copy information from block on Part 1*

*This part of the report must be completed by a licensed water well contractor or a licensed pump installer. A copy of Part 1 of the report must be attached and both parts filed with the Department at the above address within 30 days of well completion.*

Well Owner Information	Well Location
Owner Name: <u>Live Oaks Planting Company</u>	Latitude: _____ Longitude: _____
Mailing Address: <u>23939 County Road 523</u>	Method of Lat/Long (check one): Conventional Survey _____
<u>Schlater MS 38952</u>	USGS quad _____, Hand-held GPS _____, Survey-grade GPS _____
City State Zip Code	<u>NW ¼ NW ¼ Sec 15 T. 20N R. 2W</u>
<u>662-254-7322</u>	Distance Direction Nearest Town
Telephone No. ( ) _____	<u>4 Miles SW of Schlater</u>

Pump Type Circle one	Power Type Circle one
Air Lift                      Jet                      Submersible	Diesel Engine              Gasoline Engine              Natural Gas
Bucket                      Piston <u>Turbine</u>	Electric Motor              Hand                      Tractor PTO
Centrifugal                  Rotary                      Flowing Well	Windmill                      Other (specify): _____
Other (specify): _____	Horse Power Rating of Motor: <u>60</u>
Date Pump Installed: <u>9-22-06</u>	Setting Depth: <u>70</u> feet
Rated Pump Capacity: <u>2500-3000</u> Gallons Per Minute	Number of Stages: <u>1</u>

Pump Test Data	Method of Measuring Water Level Circle one
Date Well Tested: _____	Air Line              Electric Measuring Line              Steel Tape
Static Water Level (A): _____ Feet Below Land Surface	Other (specify): _____
Pumping Water Level (B): _____ Feet Below Land Surface	For flowing well, measured shut in head: _____ feet
Drawdown [(B) - (A)]: _____ Feet Below Land Surface	Well yielded _____ GPM with a drawdown of
Test Pumping Rate: _____ Gallons Per Minute	_____ feet after _____ hours of pumping
Duration of Pump Test (minimum 4 hours): _____ hours	

I HEREBY CERTIFY that the above statements are true to the best of my knowledge.

Patrick M. Chism 0695

Print Name of Pump Installer and License No. (if applicable)

*Patrick M. Chism*

Signature of Pump Installer

**RECEIVED**

Form: OLWR-SWR-1B  
SEP 28 2006

BY: OLWR