

LEE

MISSISSIPPI BOARD OF WATER COMMISSIONERS

37  
8-2-61

WATER WELL DRILLERS LOG

HERNDON WELL & SUPPLY CO.

Date: 2/2, 1961, Driller: P.O. BOX 42, County Lee  
Name: SHANNON, MISSISSIPPI

Ralph Deaton

	Description & Color of Materials Sand, Clay, Red Clay, Shell, etc.	Thick- ness Feet	Depth Feet
(1) Owner of Land: <u>Joe Evans</u> (Name)			
<u>Rt 1 Plantersville, Miss</u> (Address)	<u>Surface sand</u>		<u>0</u>
(2) Location: <u>1/4, 1/4, Sec. 1 T. 15 S. R. 6 E</u>	<u>clay</u>		
<u>5 miles North</u> , of <u>Nettles</u> (distance) (direction) (Nearest Town)	<u>Blue rock</u>		<u>30</u>
(3) Topography: <u>Hilly</u> (Hilly) (Flat) (Level)	<u>Sand</u>		<u>120</u>
(4) Purpose of Well: <u>Domestic</u> (Domestic Irrigation Municipal, Industrial, Other)	<u>Bottom</u>		<u>260</u>

Information upon completion of well:

- (1) Diameter 4 inches.
- (2) Total Depth 260 feet.
- (3) Water Level 90 feet below top of ground.
- (4) Cased to 34' 7", Size 4"
- (5) Screen: Size —, Length —
- (6) Were any formations sealed against pollution?  
 yes,  no.

If YES depth of formation 30

Why Surface & Sand

Drillers Remarks:

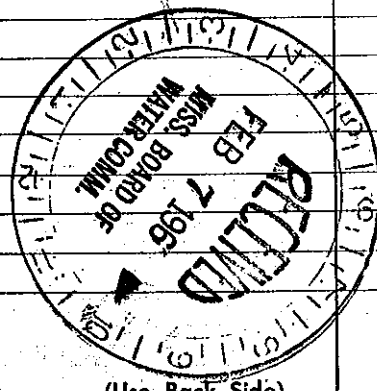
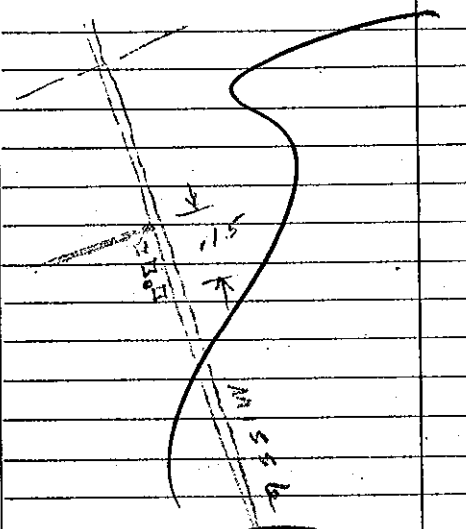

(Use Back Side)

Well No.

277 RLV 305