

MISSISSIPPI BOARD OF WATER COMMISSIONERS

LEE
N 29
4-24-61

WATER WELL DRILLERS LOG

HERNDON WELL & SUPPLY CO.

Date: April 24, 19 61, Driller: HERNDON P. O. BOX 42 County LEE
SHANNON, MISSISSIPPI

	Description & Color of Materials Sand, Clay, Red Clay, Shell, etc.	Thick- ness Feet	Depth Feet
(1) Owner of Land: <u>William D. Burtson</u> (Name)	<u>Surface soil</u>		<u>0</u>
<u>At Shannon, Miss.</u> (Address)	<u>clay</u>		<u>14</u>
(2) Location: <u>1/4</u> , <u>1/4</u> , Sec. <u>2</u> T. <u>11 S</u> R. <u>5 E</u>	<u>Blue rock</u>		<u>360</u>
<u>4</u> miles <u>N. W.</u> of <u>Shannon</u> (Distance) (direction) (Nearest Town)	<u>sand</u>		<u>480</u>
(3) Topography: <u>At top of hill</u> (Hilly) (Flat) (Level)	<u>Bottom</u>		
(4) Purpose of Well: <u>Home use</u> (Domestic Irrigation Municipal, Industrial, Other)			

Information upon completion of well:

- (1) Diameter 4 inches.
- (2) Total Depth 480 feet.
- (3) Water Level 110 feet below top of ground.
- (4) Cased to 215", Size 4"
- (5) Screen: Size _____, Length _____
- (6) Were any formations sealed against pollution?
yes, _____ no.

If YES depth of formation 16 ft
Why Siltstone & sand
Drillers Remarks: Rad 2 1/4 HP

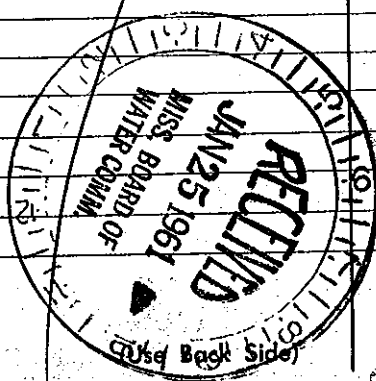
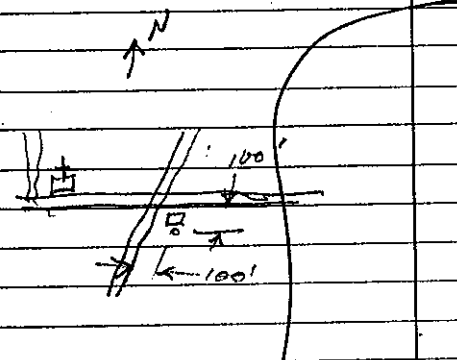

Well No.

242 ELEV 338