

BOARD OF WATER COMMISSIONERS

WATER WELL DRILLERS LOG

LEE 8-24, 1960, Driller: Living Gas Co. County Lee
 L 24 (Name)

8-24-60
 (1) Owner of Land: Shelby Green
 (Name)
Plantersville, Miss.
 (Address)
 (2) Location: 1/4, 1/4, Sec. 35 T10 R6E
5
 miles of (distance) (direction) (Nearest Town)
 (3) Topography: Hills (Hilly) (Flat) (Level)
 (4) Purpose of Well: Household
 (Domestic Irrigation, Municipal, Industrial, Other)

Description & Color of Materials Sand, Clay, Red Clay, Shell, etc.	Thick- ness Feet	Depth Feet
<u>1.5' sand & gravel chert</u>		
<u>1.5' sand & gravel</u>		
<u>at</u>		

Information upon completion of well:

(1) Diameter 4 inches.
 (2) Total Depth 308 feet.
 (3) Water Level 90 feet below top of ground.
 (4) Cased to 29', Size 44
 (5) Screen: Size _____, Length _____
 (6) Were any formations sealed against pollution?
 yes, no.

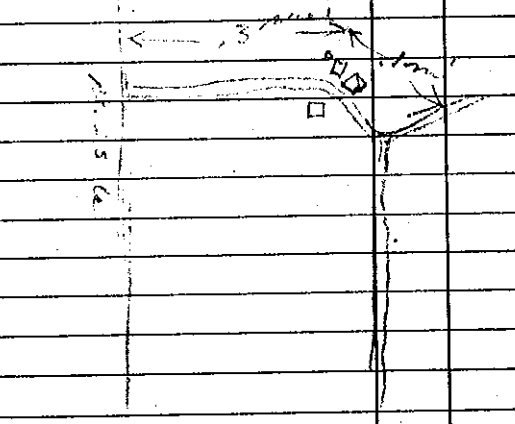

If YES depth of formation 29'
 Why _____
 Drillers Remarks: _____

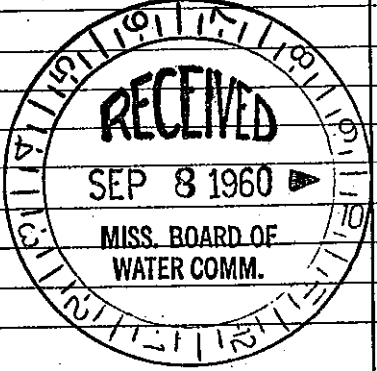

Well No.

(Use Back Side)

Mail this copy to Board of Water Commissioners 429 Miss. St. Jackson, Miss.

204 ELEV 315