

LEE

MISSISSIPPI BOARD OF WATER COMMISSIONERS

K 31

WATER WELL DRILLERS LOG

8-10-61

HERNDON WELL & SUPPLY CO.

Date: 8/10, 1961, Driller: SHANNON, MISSISSIPPI County Lee

TRENNIS FANDELL

(1) Owner of Land: <u>Trentie Powell</u> (Name)	Description & Color of Materials Sand, Clay, Red Clay, Shell, etc.	Thick- ness Feet	Depth Feet
<u>RT 3 Tupelo, Miss</u> (Address)	<u>Surface sand & clay</u>		0
(2) Location: <u>SE 1/4, NW 1/4, Sec 105</u>	<u>Blue rock</u>		20
<u>3 miles S West, of Verona</u> (distance) (direction) (Nearest Town)	<u>sand</u>		360
(3) Topography: <u>hill side</u> (Hilly) (Flat) (Level)	<u>Bottom</u>		480
(4) Purpose of Well: <u>Domestic</u> (Domestic Irrigation Municipal, Industrial, Other)	<u>Right</u>		

Information upon completion of well:

- (1) Diameter 4 inches.
- (2) Total Depth 480 feet.
- (3) Water Level 140 feet below top of ground.
- (4) Cased to 22' 8", Size 4"
- (5) Screen: Size _____, Length _____
- (6) Were any formations sealed against pollution?
 yes, _____ no.

If YES depth of formation 20 ft

Why Surface sand

Drillers Remarks:

188 ELEV 325

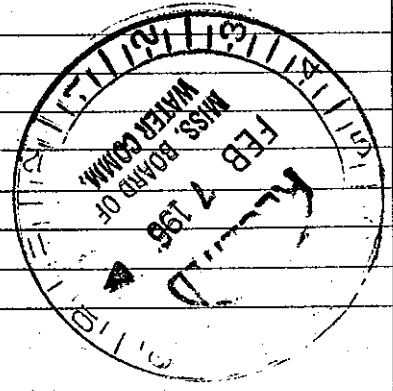
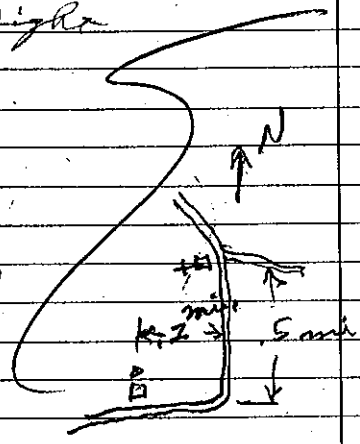

(Use Back Side)

Well No.