

LEE MISSISSIPPI BOARD OF WATER COMMISSIONERS

H 48

7-6-63

WATER WELL DRILLERS LOG

Date: 7/6, 1963, Driller: HERNDON WELL & SUPPLY CO. P.O. BOX 42
SHANNON (Name) MISSISSIPPI County Lee

(1) Owner of Land:	Description & Color of Materials	Thick- ness Feet	Depth Feet
Vernith Wicker (Name)	Surface sand	0	0
At 4 Tupelo, Miss. (Address)	clay		
(2) Location: 1/4, 1/4, Sec. 35 T. R. 4E	Blue sand	30	30
3 miles W of Newick (distance) (direction) (Nearest Town)	Silt	200	200
(3) Topography: hilly (Hilly) (Flat) (Level)	Bottom	320	320
(4) Purpose of Well: Domestic (Domestic Irrigation Municipal, Industrial, Other)			

Information upon completion of well:

- (1) Diameter 4 inches.
- (2) Total Depth 320 feet.
- (3) Water Level 120 feet below top of ground.
- (4) Cased to 35 9/16", Size 4"
- (5) Screen: Size _____, Length _____
- (6) Were any formations sealed against pollution?
yes, no.

If YES depth of formation 30'
Why Surface & sand
Drillers Remarks: trailer

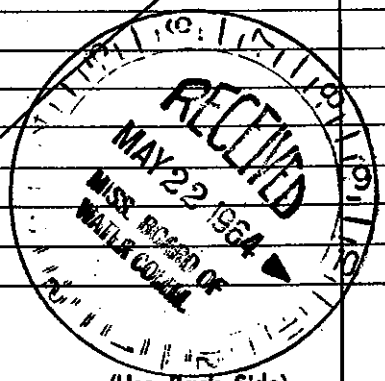
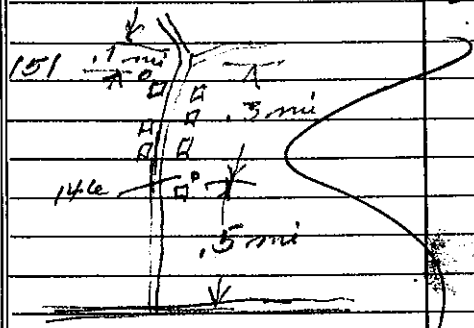

(Use Back Side)

Well No.

146 ELEV 340

Mail this copy to Board of Water Commissioners 429 Miss. St. Jackson, Miss.