

LEE
B 36
8-20-62

MISSISSIPPI BOARD OF WATER COMMISSIONERS

WATER WELL DRILLERS LOG

Date: AUG 20, 1962, Driller: OTTIS Webb, Jr. County Lee
(Name)

(1) Owner of Land: J. R. Pettibrew
(Name)
GUNTOWN, MISS.
(Address)

Description & Color of Materials
Sand, Clay, Red Clay, Shell, etc.

Thick-
ness
Feet

Depth
Feet

CLAY 0 40
40 BLUE MARL 40 330
MIXED WITH SAND,
WATER SAND 330 484

(2) Location: 1/4, NW 1/4, Sec. 27 T. 2 R. 6

 miles of GUNTOWN
(distance) (direction) (Nearest Town)

(3) Topography: (Hilly) (Flat) (Level)

(4) Purpose of Well: DOMESTIC
(Domestic Irrigation
Municipal, Industrial, Other)

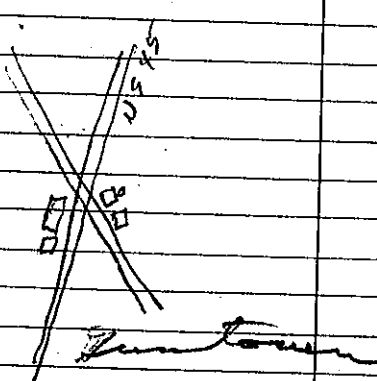

Information upon completion of well:

(1) Diameter 4 inches.

(2) Total Depth 484 feet.

(3) Water Level feet below top of ground.

(4) Cased to 203', Size 4"

(5) Screen: Size , Length

(6) Were any formations sealed against pollution?

 yes, no.

If YES depth of formation

Why

Drillers Remarks: across Hwy 45

from supermarket

22 BLEV 400

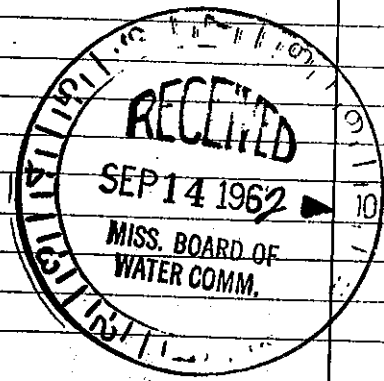

Well No.

(Use Back Side)

Mail this copy to Board of Water Commissioners 429 Miss. St. Jackson, Miss