

MS-GW-16422

County: Leake  
 Permit #: MS-GW-16422  
 Driller: Thomas Drilling  
 Date drilling completed: July 5, 07

### Well Driller Report and Well Log

Mississippi Department of Environmental Quality  
 Office of Land and Water Resources  
 P.O. Box 10631  
 Jackson, MS 39289-0631  
 (601)961-5210  
 (601)354-6938 (fax)

For Office Use Only:  
 Aquifer: \_\_\_\_\_  
 Well #: J-22  
 L. S. Elevation: \_\_\_\_\_  
 E-log #: \_\_\_\_\_

State Law requires that this report be prepared by the driller in detail and filed with the Department within 30 days of completion of drilling of the well.

Well Owner Information	Well Location
Owner Name: <u>Jim Anderson</u>	Latitude: <u>32° 41.902'</u> Longitude: <u>89° 59.359'</u>
Mailing Address: <u>PO Box 307</u>	Method of Lat/Long (circle one): <u>34</u> Conventional Survey, <u>21</u>
<u>Brandon, MS 39043</u>	USGS quad, <u>Hand-held</u> GPS, Survey-grade GPS
City State Zip Code	<u>1/4</u> <u>1/4</u> Sec <u>23</u> Twn <u>10 N</u> Rng <u>6 E</u>
Telephone No. <u>(601) 832-2225</u>	Distance Direction Nearest Town <u>5</u> Miles <u>W</u> of <u>CARTHAGE</u>

**Well Data**

Purpose of Well (circle one) Home Industrial Public Supply Irrigation Fish Culture Other: \_\_\_\_\_

Date well drilling started: July 5, 07 Date well drilling completed: 7-9-07

If flowing, method of flow regulation: Valve \_\_\_\_\_ Other (describe) \_\_\_\_\_

Static Water Level: 90 feet above or below (circle one) land surface Date measured: 7-9-07

Method of Measurement (circle one) steel tape electric tape air line other: \_\_\_\_\_

Hole depth: 285 Well depth: 285 Well grouted to a depth of 710 feet

Type of grout (circle one): Cement Bentonite Mix

Casing length: 245 feet Casing diameter: 6 inches Type of casing: PVC

Screen length: 40 feet Screen diameter: 6 inches Type of screen: PVC

Screen slot size: .010 inches Setting depth: From 245 feet to 285 feet

Type of completion (circle all applicable): Gravel packed Underreamed Telescoped Open hole Natural Development

Other (describe): \_\_\_\_\_

Top of lap pipe or reduction in casing: \_\_\_\_\_ feet. If telescoped or more than one screen, describe on back of page

Logs run (circle all applicable): No log run Electric Gamma Ray Density Sonic Neutron Other: \_\_\_\_\_

Name of organization running log(s): \_\_\_\_\_

I certify that the well was drilled, constructed, and completed in accordance with all applicable requirements of the Mississippi Department of Environmental Quality and/or the Mississippi Department of Health regulations and state laws.

David S. Thomas 0-147 \_\_\_\_\_  
 Print Name of Water Well Contractor and License No. Signature of Water Well Contractor

If well telescopes please sketch below and show depths.

**RECEIVED**  
 AUG 02 2007  
 BY: OLWR

J-22

Ground Level

Description of Formations Encountered	From	To
DIRT & Clay	0	35
SAND & Clay	35	50
GRAY Clay	69	94
SAND & Clay	94	130
SAND (GRAY)	130	164
SAND & Clay	164	180
GRAY Clay	180	205
GRAY Clay W/ fine SAND	205	230
FINE GRAY SAND	230	248
COARSE GRAY SAND	248	285

If more than one screen, show location of each on sketch

Sketch the property layout and include the following: 1) the well location; 2) any permanent structures on the property that may aid in locating the well; 3) any roads, power lines, or other items that may aid in locating the property and the well; 4) indicate direction.

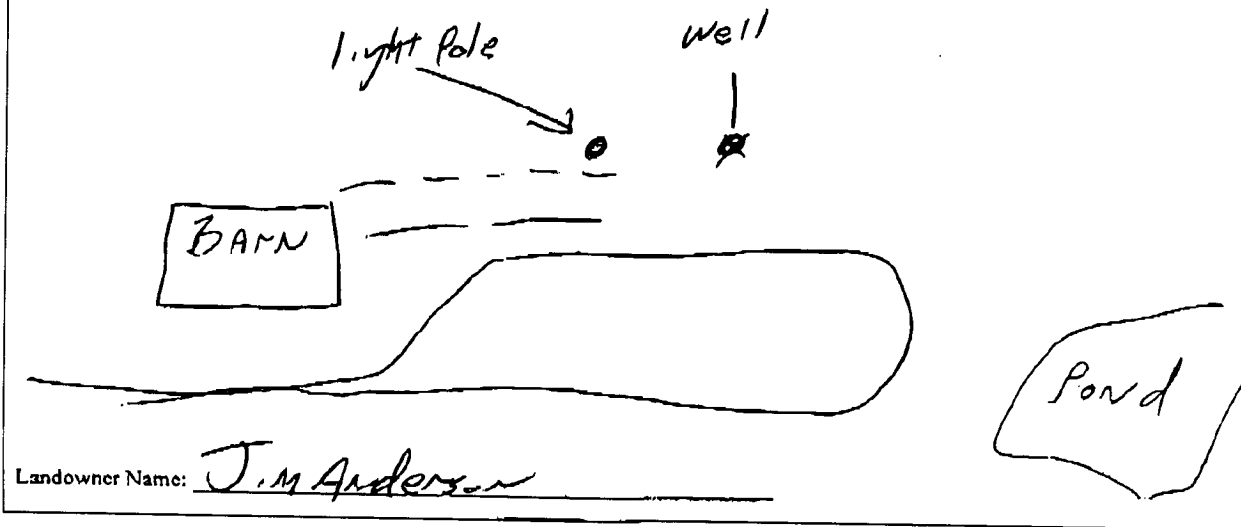

*[Signature]*  
 Signature of Water Well Contractor

RECEIVED  
 AUG 02 2007  
 BY: OLWR

### STATE WELL REPORT

#### Part 2

### Pump Installer's Completion Report

Mississippi Department of Environmental Quality  
 Office of Land and Water Resources  
 P.O. Box 10631  
 Jackson, MS 39289-0631  
 (601)961-5210  
 (601)354-6938 (fax)

County: LEAKE  
 Permit #: MS-GW-10422  
 Driller: Thomas Drilling  
 Date completed: 8-2-07

For Office Use Only:  
 Aquifer: \_\_\_\_\_  
 Well #: J-22  
 Elevation: \_\_\_\_\_

This report must be prepared by the pump installer in detail and filed with the Department within 30 days of the installation of pump. A copy of Part 1 of this report must be attached to this report.

Well Owner Information	Well Location
Owner Name: <u>Jim Anderson</u>	Latitude: <u>32°41.902</u> Longitude: <u>89°39.359</u>
Mailing Address: <u>PO BOX 307</u>	Method of Lat/Long (circle one): Conventional Survey, USGS quad, <u>Handheld</u> GPS, Survey-grade GPS
<u>Brandon, MS 39043</u>	<u>1/4</u> <u>1/4</u> Sec <u>23</u> Twn <u>10N</u> Rng <u>6E</u>
City State Zip Code	Distance Direction Nearest Town
Telephone No. <u>(601) 832-2225</u>	<u>5</u> Miles <u>W</u> of <u>CARTHAGE</u>

Pump Type Circle one	Power Type Circle one
Air Lift Jet <u>Submersible</u>	Diesel Engine Gasoline Engine Natural Gas
Bucket Piston Turbine	<u>Electric Motor</u> Hand Tractor PTO
Centrifugal Rotary Flowing Well	Windmill Other (specify): _____
Other (specify): _____	Horse Power Rating of Motor: <u>20</u>
Date Pump Installed: <u>8-2-07</u>	Setting Depth: <u>210</u> feet
Rated Pump Capacity: <u>200</u> Gallons Per Minute	Number of Stages: <u>6</u>

Pump Test Data	Method of Measuring Water Level Circle one
Date Well Tested: <u>8-2-07</u>	Air Line Electric Measuring Line Steel Tape
Static Water Level (A): <u>90</u> Feet Below Land Surface	Other (specify): _____
Pumping Water Level (B): <u>160</u> Feet Below Land Surface	For flowing well, measured shut in head: _____ feet
Drawdown [(B) (A)]: <u>70</u> Feet Below Land Surface	Well yielded _____ GPM with a drawdown of _____ feet after _____ hours of pumping
Test Pumping Rate: <u>230</u> Gallons Per Minute	
Duration of Pump Test (minimum 4 hours): <u>1</u> hours	

I HEREBY CERTIFY that the above statements are true to the best of my knowledge.

David S. Thomas Signature of Pump Installer  
 Print Name of Pump Installer and License No. (if applicable)

RECEIVED  
 AUG 02 2007  
 BY: OLWE