

State Well Report

Part 1 - Driller's Log

Mississippi Department of Environmental Quality
Office of Land and Water Resources
P.O. Box 2309
Jackson, MS 39225
(601)961- 5210
(601)961- 5228 (fax)

For Office Use Only:

Aquifer: M 143
Well #: _____
L. S. Elevation: _____
E-log #: _____

County: Lauderdale
Permit #: _____
Driller: McDonald's Hill
Date drilling completed: 2/5/10

State Law requires that this report be prepared by the license holder responsible for the work and filed with the Department at the above address within 30 days of completion of drilling of the well or borehole.

Information on Well Owner (Landowner if borehole is not for a water well)	Well or Borehole Location
Owner Name: <u>Lauderdale County Farm Supply</u>	Latitude: <u>32° 21' 25"</u> Longitude: <u>88° 43' 37"</u>
Mailing Address: <u>203 49th Ave</u>	Method of Lat/Long (circle one): Conventional Survey, USGS quad, Hand-held GPS, Survey-grade GPS
City: <u>Meridian</u> State: <u>MS</u> Zip Code: <u>39301</u>	SW 1/4 <u>SW</u> 1/4 Sec <u>24</u> Twn <u>6N</u> Rng <u>15E</u>
Telephone No. () _____	Distance _____ Miles Direction <u>13</u> of _____ Nearest Town _____

Well / Borehole Data

Date drilling started: 2/1/10 Date drilling completed: 2/5/10 Hole depth: 320 Hole diameter: 7"

Location of the source of any surface water used for drilling: Community

Method of dosing and volume of Chlorine used in drilling and development: 1lb per 1,000 gallons

Logs run (circle all applicable): No log run Electric Gamma Ray Density Sonic Neutron Other: _____

Name of organization running log(s): _____

Purpose of borehole (check one): Water Well Geotechnical/Geological Investigation _____ Ground Source Heat Pump _____ Seismic Survey _____ Other (describe) _____

If drilling is not related to water well construction, skip the remainder of this block

Purpose of Well (check one): Home _____ Industrial _____ Public Supply _____ Irrigation Fish Culture _____ Other: _____

If a flowing well, method of flow regulation: Valve _____ Other (describe) _____

Static Water Level: 20 feet above or below (circle one) land surface Date measured: 2/5/10

Method of Measurement (circle one) steel tape electric tape air line other: _____

Well depth: 320 Well grouted to a depth of 10 feet Type of grout (circle one): Neat Cement Bentonite Mix

Casing length: 255 feet Casing diameter: 4 inches Type of casing: PVC

Screen length: 60 feet Screen diameter: 4 inches Type of screen: PVC Sawn

Screen slot size: #.006 inches Setting depth: From 255 feet to 315 feet

Type of completion (circle all applicable): Gravel packed Underreamed Telescoped Open hole Natural Development

Other (describe): _____

Top of lap pipe or reduction in casing: _____ feet. *If telescoped or more than one screen, describe on next page*

Form: OLWR-SWR-1A (04/08)

RECEIVED

MAR 03 2010

BY: OLWR

M143

The sketch below only required for water wells

Description of formations encountered must be provided for all wells and boreholes, unless specifically exempted by regulations

If well telescopes, show depths on sketch.

Ground Level

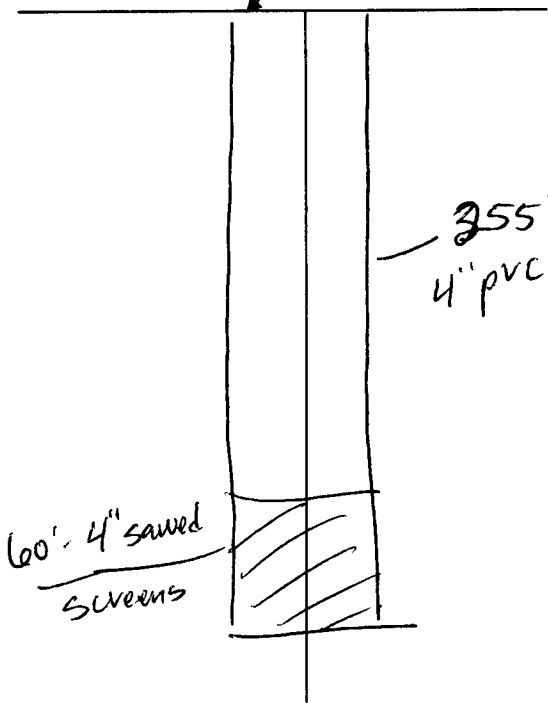

Description of Formations Encountered	From (depth)	To (depth)
Clay	Ground Level	10
Sand	10	15
shale	15	35
sand	35	55
shale	55	60
Sandy shale	60	100
Sandy shale - lignite	100	130
sand Fine	130	150
Sandy shale	150	160
shale + sand st.	160	180
SAND	180	220
Sandy shale.	220	250
sand	250	300
Mindy shale.	300	320

If more than one screen, show location of each on sketch

Sketch the property layout and include the following: 1) the well location; 2) any permanent structures on the property that may aid in locating the well; 3) any roads, power lines, or other items that may aid in locating the property and the well; 4) a north arrow.

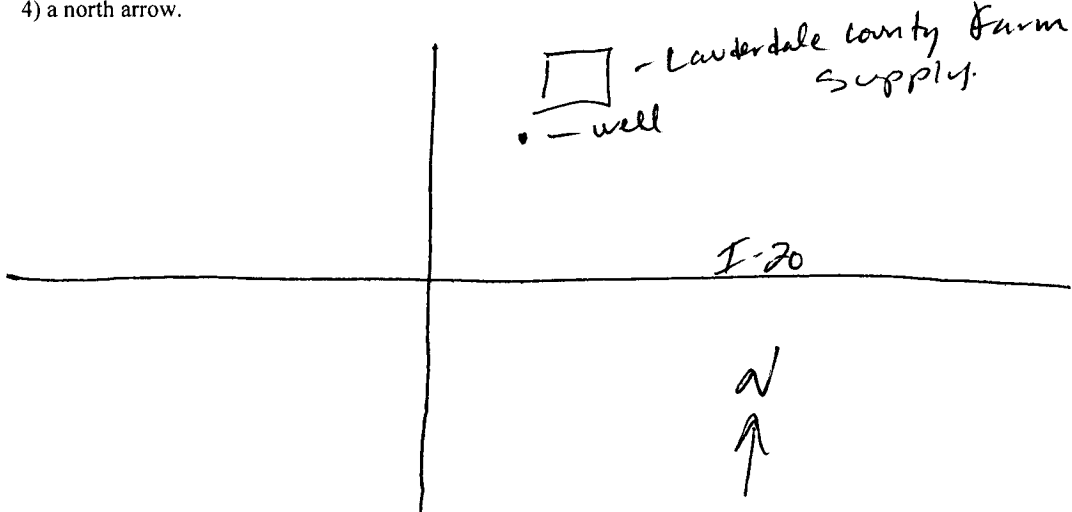

Landowner Name: Lauderdale County Farm Supply.

Form: OLWR-SWR-1A (04/08)

I certify that the well/borehole was drilled, constructed, and completed in accordance with all applicable requirements of the Mississippi Department of Environmental Quality and the Mississippi Department of Health regulations, if applicable, and state laws.

Harold Hill / McDonald Hill / #0-8
Print Name of Responsible Licensee and License No.

3/1/10
Date

Harold Hill
Signature of Licensee

RECEIVED
MAR 03 2010
BY: OLWR

STATE WELL REPORT

Part 2

Pump Installer's Completion Report
 Mississippi Department of Environmental Quality
 Office of Land and Water Resources
 P.O. Box 2309
 Jackson, MS 39225
 (601)961-5210
 (601)961-5228 (fax)

For Office Use Only:

Aquifer: M 143
 Well #: _____
 Elevation: _____

County: Lauderdale
 Permit #: _____
 Driller: McDonald & Hill
 Date completed: 2/15/10
Copy information from block on Part 1

This part of the report must be completed by a licensed water well contractor or a licensed pump installer. A copy of Part 1 of the report must be attached and both parts filed with the Department at the above address within 30 days of well completion.

Well Owner Information	Well Location
Owner Name: <u>Lauderdale County Farm supply</u>	Latitude: _____ Longitude: _____
Mailing Address: <u>203 49th Ave</u>	Method of Lat/Long (check one): Conventional Survey _____
<u>Meridian</u> MS <u>39301</u>	USGS quad _____, Hand-held GPS _____, Survey-grade GPS _____
City State Zip Code	_____ 1/4 _____ 1/4 Sec <u>24</u> T <u>01N</u> R <u>15E</u>
Telephone No. (____) _____	Distance _____ Direction _____ Nearest Town _____
	_____ Miles _____ of _____

Pump Type Circle one	Power Type Circle one
Air Lift Jet <u>Submersible</u>	Diesel Engine Gasoline Engine Natural Gas
Bucket Piston Turbine	<u>Electric Motor</u> Hand Tractor PTO
Centrifugal Rotary Flowing Well	Windmill Other (specify): _____
Other (specify): _____	Horse Power Rating of Motor: <u>5</u>
Date Pump Installed: <u>2/15/10</u>	Setting Depth: <u>100</u> feet
Rated Pump Capacity: <u>55</u> Gallons Per Minute	Number of Stages: <u>11</u>

Pump Test Data	Method of Measuring Water Level Circle one
Date Well Tested: <u>2/15/10</u>	Air Line Electric Measuring Line <u>Steel Tape</u>
Static Water Level (A): <u>26</u> Feet Below Land Surface	Other (specify): _____
Pumping Water Level (B): <u>70</u> Feet Below Land Surface	For flowing well, measured shut in head: _____ feet
Drawdown [(B) - (A)]: <u>50</u> Feet Below Land Surface	Well yielded <u>50</u> GPM with a drawdown of
Test Pumping Rate: <u>50</u> Gallons Per Minute	<u>50</u> feet after <u>4</u> hours of pumping
Duration of Pump Test (minimum 4 hours): <u>4</u> hours	

I HEREBY CERTIFY that the above statements are true to the best of my knowledge.

Harold Hill / McDonald & Hill / #0-8 Harold Hill
 Print Name of Pump Installer and License No. (if applicable) Signature of Pump Installer

RECEIVED
 Form: OLWR-SWR-1B (6/106)
 MAR 03 2010
 BY: OLWR