

State Well Report

Part 1

Mississippi Department of Environmental Quality
Office of Land and Water Resources
P.O. Box 10631
Jackson, MS 39289-0631
(601)961-5210
(601)354-6938 (fax)

For Office Use Only:

Aquifer: _____
Well #: M-169
L. S. Elevation: _____
E-log #: _____

County: Lamar
Permit #: _____
Driller: Gary Rayborn
Date drilling completed: 7-12-06

State Law requires that this report be prepared by the driller in detail and filed with the Department within 30 days of completion of drilling of the well.

Well Owner Information	Well Location
Owner Name: <u>D+D Drilling Inc</u>	Latitude: _____ Longitude: _____
Mailing Address: <u>P.O. Box 1634</u>	Method of Lat/Long (circle one): Conventional Survey, USGS quad, Hand-held GPS, Survey-grade GPS
<u>Ferriday, LA 71334</u> City State Zip Code	_____ 1/4 _____ 1/4 Sec <u>7</u> Twn <u>1N</u> Rng <u>16W</u>
Telephone No. (<u>318</u>) <u>757-3274</u>	Distance <u>4</u> Miles Direction <u>SW</u> of Nearest Town <u>Barkerville</u>
Well Data	
Purpose of Well (circle one) Home Industrial Public Supply Irrigation Fish Culture <u>Other: Rig Supply</u>	
Date well drilling started: <u>7-12-06</u> Date well drilling completed: <u>7-12-06</u>	
If flowing, method of flow regulation: Valve _____ Other (describe) _____	
Static Water Level: <u>45</u> feet above or below (circle one) land surface Date measured: <u>7-12-06</u>	
Method of Measurement (circle one) steel tape electric tape <u>air line</u> other: _____	
Hole depth: <u>160</u> Well depth: _____ Well grouted to a depth of <u>10</u> feet	
Type of grout (circle one): <u>Cement</u> Bentonite Mix	
Casing length: <u>140</u> feet Casing diameter: <u>4"</u> inches Type of casing: <u>PVC</u>	
Screen length: <u>20</u> feet Screen diameter: <u>4"</u> inches Type of screen: <u>PVC</u>	
Screen slot size: <u>.020</u> inches Setting depth: From <u>140</u> feet to <u>160</u> feet	
Type of completion (circle all applicable): <u>Gravel packed</u> Underreamed Telescoped Open hole Natural Development	
Other (describe): _____	
Top of lap pipe or reduction in casing: _____ feet. If telescoped or more than one screen, describe on back of page	
Logs run (circle all applicable): <u>No log run</u> Electric Gamma Ray Density Sonic Neutron Other: _____	
Name of organization running log(s): _____	
I certify that the well was drilled, constructed, and completed in accordance with all applicable requirements of the Mississippi Department of Environmental Quality and/or the Mississippi Department of Health regulations and state laws.	
<u>RAYBORN DRILLING, INC.</u>	<u>0-60</u>
Print Name of Water Well Contractor and License No.	Signature of Water Well Contractor

RECEIVED

AUG 02 2006

BY: OLWR

If well telescopes please sketch below and show depths.

M-169

Ground Level

Description of Formations Encountered	From	To
Red clay	0	40
Red clay & sand streaks	40	80
Fine Red Sand	80	120
Coarse sand	120	160

If more than one screen, show location of each on sketch

Sketch the property layout and include the following: 1) the well location; 2) any permanent structures on the property that may aid in locating the well; 3) any roads, power lines, or other items that may aid in locating the property and the well; 4) indicate direction.

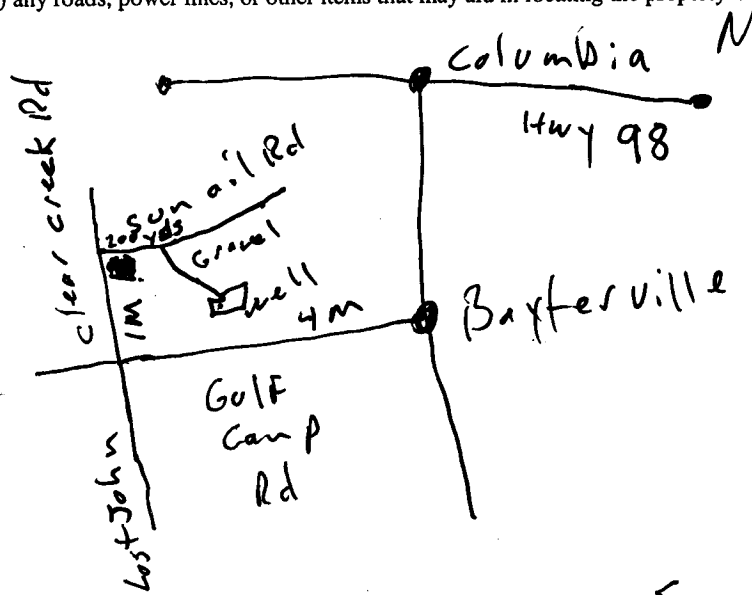

Landowner Name: _____

 Signature of Water Well Contractor

RECEIVED
 AUG 02 2006
 BY: OLWR

STATE WELL REPORT

Part 2

Pump Installer's Completion Report
 Mississippi Department of Environmental Quality
 Office of Land and Water Resources
 P.O. Box 10631
 Jackson, MS 39289-0631
 (601)961-5210
 (601)354-6938 (fax)

For Office Use Only:

Aquifer: _____

Well #: M-169

Elevation: _____

County: Lamar
 Permit #: _____
 Driller: Gary Rayborn
 Date completed: 7-12-06

This report should be prepared by the pump installer in detail and filed with the Department within 30 days of the installation of pump.

Well Owner Information	Well Location
Owner Name: <u>D+D Drilling Inc</u>	Latitude: _____ Longitude: _____
Mailing Address: <u>P.O. Box 1634</u>	Method of Lat/Long (circle one): Conventional Survey, USGS quad, Hand-held GPS, Survey-grade GPS
<u>Ferriday LA 71334</u>	_____ 1/4 _____ 1/4 Sec <u>7</u> Twn <u>1N</u> Rng <u>16W</u>
City State Zip Code	Distance Direction Nearest Town
Telephone No. <u>(388) 757-3274</u>	<u>4</u> Miles <u>SW</u> of <u>Baxterville</u>

Pump Type Circle one	Power Type Circle one
Air Lift Jet <input checked="" type="radio"/> <u>Submersible</u>	Diesel Engine Gasoline Engine Natural Gas
Bucket Piston Turbine	<input checked="" type="radio"/> <u>Electric Motor</u> Hand Tractor PTO
Centrifugal Rotary Flowing Well	Windmill Other (specify): _____
Other (specify): _____	Horse Power Rating of Motor: <u>5</u>
Date Pump Installed: <u>7-12-06</u>	Setting Depth: <u>105</u> feet
Rated Pump Capacity: <u>60</u> Gallons Per Minute	Number of Stages: <u>14</u>

Pump Test Data	Method of Measuring Water Level Circle one
Date Well Tested: <u>7-12-06</u>	<input checked="" type="radio"/> <u>Air Line</u> Electric Measuring Line Steel Tape
Static Water Level (A): <u>45</u> Feet Below Land Surface	Other (specify): _____
Pumping Water Level (B): _____ Feet Below Land Surface	For flowing well, measured shut in head: _____ feet
Drawdown [(B) - (A)]: _____ Feet Below Land Surface	Well yielded <u>60</u> GPM with a drawdown of
Test Pumping Rate: <u>60</u> Gallons Per Minute	_____ feet after _____ hours of pumping
Duration of Pump Test (minimum 4 hours): _____ hours	

I HEREBY CERTIFY that the above statements are true to the best of my knowledge.

GARY Rayborn 0-60
 Print Name of Pump Installer and License No. (if applicable)

[Signature]
 Signature of Pump Installer

RECEIVED
 AUG 02 2006
 BY: OLWR