

# State Well Report

## Part I

Mississippi Department of Environmental Quality  
Office of Land and Water Resources  
P.O. Box 10631  
Jackson, MS 39289-0631  
(601)961-5210  
(601)354-6938 (fax)

### For Office Use Only:

Aquifer: \_\_\_\_\_  
Well #: F-93  
L. S. Elevation: \_\_\_\_\_  
E-log #: \_\_\_\_\_

County: Lamar  
Permit #: \_\_\_\_\_  
Driller: AL HARRINGTON  
Date drilling completed: 1/11/06

State Law requires that this report be prepared by the driller in detail and filed with the Department within 30 days of completion of drilling of the well.

Well Owner Information	Well Location
Owner Name: <u>Walley Piggott</u>	Latitude: <u>N 31° 11' 38.4"</u> Longitude: <u>-89° 35' 52.9"</u>
Mailing Address: <u>Smith Lane</u>	Method of Lat/Long (circle one): <u>38</u> Conventional Survey, <u>53</u>
<u>Shankston MS 39455</u>	USGS quad, <u>Hand-held GPS</u> Survey-grade GPS
City State Zip Code	<u>NW 1/4 SE 1/4 Sec 27 Twn 3N Rng 16W</u>
Telephone No. ( )	Distance <u>2</u> Miles <u>N</u> Direction of <u>Baxtonville</u> Nearest Town

### Well Data

Purpose of Well (circle one) Home Industrial Public Supply Irrigation Fish Culture Other: \_\_\_\_\_

Date well drilling started: 1/10/06 Date well drilling completed: 1/11/06

If flowing, method of flow regulation: Valve \_\_\_\_\_ Other (describe) \_\_\_\_\_

Static Water Level: 131' feet above or below (circle one) land surface Date measured: 1/11/06

Method of Measurement (circle one) steel tape electric tape air line other: \_\_\_\_\_

Hole depth: 226' Well depth: 226' Well grouted to a depth of 20' feet

Type of grout (circle one): Cement Bentonite Mix 156' of 4" 60' 2"

Casing length: 216' feet Casing diameter: 4" x 2" inches Type of casing: PVC

Screen length: 10' feet Screen diameter: 2" inches Type of screen: PVC

Screen slot size: 1008 inches Setting depth: From 216' feet to 226' feet

Type of completion (circle all applicable): Gravel packed Underreamed Telescoped Open hole Natural Development

Other (describe): \_\_\_\_\_

Top of lap pipe or reduction in casing: \_\_\_\_\_ feet. If telescoped or more than one screen, describe on back of page

Logs run (circle all applicable): No log run Electric Gamma Ray Density Sonic Neutron Other: \_\_\_\_\_

Name of organization running log(s): \_\_\_\_\_

I certify that the well was drilled, constructed, and completed in accordance with all applicable requirements of the Mississippi Department of Environmental Quality and/or the Mississippi Department of Health regulations and state laws.

AL HARRINGTON #0-564 AL Harrington  
Print Name of Water Well Contractor and License No. Signature of Water Well Contractor

RECEIVED  
FEB 13 2006  
BY: OLWR

F-93

If well telescopes please sketch below and show depths.

Ground Level

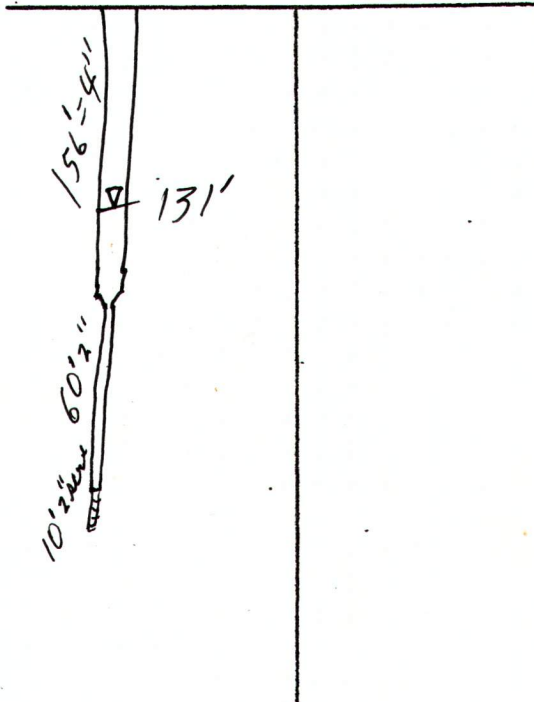

Description of Formations Encountered	From	To
Red clay	0'	18'
Red sand	18'	23'
Yellow sand	23'	30'
Red clay	30'	31'
white clay	31'	70'
Blue Green clay	70'	200'
fine sand	200'	214'
med grey sand	214'	226'

If more than one screen, show location of each on sketch

Sketch the property layout and include the following: 1) the well location; 2) any permanent structures on the property that may aid in locating the well; 3) any roads, power lines, or other items that may aid in locating the property and the well; 4) indicate direction.

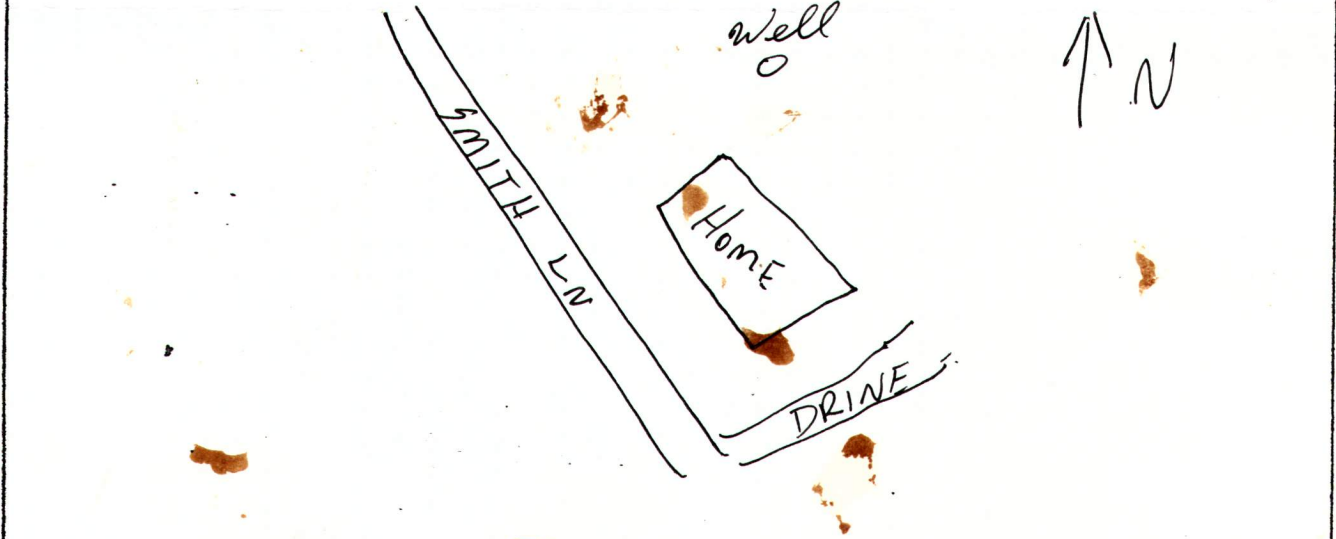

Landowner Name: Walley Piggot

Cl Hamilton  
Signature of Water Well Contractor

RECEIVED  
FEB 13 2006  
BY: OLWR

# STATE WELL REPORT

## Part 2

**Pump Installer's Completion Report**  
 Mississippi Department of Environmental Quality  
 Office of Land and Water Resources  
 P.O. Box 10631  
 Jackson, MS 39289-0631  
 (601)961-5210  
 (601)354-6938 (fax)

For Office Use Only:

Aquifer: \_\_\_\_\_

Well #: F-93

Elevation: \_\_\_\_\_

County: Lamar

Permit #: \_\_\_\_\_

Driller: AL HARRINGTON

Date completed: 1/11/06

**This report should be prepared by the pump installer in detail and filed with the Department within 30 days of the installation of pump.**

Well Owner Information	Well Location
Owner Name: <u>Walley Peggat</u>	Latitude: <u>N31° 11' 38.4"</u> Longitude: <u>W-89° 35' 52.9"</u>
Mailing Address: <u>Smith Ln</u>	Method of Lat/Long (circle one): Conventional Survey, <u>38</u>
<u>Lumberton MS 39455</u>	USGS quad, <u>Hand-held GPS</u> , Survey-grade GPS
City State Zip Code	<u>NW 1/4 SE 1/4 Sec 27 Twn 3N Rng 16W</u>
Telephone No. ( ) _____	Distance Direction Nearest Town
	<u>8</u> Miles <u>N</u> of <u>Barterville</u>

Pump Type Circle one	Power Type Circle one
Air Lift Jet <u>Submersible</u>	Diesel Engine Gasoline Engine Natural Gas
Bucket Piston Turbine	<u>Electric Motor</u> Hand Tractor PTO
Centrifugal Rotary Flowing Well	Windmill Other (specify): _____
Other (specify): _____	Horse Power Rating of Motor: <u>1 HP</u>
Date Pump Installed: <u>1/11/06</u>	Setting Depth: <u>150'</u> feet
Rated Pump Capacity: <u>10 GPM</u> Gallons Per Minute	Number of Stages: _____

Pump Test Data	Method of Measuring Water Level Circle one
Date Well Tested: <u>1/11/06</u>	Air Line Electric Measuring Line <u>Steel Tape</u>
Static Water Level (A): <u>131'</u> Feet Below Land Surface	Other (specify): _____
Pumping Water Level (B): <u>7150'</u> Feet Below Land Surface	For flowing well, measured shut in head: _____ feet
Drawdown [(B) - (A)]: _____ Feet Below Land Surface	Well yielded _____ GPM with a drawdown of _____ feet after _____ hours of pumping
Test Pumping Rate: _____ Gallons Per Minute	
Duration of Pump Test (minimum 4 hours): _____ hours	

I HEREBY CERTIFY that the above statements are true to the best of my knowledge.

AL HARRINGTON #0-564  
 Print Name of Pump Installer and License No. (if applicable)

Al Harrington  
 Signature of Pump Installer

RECEIVED  
 FEB 13 2006  
 BY: OLWR