

County: LAMAR  
 Permit #: 0-586  
 Driller: JAMES WELLS  
 Date drilling completed: 3-23-11

**State Well Report**  
**Part 1 - Driller's Log**  
 Mississippi Department of Environmental Quality  
 Office of Land and Water Resources  
 P.O. Box 2309  
 Jackson, MS 39225  
 (601)961- 5210  
 (601)961- 5228 (fax)

For Office Use Only:  
 Aquifer: A 188  
 Well #: \_\_\_\_\_  
 L. S. Elevation: \_\_\_\_\_  
 E-log #: \_\_\_\_\_

*State Law requires that this report be prepared by the license holder responsible for the work and filed with the Department at the above address within 30 days of completion of drilling of the well or borehole.*

Information on Well Owner (Landowner if borehole is not for a water well)	Well or Borehole Location
Owner Name: <u>Doug Russell</u>	Latitude: <u>31° 25' 23"</u> Longitude: <u>89° 33' 24"</u>
Mailing Address: <u>55 Rock Hill ch. Rd</u> <u>Sumrall MS 39482</u>	Method of Lat/Long (circle one): Conventional Survey, USGS quad, Hand-held GPS, Survey-grade GPS
City: _____ State: _____ Zip Code: _____	<u>SE</u> 1/4 <u>SE</u> 1/4 Sec <u>1</u> Twn <u>5N</u> Rng <u>16W</u>
Telephone No. ( <u>601</u> ) <u>270 1918</u>	Distance: <u>1</u> Miles Direction: <u>North</u> of Nearest Town: <u>Sumrall</u>

**Well / Borehole Data**

Date drilling started: 3-23-11 Date drilling completed: 3-23-11 Hole depth: 80 Hole diameter: 7

Location of the source of any surface water used for drilling:  creek

Method of dosing and volume of Chlorine used in drilling and development: 2 lb shock

Logs run (circle all applicable): No log run Electric Gamma Ray Density Sonic Neutron Other: \_\_\_\_\_

Name of organization running log(s): \_\_\_\_\_

Purpose of borehole (check one): Water Well  Geotechnical/Geological Investigation \_\_\_\_\_ Ground Source Heat Pump \_\_\_\_\_  
 Seismic Survey \_\_\_\_\_ Other (describe) \_\_\_\_\_

*If drilling is not related to water well construction, skip the remainder of this block*

Purpose of Well (check one): Home \_\_\_\_\_ Industrial \_\_\_\_\_ Public Supply \_\_\_\_\_ Irrigation \_\_\_\_\_ Fish Culture \_\_\_\_\_ Other: \_\_\_\_\_

If a flowing well, method of flow regulation: Valve \_\_\_\_\_ Other (describe) \_\_\_\_\_

Static Water Level: 40 feet above or below (circle one) land surface Date measured: \_\_\_\_\_

Method of Measurement (circle one) steel tape electric tape air line other: \_\_\_\_\_

Well depth: 80 Well grouted to a depth of 10 feet Type of grout (circle one): Neat Cement Bentonite Mix

Casing length: 60 feet Casing diameter: 4 inches Type of casing: PVC

Screen length: 20 feet Screen diameter: 4 inches Type of screen: PVC

Screen slot size: .008 inches Setting depth: From 60 feet to 80 feet

Type of completion (circle all applicable): Gravel packed Underreamed Telescoped Open hole Natural Development  
 Other (describe): \_\_\_\_\_

Top of lap pipe or reduction in casing: \_\_\_\_\_ feet. *If telescoped or more than one screen, describe on next page*

Form: OLWR-SWR-1A (04/08)

*Casing only*

RECEIVED  
 APR 18 2011  
 BY: OLWR

A188

The sketch below only required for water wells

Description of formations encountered must be provided for all wells and boreholes, unless specifically exempted by regulations

If well telescopes, show depths on sketch.

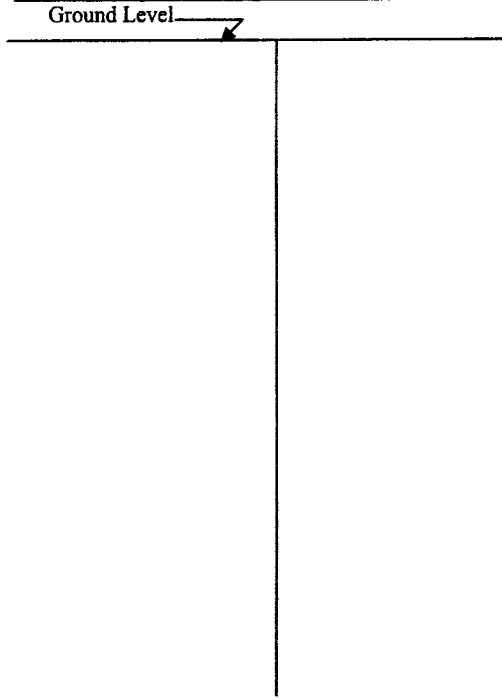

Description of Formations Encountered	From (depth)	To (depth)
	Ground Level	2
clay	2	30
sand	30	50
pen sand	50	80

If more than one screen, show location of each on sketch

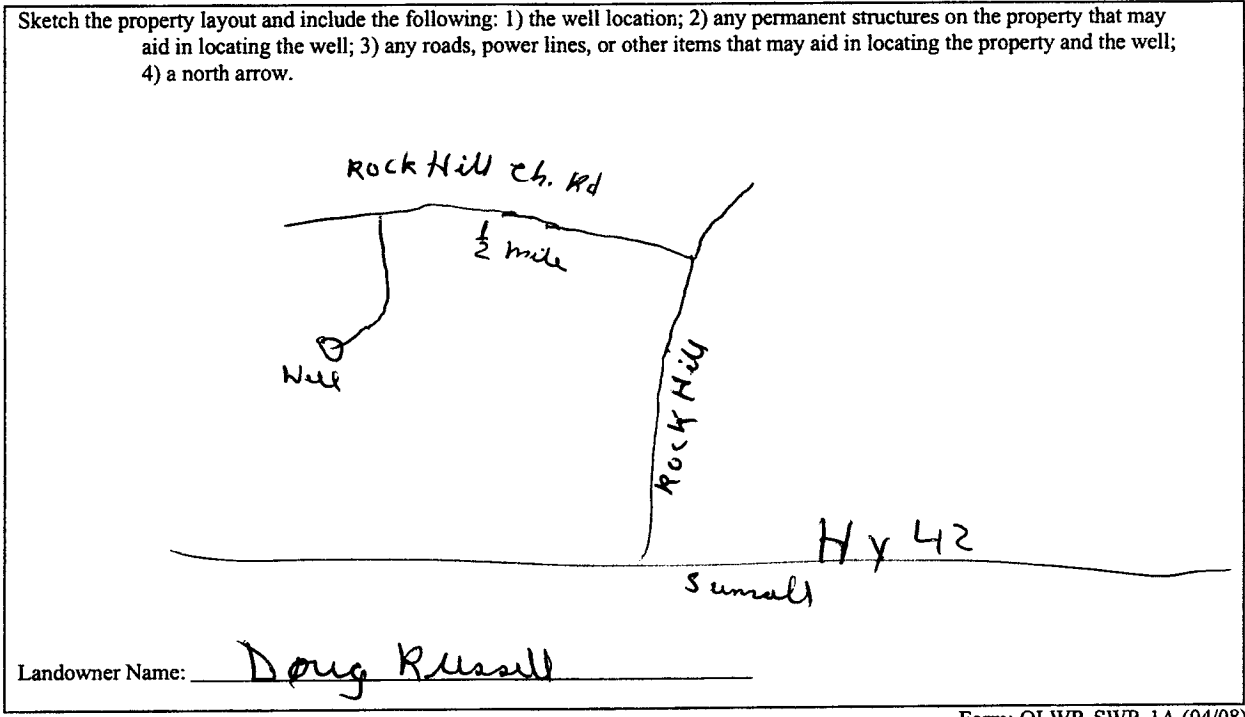

Form: OLWR-SWR-1A (04/08)

I certify that the well/borehole was drilled, constructed, and completed in accordance with all applicable requirements of the Mississippi Department of Environmental Quality and the Mississippi Department of Health regulations, if applicable, and state laws.

JAMES WELLS 0-586  
Print Name of Responsible Licensee and License No.

James Wells  
Signature of Licensee

RECEIVED

APR 18 2012

BY: OLWR

# STATE WELL REPORT

## Part 2

**Pump Installer's Completion Report**  
 Mississippi Department of Environmental Quality  
 Office of Land and Water Resources  
 P.O. Box 10631  
 Jackson, MS 39289-0631  
 (601)961-5210  
 (601)354-6938 (fax)

For Office Use Only:

Aquifer: \_\_\_\_\_  
 Well #: \_\_\_\_\_  
 Elevation: \_\_\_\_\_

County: Lamar  
 Permit #: \_\_\_\_\_  
 Driller: JAMES WELLS  
 Date completed: 3-23-11

This report should be prepared by the pump installer in detail and filed with the Department ~~within 30 days~~ of the installation of pump.

Well Owner Information	Well Location
Owner Name: <u>Doug Russell</u>	Latitude: _____ Longitude: _____
Mailing Address: <u>55 Rock Hill Rd</u> <u>Sumner MS 39482</u>	Method of Lat/Long (circle one): Conventional Survey, USGS quad, Hand-held GPS, Survey-grade GPS
City _____ State _____ Zip Code _____	_____ 1/4 _____ 1/4 Sec <u>1</u> Twn <u>5N</u> Rng <u>16W</u>
Telephone No. <u>(601) 270-1918</u>	Distance _____ Direction _____ Nearest Town _____ <u>1</u> Miles <u>North</u> of <u>Sumner</u>

Pump Type Circle one	Power Type Circle one
Air Lift      Jet <del>Submersible</del>	Diesel Engine      Gasoline Engine      Natural Gas
Bucket      Piston      Turbine	Electric Motor      Hand      Tractor PTO
Centrifugal      Rotary      Flowing Well	Windmill      Other (specify): _____
Other (specify): _____	Horse Power Rating of Motor: _____
Date Pump Installed: _____	Setting Depth: _____ feet
Rated Pump Capacity: _____ Gallons Per Minute	Number of Stages: _____

Pump Test Data	Method of Measuring Water Level Circle one
Date Well Tested: _____	Air Line      Electric Measuring Line      Steel Tape
Static Water Level (A): <u>40</u> Feet Below Land Surface	Other (specify): _____
Pumping Water Level (B): _____ Feet Below Land Surface	For flowing well, measured shut in head: _____ feet
Drawdown [(B) - (A)]: _____ Feet Below Land Surface	Well yielded _____ GPM with a drawdown of _____ feet after _____ hours of pumping
Test Pumping Rate: _____ Gallons Per Minute	
Duration of Pump Test (minimum 4 hours): _____ hours	

I HEREBY CERTIFY that the above statements are true to the best of my knowledge.

JAMES WELLS 0-586      James Wells  
 Print Name of Pump Installer and License No. (if applicable)      Signature of Pump Installer

Cosy only

RECEIVED  
 APR 18 2011  
 BY: OLWR