

County: Lafayette  
Permit #: MS-GW-16504  
Driller: Leeper Drilling  
Date drilling completed: 2/12/09

## State Well Report

### Part 1

Mississippi Department of Environmental Quality  
Office of Land and Water Resources  
P.O. Box 10631  
Jackson, MS 39289-0631  
(601)961-5210  
(601)354-6938 (fax)

#### For Office Use Only:

Aquifer: \_\_\_\_\_  
Well #: E-111  
L. S. Elevation: \_\_\_\_\_  
E-log #: \_\_\_\_\_

State Law requires that this report be prepared by the driller in detail and filed with the Department within 30 days of completion of drilling of the well.

#### Well Owner Information

Owner Name: Wellgate Owner Association  
Mailing Address: 2212 Longspur Pointe  
Oxford, MS 38655  
City State Zip Code  
Telephone No. ( ) \_\_\_\_\_

#### Well Location

Latitude: \_\_\_\_\_ Longitude: \_\_\_\_\_  
Method of Lat/Long (circle one): Conventional Survey,  
USGS quad, Hand-held GPS, Survey-grade GPS  
SE 1/4 SE 1/4 Sec 22 Twn 8S Rng 4W  
Distance 1 1/2 Miles Direction W of Nearest Town Oxford

#### Well Data

Purpose of Well (circle one) Home Industrial Public Supply Irrigation Fish Culture Other: Recreational  
Date well drilling started: 2-12-09 Date well drilling completed: 2-12-09  
If flowing, method of flow regulation: Valve \_\_\_\_\_ Other (describe) \_\_\_\_\_  
Static Water Level: 15 feet above or below (circle one) land surface Date measured: 2-13-09  
Method of Measurement (circle one) steel tape electric tape air line other: \_\_\_\_\_  
Hole depth: 145 ft Well depth: 145 ft Well grouted to a depth of 10 feet  
Type of grout (circle one): Cement Bentonite Mix  
Casing length: 105 feet Casing diameter: 6" inches Type of casing: PVC  
Screen length: 40 feet Screen diameter: 6" inches Type of screen: Pvc  
Screen slot size: .016 inches Setting depth: From \_\_\_\_\_ feet to \_\_\_\_\_ feet  
Type of completion (circle all applicable): Gravel packed Underreamed Telescoped Open hole Natural Development  
Other (describe): \_\_\_\_\_  
Top of lap pipe or reduction in casing: \_\_\_\_\_ feet. If telescoped or more than one screen, describe on back of page  
Logs run (circle all applicable): No log run Electric Gamma Ray Density Sonic Neutron Other: \_\_\_\_\_

Name of organization running log(s): \_\_\_\_\_

I certify that the well was drilled, constructed, and completed in accordance with all applicable requirements of the Mississippi Department of Environmental Quality and/or the Mississippi Department of Health regulations and state laws.

Print Name of Water Well Contractor and License No. Leeper Drilling #1 0079

Signature of Water Well Contractor [Signature]

RECEIVED

MAR 13 2009

BY: OLWR

E-111

Ground Level

145 ft TD

-15 FT = STATIC Level

Gravel pack

6" PVC Screen (40 #)

[illegible]

Sketch the property layout and include the following: 1) the well location; 2) any permanent structures on the property that may aid in locating the well; 3) any roads, power lines, or other items that may aid in locating the property and the well; 4) indicate direction.

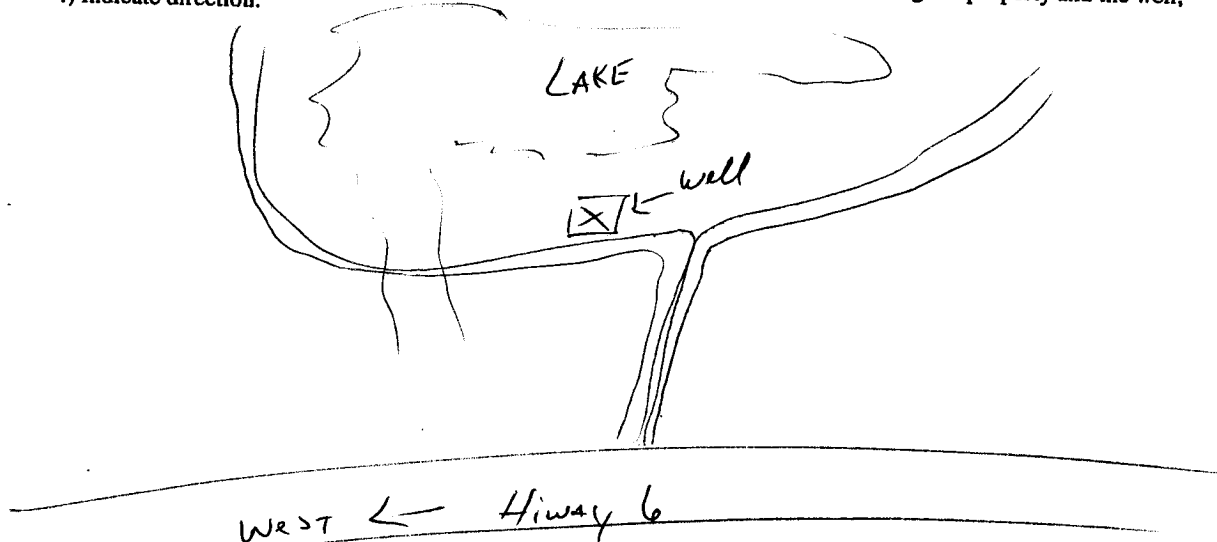

Landowner Name: Wellsgate OWNER Association

**Signature of Water Well Contractor**

BY: OLWR

# STATE WELL REPORT

## Part 2

**Pump Installer's Completion Report**  
Mississippi Department of Environmental Quality  
Office of Land and Water Resources  
P.O. Box 10631  
Jackson, MS 39289-0631  
(601)961-5210  
(601)354-6938 (fax)

For Office Use Only:

Aquifer: \_\_\_\_\_

Well #: E-111

Elevation: \_\_\_\_\_

County: Lafayette  
Permit #: MS-GW-16504  
Driller: Leaper Drilling  
Date completed: 2-18-09

This report should be prepared by the pump installer in detail and filed with the Department within 30 days of the installation of pump.

### Well Owner Information

Owner Name: WellsGate Owners Association  
Mailing Address: 2212 Longspur Pointe  
Oxford, MS 38655  
City State Zip Code  
Telephone No. (662) 801-3012

### Well Location

Latitude: \_\_\_\_\_ Longitude: \_\_\_\_\_  
Method of Lat/Long (circle one): Conventional Survey,  
USGS quad, Hand-held GPS, Survey-grade GPS  
SE 1/4 SE 1/4 Sec 22 Twn 8 S Rng 4 W  
Distance Direction Nearest Town  
1 1/2 Miles W of Oxford

### Pump Type Circle one

Air Lift Jet Submersible  
Bucket Piston Turbine  
Centrifugal Rotary Flowing Well

Other (specify): \_\_\_\_\_

Date Pump Installed: 2-18-09

Rated Pump Capacity: 250 Gallons Per Minute

### Power Type Circle one

Diesel Engine Gasoline Engine Natural Gas  
Electric Motor Hand Tractor PTO  
Windmill Other (specify): \_\_\_\_\_

Horse Power Rating of Motor: 10 HP

Setting Depth: 100 feet

Number of Stages: 4

### Pump Test Data

Date Well Tested: 2-13-09  
Static Water Level (A): 15 Feet Below Land Surface  
Pumping Water Level (B): \_\_\_\_\_ Feet Below Land Surface  
Drawdown [(B) - (A)]: \_\_\_\_\_ Feet Below Land Surface  
Test Pumping Rate: \_\_\_\_\_ Gallons Per Minute  
Duration of Pump Test (minimum 4 hours): \_\_\_\_\_ hours

### Method of Measuring Water Level Circle one

Air Line Electric Measuring Line Steel Tape  
Other (specify): \_\_\_\_\_  
For flowing well, measured shut in head: \_\_\_\_\_ feet  
Well yielded \_\_\_\_\_ GPM with a drawdown of  
\_\_\_\_\_ feet after \_\_\_\_\_ hours of pumping

I HEREBY CERTIFY that the above statements are true to the best of my knowledge.

Leaper Drilling #0079  
Print Name of Pump Installer and License No. (if applicable)

[Signature]  
Signature of Pump Installer

RECEIVED

MAR 13 2009

BY: OLWR