

Sep 19 08 10:00a

WEST WATER WELL DRILLING

6014262154

p.1

State Well Report

Part I

Mississippi Department of Environmental Quality
Office of Land and Water Resources
P.O. Box 10631
Jackson, MS 39289-0631
(601)961-5210
(601)354-6938 (fax)

For Office Use Only:

Aquifer: _____
Well #: K-50
L. S. Elevation: _____
E-log #: _____

County: Jones
Permit #: _____
Driller: Dand West
Date drilling completed: 8-22-08

State Law requires that this report be prepared by the driller in detail and filed with the Department within 30 days of completion of drilling of the well.

Well Owner Information	Well Location
Owner Name: <u>Lynn Buckhaults</u>	Latitude: <u>31-35-30</u> " Longitude: <u>89-10-15</u>
Mailing Address: <u>109 E Ave</u>	Method of Lat/Long (circle one): Conventional Survey, USGS quad, Hand-held GPS, Survey-grade GPS
<u>Ellisville MS 39437</u> City State Zip Code	<u>SW 1/4 SW 1/4 Sec 2 Twn 7N Rng 12W</u>
Telephone No. <u>(601) 477-9405</u>	Distance Direction Nearest Town <u>0</u> Miles <u>Inside</u> of <u>Ellisville</u> <u>City Limits</u>

Well Data

Purpose of Well (circle one) Home Industrial Public Supply Irrigation Fish Culture Other: Pond Fill

Date well drilling started: 8-22-08 Date well drilling completed: 8-22-08

If flowing, method of flow regulation: Valve _____ Other (describe) _____

Static Water Level: 34' feet above or below (circle one) land surface Date measured: 8-22-08

Method of Measurement (circle one) steel tape electric tape air line other: _____

Hole depth: 96' Well depth: 96' Well grouted to a depth of 10 feet

Type of grout (circle one): Cement Bentonite Mix

Casing length: 76 feet Casing diameter: 4 inches Type of casing: Pvc

Screen length: 20 feet Screen diameter: 4 inches Type of screen: Pvc

Screen slot size: 10 inches Setting depth: From 76 feet to 96 feet

Type of completion (circle all applicable): Gravel packed Underreamed Telescoped Open hole Natural Development

Other (describe): _____

Top of lap pipe or reduction in casing: _____ feet. If telescoped or more than one screen, describe on back of page

Logs run (circle all applicable): No log run Electric Gamma Ray Density Sonic Neutron Other: _____

Name of organization running log(s): _____

I certify that the well was drilled, constructed, and completed in accordance with all applicable requirements of the Mississippi Department of Environmental Quality and/or the Mississippi Department of Health regulations and state laws.

Dand West 0-672
Print Name of Water Well Contractor and License No.

Dand West RECEIVED
Signature of Water Well Contractor

SEP 18 2008

BY: OLWR

STATE WELL REPORT

Part 2

Pump Installer's Completion Report
 Mississippi Department of Environmental Quality
 Office of Land and Water Resources
 P.O. Box 10631
 Jackson, MS 39289-0631
 (601)961-5210
 (601)354-6938 (fax)

County: JDAS
 Permit #: _____
 Driller: David West
 Date completed: 8-22-08

For Office Use Only:
 Aquifer: _____
 Well #: K-50
 Elevation: _____

This report should be prepared by the pump installer in detail and filed with the Department within 30 days of the installation of pump.

<p>Well Owner Information</p> <p>Owner Name: <u>Lynn Buckhaults</u> Mailing Address: <u>109 E Ave</u> <u>Ellisville MS 39437</u> City State Zip Code Telephone No. <u>(601) 477-9405</u></p>	<p>Well Location</p> <p>Latitude: <u>31°35'30"</u> Longitude: <u>89°10'15"</u> Method of Lat/Long (circle one): <u>Conventional Survey</u> USGS quad, Hand-held GPS, Survey-grade GPS <u>SW 1/4 SW 1/4 Sec. 2 Twn 7N Rng 12W</u> Distance Direction Nearest Town <u>0 Miles Inside of Ellisville</u> <u>City Limits</u></p>
---	--

<p>Pump Type Circle one</p> <p>Air Lift Jet <input checked="" type="radio"/> Submersible Bucket Piston Turbine Centrifugal Rotary Flowing Well Other (specify): _____ Date Pump Installed: <u>8-22-08</u> Rated Pump Capacity: <u>35</u> Gallons Per Minute</p>	<p>Power Type Circle one</p> <p>Diesel Engine Gasoline Engine Natural Gas <input checked="" type="radio"/> Electric Motor Hand Tractor PTO Windmill Other (specify): _____ Horse Power Rating of Motor: <u>3</u> Setting Depth: <u>60</u> feet Number of Stages: _____</p>
---	--

<p>Pump Test Data</p> <p>Date Well Tested: _____ Static Water Level (A): _____ Feet Below Land Surface Pumping Water Level (B): _____ Feet Below Land Surface Drawdown [(B) - (A)]: _____ Feet Below Land Surface Test Pumping Rate: _____ Gallons Per Minute Duration of Pump Test (minimum 4 hours): _____ hours</p>	<p>Method of Measuring Water Level Circle one</p> <p>Air Line Electric Measuring Line Steel Tape Other (specify): _____ For flowing well, measured shut in head: _____ feet Well yielded _____ GPM with a drawdown of _____ feet after _____ hours of pumping</p>
--	---

I HEREBY CERTIFY that the above statements are true to the best of my knowledge.

David West 0672
 Print Name of Pump Installer and License No. (if applicable)

David West RECEIVED
 Signature of Pump Installer

SEP 18 2008
 BY: CLIVE

Sep 19 08 10:01a

WEST WATER WELL DRILLING

6014262154

p.3

K-50

If well telescopes please sketch below and show depths.

Ground Level

Description of Formations Encountered	From	To
Clay	0	13
Sandy Clay	13	44
Sand	44	96

If more than one screen, show location of each on sketch

Sketch the property layout and include the following: 1) the well location; 2) any permanent structures on the property that may aid in locating the well; 3) any roads, power lines, or other items that may aid in locating the property and the well; 4) indicate direction.

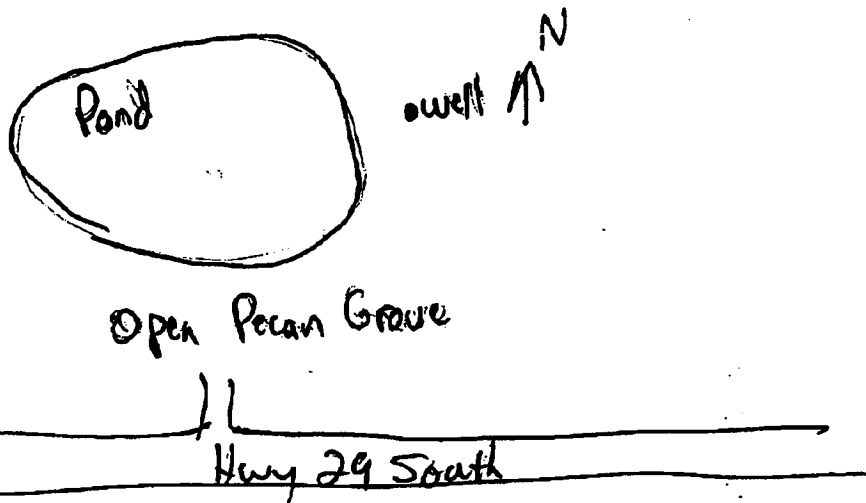

Landowner Name: Lynn Buckhauf

D.W. A. W.

Signature of Water Well Contractor

RECEIVED

SEP 18 2008

BY: OLWE